



2-Pc. Blitwell sectional davenport. Makes into bed. \$300 value, Special only **\$199**



Special combination offer: Revere Ware 1 1/2-qt. covered saucepan and 1-cup copper bottom handled measuring cup \$6.25 **\$6** \$2.00 Value

Special Sale on Receiving swing rockers. Assorted colors, top grade covers \$59.95 Special **\$59**

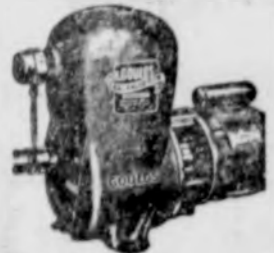

Gould No-Tank Pump Now Only \$111.75

# BRUNSMAN HARDWARE AND ELECTRIC

PHONE HA 9-5651 WE DELIVER

## FRIGIDAIRE ELEC. APPLIANCES — FINE FURNITURE



20-Gallon Garbage Can Special **\$3.95** 26-Gallon Can **\$4.95**

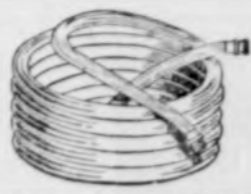

Green Opaque Vinyl Plastic Garden Hose. 50-Foot Length **\$2.49** 25-Foot Length **\$1.69**



Modern 3-Way Floor Lamp with Bulb. \$17.50 Val. **\$8.95** Special

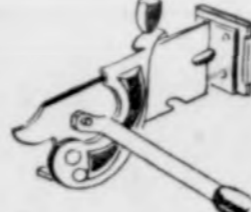

Swingaway magnetic can opener **\$2.98** \$3.98 Value **\$2** and any old can opener.



**FREE**

98c Kitchen Hammer and Screwdriver set with 1 gal. M.W. alkylid enamel. Gal. \$7.50 Qt. \$2.25 Three Beautiful Finishes: Full Gloss, Satin Finish, Wooncoat Flat

Outside White, Reg. \$6.29 **\$4.95** Special Gal. **4**

### Frigidaire Golden Anniversary Days



FD 104-58 10.4 cu. ft. Frigidaire Cyclomatic refrigerator with the only true automatic defrost **\$349.95**

New, low prices on Frigidaire Electric Ranges Washers and Dryers

**FREEZER BAGS, TAPE, BOXES, WRAPPING.**

#### FOR RENT ITEMS

- 20-Gal. 2-wheel Pump Spray \$1 day
- Orbit Sander \$1.50 per day
- Skil Floor Sander \$5 per day
- Half day \$2.50
- Floor Polisher \$1 per day
- Punch Bowl Set \$1 per day
- Curtain Stretcher 50c per day
- House Jacks 75c per week
- Power Lawn Mower

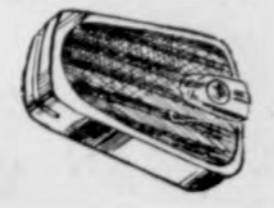

Borg Bath Scale, assorted colors **\$6** \$8.45 Value



Gleaming white toilet seat. Special **\$4.99** Only



\$12 High Chair **\$9.95**



Roll Roofing in all weights. Roofing tar in quarts, gallons and 5-gallon cans.



5-drawer chest of clear pine. No knots **\$15.95** 4-drawer **\$14.95** 9-drawer Mr. & Mrs. Chest **\$22.95**

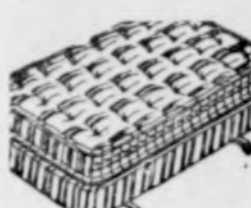

\$99.95 Kingfisher box spring and mattress set **\$69.95** Special



Beautiful new patterns in 6, 9 and 12-ft. Linoleum **\$1** Per Sq. Yd.



\$125 5-Pc. bedroom set and \$99.95 and \$99.95 deluxe King inner-spring mattress and box springs. Complete **\$179.50** For

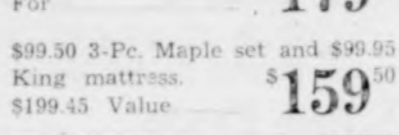

\$99.50 3-Pc. Maple set and \$99.95 King mattress. **\$159.50** \$199.45 Value

IT'S A PRIVILEGE AND A PLEASURE TO LIVE IN VERNONIA

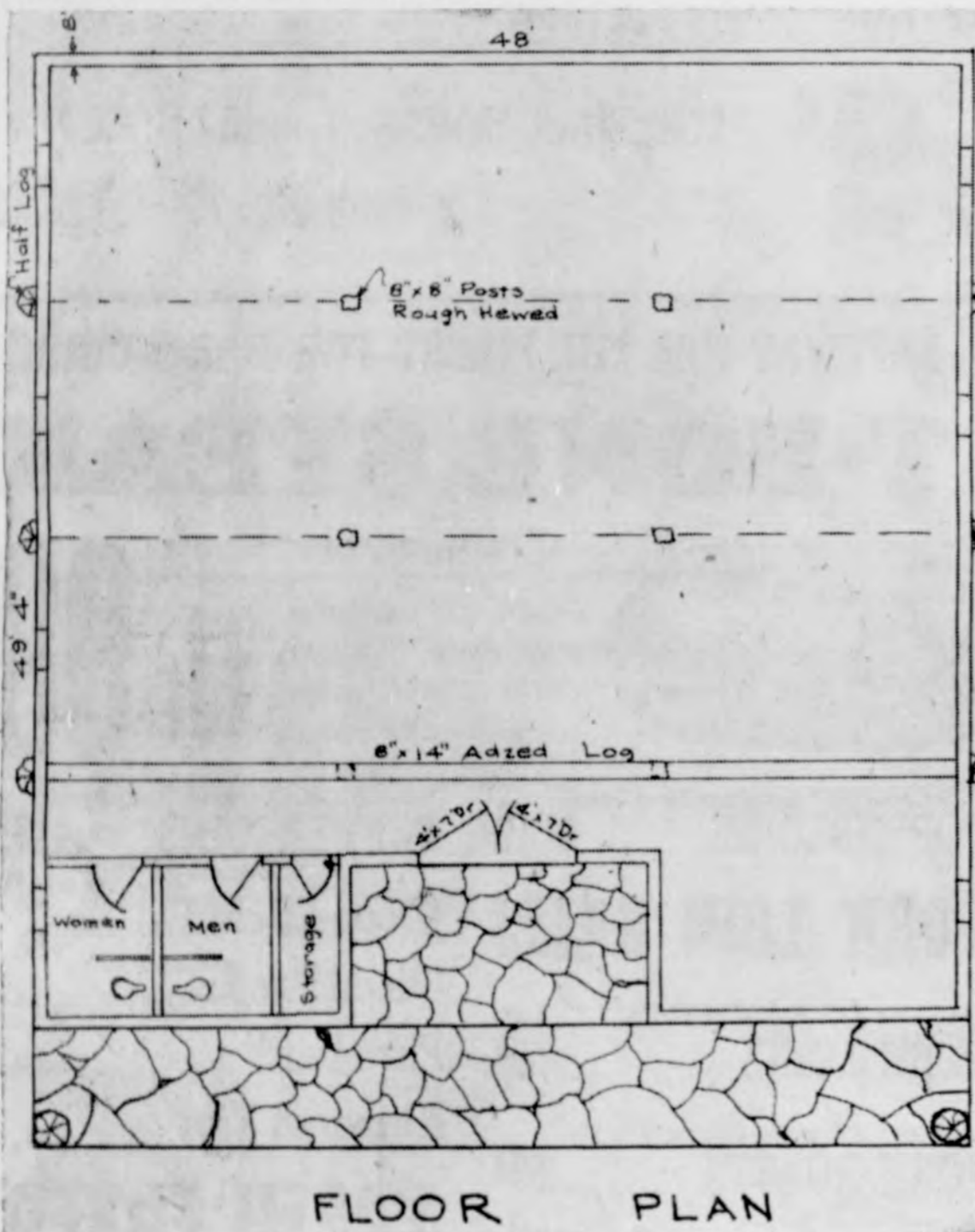

WHEN VOTERS go to the polls in November they will be asked to decide whether to adopt a one-mill levy for raising funds to construct a county historical museum. Artist's drawing above indicates tentative floor plan for structure. Design work was done by Clarence Wagner.

### Neuberger Urges S.S. Increases

Senator Richard L. Neuberger announced today that 135,503 Oregon residents were receiving monthly Social Security benefits totaling \$7.3 million monthly. In Columbia county 2,134 recipients draw \$121,144 monthly.

The Social Security figures for 1957, just released by the department of health, education and welfare, cover benefits for retired workers, wives or husbands, children, widows or widowers, mothers, parents and disabled workers.

Social Security disability benefits, for those totally disabled between the ages of 50 and 64 are paid to 1,217 Oregon workers. Senator Neuberger co-sponsored this amendment to the Social Security law which was adopted in 1956 and provides that totally disabled workers over 50 years of age are eligible for benefits.

Neuberger said that another 1958 amendment he sponsored, lowering the women's retirement age to 62, means that some 300,000 women throughout the country between the ages of 62-64

are receiving retirement benefits for the first time.

"Because of the ever-increasing high cost of living," Neuberger said, "I am urging adoption of legislation now in the Senate to provide a cost-of-living increase in Social Security benefits so that they will more adequately reflect today's needs."

Marian B. Folsom, secretary of health, education and welfare reported that more than 11 million persons are now receiving Social Security benefits at a monthly rate of \$606 million. This represents an increase of 2 million beneficiaries as a result of 1958 amendments to the Social Security law which provided coverage for the first time to the self-employed, women aged 62-64, and totally disabled workers aged 50-64.

OFFICE SUPPLIES THE VERNONIA EAGLE

### Return Coupon, Jamboree Asks

In order to ascertain the opinion of people interested in a bigger and better Friendship Jamboree for 1959 Jamboree officials ask that the coupon below be filled out and returned to either The Vernonia Eagle office or to Phil Steinmetz, present chairman of the Jamboree.

People who have ideas for improving the affair are urged to express their opinions below:

I believe the 1959 Jamboree should be held on the following date (or dates):

I would like to suggest the following events:

### Farmers Fail to Claim Gasoline Tax Refunds

Gasoline tax refunds are not being claimed by many farmers eligible to receive them, according to internal revenue service figures, says County Extension Agent, Don Coin Walrod.

Last year only 1.2 million farmers received gas-tax refunds out of the 4.8 million farmers eligible to make claims for the 3-cent-per-gallon rebate.

This refund is paid on every gallon of gas used for farm production purposes. Farmers that made claims last year should receive claim forms for this year by mail. Farmers not receiving refund application forms should request form 2240 from the district director of the internal revenue service, Portland.

The deadline for filing applications covering gasoline used July 1, 1957 through June 30, 1958 is September 30 this year, says Walrod.

Young drivers now being properly trained will reduce future traffic accidents, but population increases require a rapid expansion of driver training facilities. Fourteen states are offering financial aid to driver education programs, setting a pattern that will help provide adequate driver education courses for more high school students.

### County Fair Attended By Residents of Mist

MIST — Mr. and Mrs. Sam Devine were among those attending the county fair at Deer Island Saturday.

Mr. and Mrs. Francis Burnham, Jack and Loren from Portland were Sunday guests of her brother and wife, Mr. and Mrs. Shalmon Libel.

The Louswault family moved from the L. P. Wikstrom house last week to Clatskanie.

Mrs. Al Cavanaugh visited Sunday afternoon with Mrs. Austin Dowling.

Mrs. Lester Clossner was back from Martindale, Montana for a few days last week. The family is moving there where he is in the lumber mill business.

To help accident proof your home, avoid slippery floors, open fireplaces with no screens, and trailing extension cords.

CALL HA 9-3725 FOR FLOWERS FOR ALL OCCASIONS MRS. L. H. THOMAS

HENRY & POLLY HUDSON DRY GOODS NOTIONS — GIFTS FIRE, AUTO AND CASUALTY INSURANCE LINES Phone HA 9-6058 At Mile Bridge, Riverview

International Paper Co. LONG-BELL DIVISION Vernonia, Oregon

"It's the Water" that makes Olympia beer refreshingly different

OLYMPIA BREWING COMPANY, OLYMPIA, WASHINGTON, U.S.A.

### Suggestions for Your Next Grocery Order

COME TO YOUR FAVORITE FOOD STORE FOR FINE Groceries Meats—Vegetables

## SAM'S FOOD STORE

Free Delivery HA 9-5501

ELECTRIC WARM AIR FURNACES FOR HOME & INDUSTRY Complete Units \$275.00 — \$575.00 J. B. ARTMAN Timber Route Vernonia, Oregon