

The Leaders in Country Property

OregonCountryProperty.com

Listing and Selling Washington, Multnomah, Columbia, Yamhill, Marion, Polk and Clatsop county properties.
 If you are in the market to buy or sell country property, call us or visit our website
 for more information: OregonCountryProperty.com

Steve Mead
Broker



503-936-8110

Mark Mead
Broker



503-341-0319

2785 Towne Center Drive, No. 4
 Beaverton, OR 97006

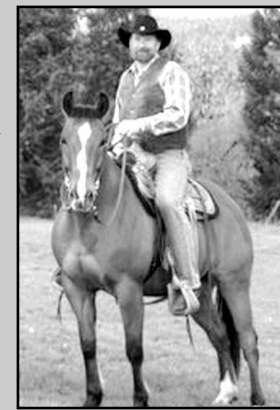

\$725,000 – 5.45 AC Quality custom built, huge rooms 4 fireplaces, bonus/game room, 6-panel doors. Two o'sized shops, 30x60 4-bay, 24x48 barn/bldg. Creek & pond.



\$298,000 – 1.44 AC Remodel w/2/2 on main. Loft, new deck o'looks river, new floor coverings, kitchen & bath. Great setting. Room for RVs. Fishing, swimming, mountains. Did not flood.



\$649,900 – 5 AC One level, vaulted thruout, new kitchen/baths, new h'-wood floors, massive stone FP. Beaut. grounds, huge covered patio, paved. Det. 1br/1ba cottage w/3rd garage. 4 stall barn w/tack room.



\$550,000 – 7.3 AC End of road. Fenced pasture, barn, 3 bay shop. Orchard/garden. Metal siding/roof. Stunning Craftsman detail, granite counters. Vaulted master, walk-in cedar closet & private deck w/spa.



\$349,900 – 5.63 AC Custom 2300 sf home, daylight basement, 20x30 covered deck wired for spa. 24x60 shop w/power. Close-in yet secluded. Southwest exposure w/view.



\$689,500 – 2 AC Stunning custom tamarack log home. Barely used, priced below reproduction cost. High ceilings, river rock f'place. 2 1-ac lots allow 2nd home. Walk to river.



\$699,000 – 12.69 AC Spectacular Sunset Corridor property. Meadow, room for arena, views, timber. Day ranch 1/4 mi off Hwy 26, minutes to Intel/Nike. Lg rooms, 2 f'places, 3 bay shop w/machine shed. County OK for add'l home.



\$185,000 – 1.44 AC Nice home w/main addition in '40s. New septic 1999; well about 1990. Sold AS IS. Preapproved buyers only. Foundation may need work. Room for shop, garden. Appt. only.



\$419,000 – 2.7 AC Like new home. Kitchen has cherry cabs, island, propane; great rm w/deck o'looks pasture, trees. 2 fenced paddocks, open meadows, firs, oaks.



\$995,000 – 9.77 AC True estate setting. Outstanding 2 story Craftsman, granite, marble, hickory cabs, great room. 48x60 shop, horse facility w/36x48 barn, 5 stalls, 3 paddocks. Paved circular drive.



\$224,900 One-year-old 2 story, 9 yrs warranty remain. Walk to shopping, schools. Room for garden. Covered deck. \$5000 gas card at closing.



\$989,000 – 57.50 AC Amazing cattle ranch. Restored 1911 farmhouse. 2000 add'n w/guest house. Rolling fenced pasture w/33 AC of water rights. Exc. fishing/swimming. House above flood plain. +/-1890s 6 stall 5000 sf barn, 2 loafing sheds. Incl. all equipment. 30 mins. to Hi-tech.



\$349,900 – 1.64 AC Turn key horse operation w/nice view setting. 60x72 covered arena, 4 stall barn, heated tack room, 12x24 hay barn, exclude panels. Well maintained home w/att. 2 car garage.



\$3,250,000 – 77 AC Camp Colton. Operating as a wedding event facility w/day & overnight use. Previous church camp. Great comm/church/retreat. Ancient forest setting, creeks, 2 trout ponds, cabins, chapel, meeting hall & shop. Call for CD.

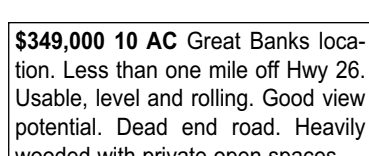

\$349,000 10 AC Great Banks location. Less than one mile off Hwy 26. Usable, level and rolling. Good view potential. Dead end road. Heavily wooded with private open spaces.
\$445,000 – 43.42 AC Buildable Sky-line area. Meets template test. Secluded, Coast range views, wooded. Driveway access to home site.
\$169,000 – 2.7 AC County OK for home, barn. Septic approved. Well 100', 35GPM, power, secluded, miles of trails. Seller carry w/10% down, 7.5% int only on balance.



\$549,900 – 5.21 AC Don't miss this! Paved circular drive. Close to ocean/fishing, outdoor activity. Close in privacy. 5BD, 3000 sf single level. Views, shop, office/studio, trails!

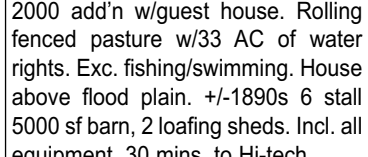

\$299,900 – 23.29 AC Beautiful, private gardener's delight. 1 AC flowers, trees, shrubs, grapes, nuts, berries, stream, ponds. Home being remodeled, new bsmt, in-floor radiant heat, hi ceiling. 20+ AC 10-11 yr-old timber

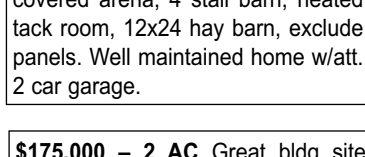

\$175,000 – 2 AC Great bldg site near Trask River, 1/2 mi past park. Hunting, fishing, nature.
\$149,000 – 5.19 AC Buildable parcel, well, easy commute, privacy, timber.
\$549,000 – 31.81 AC Vineyard potential between 2 existing vineyards. Stream, paved road. Seller to install 2 county-approved septic systems.

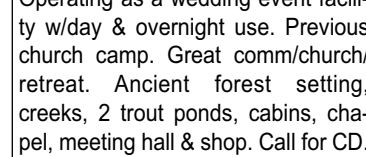

\$989,500 – 19.6 AC One of a kind estate property. Less than 30 minutes to ocean. Catch 50 lb. salmon and steelhead. Beautiful meadows perfect for horses/wildlife. Possible air strip. Old growth spruce private park on property. Quality built home.

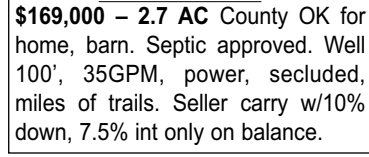

\$449,000 – 9.89 AC Must see property! Complete remodel w/new baths, electrical, bamboo floors, paint, etc. Big trees, 2 new shops +/- 2 AC meadow. Great horse property. Lease Option!



\$375,000 – 5 AC Privacy, woods, pasture & nature. Nice view from neat, clean mfg home w/3BD/2BA. Big decks, hot tub. Det. shop/ garage w/concrete floor and power.

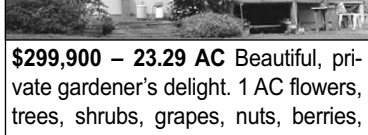

\$694,000 – 5.27 AC Multi-family/investment opportunity in city limits. Restored farmhouse w/sun room, media room, 4 bdrms + den. Country setting on edge of town. Barn/greenhouse & shop. City utilities. Call for development info.

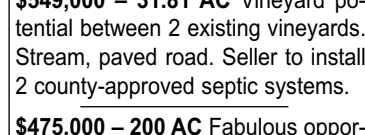

\$675,000 – 5.13 AC Designed by award-winning architect. Very private but close in. Breathtaking view. Designed for additional sq. ft.

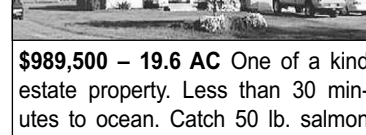

\$439,000 – 10 AC SADDLE UP! Fenced/cross-fenced, barn, exclnt. pasture, hay. Beautiful, mature landscaping. 240 sq ft covered porch. Recent add'n & remodel of home w/up-dated kitchen & bath.



\$449,900 – 4.89 AC Perfect family farm. Well maintained 2-story home, new 30 yr roof. 1+ AC producing orchard, vineyard. Fenced, excl horse property. Gentle south slope, corral, 24x60 barn/shop, concrete flr in shop.



\$750,000 – 5.21 AC Live high above Columbia River. Watch bald eagles, shipping, sandy beaches of Cottonwood Is. Fish for salmon, steelhead, sturgeon. Impeccable home/grounds; 36x60 4-bay encl. shop w/office.