



Project draws neighbor concerns

Seventeen Seaside homes east of Wahanna Road

By R.J. MARX
Seaside Signal

Engineer Mark Mead navigated a steep slope last week at the Seaside Planning Commission, presenting plans for Vista Ridge II, a 17-home development on 6.5 wooded acres that neighbors say is far too risky to build on.

Representing Sunset Ridge LLC, Mead asked the commission for approval for a subdivision east of Wahanna Road, to be accessed by Hemlock and Aldercrest streets and separated from the original Vista Ridge subdivision by a creek.

According to engineering plans, the parcel could be developed into 17 residential building lots from 7,000 to 15,000 square feet, with a single one- or two-story home on each lot. About 2 acres would be preserved for open space.

Concerned about flooding, landslides and habitat, neighbors turned out to slow or halt the process.

See Project, Page A3

GEARHART

Circuit Court judge hears firehouse ballot arguments

City aims for May 2022 bond vote

By R.J. MARX
Seaside Signal

Clatsop County Circuit Court Judge Beau Peterson heard testimony last Thursday from Jack Zimmerman and Gearhart City Attorney Peter Watts in seeking to determine the wording of a ballot title for a \$13 million firehouse bond vote.

The bond measure was pulled from the November ballot by Clatsop County Clerk Tracie Krevanko because the court hearing extended past the election filing deadline.

Gearhart is working with planners to bring the 30-acre Cottages at Gearhart subdivision off Highlands Lane into the city's urban growth boundary in a land swap for acreage in the city's "no-build" zone near the ocean. The land would be used for a firehouse and police station.

See Firehouse, Page A5



Katherine Lacaze

Seaside anticipated providing full, five-day-per week, in-person instruction for the entire year.

BACK TO SCHOOL

First day excitement shared at Pacific Ridge, new campus

By KATHERINE LACAZE
For Seaside Signal

The morning of Sept. 7 brought with it nearly idyllic fall weather — sunny and crisp — as Seaside students headed up the hill for the first day of the 2021-22 school year.

Despite the long lineup of cars leading out onto Wahanna Road as parents, guardians and students started adjusting to new traffic patterns, there was a thrum of enthusiasm

as young children hustled into Pacific Ridge Elementary School, aided by administrators and staff who, more often than not, greeted them by name.

"It was a great way to start the year," said Superintendent Susan Penrod, who helped with morning traffic monitoring. "Whether you're a 5-year-old or an educator who's been doing this for 30 years, there's still that excitement of the first day of school."

See First day, Page A6

In-person instruction brings new protocols

By KATHERINE LACAZE
For Seaside Signal

With classes officially underway, administrators and staff are focused on providing students with a somewhat typical school year for 2021-22 while still adhering to protocols and guidelines designed to mitigate the risk of COVID-19.

"It's our No. 1 goal to keep kids in school all year, every day," Superintendent Susan Penrod said.

That is one of the district's areas of focus when it comes to developing and implementing protocols. The other two are designed to uphold it: keeping students and staff healthy, and supporting students as they transition back into full-time learning in the building through social-emotional learning, instructional interventions and open communication with families and the community.

Safety protocol

Many of the protocols in the district's plan — presented before the board of directors and approved at the August meeting — mirror those in place during hybrid learning last school year and over the summer.

Face coverings are a requirement for all staff and students 5 and older, both on campus and when using bus transportation, regardless of vaccination status. This is not only a district guideline, but also in line with Oregon's indoor mask mandate that went into effect last month.

See Back to school, Page A6



Katherine Lacaze

Seaside High School teacher Jeff Corliss annually organizes the Link Day program, a unique take on orientation.

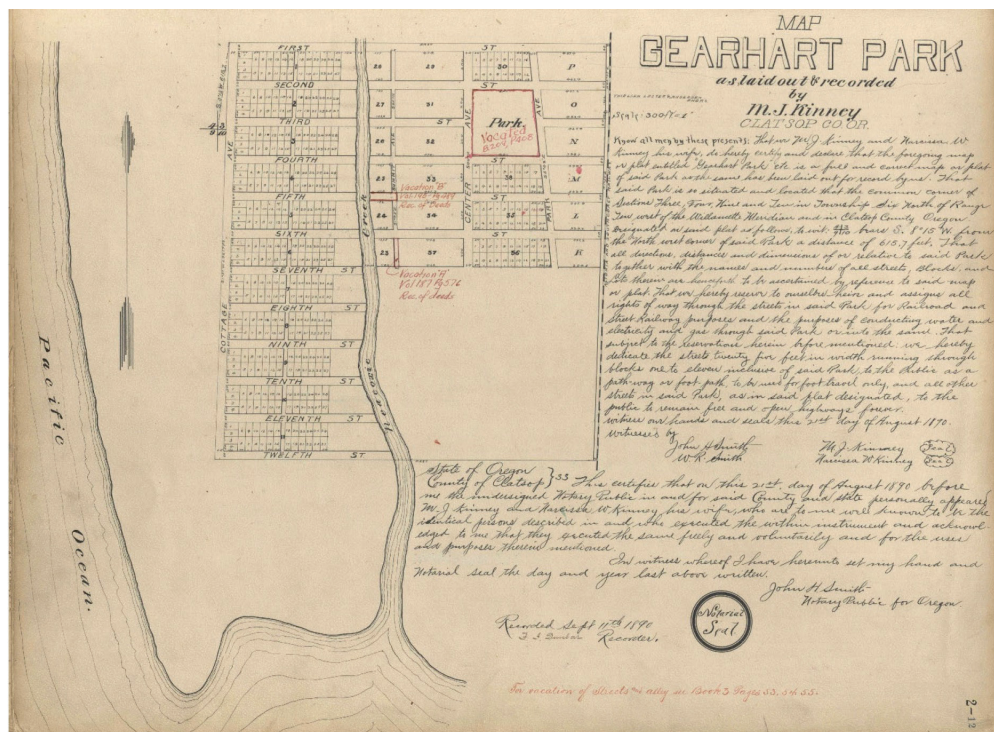

Original map of Gearhart as laid out and recorded by M.J. Kinney.

GEARHART

City considers parks master plan

Residents prepared to invest in preservation, recreation

By R.J. MARX
Seaside Signal

In a parks survey conducted by the Gearhart Parks Master Plan Advisory Committee, Gearhart residents found many ways to say the same thing when it comes to their love of beaches, local parks, walking and bike trails.

The plan, delivered in draft form last Tues-

day, describes a potential for improving facilities for east-west travel across U.S. Highway 101 and new parks throughout the city. It emphasizes support for existing parks and trails like the Ridge Path, Lesley Miller Dunes Meadow Park and the 10th Street beach access.

"It was interesting to note how much of the community agrees," said George Van Hoomissen, chairman of the committee. "There are some areas of disagreement. But there is far more consensus in our communities."

Along with Van Hoomissen, who is executive chairman of USNR LLC, a man-

ufacturer of equipment for the wood processing industry based in Woodland, Washington, the committee includes Gearhart residents Skyler Archibald, executive director of the Sunset Empire Park and Recreation District; former Seaside School District Superintendent Doug Dougherty; Planning Commission member Austin Tomlinson, natural area manager for the Columbia Land Trust; and longtime resident Molly Meyer, a retired nurse.

See Parks, Page A5

