

# A Minimum Home You Would Be Proud To Own

One of the most annoying jobs of the home handyman is that of fastening objects to masonry or plaster. Very often a person who is adept at woodworking or general do-it-yourself activity will come a cropper when he has to make an attachment to a concrete or plaster wall.

Sometimes, the difficulty is caused by lack of familiarity with the many types of fasteners on the market rather than by lack of skill. There are literally dozens of types of fasteners available but most of them fit into one of the categories we will discuss here.

For concrete, an excellent fastener is a masonry shield or a masonry anchor. Similar in appearance, these are hollow receptacles which are inserted into holes in concrete. The holes are drilled into the concrete, either with a power drill with a carbide-tipped bit or with a star drill. When a screw or special bolt is inserted into the shield or anchor, the receptacle expands, firmly gripping itself inside the concrete. In making the hole in the concrete, it is important that it be slightly smaller—one-sixteenth of an inch—than the shield or anchor. If you have done the job right, the shield or anchor will fit very snugly.

There is a plastic anchor which operates on the same principle as the metal anchor, but which usually is intended for lighter installations. Masonry nails also can be used. These are hammered into the concrete and sometimes require plenty of sheer power. The nails are inclined to bend under the hammering unless they first are inserted into the object being fastened, such as a piece of 2 by 4 studing.

For masonry, there also is something called an anchor nail, which does away with the job of



**MINIMUM HOME; MAXIMUM APPEAL** — This house contains only 1,221 square feet of living area, but it has three bedrooms, a split bath which does the work of two, plus a number of bonus features seldom found in small

homes. Architect Herman H. York also suggests a number of ways to improve the home, if the budget can stand it.

In plaster, ordinary nails or screws usually will not hold very well, although they sometimes can be used when very light objects are being attached to the wall. A picture nail will hold well. But it is driven into the wall at an angle and thus, while practical for a picture, is not ideal for an installation which must rest flush against the wall.

Most plaster walls have openings in back of them and call for the use of a toggle bolt. This bolt has a wing-like attachment on it. As the bolt is driven into the wall, the wings open up the moment the bolt reaches the inner side of the wall. The bolt thus is held firmly in place.

Also practical for plaster walls are smaller fiber and plastic plugs into which screws are inserted. Still another way to get results is to make a hole in the plaster and fill it with wood putty or plastic wood. When the filler is dry and thoroughly hard, it serves as a base for an ordinary wood screw. And when something extra heavy must be hung on a plaster wall, it often is necessary to use long screws that go through the wall into the studing.

In hanging a kitchen cabinet, it usually is best to attach heavy strips of wood to the wall, then attach the cabinet to the wood. It's easier to drive screws through the

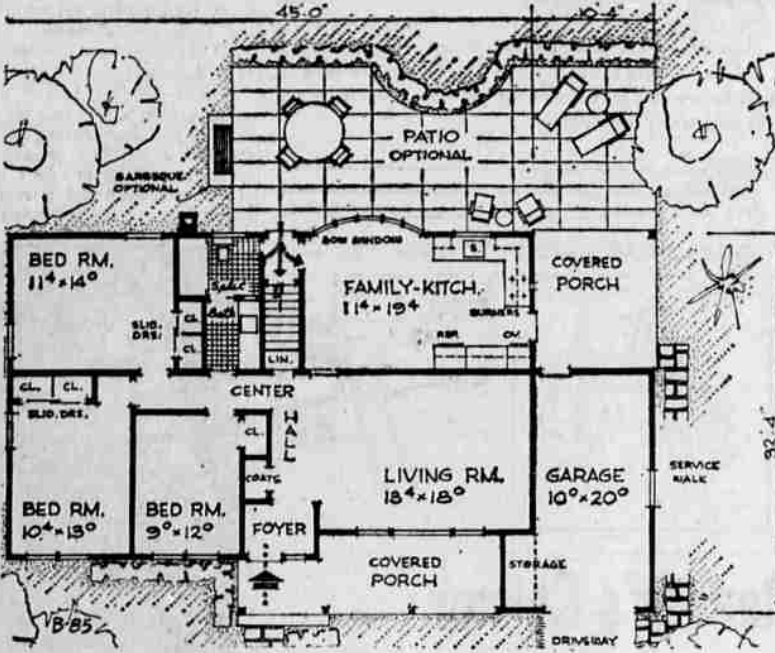

**FLOOR PLAN** — Excellent design makes maximum use of every inch of the 1,221 square feet in this house. Garage adds 225 square feet to over-all area. Note split bath, with two entrances and sliding divider separating vanity from bathtub area, enabling single bath to do the work of two. House has full basement, not shown in plan.

back of the cabinet into the wooden strips through the back of the cabinet, the plaster and the studing at the same time. This also allows the passage of air between the wall and the cabinet, desirable in a room where there is excessive humidity.

**B-85 STATISTICS**  
A minimum house, containing three bedrooms, split bath, living room, family room-kitchen, two covered porches, single garage, full basement, in 1,221 square feet not including 225 square foot garage. Dimensions are 46' 4" wide by 32' 4" deep.  
Addition of living room fireplace would add 2' to width. Double garage instead of single would increase width about 9". Brick or stone could be substituted for wood exterior if desired; architect would provide detail for minor dimensional changes.



**MODEST LUXURY** — View from the living room entrance to the family room-kitchen shows the glamorous, bow window overlooking the rear patio. Kitchen work area is U-shaped, broken by entrance to covered porch. The architect suggests wood paneling as an option feature to dress up the bow window area.

### Send this coupon for your STUDY PLAN

YOU CAN GET a study plan for The House of The Week by filling in your name and address on the coupon on this page and sending it with 50 cents to this newspaper.

This study plan shows each floor of the house together with each of the four elevations, front, rear and sides of the house. It is scaled at 1/8-inch per foot. It includes a guide on "How to Get Your House Built."

You can take this study plan to your bank or other mortgage lender and to your builder and get rough estimates on the cost of construction in this area as well as an idea of the cost in relation in your budget.

With this information you will know whether you will want to proceed with construction by ordering working blueprints direct from the architect and asking for bids for the work.

**STUDY PLAN ORDER COUPON**  
Enclosed is 50 cents. Please send me a copy of the study plan of **The House of The Week** B-85

Name \_\_\_\_\_  
Street \_\_\_\_\_  
City \_\_\_\_\_ State \_\_\_\_\_  
Building Editor: \_\_\_\_\_ (please print)

### Not Eliminated Yet

**BUFFALO, N.Y. (AP)** — Gov. Nelson A. Rockefeller said today he has not eliminated former Vice President Richard M. Nixon as a potential candidate for the Republican nomination for president in 1964.

Of the possibility that Nixon's statement Wednesday night withdrawing from presidential competition had left Rockefeller a leading candidate, the governor said: "I really don't agree."  
He said he would not make his own intentions regarding the GOP presidential nomination known until after his bid for re-election in New York state next year.

**DANGEROUS BOMB SHELTER**  
SANTA CLARA, Calif. (UPI) — Police inspector Loren D. Pierce, who also serves as Santa Clara's coordinator of civil defense, sprained an ankle Wednesday when he fell 12 feet into the excavation for a bomb shelter he was building in his backyard.

## ON THE HOUSE

By ANDY LANG

**What's new on the market:**  
The product — a power block plane. It weighs only 4 1/2 pounds and can be held in one hand.  
The manufacturer's claim—that it is a new concept in planing because it not only is faster than its non-powered predecessors, but does a wider variety of operations, including edge planing, beveling, rabbeting and surface planing.  
The product—an all-purpose masonry kit. It includes all the materials and tools needed for a cement job and is packaged in its own plastic mortar box.  
The manufacturer's claim—that its key ingredient is a unique, pre-blended masonry product requiring no additive but water and that it will bond to cement, stone, brick, flagstone and steel.  
The product—a spray designed to prevent mildew.

**MOEN**  
NEW! CONVENIENT! one handle does the work of two

**SHERWIN-WILLIAMS PAINTS**  
OUR BEST BUY  
OPEN A CHARGE ACCOUNT!  
Up to 5 Months to Pay!  
No Carrying Charges!

**Ethan Allen**  
Early American Furniture  
Plus 2 1/2% Green Stamps  
Exclusively ours in Klamath Falls

**TOWER**  
12th & Main

**Washer Service**  
Reliable — Guaranteed  
Automatics  
Conventional  
CALL — J. W. KERNS  
734 So. 6th TU 4-4197

**N. R. KIMES**  
Plumbing & Heating  
2720 So. 6th Ph. TU 4-8620

**1229 E. Main - TU 4-3324**

**NEW METHOD CLEANERS**  
1433 Esplanade Ph. 4-4471  
RUG CLEANING  
WALL-TO-WALL CARPET CLEANING  
FURNITURE CLEANING & TINTING  
Gold Bond Stamps, Too!

# House-Trading May Be Easy As Car-Trading

Trading in your old house for a new split-level may become as natural as unloading the old klunker in your driveway for the newest "Chromefire 8," say a sampling of realtors across the nation.

Larger families, a desire for more expensive homes and the plain fact that 50 per cent of potential homebuyers already own a house are forcing builders and realtors into the "used house" business, according to a survey by E. L. Bruce Co., the world's largest maker of hardwood flooring.

The public is trade-in conscious," declares a Harlingen, Texas, realtor.

"Trade-ins will increase," says one Cincinnati realtor, "simply because the public wants it."

Not a month passes that some builders' association does not put trade-in plans on the agenda. Almost all builders and realtors agree that increasingly the toughest obstacle to overcome before making a sale is helping the prospect get rid of his present house so he doesn't get stuck with two pieces of property.

Twelve Fort Worth builders have joined to form the Builders Trade-

In Exchange. The local homebuilders association at Fort Way Ind., has formed its own trade-in home corporation. A savings and loan company in Peoria, Ill., has a special deferred payment plan for builders and realtors taking trade-in homes.

Probably the most celebrated trade-in plan in the housing industry so far is "Operation Trade-Up" in New Jersey. Briefly, "Operation Trade-Up" provides two 45-day periods in which a homeowner after signing up can either sell his house himself for a better price and cancel his OT-U con-

tract or accept the OT-U offer. Even Capitol Hill has taken an interest by instructing the Federal Housing Administration to offer special 85 per cent mortgages on traded houses. This plan has been reported unsuccessful, so far.

One thing seems certain, and that is that additional trade-in plans are needed and are being offered every day in the United States.

And just as you wax your car... hammer out the dents... and keep Junior's feet off the upholstery, so will you have to buy and take care of your home with an eye to eventual trade-in value, say housing industry leaders.

## Fit Child's Room To His Future By Using Care In Redecoration

By VIVIAN BROWN  
AP Newsfeatures Writer

Planning to redecorate the nursery for your now-in-school 6 year old? Think carefully before you get out the paint brushes and swatches and start visiting furniture stores, or you may have the whole job to do again in just one year. That's advice from young, talented Emily Malino, New York decorator and mother of four.

She says: "The transition period between 6 and 7 years of age is big. It takes Mother by surprise, but her small child suddenly requires adult furnishings."

"A beginning reader, he will need a desk and lamp, a reading lamp at the bed, a place for books and storage space for toys that he does not wish to discard. He'll need space for sociability from 7 until his mid-teens — a place for a record player, hobby collections, drawing tools, comfortable seating arrangements for friends."

A good sturdy bed can move into the teen years with a youngster she points out.

"One must have a long-range plan in decorating a child's room. If a large family is planned, think in terms of flexibility."

"If a room is being furnished for a boy, can you move a girl into it later? Will the storage space accommodate her as well as the boy?"

Emily Malino has two girls, 10 and 7 1/2, and two boys, 4 and 2. "I'm always decorating children's rooms in my own home and I've learned a lot about their needs and likes. Colors can be bright or soft as long as they are in good taste. The amateur decorator should avoid linking children with wishy-washy colors or too-bright garish colors," she says.

A parent should guide a child toward developing a sense and taste of his own, she says, adding that taste isn't nourished in dreary furnishings.

The decorator likes white and off-white in youngsters' rooms, with one wall painted an accent color which is repeated in room accessories. Unpainted furniture is inexpensive and the children have

(un suggesting new colors, painting it themselves and moving the furniture around where they choose. Miss Malino says these dressed-up unpainted pieces can sometimes serve from crib to college.

A good room planning can result in a lot of mileage out of initial investment. Economy tricks Miss Malino has employed in children's rooms include using a high bath table in a nursery, cutting the legs down to make it useful as a playtable in childhood, adding casters for desk use in the teens.

An unused fireplace in a child's room makes a wonderful place for a built-in doll house, she points out. Shelves built into that fireplace would please any little boy who has a collection of trains.

The vivacious decorator graduated from Vassar in 1932, studied at Columbia School of Architecture and has specialized in contractual work for hotels, hospitals and offices. An award last year for her work in a home for neglected youngsters recognized the Malino talent as a decorator of children's rooms.

## Gutters Must Be Clean To Work

By MR. FIX  
Written for  
Newspaper Enterprise Assn.

If you think that gutters and downspouts are unimportant so far as periodic maintenance is concerned, remember that the investment in gutters for a single home may run several hundred dollars. If you think that you can do without them should they rust and fall apart, consider the foundation plantings around your house that would be ruined and the possible danger to foundation and basement.

With a little periodic work all gutters will last a long time. Stainless steel, copper, aluminum and galvanized metal are the materials you are likely to encounter; although the first two are not very common today. If you were to replace them, steel and copper would cost the most and the others would follow.

The most expensive material is also the best. But even the cheapest, galvanized metal, will last a lifetime if properly installed and cared for.

**Lasting Gutters**  
To make the gutters last they must be kept clean of all debris; be coated on the inside with an asphalt-asbestos paint; be painted on the outside, maintaining a proper pitch so that water does not collect, and be fastened with materials made of the same metal. Any inspection should consider all these points.

It's wise to check gutters while the weather is still warm. Not only is it easier, but gutters should be put in shape before winter when they will be subjected to heavy loads of snow and ice.

When you check the gutters take along a wire brush to clear away twigs, leaves, soot and other dirt. If hangers are loose re-nail them. Carefully lift the shingle under which the hanger is fastened, fill the old nail hole and cover the new nail head with asphalt paint.

**Check Back**  
Other gutters—the box type —

are fastened by driving spikes through the front of the gutter into the fascia board at the rear. Sometimes re-nailing is called for. Check the board at the back of the gutter to see that it hasn't rotted.

Pin-point holes should be thoroughly cleaned and coated with asphalt paint. Larger holes should be patched. Again, clean away all rust. Patches can be made of canvas, burlap, or roofing combined with layers of asphalt paint. Or

remain in little pools. If you haven't already, install wire strainers at the outlet from gutter to downspout. Check the straps that hold the downspout against the house and re-nail where loose.

If the downspout is blocked, clear it with a weight tied to a rope or with a metal used to clear drains.

Outside surfaces should be cleaned of rust and painted with a rust resistant paint.

**GUTTER CARE**  
CHECK FOR ROTTEN WOOD  
INSTALL STRAINERS  
WATER SHOULD FLOW TOWARD DOWNSPOUT

you can use some of the modern glass fibers and resins often sold for auto body repair.  
If you use metal, make certain that it is the same metal the gutters are made of. If you use any of the plastic metals (plastic aluminum, steel, etc.) again make certain that the metals match.

**Carry Water**  
Take along a can of water when you make your inspection. Make certain that the water flows toward the downspout and does not

## Consent Needed For Transfer

**SALEM (AP)**—Consent of the patient's family must be obtained before state hospitals can transfer patients to nursing homes, Atty. Gen. Robert Y. Thornton said Wednesday.

He said the law prohibits discharge of a patient if his guardian, friends or relatives are unwilling to care for him or arrange for his care.

The state hospitals have been placing some patients, especially older ones, in nursing homes. The state Public Welfare Commission pays for such care.

**CARPETING HOST-CLEANED**  
Do it yourself OR we do it for you  
**RENT THE HOST Electric Brush**  
When cleaned by you... your carpeting should be HOST-CLEANED. Safe, won't burn, dustless. Removes dirt instead of shampooing it in. No shrinkage, raises nap, saves texture. Before entertaining...  
Ph: 4-5111 or 2-2531 for Complete Information  
**CASCADE LAUNDRY & CLEANERS**  
Opp. P.O. 11th & Klamath

**Fiberglass Boat Building Materials The Gun Store**  
714 Main Ph. TU 4-3863

**REMODELING?**  
Shop Calhoun's For **LINOLEUM**  
Over 100 rolls to choose from... all colors and grades. Vinyls, inlays... marbled or embossed.  
**TILE**  
Vinyls, Asphalt, Linoleum, vinyl-asbestos... all in stock in large quantities. Choose from marbles... confetti... tweeds... plain patterns.  
**FORMICA** **FREE ESTIMATES GLADLY!**  
Whatever your needs... you'll find it at Calhoun's. An array of colors and patterns too numerous to list!  
**CALHOUN'S FLOOR COVERINGS**  
357 E. Main TU 2-5523

See Lucas for a Complete Selection!  
**HARD SURFACE FLOOR COVERINGS**  
Building or remodeling, you'll do well to visit our hard surface floor covering department. New patterns have been arriving almost daily, and we do expert installation on floors, counters, wall tile. Or, install yourself. Our usual low prices... you'll save!  
**Linoleum**  
FREE ESTIMATES - NO OBLIGATION!  
Ph. 4-3134  
**LUCAS Furniture**  
108 EAST MAIN Between Main Street Underpass and Mills School