

THE HOUSE OF THE WEEK

Like Outdoor Living? Then Try This!

By DAVID L. BOWEN

For those who dare to be different, this house offers a remarkable opportunity for enjoyment of modern outdoor living.

It's a moderate sized six-room ranch laid out in an unusual but rewarding U-shape. Nestled between the protective arms of the "U" and completely hidden from the street is a delightfully private patio.

The patio actually adds a seventh room, open to the sunlight and cooling summer breeze but shielded on three sides by the house and by a pair of pierced brick walls on the fourth.

The warm, cheerful atmosphere of the patio comes flooding into the house through the big glass doors and window which separate it from the combination family-dining room.

The plan is B-2 in the House of the Week series of distinguished homes, this one designed by Architect Samuel Paul. The living area is 1,672 square feet, not including the two-car garage. There are three bedrooms, a large kitchen, 2½ baths, entrance foyer and a 22-foot living room with a two-way fireplace which also opens toward the family room.

A major advantage of the U-shape is the separation of the sleeping wing from activity areas. The bedrooms are further shielded by a hallway and a bank of closets.

The U-shape also makes possible cross ventilation of the master bedroom. In addition to a large walk-in and a 6-foot long conventional closet, this chamber has a full private bath.

B-2 is trimly roofed with a hip around the three sides of the "U" and a flat roof above the garage and front entrance porch. The exterior is finished in wood siding or shingles. Over-all width is 51' and depth is 58'4".

Additional Details

If the owner desires, the patio can be completely enclosed and fenced to provide a controlled play area for small children. The patio is ideal for supervision, since it can be seen from the family room, living room and the master bedroom.

The kitchen is the core of the home to the woman of the house. This one has room for all the mechanical labor savers that the homemaker could desire: built-in oven - broiler combinations, six burner counter-top range, built-in refrigerator, freezer, dishwasher and a generous amount of counter



HORSESHOE RANCH: A different shape pays an outdoor living bonus in this six-room ranch design. The side patio is completely shielded on three sides by the house itself. Living room and foyer are across the front, kitchen and combination family-dining room at the base of the "U", and bedrooms in the rear.

space. There's also room for a breakfast table.

The formal living room is separated from the foyer by a louvered screen which provides glimpses of the living room before guests enter the room itself. This space divider also directs everyday traffic toward the informal portions of the house without causing traffic through the living room.

Design Bonus

A major bonus is the double use lavatory just off the foyer. It can serve both as a powder room for the living - dining room area and

a clean-up room for children entering the house through the kitchen door.

The basement has plenty of light and air and could be developed into a bad-weather play area with little effort. The two-car garage has ample space for storage of garden equipment as well as a good location for a workshop.

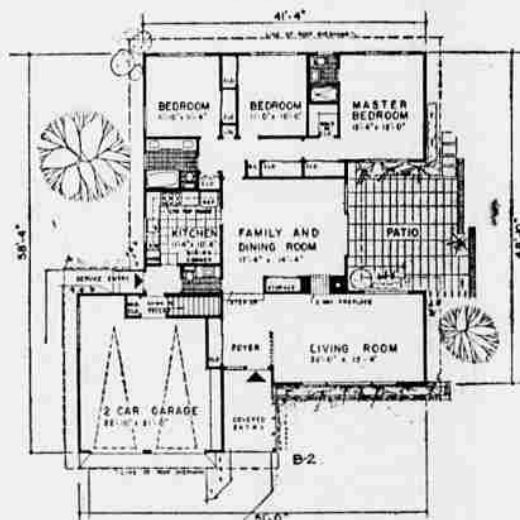

B-2 STATISTICS

This plan offers six rooms in 1,672 square feet of living space. There are three bedrooms, 2½ baths, living room, kitchen and combination family-dining room. A basement and two-car garage supplement abundant first floor storage space.

Over-all width of the house is 51 feet even. Depth is 58' 4".

FLOOR PLAN: There are 2½ baths in this three-bedroom ranch. Modern kitchen is in central location with easy access to the outside and basement. Living area is 1,672 square feet, not including two-car garage.

Send this coupon for your STUDY PLAN

YOU CAN GET a study plan for The House of The Week by filling in your name and address on the coupon on this page and sending it with 50 cents to this newspaper.

This study plan shows each floor of the house together with each of the four elevations, front, rear and sides of the house. It is scaled at 1/8-inch per foot. It includes a guide on "How to Get Your House Built."

You can take this study plan to your bank or other mortgage lender and to your builder and get rough estimates on the cost of construction in this area as well as an idea of the cost in relation in your budget.

With this information you will know whether you will want to proceed with construction by ordering working blueprints direct from the architect and asking for bids for the work.

STUDY PLAN ORDER COUPON

Building Editor:
Enclosed is 50 cents. Please send me a copy of the study plan of **The House of The Week B-2**

Name _____
(please print)

Street _____

City _____ State _____

Service Is Their Motto

NEW YORK (UPI)—The **Homeowners Association**, which provides around-the-clock maintenance and repair services for thousands of members throughout the nation, also stands ready to help its clients with more personal problems.

Its 1959 list of strange and unusual requests included:

An Ohio member who gave no explanation for wanting to have his TV set installed in a new cabinet—upside down.

A lady in Connecticut who is not an insomniac but has a dog who

is. She wanted someone to walk her pet each day from 4 to 5 a.m.

A Pennsylvania member who wanted a "genuine French chef" to handle the culinary chores at a backyard barbecue.

A suburban New York matron who ordered the installation of a plumbing system to enable her to select one of four favorite eaux de colognes for automatic mixing with her shower water each morning.

And a doting mother in the Midwest who had her children's rigipus room paneled entirely in foam rubber—even the ceiling.

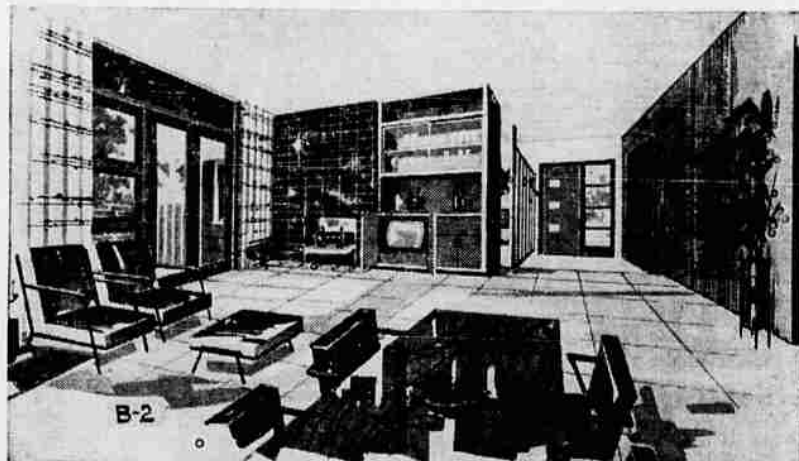

WIDE OPEN SPACES: Artist's view looks across family-dining room from the bedroom side toward two-way fireplace and front entrance foyer. Patio is through glass doors to left.