

MARKETS and FINANCIAL

All Major Grains Score Advances

CHICAGO (AP) — A late rally, accompanied by the most active trading of the session, left all major grains with advances at the close on the board of trade Thursday.

Brokers thought the closing advance stemmed mainly from short covering, partly from floor traders who had sold earlier in the day. Final prices in wheat, corn and oats were just about the day's highs.

Until the last half hour, the market had held under the previous close practically the entire session. March corn was an exception, showing strength from the start on export buying.

Wheat closed $\frac{1}{4}$ higher, Mar. $\$2.57\frac{1}{2}$, corn $\frac{1}{4}$ higher, Mar. $\$1.93\frac{1}{2}$, oats $\frac{1}{4}$ higher, Mar. $\$1.84\frac{1}{2}$, rye $\frac{1}{4}$ higher, Mar. $\$1.98\frac{1}{2}$, soybeans 1 cent lower to $\frac{1}{4}$ higher, Mar. $\$2.99$, and lard unchanged to 10 cents a hundred pounds higher, Mar. $\$13.80$.

	Open	High	Low	Close
Mar	2.55	2.57	2.55	2.57 1/2
May	2.52	2.53	2.51	2.52 1/2
July	2.46	2.46	2.45	2.46 1/2
Sep	2.47	2.48	2.47	2.48 1/2
Dec	2.50	2.51	2.50	2.51 1/2

Oil Demands Holding Higher

NEW YORK (AP) — Highly selective demand centering in oils today kept the stock market a shade higher.

Aside from issues in which there was exceptional demand, prices were spread out over a range of around 2 points higher to 1 lower.

The volume of business again lagged at an estimated 1,300,000 shares.

Railroads held ahead, and steels and motors were steady. A few good plus signs showed up in utilities, gold mines, and rubbers.

Quotations

By The Associated Press

Admiral Corporation	26 3/4
Allied Chemical	71 1/2
Allis Chalmers	51 1/2
American Airlines	23
American Power & Light	156 1/2
American Tel. & Tel.	63 1/2
American Tobacco	51 1/2
Anacostia Copper	76 1/2
Atchafalaya Railroad	51 1/2
Bethlehem Steel	48 1/2
Boeing Airplane Co.	64 1/2
Borg Warner	17 1/2
Burroughs Adding Machine	67 1/2
California Packing	26 1/2
Canadian Pacific	35 1/2
Caterpillar Tractor	50 1/2
Celanese Corporation	46 1/2
Chrysler Corporation	70 1/2
Cities Service	109 1/2
Consolidated Edison	35 1/2
Consolidated Utilities	19 1/2
Crown Zellerbach	55 1/2
Curtis Wright	9 3/4
Douglas Aircraft	60 1/2
duPont de Nemours	87 1/2
Eastman Kodak	42 1/2
Emerson Radio	56 1/2
General Electric	14 1/2
General Foods	43 1/2
General Motors	52 1/2
Georgia Pac Plywood	22 1/2
Goodyear Tire	46 1/2
Homesite Mining Co.	36 1/2
International Harvester	34 1/2
International Paper	49 1/2
Johns Manville	64 1/2
Kennecott Copper	87 1/2
Libby, McNeill	21 1/2
Lockheed Aircraft	16 3/4
Loew's Incorporated	16 3/4
Long Bell A	42 1/2
Montgomery Ward	62 1/2
Nash Kelvator	19 1/2
New York Central	15 1/2
Northern Pacific	16 1/2
Pacific American Fish	35 1/2
Pacific Gas & Electric	109 1/2
Pacific Tel. & Tel.	71 1/2
Packard Motor Car	18 1/2
Pennycy (J. C.) Co.	9 1/4
Pennsylvania R. R.	28 1/2
Pepsi Cola Co.	24 1/2
Philo Radio	64 1/2
Radio Corporation	42 1/2
Rayonier Incorp	42 1/2
Rayonier Incorp Ptd	66 1/2
Republic Steel	57 1/2
Reynolds Metals	30 1/2
Richfield Oil	55 1/2
Safeway Stores Inc.	38 1/2
Scott Paper Co.	38 1/2
Sears Roebuck & Co.	63 1/2
Socony-Vacuum Oil	51 1/2
Southern Pacific	80 1/2
Standard Oil Calif	32 1/2
Standard Oil N. J.	32 1/2
Studebaker Corp.	33 1/2
Sunshine Mining	5 1/2
Swift & Company	23 1/2
Transamerica Corp.	18 1/2
Twentieth Century Fox	31 1/2
Union Oil Company	112 1/2
Union Pacific	31 1/2
United Airlines	31 1/2
United Aircraft	31 1/2
United Corporation	5 1/2
United States Plywood	32 1/2
United States Steel	14 1/2
Warner Pictures	43 1/2
Western Union Tel	26 1/2
Westinghouse Air Brake	36 1/2
Westinghouse Electric	43 1/2
Woolworth Company	43 1/2

Livestock

PORTLAND (AP) — Cattle salable 100; scattered sales steady; but most classes untested; load mostly good fed steers not yet shown; scattered lots utility heifers 22.00-27.00; canner and cutter cows mostly 15.00-18.00; utility cows 19.00-23.00; odd head young cows up to 24.50; commercial bulls 29.00; utility 26.00-28.00.

Calves salable 25.00; market active, steady; few choice vealers 34.00-37.00; utility and commercial grades 20.00-30.00.

Hogs salable 300; choice No. 1 butchers scarce; 1 load not yet shown. Few sales other grades and weights steady but most bids lower odd lots mostly choice No. 2 190-230 lb butchers 19.75-20.00; few No. 3 butchers and medium grades bid down to 19.00; few choice 270 lbs 19.00; 372 lbs 18.00; sows scarce; few choice around 400 lbs held above 17.00; medium grades down to 15.00; good and choice 138 lb feeder pigs 18.00; medium around 85 lb feeders 17.00.

Sheep salable 150; market about steady but bulk of supply unsold; 1 lot choice and prime 81 lb wooled lambs 28.25; choice 128 lbs 25.00; odd utility ewes 9.00; good slaughter ewes quotable around 12.50-13.00.

Chicago Livestock

CHICAGO (AP) — (USDA) — Salable hogs 10,000; unevenly 25 to mostly 50 cents higher on both butchers and sows; extremes up more; choice 180-220 lb 18.25-18.50; top 18.60 sparingly; most packer purchases 18.25 down; choice 230-240 lb 17.75-18.15; 250-270 lb 17.25-17.65; 280-310 lb 16.75-17.25; sows 14.0-16.50.

Salable cattle 2,500; salable heifers about steady; cows mostly steady with early Wednesday or as much as 25-50 cents higher than close that day; bulls and vealers steady to weak; load high-choice and prime 1,142 lb steers 37.25; most choice steers 33.00-35.75; commercial to low-choice grades 28.00-32.75; most good and choice heifers 31.00-34.50; utility and commercial bulls 25.50-29.00; good medium weight and heavy bulls 26.00-28.00; commercial to prime vealers 31.0-38.00; light culls down to 15.00.

Salable sheep 3,500; asking steady but bidding weak to 50 cents or more lower; double 107 lb choice to prime Iowa-fed yearlings including small two-year-old end 23.50; slaughter ewes steady to weak at 11.00 to 15.00 with culls 10.50 down to 9.00.

Portland Grain

PORTLAND (AP) — Wheat bid, to arrive market, basis No. 1 bulk, delivered coast: Soft white 2.50; soft white, excluding rex, 2.50; white club 2.50.

Hard red winter: Ordinary 2.52; 10 per cent 2.53; 11 per cent 2.53; 12 per cent 2.53.

Hard white baart: Ordinary 2.50; 10 per cent 2.50; 11 per cent 2.50; 12 per cent 2.50.

Wednesday's car receipts: Wheat 84; barley 5; flour 3; corn 7; oats 1; mill feed 3.

Potatoes

CHICAGO (AP) — (USDA) — Potatoes: arrivals 121, on track 29; total U.S. shipments 878; for Russia and washed Reds, demand good; market firm at ceilings; other stock, demand slow, market dull; let track sales: Idaho Russets \$5.65-66; bakers \$6.06; street sales according to basis of sale, per 100 lb: Colorado McClures \$5.51-61; Idaho Russets \$5.55-6.26.

Potato Ceilings Start Timed

Henry Witte, OPS representative from the Portland district office, has told Klamath County Agent Walter Jendrzewski that potato price ceilings begin "when the potatoes are put in containers."

In effect, he said, potatoes sold as a unit in the cellar, for instance, were not subject to the OPS price ceiling regulations.

The ceilings, on U.S. No. 1 inch-and-three-eighths minimum diameters, are 33.75 this month. Other grades, according to the OPS, including ungraded spuds, are a dollar per hundred less.

Obituary

KIRKPATRICK, 68, a native of Bridgeport, California and a resident of Klamath County for 33 years, died here February 7, 1952. Survivors include: the widow, Mrs. Lois S. Kirkpatrick and a son, Don C. of this city; a sister, Mrs. Alma Layman of Merrill, Ore.; two brothers, George of Malin, Ore. and George of Taylor, B. C.; 3 cousins, Hannah Hosack of Long Beach, Calif., Lella Karatter of Fullerton Calif., Mr. Kirkpatrick was a member of the World. Funeral arrangements will be announced later by Ward's Klamath Funeral Home.



LEAVES HEARING — Arthur H. Samish, portly California liquor and beer lobbyist, waves aside questions by newsmen as he leaves a closed session of the King house subcommittee now investigating irregularities in the San Francisco internal revenue bureau.



COOL MILLION — Actress Arlene Dahl wears the largest cut diamond in the world, the Transvaal Diamond, valued at one million dollars. Miss Dahl dazzled over 500 guests at a recent cancer benefit in Hollywood with the gem — the first time it has ever been worn publicly. It was brought to Hollywood to be used in a jungle film.

Weather

Western Oregon — Mostly cloudy in valleys of southern interior and partly cloudy elsewhere Thursday and Friday. Considerable night and morning fog. Highs Thursday and Friday 50 to 60 except 45 in southern interior. Lows Thursday night 32 to 40. Winds off coast variable and 8 to 15 miles an hour Thursday, becoming westerly to southwesterly and 10 to 20 miles an hour Friday.

Eastern Oregon — Partly cloudy in north and generally fair in south Thursday and Friday. Highs Thursday and Friday 42 to 52. Lows Thursday night 25 to 35 except 15 in higher valleys.

For the 24 hours to 4:30 a.m.

	Max.	Min.
Baker	36	16
Bend	55	29
Eugene	63	33
La Grande	43	17
Lakeview	43	17
Medford	42	32
North Bend	55	43
Ontario	39	22
Pendleton	58	42
Portland	55	35
Roseburg	61	32
Salem	54	33
Boise	46	24
Chicago	31	21
Denver	54	31
Eureka	55	43
Los Angeles	82	55
New York	44	38
Red Bluff	67	40
San Francisco	60	45
Seattle	51	41
Spokane	46	33

Man Admits Holdup Guilt

Thomas Patrick Schram, 28, admitted robbing Walter Vaughn, Oregon Food Store No. 2 manager, of \$476 with a toy pistol the night of Dec. 10, 1951.

"I wouldn't plead guilty to it, sir," Schram said to Circuit Judge David R. Vandenberg late this morning. "If I hadn't done it."

Schram has been in custody since 90 minutes after the robbery Dec. 10.

The following day Schram was charged with robbery, armed with a dangerous weapon.

NO GUN

Police never found the supposed gun, and recovered only \$252 of the loot when Schram was arrested at Wocus Tavern 90 minutes after the holdup.

Today the charge was changed to read "robbery, by putting in fear of force and violence, not being armed with a dangerous weapon."

In September, 1946, Schram was sentenced in Circuit Court here to two years on conviction of obtaining money by false pretenses.

He served eight months of the time, was released, but later served the full term on parole revocation.

In 1948 in Portland he was sentenced to two four-year terms on conviction of pulling two robberies with toy pistols. He was released from the State Prison only last August.

Schram also admitted being arrested in Vancouver, Wash., in 1948 for an attempted filling station robbery.

CONVICTIONS

"I was not prosecuted on that charge," Schram told the judge, "because they took me over to Portland and I was convicted on the two robberies."

"But I did the Vancouver job," he said. "I was caught 20 minutes after trying the holdup."

Judge Vandenberg said he would pass sentence when he returned to town. He is scheduled to leave town for several weeks.

Many people have wished they had fire insurance after the fire. Don't be one. Hans Norland Insurance, 627 Pine St. Phone 2-2515.

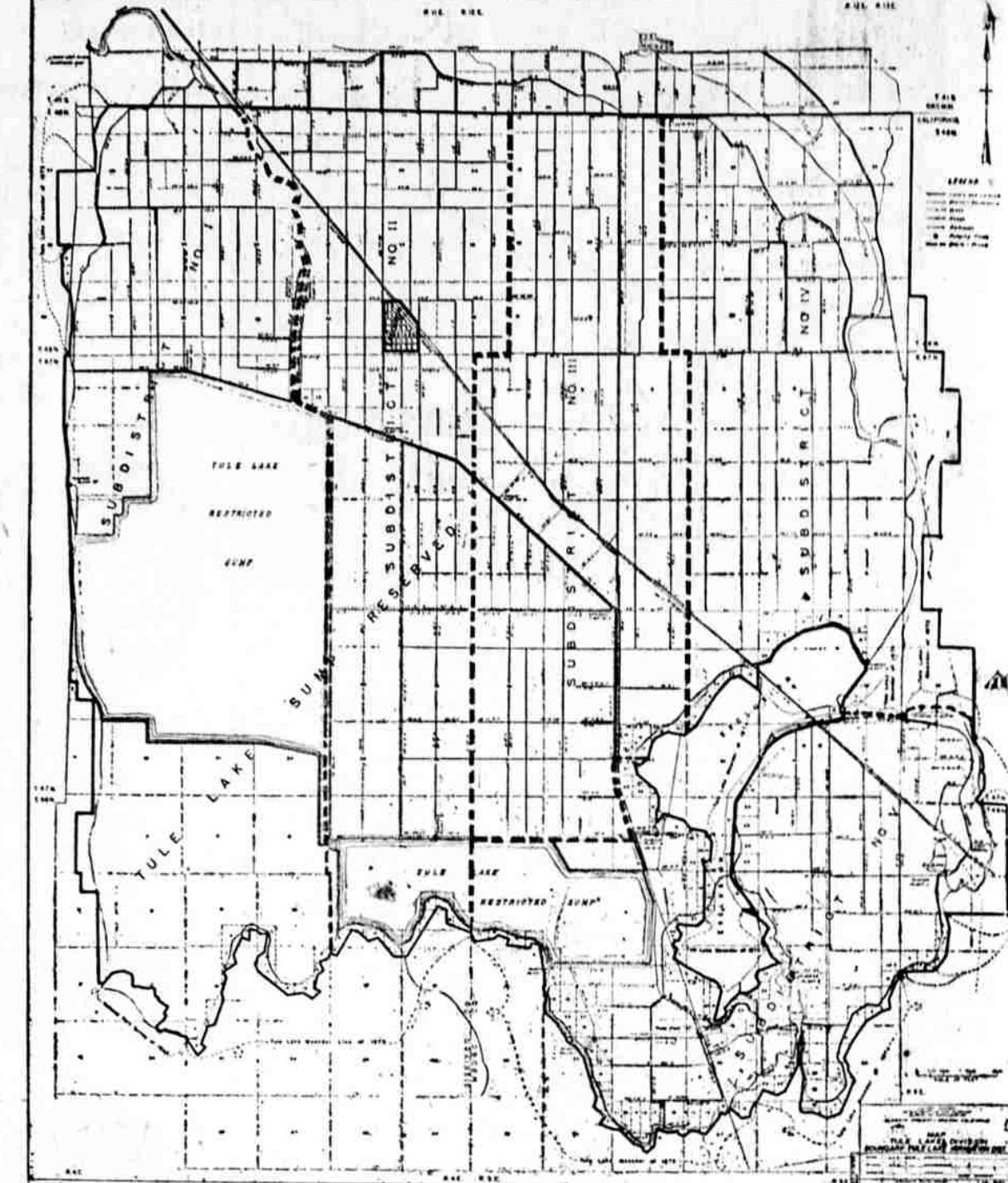

TULELAKE FARMERS step out Mar. 11 to vote for directors of the organizing Tulelake Water District. One director will be elected from each of the five subdistricts (divided by dotted lines in map above). The district follows the old meander line of Tulelake, but excludes the town of Tulelake itself. It includes some 93,000 acres. The district, in operation, would put the operation and maintenance under control of the water users themselves, instead of the Bureau of Reclamation, thus returning revenues to the district alone, and not the bureau.

Retail Beef Prices Down

PORTLAND (AP) — Declining cattle prices on the North Portland livestock market were reflected Thursday in lower retail beef prices.

Some beef prices were well below ceilings, with ground beef selling at 35 to 59 cents a pound. Rib and swiss steaks were as low as 85 cents, and rib roast 79.

Theodore T. Swenson, federal market reporter, said that the lower livestock market prices reflect an increased supply of beef throughout the country. Pork prices also are at a seasonal low.

Soil District Votes Counted

Ballots cast in the Langell Valley Soil Conservation District election Monday were being counted late this morning, and Polling Supvr. Basil Hall, Bly, said they would probably be finished early this afternoon.

The election would add three-quarters of a million acres of lands to the present 120,000-acre Langell Valley SCD if the proposed passes.

Approximately 70 ballots were cast.

EASIER NEW PIE CRUST

it's **GOLDEN FLAKE** good with **Snowdrift and Milk!**

Easier, tastier pie crust without any guess-work!

Start the usual way—cut in Snowdrift with all the flour. Extra easy with quick-blending Snowdrift, your emulsified shortening.

Now comes Snowdrift's wonderful new secret for sureness! This pie crust is made with milk—an exact amount—no guessing how much to add. Result: a crust rich in flavor and color with "golden flake" goodness clear through! Rolls neatly, too, between waxed papers.

You'll call this your "trusty crust" recipe! Just be sure you use Snowdrift—pure all-vegetable shortening.

RED CHERRY PIE with Snowdrift's New "Golden Flake" Pie Crust

Snowdrift with Milk gives you the crust you can trust every time—golden brown and rich in flavor!

- Yields a double-crust pie or lattice-top pie, or 2 pastry shells. Preheat oven to 425°.
- Mix in large mixing bowl 2 cups sifted all-purpose flour, such as Gold Medal.
- 1 teaspoon salt
- 1/2 cup Snowdrift using blender or knives, until mixture looks like coarse meal. Remove 1/4 cup (4 tsp.) for Step 2.

- Measure 1/2 cup milk and stir in 1/4 cup of the Snowdrift-flour mixture.
- Stir together and mix into the remaining Snowdrift-flour mixture to form dough. Press into a ball and flatten slightly.

- Roll half the dough between two waxed papers (12 inches square). Ease off top paper. Pick up bottom paper at top corners. Dough will cling. Place (paper side up) in 9-inch pie pan. Peel off paper; fit into pan. Trim. Add filling.

CHERRY FILLING: Drain 1 (No. 2) can red sour cherries; save juice. Combine 2 tbs. cornstarch, 1/4 to 1/2 cup sugar and dash salt. Stir in 1/4 cup canned cherry juice. Cook until thick and clear. Add 1 tsp. almond extract. Turn drained cherries into pie shell; add thickened juice and dot with 2 tbs. butter. Cover with lattice pastry. **TO MAKE LATTICE TOP:** Roll remaining dough as above. Peel off top paper. Cut into 1/4-inch strips. Wax strips crosswise on waxed paper. Pin quickly over filling. Seal ends without moistening and flute edge. Bake in hot oven, 425° F., about 40 minutes.

CELEBRATING Sperry 100th Anniversary - 1852-1952

PIONEER DAYS FOOD SALE

Sperry WHEAT HEARTS 28-oz. pkg.	29c
Sperry PANCAKE and WAFFLE MIX 4-lb. bag	53c
Sperry DRIFTED SNOW FLOUR 5-lb. bag	49c

PRODUCE SPECIALS

Tomatoes	tube	19c
Grapfruit	8-lb. bag	39c
Rhubarb	lb.	19c
Lettuce	lb.	9c
Green Peppers	lb.	19c
Broccoli	bun.	23c
Oranges	9-lb. bag	69c
Beets, Radishes or Green Onions	bun.	5c

Poteet's Market
Owned and Operated By Bob & "Peanuts" Poteet

Bratton's Best Leon **PICNICS** lb. **39c**

A GRADE BEEF ROAST lb. **65c**

Skinless **Wieners** lb. **49c**

Pure **LARD** 4 lb. Carton **75c**

Wesson OIL qt. **49c**
With coupon from Softasilk Cake Flour

Kerr's **Jam's 'n' Jellies** Pint Jars **HALF PRICE**

Hi Ho **CRACKERS** Pound Box **33c**
Sunshine

Orange **SLICES** lb. bag **25c**

Party Time **CHERRIES** No. 2 Cans **29c**

Durkee's **WHIPPED DRESSING** qt. **59c**

MAYONNAISE qts. **69c**

EGGS Grade A Large Fresh Ranch Eggs Doz. **59c**

JURGENSEN'S GROCERIES • PRODUCE • FROZEN FOODS
1710 Oregon Ave. Phone 3860

Free Delivery On \$5.00 Orders Or Over

INVESTMENT SECURITIES OWENS

INVESTMENT SERVICE
Listed, inactive, Unlisted and Over-the-Counter Bonds and Stocks. Investment Fees 100% Mod-Cons. Bldg. Phone 5-3426
KLAMATH FALLS