

Our Civilian Defense-- 'Dozen Men'

WASHINGTON, Oct. 1 (AP)—If American cities were attacked tomorrow the federal government would be ready with two civil defense planning organizations totaling about a dozen men who have no authority whatsoever.

Some states and communities have gone ahead with their own plans for rescue and protection of civilian populations in event of atomic or other aerial attack under plans tentatively outlined by the federal government a year ago and since put aside for new studies.

But the only civil defense planning groups in the federal set-up now are a study unit within the national security resources board consisting of a coordinator and one assistant, and a civil defense liaison office in the defense department made up of about ten men.

In a directive earlier this year, President Truman ended the office of civil defense planning created in March 1948 by the late Secretary of Defense James Forrestal. The plan for planning a national civil defense system to the NSRB, with William H. Gill named coordinator.

The office of civil defense planning was headed by Russel J. Hopley, Omaha Telephone company executive, and consisted of members and committees representing a cross-section of civilian and military life.

Responsibility

In November 1948, seven months after it was officially dissolved, this agency issued a report recommending that civil defense be a primary responsibility of local civilian organizations, with a federal agency guiding the program.

In addition, the office, working with state and municipal groups, prepared a program of legislation for introduction in congress and in state legislatures.

The report and program were turned over to the secretary of defense and to the president. The program was not introduced in congress. The matter remained dormant until Truman's directive ordered new studies to be made by NSRB.

Russ Influence?

There has been no indication whether the announcement that Russia has set off an atomic explosion will mean a speed-up in efforts to get a new program before congress.

The civil defense liaison office headed by Lt. Col. Barnet W. Beers is attempting to aid state and local defense organizations wherever possible through consultations and correspondence.

The NSRB unit is getting organized to expand its study staff for the preparation of new plans some of which presumably will retain features of the Hopley recommendations.

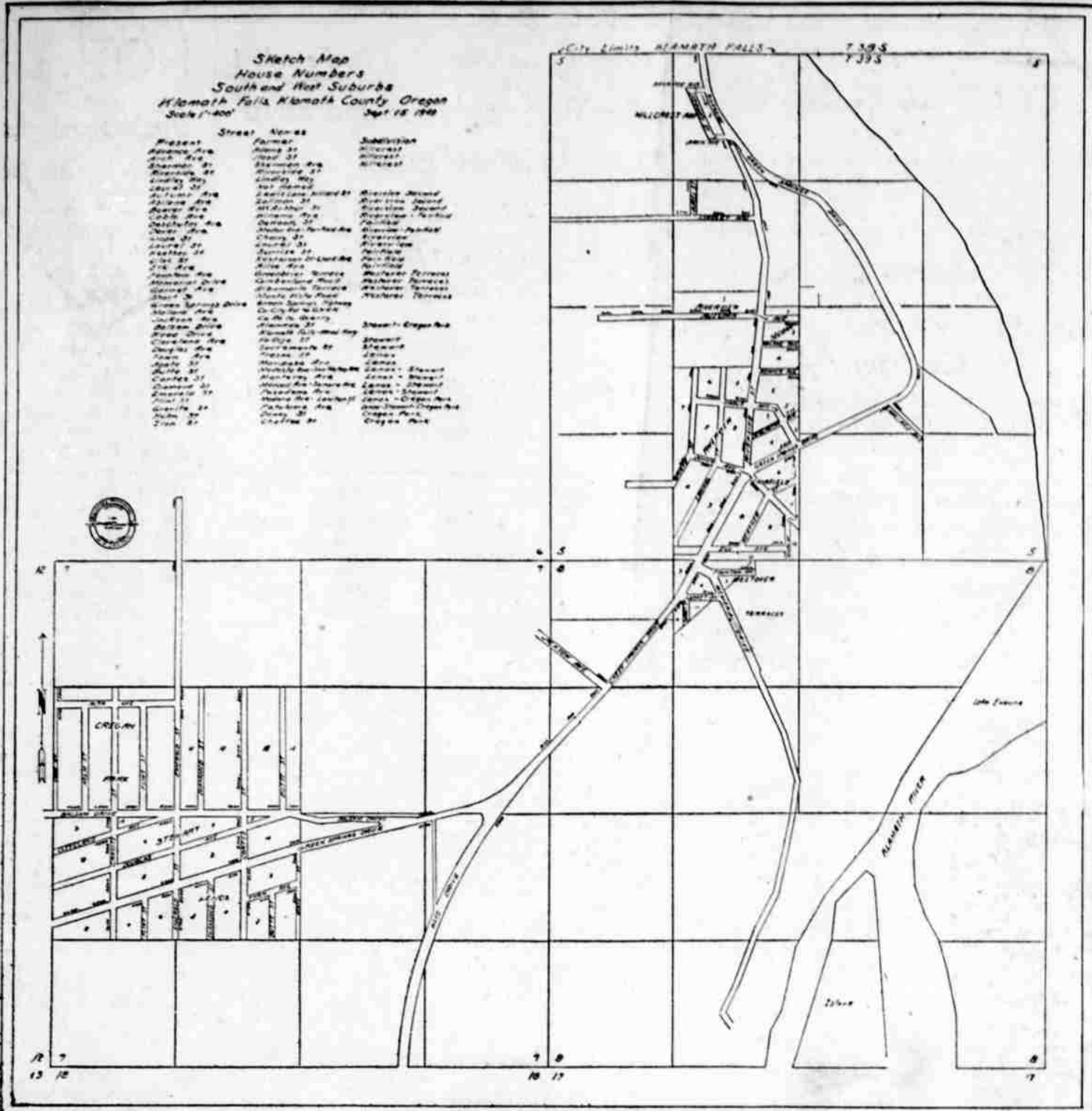

Official permission has been granted in the re-vamping of street names and numbers in the Lindley Heights, Riverview, Stewart-Lenox and Westover terraces residential sections.

In addition to making the location

of homes simpler, the new street names and numbers will enable residents to change from rural mail service to mounted city delivery.

The post office received authority to make the change Saturday, October 1.

Street signs are not yet up, but will soon be installed through co-operation of the state, county and individual residents.

Some streets in the areas have had unofficial names and others have never been named, so resi-

dents felt the best method was to completely rename streets and where possible to name them alphabetically.

The county court, planning commission and postal authorities have given their official approval to the plan.

William Canton did the engineering work required for the project, and Mrs. C. W. Adams was general chairman of the group of residents which worked out the plan. Working with Mrs. Adams were Harvey Wyatt, Glen Jones and Mr. Lewis Hornby.

Darwin Giles Dies at Canby

Darwin J. Giles, 52-year-old millwright at Ralph L. Smith Lumber company at Canby, died suddenly while on the job at 4 o'clock Friday afternoon. Death was attributed to a heart attack.

Mr. Giles made his home in Klamath Falls at 1539 Worden and is a former employee of Kesterson Lumber company here. He is survived by his wife, Anna, and a son, D. P. Giles, both of this city.

Mr. Giles had been with the Ralph L. Smith company since April of this year. Whitlock's will announce final rites.

Mother Keeps Children In Train's Path

GENEVA, N. Y., Oct. 1 (AP)—While a freight train bore down on them, Mrs. Fenton Stevens of Stanley, N. Y., and her four young children huddled in their automobile last night.

Stevens tried in vain to push the stalled car off the grade crossing. The locomotive struck. The car overturned and slid onto another track.

All lived to tell about it.

Mrs. Stevens, who is expecting another child, said she kept the children in the car because she feared the train would run over them if they jumped out. The children range in age from one to five.

The 25-year-old mother and the children were taken to a hospital. Attendants said no injuries were apparent.

Stevens was not hurt.

Machine Shaves Thin Slices

SCHENECTADY, N. Y. (AP)—Metal shavings so thin that they are transparent can be produced on a machine developed here.

The device is the work of Dr. E. F. Fullam of the General Electric laboratories, and it will produce a metal slice 1/500,000th of an inch thick.

Cutting metal so thin makes possible its study under the electron microscope.

Dim Moonshine Big Harvest Moon's Face To Be Darkened by Eclipse

By J. HUGH PRUETT
Astronomer, Extension Division, Oregon Higher Education System

NEXT Thursday evening (Oct. 6) the jolly face of the big harvest moon will for a while be darkened by the shadow of the earth. This eclipse, which will be total from 6:20 to 7:33 p.m. PST, 7:20 to 8:33 p.m. MST, 8:20 to 9:33 p.m. CST, will resemble in most respects the fine lunar "blackout" of last April 12.

The times of the various phases of the event this coming week will occur around an hour earlier than last spring, but so will the times of sunset and moonrise. The chances of viewing all stages of the eclipse are thus almost the same as then. Observers near the Pacific coast will miss the earlier part of the show since the moon will then not be above the eastern horizon. Moonrise will occur around 5:30 p.m., the exact time depending upon the latitude and longitude of the place concerned. Since the umbra, or dark shadow, will start to bite into the eastern side of the moon at 5:05 p.m. PST, a part of the lunar face will already be darkened at moonrise. The gradual increase to totality will then require almost another hour. Those farther east will be more fortunate.

Eclipse Timetable (October 6)

Moon enters penumbra . . . 3:50 p.m.
Moon enters umbra . . . 5:05 p.m.
Total eclipse begins . . . 6:20 p.m.
Total eclipse ends . . . 7:33 p.m.
Moon leaves umbra . . . 8:48 p.m.
Moon leaves penumbra . . . 10:03 p.m.
* Pacific standard time.

Killed Fliers Identified

McCLEARY, Wash., Oct. 1 (AP)—Three fliers killed in the crash of an air force C-82 "Flying Boxcar" near here Thursday night were identified yesterday by authorities at their McChord home base.

They were Capt. Burton A. Reeves, 25, Brownwood, Tex.; Second Lt. Troy V. Martin Jr., 21, Orlando, Fla.; and T-Sgt. Cleo Quarrels, 28, Diboll, Tex.

Their bodies were recovered yesterday from the charred wreckage of the twin-engine cargo plane on a ridge close to the junction of Grays Harbor, Mason and Thurston counties.

State Cities Meet Closing

PORTLAND, Oct. 1 (AP)—The League of Oregon Cities will close its annual session here today with election of officers.

The Oregon Finance Officers' association, which held joint sessions with the league, wound up its meetings yesterday by naming J. O. Bredemeier, Portland, as president.

George M. Baldwin, Portland, was elected first vice president, and Henry Beistel, Eugene, second vice president.

Among those named to the board of directors were M. B. Winslow, Grants Pass, and Grace Shiska, Eugene.

Girls Camp Out In Kimball

The Wa-Han-Ka Camp Fire group of Fairview school recently went on an overnight camping trip to Kimball park. The outing was arranged to aid the girls in acquiring their wood gatherers' ranks.

Taking part were Betty Barrett, Susan Derby, Twila Greene, Carol Herman, Charlene Hood, Carol Larson, Patricia Ann Phillips, Verla Tibbetts, Roberta Tuttle and Patty Vigen. They were accompanied by Mrs. Orville Herman, their leader, Mrs. Earl Greene, assistant leader, and Mrs. Roger Kirkpatrick.

Eppersons Return From Abroad

Mr. and Mrs. A. B. Epperson, 130 N. 1st, returned Friday afternoon from a visit in England, France, Switzerland and other points on the continent.

They were guests of their son and family, Capt. and Mrs. George M. Epperson and twin daughters, Janice and Carolyn, in London where Capt. Epperson has been stationed. The two families enjoyed four days in Paris, and from there Capt. Epperson and family returned to London and his parents went on to Switzerland.

The Eppersons made the trip both ways by air. They left here six weeks ago.

Mystery Gem Tiny Diamond with Curse Found to Be Radioactive

By ALTON L. BLAKESLEE
Science Reporter

NEW YORK—How would you like a diamond with a curse? This diamond is radioactive—so much so that it's dangerous to wear it. Rays shooting out from it can kill living flesh and bone. The gem will take its own picture just by being placed against photographic film.

The diamond is small, weighing less than one carat. But scientists say it is four times more radioactive than a comparable mass of pure uranium or thorium.

How the stone got that way is a mystery. John A. Hardy, a consulting engineer, tells about it in "Gems and Gemology," journal of the Gemological Institute of America.

Originally the diamond had a deep lively green color, he said. It came from Belgium in 1938, but he doesn't know anything more about its history.

The green color changed suddenly to a golden yellow in 1940 when jeweler accidentally heated the stone too much while shaving down its heavy setting. After scientist inspected it, the owner's wife immediately stopped wearing it. The radioactivity had already started to attack the calcium in the bone of her finger.

University of Michigan scientists found the diamond is shooting out electrons and alpha particles, which are the nuclei or cores of helium atoms. Its radioactivity is apparently due to one form of radium, they said.

One possible explanation is that the diamond had once been packed close to radium or radon in the earth. Heavy atomic centers or nuclei from the radium penetrated deep into the diamond.

At Harvard, it was found that diamonds, which are pure carbon, will change to a green color and become radioactive when they are bombarded with deuterons in a cyclotron. Hardy's stone was bombarded at the University of Michigan in 1942, and it changed back to its original green color. It has kept that color since.

Oregon Harbors Revamping OK'd

VANCOUVER, Wash., Oct. 1 (AP)—Proposed improvement of three Washington harbors and another in Oregon drew approval yesterday of the Northwest rivers and harbors congress.

The harbors are: Port Townsend, Snohomish river, Willapa river and Yaquina bay. The last is in Oregon.

The port commission officials from Oregon and Washington cities also commended army engineers' program.

The engineers reported \$64,500,000 in federal money had been spent on Oregon and Washington rivers, harbors and for flood control work this year.

MEET FRANK DRISCOLL . . .



our **HOUSEHOLD GOODS Moving Expert!**

Frank has been with OK nearly 30 years. He will estimate, pack your goods for moving or storage; in fact, take care of all your moving problems!

Estimates gladly . . . Phone 4168

PADDED VANS—MOVING IN OREGON, WASHINGTON, CALIFORNIA, OR ANY PLACE IN THE WORLD!

OK TRANSFER

Search for Words

Bibles for the World - - It's a Tough, Tedious Job

By SHERRY BOWEN

NEW YORK (AP)—Suppose you tried to translate the Bible into a language in which you could find no word for "love."

That was the problem one man faced, says Miss Margaret Hill, librarian of the American Bible Society. He finally heard a mother use a word when she talked to her child. She said, "This is the word I use when I mean that I care so much for this little girl of mine that when I think of what is going to befall her when she grows up it hurts me." He had found his word. It meant, literally, "To care so much it hurts."

And how would you translate the vines of the Bible in a land where vines are useless? In one language "tasting death" would mean "chewing a corpse." In another "will of the flesh" denotes a prostitute. In another a word in one tone means "to laugh." When another tone is used it means "to weep."

Tough Task

The man who first writes the Bible in a language has one of the largest tasks in the world, says Dr. Eugene A. Nida, the Bible Society secretary for versions. "He is handling the very souls of his fellow men."

Some people have no food made of wheat. Thus "Give us this day our daily bread" would have no meaning. Dr. Nida says ancient Greeks lay down to eat. In the Greek text people "recline to eat." The English text says they "sat down to eat." In the same way texts must gain meaning from the life of the people. Sometimes they have no beds, no chairs. Thus, in some cases, the throne of God becomes a "stool." In one tribe men sit on stools, but rest their feet on sticks. And "God's footstool" becomes "God's footstick."

Millions Printed

Last year, the American Bible Society had almost 10 million Bibles and parts of Bibles printed, says Dr. Eric M. North, the secretary. The society works with the United Bible Societies in which 24 groups from all over the world, distributed 17,508,464 Bibles and parts of Bibles. The society also works with 40 denominations in America. Church missionaries use society books. Church funds help the society. Church men do much of the translating.

The most important work of the society is not at Bible House on Park Avenue here, says Dr. North. Nor is it found in other Bible Houses in many cities of the world. "The major work is done where the man without the Scriptures is met by the man with the Scriptures."

That meeting may come on the frozen tundra north of the Arctic Circle. It may be in the rain and heat of the jungle or among the towering peaks of the Andes. It may be in the streets and offices of great cities or between the corn or cotton rows on the farm.

Books Necessary

But for those meetings to take place there must be the books. It may be the whole Bible. It may be a translation of one of the Gospels or just the Sermon on the Mount.

In some cases, salesmen from the society are in the field long before missions are there. In other cases faith comes only after men have read their Bibles for themselves in their own language. Hence the need for translations. Some part of the Bible has been translated into 1108 languages. These languages are used by nine tenths of the people of the world, says Miss Hill.

But there is still much work to be done. Most people in the world have never heard that there is a published Word of God, she says. And there are still about 1000 languages which do not have Bibles and in which they may some day be printed. Some part of the Bible is put into about 10 new languages a year.

Reading Taught

Another vital part of the work is to teach people to read so that they can read their Bibles once they are in print, says Miss Hill. And of the 1108 languages in which the Bible has been translated, most were first written down for the Bible. Thus, she sees one phase of the work

as making men more modern. They are given a written language and taught to read it.

"And the Bible in print is a machine product," says Dr. North. "Often we try to take it to countries where people are primitive or whose economy is farm centered. It can have a fabulous cost for a man who never sees more than \$70 a year."

30 CENTS A Day

A milder example is Brazil. There, he says, a day's wage is 70 cents. A Portuguese Bible there costs \$125. In America an English Bible can be printed for \$1.00 or less. "If a man here paid in proportion his Bible would cost \$14 or \$15 or more. This is one of the reasons for Bible societies," he says. "We try to wipe out some of that difference."

He says the sales price of the books pays about one-third of the society's costs. Some Bibles are given to poor people who want them. This is done often for those who lost all in the war. But most Bibles are sold. The aim is to make people want the Bible. If they pay, they show they want it even if they pay less than the cost.

And in spite of all the work of Bible societies there is a world wide shortage of Bibles. Dr. North says. From China, Japan, Germany, the jungles, mountains and plains men are calling for more books. In China last year Bibles were flown in to areas cut off by Red drives. "Please send us scriptures," was the word sent out from Loyang which had been cut off for months. "Bibles were put ahead of money to relieve their poverty," says Dr. North.

Bible Black Markets

There are even black markets in Bibles, he says. Sometimes men write to Americans whose names they learn and beg for Bibles. In some cases they use the Bibles they get just as something to sell. The latest rash of such letters has come from Liberia. But other countries may get the idea. Dr. North suggests that those who wish to give Bibles do so through their own church or through a Bible society they know to be reliable.

Senator William Blount of Tennessee was named in the first impeachment proceedings before the Senate in 1798 and the charge were dismissed for want of jurisdiction.

Expert CARPET LAYING by Specialists

The most perfectly designed carpet placed in the most fastidiously furnished room if improperly laid is just a covering for the floor—nothing more! To match the decor . . . to enhance the style . . . to blend with the theme a carpet must be carefully and exactly laid—by trained specialists.

Our experienced craftsmen take pride in their work . . . pride in making every job a finished job . . . every carpet a credit to their skill.

Calhoun's FLOOR COVERINGS

317 E. Main Ph. 8493
The largest stock of Quality floor coverings in the Klamath Basin



Keep that Wolf from the Door

Many methods have been devised and followed with the purpose of keeping the wolf from the door. Personally we are inclined to believe that the buying of insurance is the best and cheapest of them all. Of course, since that is our profession we may be prejudiced to some extent, but there is a lot of common sense in the statement—Insure and be sure. We even go further and suggest that you be sure to insure with this agency.

Our advice costs you nothing and places you under no obligation.

GEORGE E. WOOD - GRAYCE RUSCO Associates

m. JOHNSON General Insurance
412 MAIN ST.
Ph. 5113-5114-7119

Announcing . . .

The Association of **JOHN SHAW**
As Real Estate Salesmen
With The **NEAL STEWART Agency**

119 So. 6th REALTOR Phone 9259

I.P.T.A. PIANO LESSONS
TIME NOW AVAILABLE

Mrs. E. L. Gray . . . Malin
Member I.P.T.A.