

HITS COP, GOES TO HOSPITAL

When Earl Holland slugged City Patrolman J. P. McDonald the latter was urging him to go home and "sleep it off" Saturday night. He slugged the wrong man. Instead of turning the other cheek, McDonald retaliated so forcefully that Holland is now in a local hospital recovering from the effects of the blow. When he gets out he will be brought before the police court and charged with being drunk and hitting an officer. McDonald was not the only patrolman forced to use summary measures Saturday night to effect an arrest. On the knuckle of Patrolman Solomon is a large contusion testifying to a little physical persuasion.

According to the officers, force is often required in making an arrest. Most of the arrests are for drunkenness and some men in a drunken state are pugnacious.

In the police court yesterday, Ole Wilson, Joe Durvin, John Wallen, Nels Quantstrom and Jo Picket were all fined \$20 on the charge of being drunk.

EVENING HERALD
CLASSIFIED AD RATES
First insertion.....per line 10c
Two insertions.....per line 15c
Three insertions.....per line 20c
Four insertions.....per line 25c
Week (6 times).....per line 30c
One Month.....per line 70c

NEW TODAY

WANTED—Mr. Chastian of the Medford Fluff Rug Works is in Klamath Falls and wants your order for fluff rugs. Phone 95. 29*

YOUR WORN CARPETS or Rugs make good fluff rugs. Phone 95 for the Medford man. 29*

WANTED—Girl or woman to care for two children from 8 to 6 and help with housework. Phone after 5:30, 245-R. 29-30

WANTED—To learn marcelling. Monclair Beauty Shoppe. 284t

WANTED—Woman wants laundry work to do at home. Rough dry and finish. Phone 121-W. 29

WANTED—To borrow five hundred dollars. Will give \$20 acre ranch for security. Box 329 Herald Office. 29-30*

FOR RENT—Furnished room. 505 N. 9th. 29t

FOR RENT—Unfurnished apt. Phone 339-J. A. 29-M. 13. 29t

FOR RENT—Nice large furnished sleeping room. 119 Washington. Phone 542-R. 29-30*

FOR RENT—4-room modern house. Inquire at 911 Prospect Ave. 221f

FOR RENT—2 furnished appts. 419 N. 10th St. 231f

MISCELLANEOUS
CARPENTER wants work. Day or contract. Call at 137 N. 8th St., evenings. 24-M. 1*

We have the cash to pay for your Second Hand Furniture. Groves & Ranges. Phone 755. O. K. Furniture Co., 122 N. 6th St. 21t

TRIANGLE CAFE—The place to get good eats. OPEN ALL NIGHT. 633 Main street, phone 624. 741f

Z. PETERS, accredited Teacher, piano and violin, all other instruments taught also. 748 Broad St., near 6th. Saturdays, Sundays and Mondays. A. 14-M. 1t

LET GEORGIN fit up your little cozzy home at a reasonable price. Phone 605-M. 624 Klamath Ave. Apr. 16—May 19 Inc. 28-30*

DRESSMAKING and Dressing by expert. Mrs. H. T. Lundman, 927 South Sixth, Klamath Falls. Apr. 28-May 3. 28-30*

PASTURE FOR STOCK—Blue grass, running water. Four miles out on Spring Lake road. Fred Peterson. 28-30*

SEE ME FOR Estimates, plans and specifications. Immediate service. Any kind of building. Jas. L. Crisman, General Contractor, Phone 479-J. 28-30*

NEW AND OLD Buildings Built and remodeled. Jan. L. Crisman, General Contractor, Phone 479-J. 28-30*

REAL ESTATE
HOUSE FOR SALE—Could be made into 5 rooms. Cheap for cash or will consider small car as part payment. 2105 Radcliff Ave., Mills addition. 26-29*

FOR SALE—Modera 6 room house, garage, large lot. Close in. \$2000 cash. Terms on balance. Box M, 6 E. Herald Office. 28-30*

FOR SALE or will Exchange for Klamath Falls income property, my beautiful home near Santa Cruz, Cal., consisting of eight acres of land, modern eleven-room house completely furnished, orchard consisting of about all varieties of fruit that grows in this climate, creek of running water. Place must be seen to be appreciated. Address B. B. Kern, R. F. D. 1, Box 312, Santa Cruz, Cal. 28-29*

MOM'N POP



"CORA GUESSES RIGHT"



BY TAYLOR



POULTRY

FOR SALE—S. C. White Leghorn baby chick from heaviest laying strains. \$10.00 per 100. Safe delivery guaranteed. Model Poultry Farm, Corning, Calif. Apr. 19—May 19, Inc.

CERTIFIED BABY CHICKS—White and Brown Leghorns, Barred Rocks, R. I. Reds, Black Minorcas. Now booking for spring delivery. All flocks certified by the Glenn County Poultry Bureau. Prices on application. Grand Hatchery, Orland, Glenn Co., Calif. 184t

FOR SALE—A good used corner and cheap winners jewelry store. 282t

FOR SALE—Mammoth overbearing strawberry plants. J. S. Goldworthy, 502 Doty St. Phone 223-W. 26-29

FOR SALE—Grocery store. Owner in poor health. Rent \$25. South 6th and East Main. Mills 2nd addition. Terms Cash. H. W. Clark. 26-M. 2*

FOR SALE—Good paying restaurant at Chiloquin. Doing good business. Apply at Quick Lunch restaurant. 28-3t

FOR SALE—A few more lots left at \$100—\$10 down. \$5 a month. Fred Buehing, 1020 Main St. 28-2*

FOR SALE—First Class hot air Boynton garage, including lots of pipes, also floor grates. 213 Cedar St., cor. Pine. Phone 516. 211f

FOR SALE—PAY LIKE RENT HUNGALOWS H. H. Masley, 703 9th St. Apr. 1—May 1 Inc. 29-30

WANTED—To rent, by April 1, 4 or 5-room, furnished or partly furnished house, close in. Phone 411-W. 141f

WANTED—Steady work on ranch by married man. Box C. N. Herald Office. 26-29

WANTED by woman, experienced in camp cooking, wants cooking job or day work. Good recommendations. Mrs. Viola Wheeler, 626 N. 9th St. or Gen. Delivery. 81f

WANTED—Man and wife in restaurant as cook and waitress. State salary desired. Call evenings. Phone 22, Chiloquin. 28-30*

WANTED—Sewing, nursing or housework. Box S. N., Herald Office. 28-30*

LOST AND FOUND
LOST—Saturday, carrier boy's collection book for Route No. 4. Please return to Herald Office, 100t

LOST—Goodyear cord tire and run, 50x3 1/2. Leave at Mecca Pool Hall. Reward. 28-30

LEGAL NOTICES
SUMMONS FOR PUBLICATION.
IN THE CIRCUIT COURT OF THE STATE OF OREGON FOR KLAMATH COUNTY.

Equity No. 1759.
Emma G. Bond, plaintiff, vs. Nathan E. Bond, defendant.
To Nathan E. Bond, defendant above named:

IN THE NAME OF THE STATE OF OREGON, You are hereby required to appear and answer the complaint filed against you in the above entitled suit on or before June 10, 1924, that being the last day of the time prescribed in the order for publication of this summons. And if you fail so to answer or appear, for want thereof, the plaintiff will apply to the Court for the relief prayed for in her complaint on this behalf, to-wit: For a decree of this Court dissolving the bonds of matrimony now existing between plaintiff and defendant, and decreeing that defendant herein has no interest in or claim upon the real property owned by plaintiff, to-wit:

Situate in Klamath County, Oregon: 28 feet of the Easterly side of Lot Three of Block 16 of Original town, now the City of Klamath Falls, Oregon, said parcel being in rectangular form 28 feet by 100 feet, and having a frontage of 28 feet on Main Street of said City; and for such other and further relief as to the Court may seem equitable.

This summons is served by publication thereof in the Evening Herald, a daily newspaper, printed, published and of general circulation in Klamath County, Oregon, by order of W. C. Van Emon, Attorney at Law, 204-5 Hart Building, Klamath Falls, Oregon. A. 8-15-22-29, M. 6-13-20.

SUMMONS FOR PUBLICATION
IN THE CIRCUIT COURT OF THE STATE OF OREGON FOR THE COUNTY OF KLAMATH.

Equity No. 1760-E.
Stanley W. Dwinell, plaintiff vs. James Wilson and Jane Doe Wilson, husband and wife, and all persons unknown having or claiming to have any right, title or interest in the property described in plaintiff's complaint, defendants.
To James Wilson and Jane Doe

LEGAL NOTICES

made and entered April 28th, 1924, which said order requires that this summons be published once a week, for six weeks. The date of the first publication of this summons is April 29, 1924.
R. C. GROESBECK, Attorney for Plaintiff, Klamath Falls, Oregon. A. 29—M. 6-13-20-27—J. 3-10

NOTICE FOR FINAL SETTLEMENT
Notice is hereby given that the undersigned administrator of the estate of James Vernon Houston, deceased, has filed in the County Court of the State of Oregon for Klamath County the final account of his administration of said estate, and said Court has fixed June 2, 1924, at 3 o'clock p. m., as the time and the Court room of said Court as the place for the hearing of said final account and the settlement of said estate.
B. L. COOK, Administrator of the estate of James Vernon Houston, deceased. Dated: April 29, 1924. A. 29—M. 6-13-20-27

NOTICE TO CREDITORS.
Notice is hereby given that the undersigned has been duly appointed administrator-with-the-will-annexed of the estate of Charles P. Stewart, deceased, by the County Court of the State of Oregon for Klamath County, and all persons having claims against said estate are notified to present same to said administrator at the law office of R. C. Groesbeck, American National Bank Building, Klamath Falls, Oregon, within six months from the date of this notice. Dated: April 29, 1924.
BERNARD M. CHILCOTE, Administrator with the will annexed of the estate of Charles P. Stewart, deceased. A. 29—M. 6-13-20-27

SUMMONS FOR PUBLICATION
IN THE CIRCUIT COURT OF THE STATE OF OREGON FOR THE COUNTY OF KLAMATH.

Equity No. 1758-E.
W. C. Van Emon, Attorney at Law, 204-5 Hart Building, Klamath Falls, Oregon. A. 8-15-22-29, M. 6-13-20.

NOTICE TO CREDITORS.
Notice is hereby given that the undersigned has been duly appointed administrator of the estate of Oliver S. Lovelady, deceased, by the County Court of the State of Oregon for Klamath County, and all persons having claims against said estate are notified to present same to said administrator at the law offices of R. C. Groesbeck, American National Bank Building, Klamath Falls, Oregon, within six months from the date of this notice.
A. J. LOVELADY, Administrator of the Estate of Oliver S. Lovelady, deceased. Dated: April 22, 1924. A. 22-29—M. 6-13-20

EVERETT TRUE By CONDO
— AND WHILE I WAS THERE, MR. TRUE, I HAD A WONDERFUL DELIGHTFUL TIME. IT'S A QUANT LITTLE TOWN SEQUESTERED AMONG THE WOODED HILLS. IT'S COMPOSED OF A POPULATION OF ABOUT 500 SOULS. THEY HAVE, HOWEVER, AN HOTEL.

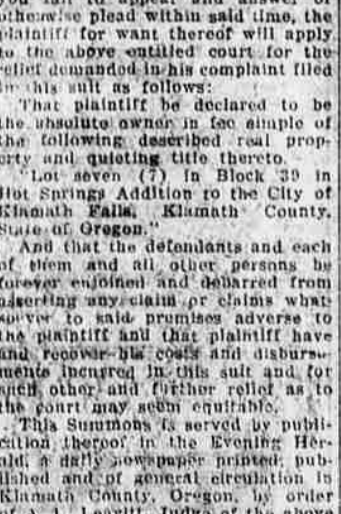

HOPE THEY HAVE AN HOTEL! LET US HOPE IT WON'T BE LONG TILL THEY HAVE AN THEATER, AN PUBLIC LIBRARY, AN HOSPITAL, AND BY ALL MEANS AN BUGH-HOUSE BEFORE YOU GO THERE AGAIN!!!

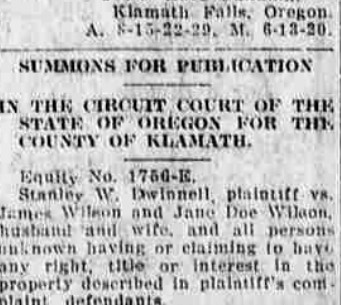

LEGAL NOTICES

Wilson, husband and wife, and all persons unknown having or claiming to have any right, title or interest in the property described in plaintiff's complaint, defendants.
IN THE NAME OF THE STATE OF OREGON: You and each of you are hereby summoned and required to appear and answer the complaint filed against you in the above entitled suit on or before May 20, 1924 and within six (6) weeks after the first publication of this Summons in the Evening Herald, a daily newspaper published in Klamath Falls, Oregon, and of general circulation in said county.
And you will take notice that if you fail to appear and answer or otherwise plead within said time, the plaintiff for want thereof will apply to the above entitled court for the relief demanded in his complaint filed in this suit as follows:
That plaintiff be declared to be the absolute owner in fee simple of the following described real property and quieting title thereto:
Lots one (1) and two (2) of Block 74, in Klamath Addition to the City of Klamath Falls, situate in Lot four (4) of Section 32, township 35, south range nine (9) East Willamette Meridian, Klamath County, Oregon.
And that the defendants and each of them and all other persons be forever enjoined and debarred from asserting any claim or claims whatsoever to said premises adverse to the plaintiff and that plaintiff have and recover his costs and disbursements incurred in this suit, and for such other and further relief as to the court may seem equitable.
This Summons is served by publication thereof in the Evening Herald, a daily newspaper printed, published and of general circulation in Klamath County, Oregon, by order of A. L. Leavitt, Judge of the above entitled Court, made and entered on the 7th day of April, A. D. 1924, which said order required that the Summons be published at least once a week for six successive weeks beginning on the 8th day of April, A. D. 1924, the last publication being May 20, 1924.
W. C. Van Emon, Attorney at Law, 204-5 Hart Building, Klamath Falls, Oregon. A. 8-15-22-29, M. 6-13-20.

ADMINISTRATORS NOTICE OF FINAL ACCOUNT.
In the County Court of Klamath County Oregon.
In the matter of the estate of Ellen Mason, deceased.
Notice is hereby given that I have filed my final account as administrator of the Estate of Ellen Mason, deceased, and the Court has set May 24th, 1924, at three o'clock p. m., as the time for hearing objections to such final account and for the settlement thereof.
Dated this 22nd day of April, 1924.
BURGE W. MASON, Administrator. A. 22-29—M. 6-13

NOTICE TO CREDITORS.
Notice is hereby given that the undersigned has been duly appointed administratrix of the estate of Ben P. Lewis, deceased, by the County Court of the State of Oregon for Klamath County, and all persons having claims against said estate are notified to present same to said administratrix at the law offices of R. C. Groesbeck, 116 South 6th Street, Klamath Falls, Oregon, within six months from the date of this notice.
HATTIE V. LEWIS, Administratrix of the Estate of Ben P. Lewis, deceased. Dated: April 22, 1924. A. 22-29—M. 6-13-20

NOTICE OF SALE
Notice is hereby given that in pursuance of an order made by the county court of Klamath County, Oregon, dated March 29th, 1924, in the matter of the Estate of Hugh L. Clopton, deceased, the undersigned administrator will sell at private sale to the highest bidder for cash, all the right, title, interest and estate of said deceased in and to the following:
The easterly 75 feet of Lots 1 and 2, and all of Lot 3 in Block 4 of Original Town of Bonanza, Ore.; also beginning at NE corner of Block 13 of First Addition to Town of Bonanza, Oregon, thence west 170 feet, thence south 75 feet, thence east 120 feet, thence northerly 90 feet to place of beginning; also, Lots 13 and 14 of Block 60 of Grandview Addition to Bonanza, Oregon.
Said sale will be held on and after the 31st day of March 1924, and bids will be received by the undersigned at Sprague River, Oregon, or by Allan Sloan, deputy county clerk at Klamath Falls, Oregon.
Claude O. Clopton, Administrator. A. 8-15-22-29, M. 6-13-20

SUMMONS FOR PUBLICATION
IN THE CIRCUIT COURT OF THE STATE OF OREGON FOR THE COUNTY OF KLAMATH.
Equity No. 1757.
J. T. Perkins, plaintiff, vs. J. A. Sharp and Christina Marshall Sharp, husband and wife, Geo. W. Sharp and Sarah Doe Sharp, husband and wife, James F. Sharp and Anna Roe Sharp, husband and wife, Wm. Sharp and Alice Roe Sharp, husband and wife, Earl E. Sharp and Christine Sharp, husband and wife, Thomas L. Sharp and Margaret Roe Sharp, husband and wife, Katherine Scott and James Doe Scott, husband and wife, John Donner and Lulu Donner, husband and wife, Alonzo Barnes and Dora Doe Barnes, husband and wife, Wm. Hills and Wm. Doe Hills, husband and wife, Mrs. Walter Davis and Walter Doe Davis, husband and wife, Richard Roe Yost and Elizabeth Yost, husband and wife, John Doe Marshall and Christina Marshall, husband and wife, W. B. Finnell and Mary Doe Finnell, husband and wife, and all persons unknown, having or claiming to have any right, title or interest in and to the property described in plaintiff's complaint, and all persons unknown as heirs or devisees of any deceased defendant claiming to have any interest in and to the property described in plaintiff's complaint, defendants.
To J. A. Sharp and Christina Marshall Sharp, husband and wife, Geo. W. Sharp and Sarah Doe Sharp, husband and wife, Wm. Sharp and Alice Roe Sharp, husband and wife, Earl E. Sharp and Christine Sharp, husband and wife, Thomas L. Sharp and Margaret Roe Sharp, husband and wife, Katherine Scott and James Doe Scott, husband and wife, John Donner and Lulu Donner, husband and wife, Alonzo Barnes and Dora Doe Barnes, husband and wife, Edith Hills and Wm. Doe Hills, husband and wife, Mrs. Walter Davis and Walter Doe Davis, husband and wife, Richard Roe Yost and Elizabeth Yost, husband and wife, John Doe Marshall and Christina Marshall, husband and wife, W. B. Finnell and Mary Doe Finnell, husband and wife, and all persons unknown, having or claiming to have any right, title or interest in and to the property described in plaintiff's complaint, and all persons unknown as heirs or devisees of any deceased defendant claiming to have any interest in and to the property described in plaintiff's complaint, defendants.
To J. A. Sharp and Christina Marshall Sharp, husband and wife, Geo. W. Sharp and Sarah Doe Sharp, husband and wife, James F. Sharp and Anna Roe Sharp, husband and wife, Wm. Sharp and Alice Roe Sharp, husband and wife, Earl E. Sharp and Christine Sharp, husband and wife, Thomas L. Sharp and Margaret Roe Sharp, husband and wife, Katherine Scott and James Doe Scott, husband and wife, John Donner and Lulu Donner, husband and wife, Alonzo Barnes and Dora Doe Barnes, husband and wife, Edith Hills and Wm. Doe Hills, husband and wife, Mrs. Walter Davis and Walter Doe Davis, husband and wife, Richard Roe Yost and Elizabeth Yost, husband and wife, John Doe Marshall and Christina Marshall, husband and wife, W. B. Finnell and Mary Doe Finnell, husband and wife, and all persons unknown, having or claiming to have any right, title or interest in and to the property described in plaintiff's complaint, and all persons unknown as heirs or devisees of any deceased defendant claiming to have any interest in and to the property described in plaintiff's complaint, defendants.
To J. A. Sharp and Christina Marshall Sharp, husband and wife, Geo. W. Sharp and Sarah Doe Sharp, husband and wife, James F. Sharp and Anna Roe Sharp, husband and wife, Wm. Sharp and Alice Roe Sharp, husband and wife, Earl E. Sharp and Christine Sharp, husband and wife, Thomas L. Sharp and Margaret Roe Sharp, husband and wife, Katherine Scott and James Doe Scott, husband and wife, John Donner and Lulu Donner, husband and wife, Alonzo Barnes and Dora Doe Barnes, husband and wife, Edith Hills and Wm. Doe Hills, husband and wife, Mrs. Walter Davis and Walter Doe Davis, husband and wife, Richard Roe Yost and Elizabeth Yost, husband and wife, John Doe Marshall and Christina Marshall, husband and wife, W. B. Finnell and Mary Doe Finnell, husband and wife, and all persons unknown, having or claiming to have any right, title or interest in and to the property described in plaintiff's complaint, and all persons unknown as heirs or devisees of any deceased defendant claiming to have any interest in and to the property described in plaintiff's complaint, defendants.
To J. A. Sharp and Christina Marshall Sharp, husband and wife, Geo. W. Sharp and Sarah Doe Sharp, husband and wife, James F. Sharp and Anna Roe Sharp, husband and wife, Wm. Sharp and Alice Roe Sharp, husband and wife, Earl E. Sharp and Christine Sharp, husband and wife, Thomas L. Sharp and Margaret Roe Sharp, husband and wife, Katherine Scott and James Doe Scott, husband and wife, John Donner and Lulu Donner, husband and wife, Alonzo Barnes and Dora Doe Barnes, husband and wife, Edith Hills and Wm. Doe Hills, husband and wife, Mrs. Walter Davis and Walter Doe Davis, husband and wife, Richard Roe Yost and Elizabeth Yost, husband and wife, John Doe Marshall and Christina Marshall, husband and wife, W. B. Finnell and Mary Doe Finnell, husband and wife, and all persons unknown, having or claiming to have any right, title or interest in and to the property described in plaintiff's complaint, and all persons unknown as heirs or devisees of any deceased defendant claiming to have any interest in and to the property described in plaintiff's complaint, defendants.
To J. A. Sharp and Christina Marshall Sharp, husband and wife, Geo. W. Sharp and Sarah Doe Sharp, husband and wife, James F. Sharp and Anna Roe Sharp, husband and wife, Wm. Sharp and Alice Roe Sharp, husband and wife, Earl E. Sharp and Christine Sharp, husband and wife, Thomas L. Sharp and Margaret Roe Sharp, husband and wife, Katherine Scott and James Doe Scott, husband and wife, John Donner and Lulu Donner, husband and wife, Alonzo Barnes and Dora Doe Barnes, husband and wife, Edith Hills and Wm. Doe Hills, husband and wife, Mrs. Walter Davis and Walter Doe Davis, husband and wife, Richard Roe Yost and Elizabeth Yost, husband and wife, John Doe Marshall and Christina Marshall, husband and wife, W. B. Finnell and Mary Doe Finnell, husband and wife, and all persons unknown, having or claiming to have any right, title or interest in and to the property described in plaintiff's complaint, and all persons unknown as heirs or devisees of any deceased defendant claiming to have any interest in and to the property described in plaintiff's complaint, defendants.
To J. A. Sharp and Christina Marshall Sharp, husband and wife, Geo. W. Sharp and Sarah Doe Sharp, husband and wife, James F. Sharp and Anna Roe Sharp, husband and wife, Wm. Sharp and Alice Roe Sharp, husband and wife, Earl E. Sharp and Christine Sharp, husband and wife, Thomas L. Sharp and Margaret Roe Sharp, husband and wife, Katherine Scott and James Doe Scott, husband and wife, John Donner and Lulu Donner, husband and wife, Alonzo Barnes and Dora Doe Barnes, husband and wife, Edith Hills and Wm. Doe Hills, husband and wife, Mrs. Walter Davis and Walter Doe Davis, husband and wife, Richard Roe Yost and Elizabeth Yost, husband and wife, John Doe Marshall and Christina Marshall, husband and wife, W. B. Finnell and Mary Doe Finnell, husband and wife, and all persons unknown, having or claiming to have any right, title or interest in and to the property described in plaintiff's complaint, and all persons unknown as heirs or devisees of any deceased defendant claiming to have any interest in and to the property described in plaintiff's complaint, defendants.
To J. A. Sharp and Christina Marshall Sharp, husband and wife, Geo. W. Sharp and Sarah Doe Sharp, husband and wife, James F. Sharp and Anna Roe Sharp, husband and wife, Wm. Sharp and Alice Roe Sharp, husband and wife, Earl E. Sharp and Christine Sharp, husband and wife, Thomas L. Sharp and Margaret Roe Sharp, husband and wife, Katherine Scott and James Doe Scott, husband and wife, John Donner and Lulu Donner, husband and wife, Alonzo Barnes and Dora Doe Barnes, husband and wife, Edith Hills and Wm. Doe Hills, husband and wife, Mrs. Walter Davis and Walter Doe Davis, husband and wife, Richard Roe Yost and Elizabeth Yost, husband and wife, John Doe Marshall and Christina Marshall, husband and wife, W. B. Finnell and Mary Doe Finnell, husband and wife, and all persons unknown, having or claiming to have any right, title or interest in and to the property described in plaintiff's complaint, and all persons unknown as heirs or devisees of any deceased defendant claiming to have any interest in and to the property described in plaintiff's complaint, defendants.
To J. A. Sharp and Christina Marshall Sharp, husband and wife, Geo. W. Sharp and Sarah Doe Sharp, husband and wife, James F. Sharp and Anna Roe Sharp, husband and wife, Wm. Sharp and Alice Roe Sharp, husband and wife, Earl E. Sharp and Christine Sharp, husband and wife, Thomas L. Sharp and Margaret Roe Sharp, husband and wife, Katherine Scott and James Doe Scott, husband and wife, John Donner and Lulu Donner, husband and wife, Alonzo Barnes and Dora Doe Barnes, husband and wife, Edith Hills and Wm. Doe Hills, husband and wife, Mrs. Walter Davis and Walter Doe Davis, husband and wife, Richard Roe Yost and Elizabeth Yost, husband and wife, John Doe Marshall and Christina Marshall, husband and wife, W. B. Finnell and Mary Doe Finnell, husband and wife, and all persons unknown, having or claiming to have any right, title or interest in and to the property described in plaintiff's complaint, and all persons unknown as heirs or devisees of any deceased defendant claiming to have any interest in and to the property described in plaintiff's complaint, defendants.
To J. A. Sharp and Christina Marshall Sharp, husband and wife, Geo. W. Sharp and Sarah Doe Sharp, husband and wife, James F. Sharp and Anna Roe Sharp, husband and wife, Wm. Sharp and Alice Roe Sharp, husband and wife, Earl E. Sharp and Christine Sharp, husband and wife, Thomas L. Sharp and Margaret Roe Sharp, husband and wife, Katherine Scott and James Doe Scott, husband and wife, John Donner and Lulu Donner, husband and wife, Alonzo Barnes and Dora Doe Barnes, husband and wife, Edith Hills and Wm. Doe Hills, husband and wife, Mrs. Walter Davis and Walter Doe Davis, husband and wife, Richard Roe Yost and Elizabeth Yost, husband and wife, John Doe Marshall and Christina Marshall, husband and wife, W. B. Finnell and Mary Doe Finnell, husband and wife, and all persons unknown, having or claiming to have any right, title or interest in and to the property described in plaintiff's complaint, and all persons unknown as heirs or devisees of any deceased defendant claiming to have any interest in and to the property described in plaintiff's complaint, defendants.
To J. A. Sharp and Christina Marshall Sharp, husband and wife, Geo. W. Sharp and Sarah Doe Sharp, husband and wife, James F. Sharp and Anna Roe Sharp, husband and wife, Wm. Sharp and Alice Roe Sharp, husband and wife, Earl E. Sharp and Christine Sharp, husband and wife, Thomas L. Sharp and Margaret Roe Sharp, husband and wife, Katherine Scott and James Doe Scott, husband and wife, John Donner and Lulu Donner, husband and wife, Alonzo Barnes and Dora Doe Barnes, husband and wife, Edith Hills and Wm. Doe Hills, husband and wife, Mrs. Walter Davis and Walter Doe Davis, husband and wife, Richard Roe Yost and Elizabeth Yost, husband and wife, John Doe Marshall and Christina Marshall, husband and wife, W. B. Finnell and Mary Doe Finnell, husband and wife, and all persons unknown, having or claiming to have any right, title or interest in and to the property described in plaintiff's complaint, and all persons unknown as heirs or devisees of any deceased defendant claiming to have any interest in and to the property described in plaintiff's complaint, defendants.
To J. A. Sharp and Christina Marshall Sharp, husband and wife, Geo. W. Sharp and Sarah Doe Sharp, husband and wife, James F. Sharp and Anna Roe Sharp, husband and wife, Wm. Sharp and Alice Roe Sharp, husband and wife, Earl E. Sharp and Christine Sharp, husband and wife, Thomas L. Sharp and Margaret Roe Sharp, husband and wife, Katherine Scott and James Doe Scott, husband and wife, John Donner and Lulu Donner, husband and wife, Alonzo Barnes and Dora Doe Barnes, husband and wife, Edith Hills and Wm. Doe Hills, husband and wife, Mrs. Walter Davis and Walter Doe Davis, husband and wife, Richard Roe Yost and Elizabeth Yost, husband and wife, John Doe Marshall and Christina Marshall, husband and wife, W. B. Finnell and Mary Doe Finnell, husband and wife, and all persons unknown, having or claiming to have any right, title or interest in and to the property described in plaintiff's complaint, and all persons unknown as heirs or devisees of any deceased defendant claiming to have any interest in and to the property described in plaintiff's complaint, defendants.
To J. A. Sharp and Christina Marshall Sharp, husband and wife, Geo. W. Sharp and Sarah Doe Sharp, husband and wife, James F. Sharp and Anna Roe Sharp, husband and wife, Wm. Sharp and Alice Roe Sharp, husband and wife, Earl E. Sharp and Christine Sharp, husband and wife, Thomas L. Sharp and Margaret Roe Sharp, husband and wife, Katherine Scott and James Doe Scott, husband and wife, John Donner and Lulu Donner, husband and wife, Alonzo Barnes and Dora Doe Barnes, husband and wife, Edith Hills and Wm. Doe Hills, husband and wife, Mrs. Walter Davis and Walter Doe Davis, husband and wife, Richard Roe Yost and Elizabeth Yost, husband and wife, John Doe Marshall and Christina Marshall, husband and wife, W. B. Finnell and Mary Doe Finnell, husband and wife, and all persons unknown, having or claiming to have any right, title or interest in and to the property described in plaintiff's complaint, and all persons unknown as heirs or devisees of any deceased defendant claiming to have any interest in and to the property described in plaintiff's complaint, defendants.
To J. A. Sharp and Christina Marshall Sharp, husband and wife, Geo. W. Sharp and Sarah Doe Sharp, husband and wife, James F. Sharp and Anna Roe Sharp, husband and wife, Wm. Sharp and Alice Roe Sharp, husband and wife, Earl E. Sharp and Christine Sharp, husband and wife, Thomas L. Sharp and Margaret Roe Sharp, husband and wife, Katherine Scott and James Doe Scott, husband and wife, John Donner and Lulu Donner, husband and wife, Alonzo Barnes and Dora Doe Barnes, husband and wife, Edith Hills and Wm. Doe Hills, husband and wife, Mrs. Walter Davis and Walter Doe Davis, husband and wife, Richard Roe Yost and Elizabeth Yost, husband and wife, John Doe Marshall and Christina Marshall, husband and wife, W. B. Finnell and Mary Doe Finnell, husband and wife, and all persons unknown, having or claiming to have any right, title or interest in and to the property described in plaintiff's complaint, and all persons unknown as heirs or devisees of any deceased defendant claiming to have any interest in and to the property described in plaintiff's complaint, defendants.
To J. A. Sharp and Christina Marshall Sharp, husband and wife, Geo. W. Sharp and Sarah Doe Sharp, husband and wife, James F. Sharp and Anna Roe Sharp, husband and wife, Wm. Sharp and Alice Roe Sharp, husband and wife, Earl E. Sharp and Christine Sharp, husband and wife, Thomas L. Sharp and Margaret Roe Sharp, husband and wife, Katherine Scott and James Doe Scott, husband and wife, John Donner and Lulu Donner, husband and wife, Alonzo Barnes and Dora Doe Barnes, husband and wife, Edith Hills and Wm. Doe Hills, husband and wife, Mrs. Walter Davis and Walter Doe Davis, husband and wife, Richard Roe Yost and Elizabeth Yost, husband and wife, John Doe Marshall and Christina Marshall, husband and wife, W. B. Finnell and Mary Doe Finnell, husband and wife, and all persons unknown, having or claiming to have any right, title or interest in and to the property described in plaintiff's complaint, and all persons unknown as heirs or devisees of any deceased defendant claiming to have any interest in and to the property described in plaintiff's complaint, defendants.
To J. A. Sharp and Christina Marshall Sharp, husband and wife, Geo. W. Sharp and Sarah Doe Sharp, husband and wife, James F. Sharp and Anna Roe Sharp, husband and wife, Wm. Sharp and Alice Roe Sharp, husband and wife, Earl E. Sharp and Christine Sharp, husband and wife, Thomas L. Sharp and Margaret Roe Sharp, husband and wife, Katherine Scott and James Doe Scott, husband and wife, John Donner and Lulu Donner, husband and wife, Alonzo Barnes and Dora Doe Barnes, husband and wife, Edith Hills and Wm. Doe Hills, husband and wife, Mrs. Walter Davis and Walter Doe Davis, husband and wife, Richard Roe Yost and Elizabeth Yost, husband and wife, John Doe Marshall and Christina Marshall, husband and wife, W. B. Finnell and Mary Doe Finnell, husband and wife, and all persons unknown, having or claiming to have any right, title or interest in and to the property described in plaintiff's complaint, and all persons unknown as heirs or devisees of any deceased defendant claiming to have any interest in and to the property described in plaintiff's complaint, defendants.
To J. A. Sharp and Christina Marshall Sharp, husband and wife, Geo. W. Sharp and Sarah Doe Sharp, husband and wife, James F. Sharp and Anna Roe Sharp, husband and wife, Wm. Sharp and Alice Roe Sharp, husband and wife, Earl E. Sharp and Christine Sharp, husband and wife, Thomas L. Sharp and Margaret Roe Sharp, husband and wife, Katherine Scott and James Doe Scott, husband and wife, John Donner and Lulu Donner, husband and wife, Alonzo Barnes and Dora Doe Barnes, husband and wife, Edith Hills and Wm. Doe Hills, husband and wife, Mrs. Walter Davis and Walter Doe Davis, husband and wife, Richard Roe Yost and Elizabeth Yost, husband and wife, John Doe Marshall and Christina Marshall, husband and wife, W. B. Finnell and Mary Doe Finnell, husband and wife, and all persons unknown, having or claiming to have any right, title or interest in and to the property described in plaintiff's complaint, and all persons unknown as heirs or devisees of any deceased defendant claiming to have any interest in and to the property described in plaintiff's complaint, defendants.
To J. A. Sharp and Christina Marshall Sharp, husband and wife, Geo. W. Sharp and Sarah Doe Sharp, husband and wife, James F. Sharp and Anna Roe Sharp, husband and wife, Wm. Sharp and Alice Roe Sharp, husband and wife, Earl E. Sharp and Christine Sharp, husband and wife, Thomas L. Sharp and Margaret Roe Sharp, husband and wife, Katherine Scott and James Doe Scott, husband and wife, John Donner and Lulu Donner, husband and wife, Alonzo Barnes and Dora Doe Barnes, husband and wife, Edith Hills and Wm. Doe Hills, husband and wife, Mrs. Walter Davis and Walter Doe Davis, husband and wife, Richard Roe Yost and Elizabeth Yost, husband and wife, John Doe Marshall and Christina Marshall, husband and wife, W. B. Finnell and Mary Doe Finnell, husband and wife, and all persons unknown, having or claiming to have any right, title or interest in and to the property described in plaintiff's complaint, and all persons unknown as heirs or devisees of any deceased defendant claiming to have any interest in and to the property described in plaintiff's complaint, defendants.
To J. A. Sharp and Christina Marshall Sharp, husband and wife, Geo. W. Sharp and Sarah Doe Sharp, husband and wife, James F. Sharp and Anna Roe Sharp, husband and wife, Wm. Sharp and Alice Roe Sharp, husband and wife, Earl E. Sharp and Christine Sharp, husband and wife, Thomas L. Sharp and Margaret Roe Sharp, husband and wife, Katherine Scott and James Doe Scott, husband and wife, John Donner and Lulu Donner, husband and wife, Alonzo Barnes and Dora Doe Barnes, husband and wife, Edith Hills and Wm. Doe Hills, husband and wife, Mrs. Walter Davis and Walter Doe Davis, husband and wife, Richard Roe Yost and Elizabeth Yost, husband and wife, John Doe Marshall and Christina Marshall, husband and wife, W. B. Finnell and Mary Doe Finnell, husband and wife, and all persons unknown, having or claiming to have any right, title or interest in and to the property described in plaintiff's complaint, and all persons unknown as heirs or devisees of any deceased defendant claiming to have any interest in and to the property described in plaintiff's complaint, defendants.
To J. A. Sharp and Christina Marshall Sharp, husband and wife, Geo. W. Sharp and Sarah Doe Sharp, husband and wife, James F. Sharp and Anna Roe Sharp, husband and wife, Wm. Sharp and Alice Roe Sharp, husband and wife, Earl E. Sharp and Christine Sharp, husband and wife, Thomas L. Sharp and Margaret Roe Sharp, husband and wife, Katherine Scott and James Doe Scott, husband and wife, John Donner and Lulu Donner, husband and wife, Alonzo