

**SUBSCRIPTION RATES**  
 Daily, by mail, a year, \$5.00  
 Daily, by mail, six months, 2.50  
 Daily, by mail, three months, 1.50  
 Daily, by mail, a month, .50  
 Daily, delivered by carrier, a week, .15  
 How to Remit.—Send Postoffice money order, express order, personal check on your local bank, stamps, coin, or currency.  
**NEWSPAPER LAW OF OREGON.**—Section 2902 of the laws of Oregon provides that whenever any person controlling a newspaper shall mail such newspaper to any person in this state without first receiving an order therefor, such newspaper shall be deemed to be a gift, and no debt or obligation shall accrue against such person, whether said newspaper is received by the person to whom it is sent or not.

FRIDAY, FEBRUARY 21, 1908

**SHORT STORIES.**

Of all callings the writer's shows the greatest mortality, 23 per 1,000.

The Connecticut supreme court will shortly put gowns on the reporter and clerk.

Shower baths will be used by the Cleveland police to sober up drunks before trial.

Between Jan. 1 and Nov. 1, 1907, the fire loss of the United States was \$180,705,300 compared with \$424,400,200 in the same ten months of 1906.

A father and mother left their baby on a street car in Cleveland. The child rode to the end of the line and was cared for till the frantic father arrived.

The Lackawanna Railroad company has issued an order to the clerks at Scranton, Pa., that they must not sneeze on their books, as tuberculosis may be transmitted.

Fire recently destroyed the house in the town of East Peoria, Ill., where the prima donna Emma Abbott first sang. Recently the building was used for a dwelling, but it was formerly a schoolhouse.

A girl was so interested at a dance at Riverside, N. J., that she did not know that her arm had been broken by a fall on the floor. A surgeon said it was the worst fractured elbow he ever treated.

**PLAYS AND PLAYERS.**

Florence Roberts is playing "Zira" on the road, and she is doing well.

Herbert Kelcey and Effie Shannon are reported to be doing well in their new play, "Bridge."

Frederick Paulding has written a play, "The Great Question," in which Jessie Bonstelle will appear.

Madge Lessing has one of the leading roles in "The Prince of Pilsen," now being produced in Paris.

William A. Brady is to produce a new political play, called "The Intruder," by Thompson Buchanan.

Grace Van Studdiford, Camille D'Arville and Helen Bertram are some of the singers now appearing in vaudeville.

Harry B. Smith has been engaged to write the book for the new musical play in which Sam Bernard will be the star after the expiration of his contract with Charles Frohman.

Lillian Albertson, the stately beauty who attracted much attention as the governess in "The Silver Girl," is to be the star of "Paid in Full," which was originally intended for Annie Russell. Ralph Delmore and Hattie Russell will be in the cast.

**TALES THEY TELL.**

Secretary Shields of the water board in New Orleans has a special that delights to catch bugs and take them to the yard for the chickens to eat.

A Sturgeon (Mo.) man says he sent his overalls to a laundry, forgetting to remove his watch. The watch, he declares, went through the wringer and continues to keep good time.

Mrs. Scholler of Manayunk, Pa., bought a life size marble statue of Venus, which was placed in the parlor. When her husband came home late at night he thought the statue was a burglar, and Venus was smashed.

A Greensfield (Mo.) citizen says that when his dog saw two preachers approaching his house he trotted around the corner and returned with two plump chickens, which he deposited near the door and then went to sleep.

**MODES OF THE MOMENT.**

Panels of very deep tucks are inserted at the bottom of evening gowns. The plain portion beneath the tucks shows embroidery designs.

Braid is seen everywhere on street and house costumes alike. Boutache and the flat silk braid of plain weave are preferred to more fancy kinds.

The return of the tailored shirt waist—and its return is assured—bespeaks for the trotteur skirt the severest simplicity, as anything else naturally would be out of keeping.

Shaded satin and velvet have been revived and are being used for trimmings on cloths, as also are cords formed of silk and wound into fanciful border and other effects. In black this latter idea is particularly pleasing.—New York Post.

**Britain's Old Age Pension.**  
 A millionaire will walk for the pleasure of saving a cab fare; any woman would spend her last shilling on a taximeter because there is no point in saving one's last shilling. That is the British workman's answer to the critics who advise him to save up his own old age pension.—London Chronicle.

If your pipes freeze up, call on Zim

**MARSH LANDS**

50 per cent. vegetable matter. Klamath's greatest bargains at \$20 per acre and upwards. Easy Terms.

Oregon's richest soil.

ABEL ADY

**Election of 1908**

Registration opens, Jan. 6.  
 Closes for primaries, April 7.  
 Primary Elections, April 17.  
 Registration reopens, April 21.  
 Closes for election, May 15.  
 General Election, June 1.  
 Registration reopens Sept. 20.  
 Closes for election, Oct. 20.  
 Presidential Election, Nov. 3.

Information compiled for the instruction of the public is as follows:

**Proceedings Under Initiative.**—Initiative petitions must have 7,465 signatures; initiative petitions must be filed by January 31; arguments advocating measures must be filed by February 3; initiative measures must be printed by the secretary of state by March 2; copies of measures must be mailed to voters by April 7; secretary of state must make up the form of ballot by May 4.

**Primary Election.**—Candidates for state and district offices, to be voted for in more than one county, and for circuit judges and district attorneys, must file with the secretary of state, at the time of beginning to circulate petitions, a copy of the petition for nomination, signed by himself, as evidence that said elector is a candidate for nomination by his party. The vote cast by a political party in each voting precinct for representative in congress that last preceding general election is the basis on which the percentage for petitions shall be counted, and need not exceed 1000 signatures.

Petitions for nominations to be voted for in districts comprising more than one county must be signed by at least two per cent of the electors residing in each of at least one-eighth of the precincts in each or at least two counties in the district and need not exceed 500 signers.

Petitions for nomination for offices to be voted for in only one county, or district, shall be filed with the county clerk not less than 15 days before the date set for the primary election, Wednesday, April 1.

The form of primary ballot must be certified to by the secretary of state by March 30.

Canvass of votes for nominations for state and district offices must be made by May 2.

**Farmers of Moderate Means Offered Rare Opportunity**

An unusual opportunity is offered the farmer of moderate means to secure a home in the Lakeside Tract located on the North shore of Tule Lake. The land now offered for sale consists of 3500 acres of irrigable land lying under the Adams canal, a part of the Klamath Project, and admirably located along the shore of the lake. It is rich sagebrush and grass land, part of it being in cultivation. It will be sold in tracts to suit purchasers and on satisfactory terms. For particulars call on or address, J. Frank Adams, manager Lakeside Company, Tule Lake, Oregon.

**Buy a Home**

A joining the new fair ground; two and one-half acres or more, best of garden land. Two and one-half acres is equal to eighteen lots 50x120 feet. If times are good or bad you can, always make a good living from it. Price reasonable, and terms easy. See L. JACOBS, Owner.

**NOTICE TO CREDITORS**

IN THE COUNTY COURT OF THE STATE OF OREGON FOR KLAMATH COUNTY.

ESTATE OF JOSEPH CONGER, DECEASED.

Notice is hereby given that the last will and testament of Joseph Conger, deceased, has been duly proven and admitted to probate and that John W. Siemens and Chas. D. Willson have been duly appointed as executors thereof. All persons having claims against said estate are hereby requested to present the same with the proper vouchers, within six months from the date of this notice, to the undersigned at the First National Bank in the city of Klamath Falls, Oregon.

Dated at Klamath Falls, Oregon, this 15th day of February, 1908.

JOHN W. SIEMENS,  
 CHARLES D. WILLSON,  
 Executors of the last will and testament of Joseph Conger, Deceased.

**Klamath Falls Public Library**

The Klamath Falls Public Library is open every afternoon from 2 to 5:30 o'clock and each evening from 6:30 to 10 o'clock. A cordial invitation is extended to all.

**The Cream of the Best**

**Old Continental Whiskey**

**Normandy Rye**

**F. F. V. Rye**

Bottled Under the Supervision of the Government

**... None Better ...**

Sold By

**C. D. Willson**

Wholesale and Retail Liquor Dealer

**The Land Where Things Grow!**

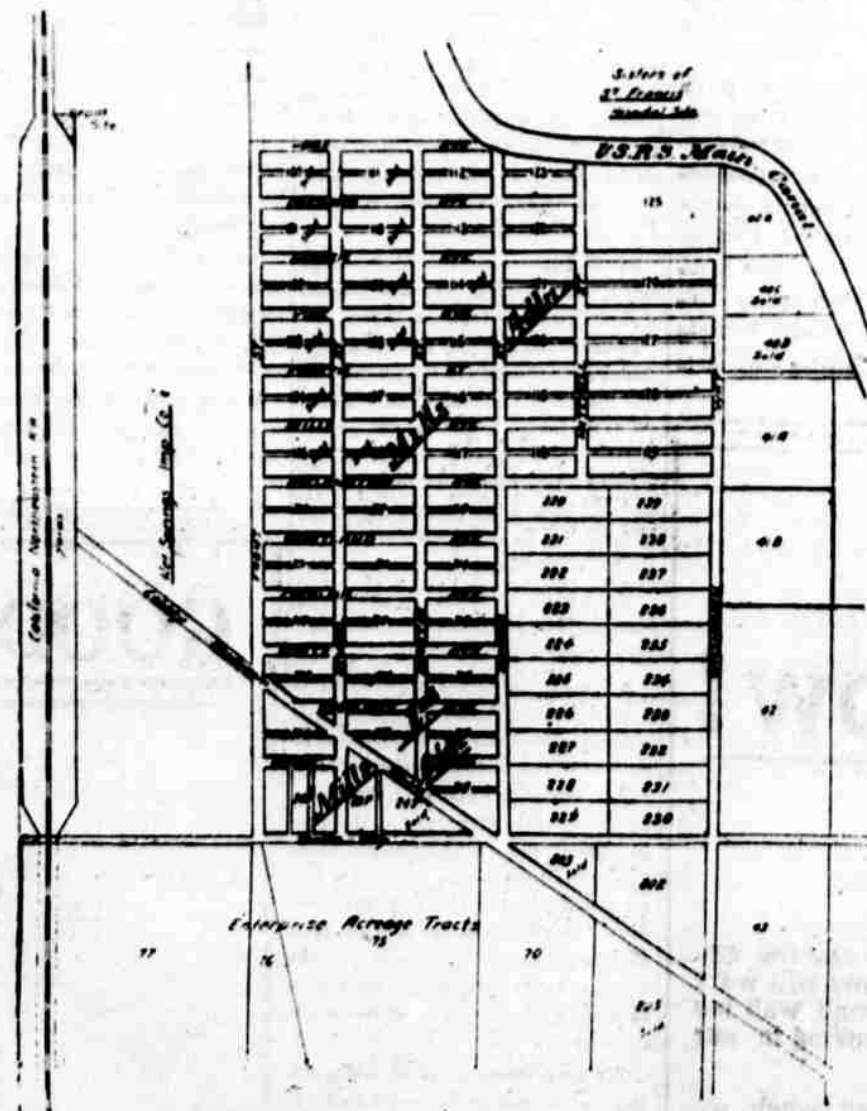

**Buy Lots in Mills Addition**

When Deciding Upon a Home or Making an Investment You Should Choose the Best

**Opportunity Is Knocking at Your Door**

Pay one-fifth Cash \$10 per Month Until paid up and you can own Choice property

**Mills Addition Lots Are the Bargain Buys of Klamath Falls**

Particular attention is called to the location with reference to the Yard location of the California Northeastern Railway, Depot location, the Macadam Road, Main Canal, and soil and physical situation that mean good streets, splendid lawns, unfailing water supply for irrigation, and easy accessibility.

**It Is Your Chance to Make Money**

Call and make inquiry of Frank Ward, Capt. O. C. Applegate, Miss Ethel McCauley. A drive over Mills Addition Streets will cost you nothing but a few moments time and convince you of its advantages

**FRANK IRA WHITE**  
 Fifth-Street Side American Bank & Trust Company Building

**LAND ON THE LAND IN KLAMATH LAND!!**