

J. W. Maxwell

V. W. Maxwell

Sample List Of Property for Sale

40 acres, \$2500 one mile from Lakeview, could be successfully irrigated as a poultry farm, one and one half story house 24x30 comparatively new, 4 rooms on ground floor, 2 on upper floor, barn 18 ft. posts, 18x24, good well, etc. No. 54-23

160 acres at \$10 per acre, sage brush land, 16 miles from Lakeview, sandy loam soil, unimproved. No. 56-52

\$4000-300 acres, a desirable stock ranch and small farm, about one fifth of this is hay land, remainder grain and pasture land, small house and barn situated 12 miles from Lakeview, small creek and irrigating ditch on the place, is patronized as a way side inn. No. 64-123

1700 acres at \$25 per acre, one of the best and most desirable farms and stock ranches in this part of the country, fine thrifty orchard, two story dwelling 72x40, addition 18x27, milk house, wood house, cellar, smoke house, chicken house, spring water in pipes to house, garden and horse barn 80x95, is well adapted to grain and alfalfa, cuts 200 ton of hay, would cut 1000 ton if seeded to alfalfa. It is a bargain, is within 12 miles of Lakeview. No. 126-83

\$11000-240 acres in Warner valley all fenced and cross fenced in five fields paid up water right of 200 inches, two story dwelling 24x30-6 rooms, front porch, cellar, wagon shed 12x16, frame barn 28x60, wagon and wood house 16x58, sheep shed 65x100, orchard bearing, 65 trees, berries of all kinds—improvements cost over \$8000. Stock if wanted at market price. This is an up to date ranch. No. 262-43

6,222 acres at \$5.50 per acre, situate in Nevada, 50 miles southeast of Lakeview, and 18 miles east of California line, it is all in one body and a large portion of it skirts the lakeshore, this is desirable for any kind of stock ranch, with the meadow land it embraces and the extensive open range adjoining. No. 433-119

160 acres highly productive land, good house, large barn, granaries, etc., small orchard, creek through place, 65 acres in cultivation—one of the best yielding farms in Goose Lake valley, 16 miles from Lakeview for \$3500. No. 510-80

80 acres for \$1200, one story frame four room house, new barn, never failing stream, on place, 50 acres fenced, 10 cultivated, an ideal chicken ranch or small stock farm—about one mile from stage road and about 12 miles from New Pine Creek. No. 434-102

160 acres \$3000, good farm house and barn, on stage road, 10 inches irrigable water, cheaply made reservoir site, 150 bearing fruit trees, 200 younger ones of good selection, 50 acre plow land, residue pasture. No. 421-38

200 acres 7 miles south of Paisley, small creek through place—this is a bargain at \$10 per acre. No. 0148

\$25 per acre—360 acres all fenced and well improved, 2 good dwellings each with commodious barns, out houses, 2 orchards—over half of it meadow, the remainder is rolling and hill land—it is one of the very few tracts that could be so evenly divided into two farms that it would be difficult to make choice of them, has all the free water it requires. No. 267-19

80 acres at 12.50 per acre—level sage brush land on the west side of Goose Lake, in good neighborhood, no improvements, yet a good bargain. No. 372-122

100 acres at \$10 per acre, 14 miles from Lakeview, this is good unimproved sage brush bottom land and will come under one or two of the irrigation projects contemplated in that vicinity. No. 392-52

280 acres at \$14.25 per acre in Warner valley, all under fence, good house and barn and out houses and small orchard, never failing creek through place. Terms \$2500, balance 1-2 and 3 years at 6 per cent. No. 290-77

\$2000-120 acres 14 miles from Plush, about 80 acres fenced, 20 in grain, 20 in timothy and clover, 10 in alfalfa, remainder mixed hay land, timothy, red top and blue joint, is a creek bottom, comfortable house, out houses, barn, corrals, 2 wells 12 ft. deep. A fine opening for a beginner in the stock business. No. 377-45

\$1020-100 acres level sage brush land in growing settlement with good prospects of the Government Reclamation Service in the near future assisting the settlers in their irrigation scheme. No. 411-112

320 acres at \$6.25 per acre—an ideal stock or dairy ranch on tributary of Chewaucan river—about twenty miles from Lakeview, is nearly all meadow with good outlet for stock. No. 418-68

200 acres of Chewaucan bottom choice land for any and all purposes, at \$15 per acre. No. 0155

120 acres at \$6.50 per acre within six miles of Lakeview. Unimproved. No. 466-66

160 acres, price \$1,000, located on border of Desert, small creek through place, 120 acres good farm land, 40 acres pasture, with extensive outlet for stock, 20 miles to nearest town—this is a first class opening for a young man to build up in the stock business. No. 0281

Prices subject to change, no notice in addition to the preceding we have over 30,000 acres of land of every grade and quality, in tracts of one to twelve thousand acres ranging in price from \$5 to \$100 per acre, the quality of soil, location and improvements determining the price. The above embraces lands principally in Lake County, a goodly portion of it in vicinity of Lakeview with some few choice tracts in Harney and Crook county in Oregon, also some choice tracts in California and Nevada bordering on the Oregon line.

Residence lots in Lakeview sell for \$125 to \$600 each. Business lots from \$60.0 to \$7000 each.

Ordinarily the town lots are 50x125 feet—in the higher priced lots there is no uniformity in size, the location and size determining the price.

We have the town lots in Watson's addition to the town of Lakeview the nearest to the business portion of town, also lots in all other additions adjoining the town—we also have a large list of improved and unimproved town property of all kinds for sale.

A fifteen years residence in Lake County enables us to say, especially to the capitalist, we can give you pointers in speculative propositions in various lines of business as well as reality that we know you will gladly investigate after you learn what we have to enlist your attention.

Any thing in the preceding that may interest you, write us for more particular description.

J. W. MAXWELL & SON,
Dept. A. Lakeview, Oregon.

A Picturesque Concrete Residence.

The Finish Gives the Appearance of Brown Sandstone. Architect's Estimate, at Least \$5,000.



PERSPECTIVE VIEW—FROM A PHOTOGRAPH.

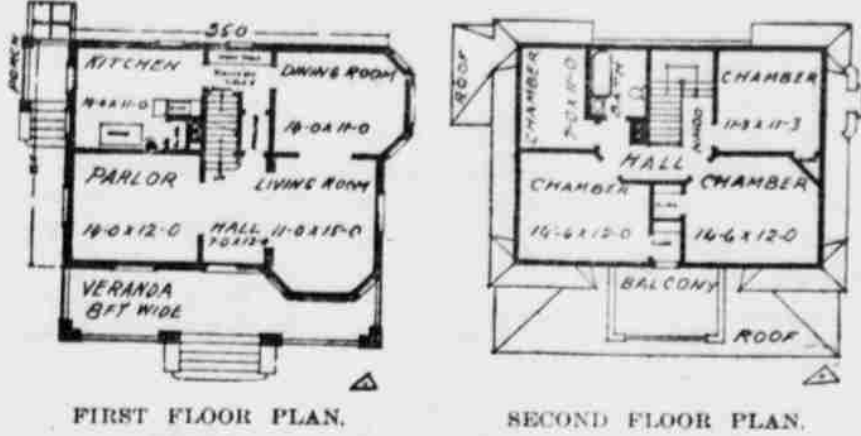

This picturesque gambrel roof house, originally built at Randolph, N. Y., has many pleasing features. Size, 25 by 35 feet without bay or veranda. The color is brown sandstone. Cost, including heating and plumbing, \$3,000. THE THOMPSON ARCHITECTURAL COMPANY.

The SPORTING WORLD

McGuire's Great Record.
The veteran catcher Jim McGuire, who is in command of the Cleveland American catchers and pitchers this spring, is one of the remarkable features in the national game. "The Deacon," as he is familiarly termed, began to play with the big teams in 1883, the year of his majority.

In his twenty-five years of active service McGuire has never been fined



JIM MCGUIRE, CATCHER OF THE CLEVELAND AMERICANS.

or put out of a game by an umpire. He formerly enjoyed the nickname of "Pinch" for his aptitude in hitting the ball at the critical period. McGuire holds the world's record for continuous catching, having participated in 142 consecutive games.

Detroit Driving Club's Chart Revised.
The directors of the Detroit Driving club have reconsidered their decision to change the Chamber of Commerce \$5,000 pacine stake from the 2-13 class to the 2-15 class, and this fixture of the grand circuit meeting will remain in the 2-15 class. The value of the Wolverine handicap, a free for all pace, which takes the place of the 2-07 pacing stake, is to be \$3,000. The Merchants and Manufacturers' stake of \$10,000 remains for the 2-24 trotters, and there is a renewal of the \$3,000 event for 2-11 trotters. The Wolverine is to be two in three and the other events three in five heats.

Penn Crew Arranging Dates.
There appears to be a growing attempt to heal the athletic break which has long existed between Pennsylvania and her natural geographical rival, Princeton. The freshmen crews of the universities will meet in a race on the Schuylkill, and it is a known fact that negotiations are under way to arrange a race between the varsity eights as well. Rowing is booming at Pennsylvania, and a prominent schedule is being arranged. A varsity race has already been scheduled with Yale, and races with Princeton and New York universities are probabilities.

Big Trotting Meet.
Announcement has been made of a big trotting meet to be held at Detroit, Mich., April 17 to 21, on the new track.

If believed, will attract between 500 and 600 of the best horses on the western turf. The Comanche county fair grounds have been leased by the promoters of the meet. Announcement was also made that Lawton, Chickasaw, Edul, Oklahoma City, Tulsa, Claremore, Bartlesville, Pawawka, all in Oklahoma, and Parsons, Kan., will be included in a racing circuit.

We call your special attention to our line of Cluett Peabody shirts at B. & M's.

1906-53741 A. M. Department of the Interior, General Land Office, Washington D. C., May 19, 1906.

NOTICE OF RESTORATION OF PUBLIC LANDS TO SETTLEMENT AND ENTRY.

Notice is hereby given that the Secretary of the Interior has vacated departmental order of withdrawal in so far as the same affects the withdrawal for irrigation purposes under the act of June 17, 1902 (32 Stat., 388), for use in connection with the Pitt River Project, Or.-Cal., of the following described lands in the State of Oregon, and by his authority such said tracts as have not been heretofore finally restored and are not otherwise withdrawn, reserved or appropriated, will be subject to settlement under the public land laws of the United States on and after August 16, 1906, but shall not be subject to entry, filing or selection until September 15, 1906, at the United States land office at Lakeview Oregon, warning being expressly given that no person will be permitted to gain or exercise any right whatever under any settlement or occupation begun after May 10, 1906, and prior to August 16, 1906, all such settlement or occupation being forbidden:

Willamette Principal Meridian.
T. 40 S., R. 19 E., all Secs. 1, 2, 11, lots 1 to 12 incl., W half NW quarter NE quarter NE quarter SW quarter NE quarter NE quarter SW quarter and SW quarter SW quarter Sec. 12, NW quarter NW quarter, and lots 1 and 2 Sec. 13, lots 1 to 13 incl., SE quarter NE quarter NE quarter SW quarter and N half NW quarter Sec. 14, all Secs. 15 and 21 lots 1 to 12 incl., NW quarter NE quarter, NW quarter NW quarter and E half SW quarter Sec. 12, lots 1 to 8 incl., W half SW quarter Sec. 27, all Sec. 28, lots 1 to 14 and W half NW quarter Sec. 33 and lot 1 Sec. 34.

T. 41 S., R. 19 E., lots 1, 2, 3, and 4 of Sec. 4 all Sec. 5 lots 1 to 13 incl., NW quarter and NW quarter SW quarter Sec. 8, all Secs. 6 and 7, all Secs. 18 and 19, lots 1 to 4 incl., and W half SW quarter Sec. 17 lots 1 to 6, SE quarter NW quarter and W half NW quarter Sec. 20.

T. 40 S., R. 29 E., all Secs. 4, 5 and 6, lots 1 to 5 incl., Sec. 7, lots 1 to 4 incl. and N half NE quarter Sec. 8, lots 1 to 4 incl. NE quarter and N half NW quarter Sec. 9, lots 1 to 11 incl., W half NE quarter, SE quarter NW quarter, W half NW quarter, N half SW quarter, SW quarter SE quarter SE quarter Sec. 10, All lots 1 to 8 incl. SE quarter NE quarter, E half SE quarter, SW quarter SE quarter, Sec. 15, lots 1 to 8 incl., SE quarter SE quarter Sec. 16, lots 1 and 2 Sec. 21, lots 1 to 6 incl., NE quarter, N half NW quarter and NE quarter SE quarter Sec. 22, all Sec. 23, lots 1 to 8 incl., E half and E half SW quarter Sec. 26, lots 1 and 2 Sec. 27, lots 1 to 5 incl., E half NE quarter and NE quarter SE quarter Sec. 36 all Sec. 36.

T. 41 S., R. 29 E., all Sec. 1, lots 1 and 2 Sec. 2, lot 1 Sec. 11, all Secs. 12 and 13, lots 1, 2, and 4 Sec. 15, lots 1, 2, 3, 4, and 5, SE quarter NE quarter and NE quarter NE quarter Sec. 23 all Sec. 24.

FRED DENNETT Commissioner of the General Land Office.
FRANK MERRICK First Assistant Secretary of the Interior.

LAKEVIEW SADDLERY

S. F. AHLSTROM
Proprietor

The best Vanquero saddle on the market

Also a complete line of wagon and buggy harness, whips, robes, bits, riates, spurs, quirts, rattles, a fact everything in the line of carriage and horse harness. Repairs, by competent men.

HOTEL LAKEVIEW

ERECTED IN 1900
MODERN THROUGHOUT
FIRST-CLASS ACCOMMODATIONS
SAMPLE ROOM For COMMERCIAL TRAVELERS
COURTEOUS TREATMENT

F. P. LIGHT & HARROW, Proprietors.

Contest Notice

Department of the Interior, United States Land Office, Lakeview, Oregon, May 27, 1906.

A sufficient contest affidavit having been filed in this office by M. B. RICE, contestant against Homestead entry No. 4035, Serial No. 01638, made May 13, 1906, for N. half SW quarter, SE quarter SW quarter, SW quarter SE quarter, section 28, Township 34 S., Range 19 E., by Rudolf Knubli Contestant, in which it is alleged that said Rudolf Knubli has never since the date of said entry established a residence on said land; that said entry man has wholly and totally abandoned said entry for more than six months last past, to-wit: From the 13th day of May, 1906 to the present time, that said entryman has wholly and totally failed to cultivate or in any manner improve the land embraced in said entry, and has performed no work of any kind thereon, and that said alleged absence from the said land was not due to his employment in the Army or Navy, or marine Corps of the United States as a private soldier, officer, seaman, or marine, during the war with Spain, or during any other war in which the U. S. may be engaged, said parties are hereby notified to appear, respond and offer evidence touching said allegation at 10 o'clock a. m. on July 9, 1906, before the Register and Receiver at the United States Land Office in Lakeview, Ore.

The said contestant having in a proper affidavit, filed May 26, 1906, set forth facts which show that after due diligence personal service of this notice can not be made, it is hereby ordered and directed that such notice be given by due and proper publication.

J35W Fred P. Cronmiller, Receiver.

REWARD

A REWARD of fifty dollars is hereby offered for information that will lead to the arrest and conviction of any person who has stolen wire or other property, from our Company, and the same reward is hereby offered for information that will lead to the arrest and conviction of anyone destroying the property of the Company, Secretary Lake Co. Tel. & Tbl. Co. 1017.

NOT COMPATIBLE

She—Mr. Bloom does not pay his wife much attention.
He—No, the only time I ever knew of his going out with her was once when the gas exploded.—London Titbits.

\$1,250 Reward.

The Harry O'Connell, Live Stock Auctioneer, of this city, has a reward for evidence leading to the conviction of parties stealing stock belonging to its members. In addition I offer \$100 reward for each horse stolen on either of both towns. Reward for each horse stolen on either of both towns. Reward for each horse stolen on either of both towns.

I will reward \$2.00 for information that will lead to the recovery of any horse branded with an old harness, or any horse branded as in the cut in this advertisement, with fresh, single brand, or with the horse's name. The brand is placed in such a manner as would cover up a bar on both jaws. The horse must be found by the possessor of some portion of harness.

Notice for Publication

Department of the Interior, U. S. Land Office at Lakeview, Oregon, April 26, 1906.

Notice is hereby given that HENRY ANDERSON, of Hy, Oregon, who on November 25, 1905, made Homestead Entry No. 3861 (Serial No. 01496) for Lots 1, 2, E half NW quarter, section 31, Township 35 S., Range 15 E., Will. Meridian, has filed notice of intention to make Final Commutation Proof to establish claim to the said above described, before Register and Receiver at Lakeview, Oregon, on the 6th day of July, 1906.

Claimant names as witnesses: Art Evans, Charlie Lewis, O. T. Anderson, Q. N. Anderson, all of Hy, Oregon.

M6J10 J. N. Watson, Register.

DIARRHOEA

There is no need of anyone suffering long with this disease, for to effect a quick cure it is only necessary to take a few doses of

Chamberlain's Colic, Cholera and Diarrhoea Remedy

In fact, in most cases one dose is sufficient. It never fails and can be relied upon in the most severe and dangerous cases. It is equally valuable for children and in the treatment of saving the lives of many children each year.

In the world's history no medicine has ever met with greater success.

PRICE 25c. LARGE SIZE 50c.

TOWER'S FISH BRAND WATERPROOF OILED CLOTHING

looks better—wears longer—keeps you dry—keeps your body cool—because out on large parties you can't be more than the just as good as the

SUITS \$3.00 SLACKS \$2.00 SOLD EVERYWHERE

Only genuine Tower's Fish Brand Oiled Clothing

WILLIAMSON-HATFIELD

W. W. BROWN, Horse Trainer

J. W. Maxwell & Son

Dept. "A" Lakeview, Oregon

Lime and Brick

HAHN & KELLEY, Lakeview

We are now preparing to burn our first kiln of 75,000 pounds of Lime, and will be prepared in two weeks to fill orders.

150,000 BRICK

We are also preparing our first kiln of 150,000 brick, which will be ready in a short time, and guaranteed best quality.

GIVE US A CALL. Yard on North Lakeview

Klamath Hospital

Klamath Falls, Oregon

Phone 561; Corner 4th and Pine Streets; Two Blocks from Court House. Completely equipped for treating surgical, medical and maternity cases. Operating room, entirely up-to-date, at disposal of any surgeon on short notice. Patients received at any and all hours.

Emily A. Humphrey.

Money Loaned

ON REAL ESTATE.

LONG TIME, EASY PAYMENTS.

RELIABLE REPRESENTATIVES WANTED.

The Jackson Loan & Trust Co.

Fort Worth, Texas, or Jackson, Mississippi