

### Douglas County Park To Open Near Canyonville

Glenn Jackson, Medford, chairman of the Oregon State highway commission, will be guest speaker at the dedication of the Charles V. Stanton county park at Canyonville, 2 p.m., Sunday, June 23. Douglas County Judge V. T. Jackson will read the court order dedicating the park and Boy Scouts will unveil the plaque. John P. Amacher, Douglas county parks commission chairman, will introduce Jackson.

The Douglas county court signed the order in 1950 creating the first county park program in Oregon. This order, drafted by Charles Stanton, editor of the Roseburg News Review, stands as a model park ordinance copied by many other counties.

The order was an outgrowth of several years of promotion by the Douglas County Sportsmen's groups of which the Roseburg Rod and Gun club and the South Umpqua Rod and Gun club were leaders. Editorials Noted. Files of the News Review contain 42 editorials written by Stanton on the county parks proposal. He also appeared in the numerous hearings before the county court. Charles Collins was appointed first park supervisor in 1951, a position which he held for ten years when he became executive vice president of Cal-Ore Recreational

Development association in Medford. Wilbur Wierprecht was appointed to fill the vacancy. Today the county has 37 parks. They total 960 acres and with their improvements are worth over a million dollars.

**New Philosophy**  
Stanton parks represents a new departure in park philosophy. It is intended to fill part of the outdoor recreational needs of the Canyonville community, but was also purchased primarily for its strategic location along Interstate Freeway 5 as a southern gateway to the outdoor recreational opportunities of the county. It will be an overnight and informational stop for visitors expected in increasing numbers along the freeway.

"No stranger can stop here without learning of the wonders of Crater lake, the angling of Diamond lake and Salmon Harbor and the scenic drives along the Umpqua river. When this park is in full operation it is planned to test its effectiveness as a recreation sales media." Collins said. The Douglas county court has authorized the purchase of two more such wayside sites, one in central Douglas county and one near the north gateway.

### Try and Stop Me

By BENNETT CERF

A MAN WHO HAD made a great fortune in the Alaskan gold rush was asked how he had been so successful when so many others had returned empty-handed. The old prospector smiled and replied, "I never told anybody before, but now I'll tell you. I just kept digging holes."



At a gay reunion of World War II veterans, the conversation got around to cartoons that had made the nation laugh a bit during the grim days before the tide turned in America's favor at Guadalcanal. It was surprising how clearly some of these cartoons—and the exact wording of the captions—were remembered.

Favorites: Two goats chewing up top-secret reports at the Pentagon, with one grunting happily, "Best darn propaganda I ever ate!"; a general's hatchet-faced wife collaring him at the door of his home to snarl, "You're not going to go inspecting barracks until you tidy up the mess in your own room!"; the G.I. having a tooth yanked at the dispensary, gasping, "Ouch—Sir!"; and an admiral jumping up from his chair with a shriek of anguish while his aide whispers to a J.G., "I think the admiral's found that Japanese carrier that was missing from his chart."

© 1965, by Bennett Cerf. Distributed by King Features Syndicate

### Local Chamber Officials Attend Del Norte Meeting

Medford Chamber of Commerce Manager Don McNeill and Past Chamber President Gerald Latham were among the 150 persons who attended the 50th annual dinner meeting of the Del Norte County Chamber of Commerce at Crescent City Tuesday evening.

Others from southern Oregon attending were Josephine County Commissioner Louis Ringuette and Mrs. Ringuette.

"A community's growth depends on enterprise and opportunity of investment capital, investment capital depends on initiative and imagination of individuals and groups of individuals," Louis P. Growney, Portland, director of industrial development for Pacific Power and Light company, told the group.

Commenting on communities offering tax benefits to attract industry, he said that businesses have found this puts industry at a disadvantage in the eyes of the public. Industry working with the community for mutual benefit is far better than any tax benefit, he commented.

**Favorable Positions**  
"Capital will come to the community where there is business potential," Growney explained. "Northern California and southern Oregon are in very favorable positions

due to California's population growth. It is up to the individual to develop the commodities which the public demands."

He complimented Crescent City on their initiative in attempting to get new industry into the area, reminding the group that community leadership depends on individual work. He explained that 85 per cent of industrial growth starts at home.

It was stated that Del Norte county receives about \$25 million from tourists each year. Among the persons attending the event were ten past presidents of the chamber. James Yarbrough, president-elect, listed four points for his program this year—transportation, industry, a stable economy, and progress.

### Sunday, June 16

Swem's  
217 E. Main St. — Medford

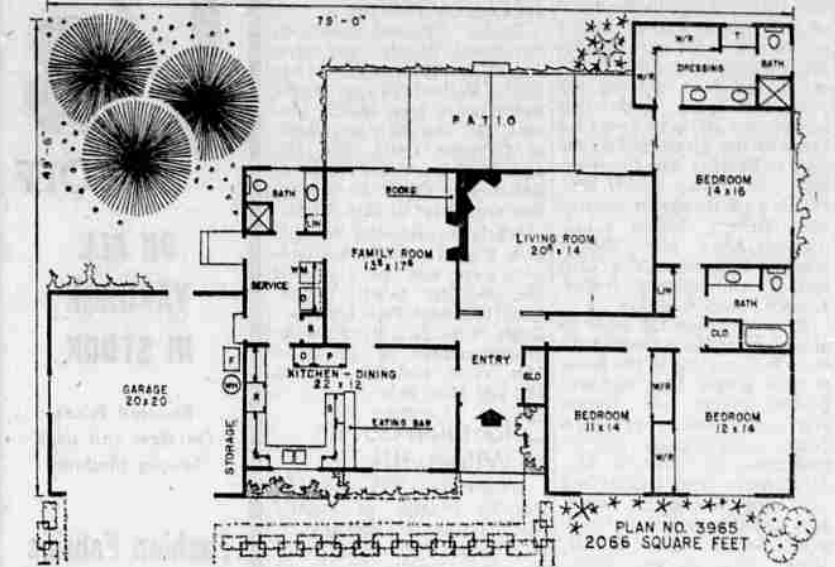

### This Week's Plan for Home Builders

By HIAWATHA ESTES  
Lovely to look at — delightful to own. This is only a partial description of this imaginative home which offers numerous ideas that are guaranteed to make your home more livable and beautiful.

One of the most important things to consider when shopping for a new home, regardless of exterior styling, is the practical arrangement of the floor plan. The first point one should consider when analyzing a plan is how efficient the design handles the flow of traffic. It would be difficult to locate a home with a more satisfactory center hall plan than the one shown here. Double front doors open from the covered porch to a wide entry that is not too deep. From this entry and the short hall, there is direct access to every major room in the house.

**Privacy in Layout**  
Privacy is sometimes hard to achieve in today's contemporary homes. A quick glance will show that there is privacy in this layout. There are no large openings between the kitchen, dining, family or living rooms. The bedroom wing is completely separated from the living area while the family bath separates the

master bedroom suite from the other two bedrooms. Doors open from the garage to the rear yard and direct to the service area. This is especially advantageous during inclement weather. The garage door has been offset in the front wall so as to provide space for the water heater, furnace and storage area along one wall.

The complete bath off the service is handy to the family room, kitchen and rear yard. Such a bath location is very convenient if a swimming pool is being considered. The location of a door leading from the service to the family room eliminates the necessity of traffic flow from the rear entrance through the kitchen to the remainder of the house.

**Large Kitchen**  
The homemaker who loves the luxury of a large kitchen will be especially enchanted with this large combination kitchen-dining room. An eating bar has been included for the serving of family meals.

The living and family rooms plus the master bedroom overlook and have direct access to the patio and refreshing rear garden, well removed from street view and noises.

A wide twin pullman lavatory plus a long dressing table

are features of the highly appealing dressing room. A shower and water closet are in a separate compartment.

Note how the garage roof continues over the planter in front of the kitchen. Complete working drawings for this plan can be purchased at a cost of \$7.50 for the first set and \$5 for each additional set when ordered at the same time. This plan will be available at these prices until Oct. 2. Please allow two or three weeks for delivery. The following home plan books are also available: Hallmark Homes \$1; Award Homes \$1; Town and Country Homes \$1; Homes for Living \$1; Homes of Distinction \$1; Ranch and Modern Homes \$2. All books a \$7 value, only \$5. Send all orders for either plans or books to: Hiawatha Estes, postoffice box 404-T, Northridge, Calif.

### Relatively High Death Rate Noted

Washington —UPI— A "relatively high" mortality rate of 946 per 100,000 population in the U. S. in 1962 was reported by the U. S. Public Health Service.

The PHS said the rate reflects "for the most part" the outbreaks of influenza that occurred in the first quarter of the year. There were also marked increases in the rate of violent deaths — accidents, suicides and homicides.

# OVER \$30,000 CLEARANCE!

To Make Room for 1964 Models and New Merchandise Arriving  
**Thursday - Friday - Saturday**  
OPEN UNTIL 9 P.M. THURSDAY & FRIDAY

- Norge Range 30 Inch **128<sup>88</sup>**
- Norge Freezer 339 lb. Cap. **158<sup>88</sup>**
- 23" Console TV Swivel **188<sup>88</sup>**
- 19" Portable TV Thin Line **138<sup>88</sup>**
- Color TV Sets Up to **\$150 Off**

**Transitional Couch**  
100" Foam Cushions  
Foam Back  
Reg. 389.00  
Now **199<sup>00</sup>**

**Danish Couch**  
4 Reversible Foam Cushions  
**49<sup>95</sup>**

**French Provincial Couch**  
Floral Quilt  
Reg. 578.00  
Now **329<sup>00</sup>**

**Early American Couch**  
100 Inch 3 Cushion With Pillows  
Reg. 529.00  
Now **299<sup>00</sup>**

- Lamps
- Bedroom
- Living Room
- Dining Room

**NEW**  
You can Save  
**20% to 50%**

- HERE'S MORE BARGAINS!
- Both Box Spring and Mattress Full Size Now **44<sup>95</sup>**
  - Mattress Sets 5 Pc. Reg. 469.00 Now **353<sup>00</sup>**
  - Solid Cherry Bedroom Set Includes Rails, Guard & Innerspring Mattress **79<sup>95</sup>**
  - Salem Maple Bunk Beds Special For Dad **39<sup>95</sup>**
  - Recliners Formica Table Top, 4 Chairs **34<sup>50</sup>**
  - 5-Piece Metal Dinettes Daveno, Rocker, Club Chair, 3 Oak Tables **179<sup>95</sup>**
  - 6-Pc. Western Liv. Rm. **5<sup>95</sup>**
  - 9x12 Linoleum Rugs Continuous Filament with Foam Pad **49<sup>95</sup>**
  - 9x12 Nylon Rug

*Reduced to Clear!*  
**CARPETING**

- 501 DuPont Label NYLON, BEIGE or COCOA ONLY **5<sup>95</sup>** Sq. Yd.
- Continuous Filament NYLON 5 Year Guarantee ONLY **3<sup>88</sup>** Sq. Yd.

... AND MANY OTHERS

- CONVENIENT CREDIT TERMS**
- Pole Lamps Special at **5<sup>95</sup>**
  - Den Couch 6-ft. Decorator Fabric **29<sup>88</sup>**
  - Bed Room Set Early American **67<sup>88</sup>**

**FREE Delivery of Course**

**EADS FURNITURE WAREHOUSE**  
123 S. FRONT Phone SR-2-7121

**EADS TRANSFER AND FURNITURE CO.**  
LOCAL AND LONG DISTANCE MOVING  
Special in Furniture Packing Crating Shipping

**ZALE'S BRINGS YOU THESE OUTSTANDING VALUES ON SCHICK'S MOST ADVANCED ELECTRIC SHAVERS!**



**NEW SCHICK COMPACT Model 30**  
Compact in price as well as size. Hand fitting shape makes it easy to reach those hard-to-shave places on your face. Shatter-proof nylon case. Adjustable comb bar. **JUST \$889**



**EXCLUSIVE WITH SCHICK!**  
Surgical stainless steel washable head. Snaps off. Washes clean. Snaps on again.



**THE NEW SCHICK SUPER-SPEED**  
Breakthrough in shaving cleanliness and convenience. Available in 2 models... green-striped head for sensitive skin, red-striped head for regular and tough beards. Gives a perfect shave with any type of skin. Comfort control shaving head.

**SCHICK Lterna S Power RECHARGEABLE SHAVERS**  
World's most advanced electric shaver. Shaves anywhere — with or without a cord. Plug in cord to recharge. One model just for tough beards... Another for sensitive skin. Comfort control adjustable bars for shaving.

**NOW JUST \$1889 ONLY \$2788**  
218 E. Main Phone 779-1331