

# GOLD REY HOMESITES

## THE DELIGHTS OF COUNTRY LIVING — WITH CITY CONVENIENCES!

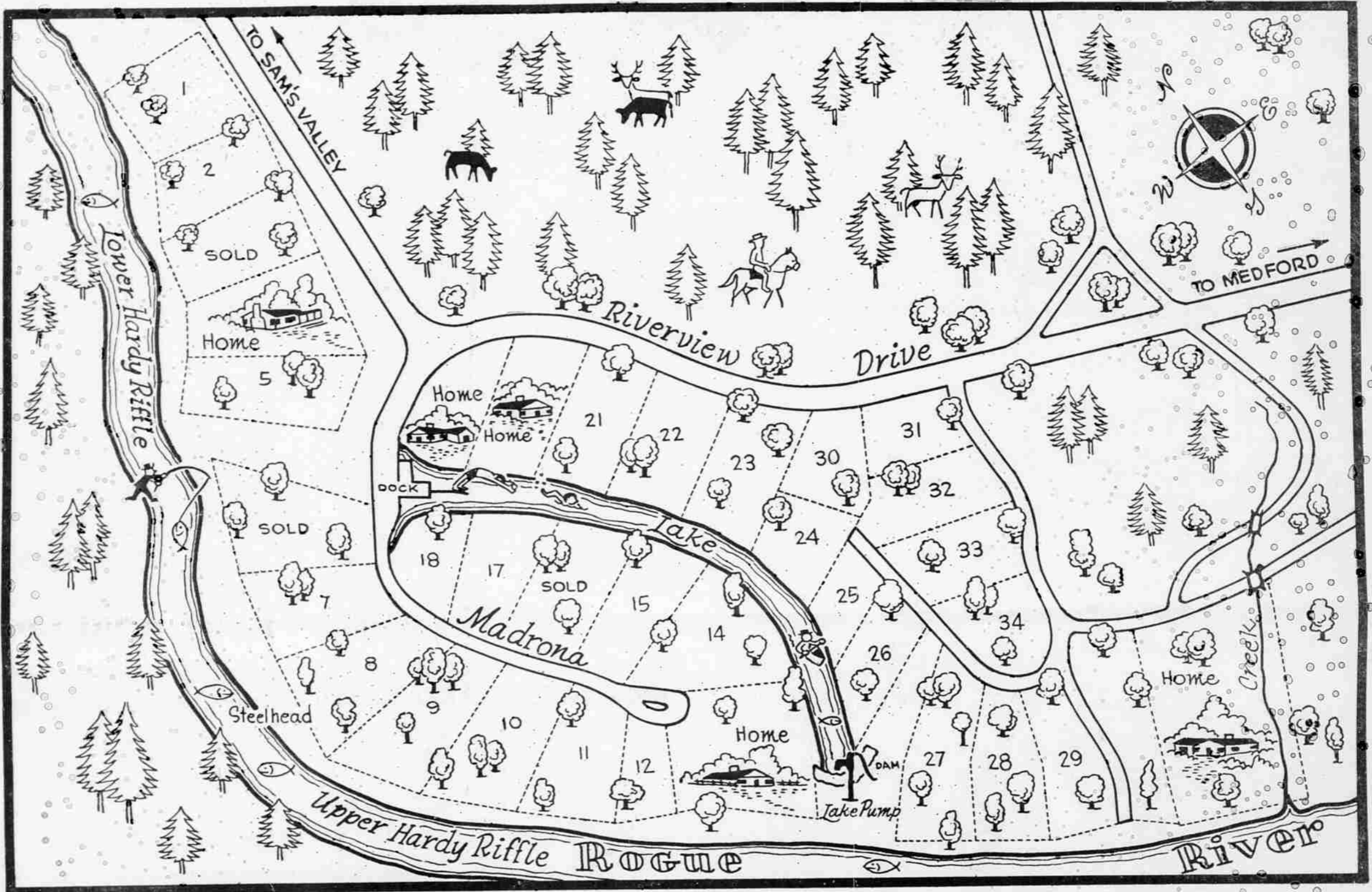

*For The Life Of A Country Squire — On A Business Or Professional Man's Income — The Answer Is **GOLD REY!***

Gold Rey is unique among residential developments in the entire United States! No other development — anywhere — offers so many delights of country estate life — with all city conveniences — for families with middle-class incomes! Here are a few of the things which will appeal to you:

**20 Minutes Easy Driving**, over good paved roads, takes you from the heart of Medford to Gold Rey.

**The Tranquillity—The Restfulness** of the country is yours in Gold Rey. Minutes from a business or professional man's busy day, a Gold Rey home is as quiet and restful as the most isolated wilderness hideaway.

**Conveniences Of The City**—excellent electric service, telephone, nearness to shopping centers, neighbors within hailing distance, city deliveries—are yours in Gold Rey!

**Fishing Is At Your Front Door** in Gold Rey. Lots now for sale in Gold Rey slope gently down to the famous Rogue. The fisherman can step off his front porch and have his limit minutes after he gets home from the office. The world-famous Hardy Riffle is right in the middle of Gold Rey.

You have to see Gold Rey . . . talk to some of its happy home-owners . . . to fully appreciate what it can mean to you. Call us at any time for a conducted tour.

**Developed, Orderly Restrictions** protect your property in Gold Rey. This is not a development for the family who wants just a house to live in. Gold Rey is for home-builders—people who expect to live graciously and see the value of their property increase.

**A Sportsman's Paradise**—Gold Rey. In addition to the private lake for swimming, boating, and fishing, Gold Rey offers all the pleasures of outdoor life while keeping the comforts of the city.

**Room To Grow Is Yours** in Gold Rey. Lots now for sale range from 1½ to 3½ acres in size. They are spaced so that you can have complete privacy—yet have neighbors close by—people with whom you have interests in common — good neighbors. Homesites fronting on private lake \$5500 — fronting on the Rogue \$6500.

### Rogue Valley Land Company

704 West Sixth — Medford — Phone 3-3641