

# Three Annexation Proposals on Ballot November 6

## Residents of City, Three 'Outside' Areas, Will Vote

Residents both in and around Medford will vote on three annexation proposals at the general election Nov. 6.

Medford voters will decide one proposal only—whether or not about a three-block area in Siskiyou Heights addition (now completely surrounded by the city) will be annexed.

The other annexation proposals are in the Berrydale district north of Medford and the Grandview-Kenwood district northeast of Medford.

### Reject Annexation

Residents in the three-block "island" rejected annexation in a special election last Jan. 16 when the southeast Medford area was annexed.

Voters in the three-block area will not vote on annexation. State law provides that if an area is completely surrounded by the city, residents of the city may decide whether or not the "island" will be annexed.

Only voters in the Berrydale and Grandview-Kenwood districts will vote on annexation in those areas. If annexation is favored, city officials have indicated that a special election will be held so residents within the city limits can pass on the proposal.

### Separate Poll Books

Separate poll books are being prepared for the annexation elections, according to City Manager Robert Duff.

The Berrydale district includes between 600 and 700 acres with an estimated population of about 1,700 and an assessed valuation of about \$1,016,253. The latter figure was determined from records in the Jackson county courthouse for the year 1955-1956. Duff said.

An estimated 1,120 acres is included in the Grandview-Kenwood district. It has an estimated population of 836. The assessed valuation is estimated at \$786,065.

Several questions have been raised concerning annexation. Among the more important are: what affect it will have on taxes, zoning, school district boundaries, financial obligations to water, sewer and fire districts, street construction and maintenance, sanitary sewer facilities, water service and police and fire protection?

### Assumes Liabilities

According to state law, the city assumes both the assets and liabilities of a water, sewer or fire district if the major portion of that particular district is annexed.

Should the Berrydale district be annexed, residents who live in the area served by Elk City Water district would be responsible for their proportionate share of the bonded indebtedness of that district.

However, if the resident lives in the Berrydale area served by the Midway Water district, they would assume responsibility for bonded indebtedness because the major portion of that district would be annexed.

In the Grandview-Kenwood district, the city would assume all assets and liabilities of the Grandview and Kenwood Water districts because the major portion of each would be annexed.

Duff said the bonded indebtedness of the Midway Water district is \$74,000, and the total liability, including interest is \$96,587. Bonded indebtedness of Kenwood district is \$41,000 with a liability of \$55,430. The in-

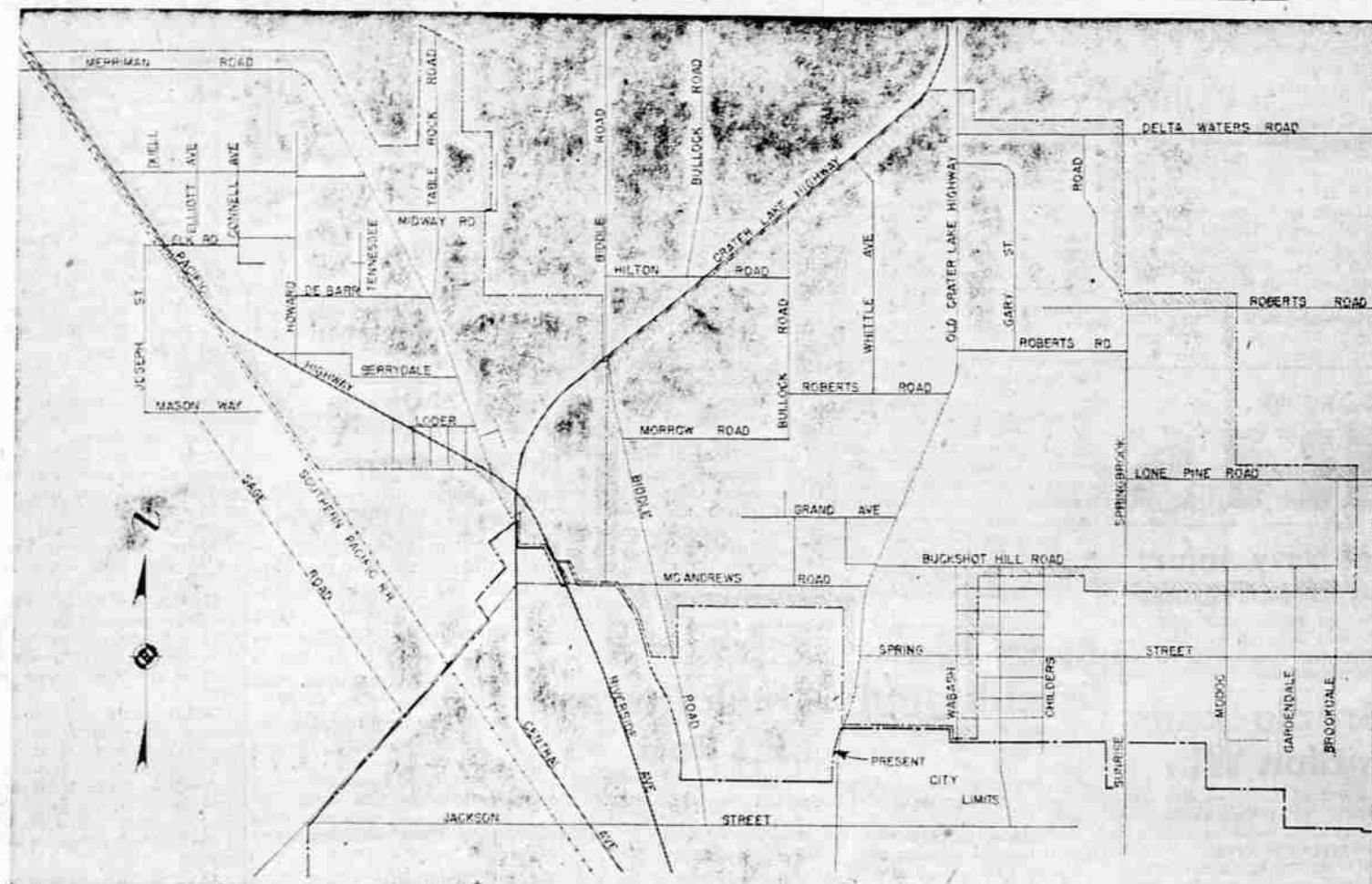

**PROPOSED ANNEXATIONS**—The Berrydale and Grandview-Kenwood districts are shown within shaded lines above. Residents of the areas will vote on annexation at the Nov. 6 general election. The Berrydale district is shown within the area west of the double shaded line extending south from Biddle rd. The general boundaries of the Berrydale district are east of Southern Pacific railroad tracks, to a point just north of Merriman rd. eastward to include a section along Table Rock rd. extending in a southerly direction to just west of Biddle rd. and south to McAndrews rd. The proposed area does not include property owned by

Medford corporation. The section enclosed in the shaded area east of the double line near Biddle rd. is the Grandview-Kenwood district. The general boundary follows a line along Crater Lake highway to north of Delta Waters rd., east to east of Springbrook rd., extending in a southerly direction to a point east of Brookdale rd., then west just south of Buckshot Hill rd., then south to the present city limits north of Jackson st., and east of Wabash ave. The Grandview-Kenwood district does not include a piece of property north of Jackson st. between Biddle rd. and Crater Lake ave.

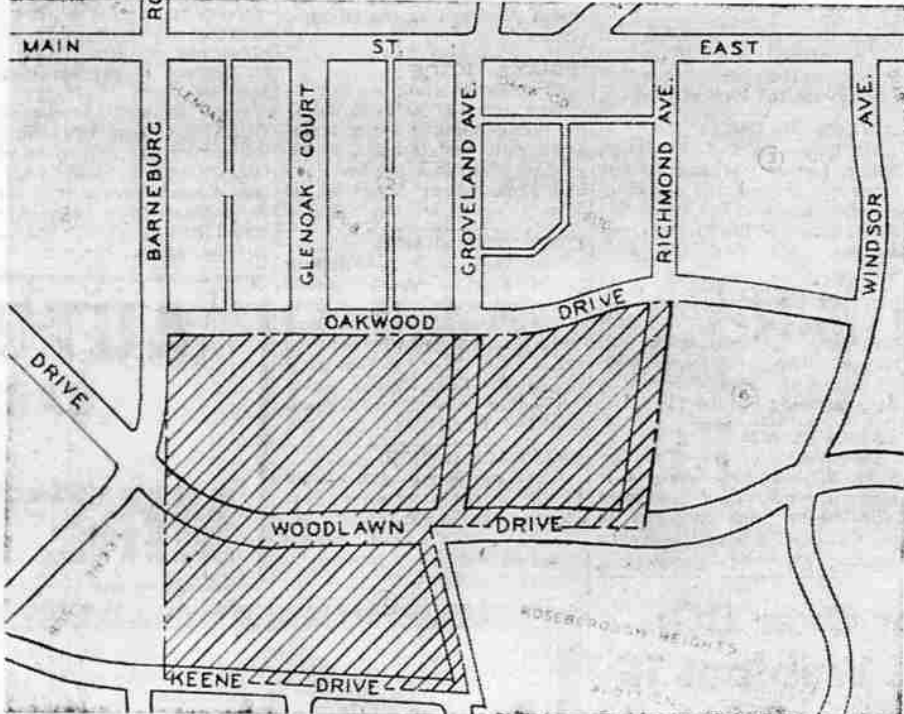

**'ISLAND' ANNEXATION**—The lined area shown above is the area in Siskiyou Heights addition proposed for annexation to Medford. Residents of the area will not vote on the proposal. Medford residents only will vote.

The area is bounded by Oakwood drive on the north, Richmond ave. on the east, along Woodlawn drive to Groveland ave., then south to Keene drive, and north to connect at the corner of Barneburg rd. and Oakwood drive.

debtedness of the Grandview area is \$112,000 with a total liability of \$160,207.

The total bonded indebtedness of the three districts is \$227,000, and the total liability is \$312,224, according to figures prepared by Duff and Assistant City Manager Gilbert.

Water commission officials estimated it would take an 80 per cent increase in Medford water rates to offset the Berrydale district debt, and about \$1.63 annually to offset the Grandview-Kenwood district debt. The total estimated increase is \$2.43 per year. The higher water rates would be both within the present city limits and in the annexed areas.

Broken down to a monthly basis, the increase would be a little more than 20 cents per month.

Duff and Gilbert have compiled figures showing the service and tax costs for proposed annexation districts compared with annual costs of services and taxes within Medford. The figures are for water and sanitary sewer service, fire insurance and fire district rates as well as the city tax.

**Hypothetical Property**  
The figures are based on hypothetical pieces of property, both in the city and in the district, with an assessed valuation of \$1,700 on the basis of the 1955-56 assessed valuation.

Cost of services and taxes to such a property in Medford are: city tax, \$32.13; water service, \$23.04; sanitary sewer service, \$6; and fire insurance, \$17.27; total, \$78.44.

Comparable cost for Berrydale property in the Midway Water district is: rural fire protection, \$8.80; water service, \$53.72; fire insurance, \$22.40; and sanitary sewer service, \$14.88. Total cost for most residents

in the Midway district is \$82.92 since there are only about 20 connections for sanitary sewer service. If residents live in the Central Point Rural Fire Protection district, the cost of protection is 51 cents.

**Elk City District**  
For those living in the Elk City Water district, the cost is: rural fire protection, \$6.80; water service, \$46.80; and fire insurance, \$22.40; total, \$76.

Costs for services in the Kenwood district are: rural fire protection, \$6.80; water service, \$66.47; fire insurance, \$22.40; total, \$95.67.

Costs for services in the Grandview district are: rural fire protection, \$6.80; water service (including millage rate and water rate), \$69.98; fire insurance, \$22.40; total, \$99.18.

(Water service rates given above are based on 8,000 gallons consumption per month. Sanitary sewer service rates are based on 8,000 gallons of sewage per month. Fire insurance rates are based on a three-year policy for an \$8,000 building and \$3,000 contents with an approved asphalt roof on the building. If the building is more than 500 feet from a fire hydrant, an additional \$2.56 should be added if outside the city limits.)

**Improvements on Request**  
Improvements, including streets, water and sewer mains, are made at the request of residents through petitions submitted to the council.

The same type street maintenance which is provided within in an annexed area. On improving streets with curbs, gutters and paving, the property owner is assessed. The city finances construction of intersections.

Residents also are assessed for installation of water mains up to six inches in diameter. The

water department finances the additional cost if the main is larger than six inches in diameter.

Trunk sanitary sewer mains are installed through sewer improvement districts within the city. Cost of lateral mains are assessed to property benefited by the improvement. Lateral mains are installed upon request by residents through petitions to the council.

**School District Boundaries**  
School district boundaries do not change with annexation. Portions of school district 549C, (Medford) and 100, (Howard) are in areas proposed for annexation. Those boundaries would not be changed unless by action of the Jackson county district boundary board, which has jurisdiction over changing school district boundaries.

Annexation would have little effect on agriculture in the areas in the immediate future. Duff said. He pointed out that agricultural uses are permitted under present city ordinances, and an agricultural zone has been proposed. A hearing on the suggested agricultural zone will be held by the council at its Nov. 7 meeting.

**Protects Investment**  
Duff noted that proper city zoning helps to protect investments in homes and businesses. City police protection would be available to both areas if annexed.

Additional fire protection also would be available. In an area protected by the Medford Rural fire district, a limited amount of equipment is required to respond. However, all equipment, if necessary, is required to respond to a call within the city. Street lights in all annexed areas are installed as the areas develop.

## Early Voting To Help Expedite Ballot Tally

The Voters Service committee of the League of Women Voters noted two items which the voter can do to expedite tallying and counting votes at the general election Nov. 6. The League consulted the county clerk's office concerning problems of administering the election.

The committee noted that early voting will help expedite counting. It recommended that if anyone was not working to make an attempt to vote before the 5 p.m. rush Nov. 6.

### Near Working Place

If the precinct polling place is near the place of work, the committee suggested the voter consult his employer and take time during the day to vote.

In regard to write-in votes, the committee urged citizens not to misuse the privilege. It noted that unless there has been considerable publicity and an organized campaign prior to the election, a write-in vote will not win an election, but will take extra time to record.

To record a write-in candidate, such as "Little Daisy," the committee noted that it takes three clerks to tally it in three books.

This constitutes a delay of perhaps three minutes for five people on the counting board while the name is entered. This costs the taxpayer about 15 cents without figuring time for the official canvass of the votes, the committee noted.

### Orchard Drainage Should Start Soon

Jackson county fruit growers should start work on orchard drainage as soon as possible, according to C. B. Cordy, county horticulture agent.

He explained that much valley floor orchard land in this area is heavy and difficult to drain. If water is allowed to stand, the quality of the soil is undermined. Also, he pointed out, if water runs off too rapidly, erosion will result.

The county agent recommended digging a series of shallow rills, running in the direction of the slope, between rows of trees. Each series of rills should be intersected with one furrow about six inches deep and 12 inches wide.

For digging the intersecting furrows, Cordy recommended using a moldboard plow or similar tool, which will throw dirt downhill rather than both up and downhill. If dirt is piled on both sides of the rills, he said, the water will not be able to drain into them.

Cordy said this method of orchard drainage has been popular and results have been good.

## Early Voting To Help Expedite Ballot Tally

The Voters Service committee of the League of Women Voters noted two items which the voter can do to expedite tallying and counting votes at the general election Nov. 6. The League consulted the county clerk's office concerning problems of administering the election.

The committee noted that early voting will help expedite counting. It recommended that if anyone was not working to make an attempt to vote before the 5 p.m. rush Nov. 6.

### Near Working Place

If the precinct polling place is near the place of work, the committee suggested the voter consult his employer and take time during the day to vote.

In regard to write-in votes, the committee urged citizens not to misuse the privilege. It noted that unless there has been considerable publicity and an organized campaign prior to the election, a write-in vote will not win an election, but will take extra time to record.

To record a write-in candidate, such as "Little Daisy," the committee noted that it takes three clerks to tally it in three books.

This constitutes a delay of perhaps three minutes for five people on the counting board while the name is entered. This costs the taxpayer about 15 cents without figuring time for the official canvass of the votes, the committee noted.

### Orchard Drainage Should Start Soon

Jackson county fruit growers should start work on orchard drainage as soon as possible, according to C. B. Cordy, county horticulture agent.

He explained that much valley floor orchard land in this area is heavy and difficult to drain. If water is allowed to stand, the quality of the soil is undermined. Also, he pointed out, if water runs off too rapidly, erosion will result.

The county agent recommended digging a series of shallow rills, running in the direction of the slope, between rows of trees. Each series of rills should be intersected with one furrow about six inches deep and 12 inches wide.

For digging the intersecting furrows, Cordy recommended using a moldboard plow or similar tool, which will throw dirt downhill rather than both up and downhill. If dirt is piled on both sides of the rills, he said, the water will not be able to drain into them.

Cordy said this method of orchard drainage has been popular and results have been good.

## 94 Precinct Polls For Election Listed

Following are the polling places in Jackson county's 94 precincts for the Nov. 6 general election ballot, as announced by the county clerk's office.

The eight single counting places are marked with an asterisk, all others are double boards.

NO.	NAME	POLLING PLACES
1	Ashland	Public Library
2	Ashland	City Hall
3	Ashland	Legion Hall
4	Ashland	First Church of Christ
5	Ashland	First Presbyterian church
6	Ashland	Calvary Baptist Church
7	Ashland	Junior High School
8	Ashland	Briscoe School
9	Ashland	Lincoln School
10	Ashland	Briscoe School Library
11	Ashland	130 4th Street
12	Ashland	Walker School
13	Ashland	S.O.C.E. Gym
14	Valley View	Valley View School
15	Barron*	Emigrant Lake Cafe
16	Bellevue	Bellevue Grange
17	Pinehurst*	Lincoln School
18	Coletine*	Sis. Q. Maint. Station
19	Lake Creek*	Lake Creek Community Hall
20	Butte Falls	Kincaid Hall
21	Eagle Point North	Teen-Age Club
22	Eagle Point South	High School Gym
23	Flourence Rock	Prospect Community Hall
24	Trail	Elk-Trail School Gym
25	Shady Cove	Shady Cove School Gym
26	Reese Creek*	Reese Creek Gospel Mission
27	Derby	Leonard Ward Residence
28	Howard	Howard School Band Room
28-A	Howard	Hauptert Tractor Co., N. Pacific Hwy.
29	Howard	CAP Building Airport
29-A	Howard	McCormick Farm Equip Co., 2232 Biddle Rd.
30	Roxy Ann	1060 Crater Lake Ave.
31	Hillcrest	Hillcrest Orchard Home
32	Medford	Nazarene Church Annex
33	Medford	Free Methodist Church Annex, 337 West 10th St.
34	Medford	City Hall
35	Medford*	Eads Transfer, 123 S. Front St.
36	Medford*	610 South Central Ave.
37	Medford	Lincoln School
38	Medford	1228 North Riverside Ave.
39	Medford	St. Mary's Gym
40	Medford	Court House
41	Medford	701 Park St.
42	Medford	Modern Plumbing, East Jackson St.
43	Medford	Boy Scout Headquarters
44	Medford	120 Ashland Ave.
45	Medford	Roosevelt School
45-A	Medford	Church of the Brethren
46	Medford	Hedrick Junior High School
46-A	Medford	2415 Lyman Ave.
47	Medford	Washington School, Peach St. Entrance
47-A	Medford	Washington School, Dakota St. Entrance
48	Medford	Fire Hall, 8th and Lincoln Sts.
49	Medford	Assembly of God Church Annex
50	Medford	317 North Columbus Ave.
51	Medford	Jackson School
52	Medford	548 Fairmont St.
53	Medford	St. Mark's Guild Hall
54	Medford	Parish Hall Catholic Church
55	Medford	Senior High School Girls Gym
55-A	Medford	Senior High School Auditorium
56	Medford	116 South Modoc Ave.
56-A	Medford	1315 Bundy St.
57	Orchard Home—East	Jefferson School, Gym
58	Orchard Home—West	1840 Stewart Ave.
59	Phoenix—East	Presbyterian Church
60	Phoenix—West	Phoenix New School Gym
61	Phoenix Southwest	Grange Hall
62	Talent—West	Old School Gym
63	Talent—East	City Hall
64	Griffin Creek	Griffin Creek School
65	Jacksonville—North	Jacksonville Community Hall
66	Jacksonville—South	Odd Fellows Hall
67	Perrydale—North	Oak Grove School Gym
68	Perrydale—South	Temple Baptist Church
69	Central Point—West	John Robison Res., 136 Main St.
70	Central Point—N. East	Crater High School Music Rm.
71	Central Point—S. East	Legion Hall
71-A	Central Point—S. East	Junior High School Old Gym
72	Willow Springs	Willow Springs School
73	Camp White	Post Office Bldg., Camp White
73-A	Mound	Table Rock School
74	Sams Valley	Sams Valley School
75	Wimer	Wimer Grange Hall
76	Rogue River—East	Live Oak Grange Hall
77	Rogue River—West	V.F.W. Hall
77-A	Rogue River—West	Rose Gardens, 4956 Pacific Hwy.
78	Gold Hill—North	City Hall
79	Gold Hill—South	Old Hardware Store
80	Foots Creek*	Community Hall
81	Applegate*	School Gym
82	Union	Ruch School Gym
83	Watkins*	Route 2, Box 67A, Upper Applegate rd.
84	Sterling*	Old West Place, Applegate rd.

mary election in Jackson county.

The committee said the write-in vote privilege is not intended as an obstruction of democratic rights, but merely as an educational gesture. It cautioned against the careless use of the privilege.

### TWO ACCIDENTS

Waterbury, Conn.—(U.P.)—Mrs. Lucia Antonacci, 68, was hospitalized because of an automobile accident in which she was injured. She stepped from the wrecked car and tumbled down a bank, suffering a concussion.

## TIRED 'TIL IT HURTS?

Just 6¢ a Day Can Help Build Rich, Red Blood... Save You from being Dragged Out... EASY PREY TO MINOR ILLS.

Nutritional experts reveal vitamin losses in cooked foods plus faulty diet may be seriously undermining your energy, strength, and resistance, making you feel on edge—affecting your appetite—spoiling your sleep—because your body is vitamin and iron starved.

How You Can Stop Chronic Vitamin & Iron Starvation TODAY... Feel Like a New Person!

Supplement your diet every day with just one High-Potency Bexel Capsule. Just one of these wonderfully strengthening capsules give you the full vitamin and iron content nature provided in the following groups of foods before cooking:

1 quart of pasteurized milk 1/2 lb. of ham  
4 oz. of fresh orange juice 1 lb. of beef  
1 lb. of lean beef 1/2 lb. of butter  
1 lb. of lean pork 1/2 lb. of oatmeal  
1/2 lb. of green string beans

Penny for Penny... You Get More Value in High-Potency BEXEL

SPECIAL FORMULA VITAMIN CAPSULES Feel Better... Look Better... Work Better... YOUR MONEY BACK!

Central Rexall Drug Main & Central

## If You Have a HEARING LOSS...

HERE ARE A FEW WORTHWHILE SUGGESTIONS TO CONSIDER BEFORE BUYING A HEARING AID.

- FIRST See a Doctor for an examination. Many cases of deafness are caused by an accumulation of wax in the ear and you may not need a hearing aid.
- SECOND See a local dealer who can be found if your hearing aid needs attention.
- THIRD Try a hearing aid in your home, at church or meetings before you buy.
- FOURTH Don't be misled by fake ads such as NO BUTTON, NO COIL, NO BATTERY, NO TUBES. These are "come-on" ads to sell high priced unheard of hearing aids with no guarantee.
- FIFTH See the dealer who wears a hearing aid and understands the problems of the hard of hearing.

## GEORGE E. WHITE

THE FINEST IN HEARING AIDS Eye Glass Hearing Aids — Eye Glass Hearing Aids Using Your Own Glasses — Behind the Ear Hearing Aids — Conventional Hearing Aids

FROM \$50 UP 131 West Main Street, Medford PHONE 3-1841 FOR APPOINTMENT AT YOUR HOME

## BUFFALOED?

ARE YOU BUFFALOED BY MEDFORD'S PARKING PROBLEM?

THEN INFORM YOURSELF AND VOTE 51 (X) YES

LET PARKING PAY FOR ITSELF

The Self Supporting Plan Will Be Advanced by

1. A portion of present parking meter revenues.
2. Special assessment on downtown business buildings affected.
3. Additional parking meter revenues from off-streets lots.

VOTE 51 (X) YES

Citizens' Off Street Parking Committee