

# Farm Prices Decline Three Per Cent During Month Ending Aug. 15

Washington — (U.P.) — Farm prices — a particularly potent political factor in this election year — took a sudden drop in mid-August, wiping out some of the gain made earlier this year. The Agriculture Department's monthly price report showed that farm prices skidded three per cent during the month ending Aug. 15. The decline was the sharpest since the May-June 1954 report when a three per cent drop was recorded.

The decline in prices received coupled with the rise in production costs, brought the parity ratio down to 82 per cent from 85 per cent in mid-July. The ratio in mid-August, 1955, was 83 per cent. The ratio last December, when postwar lows were recorded, was 80 per cent. "The decline reported was in crops and, except for potatoes, was largely of a seasonal nature," Benson said in a statement. "Seasonal price declines for crops are usual at this time of the year when the nation's harvests are coming to market in large seasonal volume."

## New S. F. Bay Span Opened To Auto Traffic

Richmond — (U.P.) — Automobile traffic rolled across the new Richmond-San Rafael Bridge Friday for the first time.

The \$68 million span, second largest high over-water bridge in the world, was dedicated Friday by Gov. Goodwin J. Knight and opened to traffic at midnight.

The 5½-mile-long bridge, exceeded in length only by the San Francisco-Oakland Bay Bridge, is the fifth link joining counties across San Francisco Bay.

Some 1,000 persons were on hand to hear Knight dedicate the span "to the men and women who conceived it and to those whose hearts, hands and minds fashioned it."

30 Years of Planning

The dedication marked the climax of more than 30 years of planning. The first study of the project was made in 1926. It was authorized in 1952 and construction began in early 1953.

The opening of the span marks the end of ferry service between San Rafael and Richmond. The familiar ferries shuttling back and forth had operated on the Bay since 1915.

The bridge, at the northern end of the bay, links Contra Costa county, with Point San Quentin near Marin county's famous state prison.

Estacada — (U.P.) — Dr. Ralph J. Svehaug, mayor of Estacada, said today he will present his resignation to the city council at its Sept. 6 meeting. He said he and his family are moving to Seattle.

HARD TO BEAT HEAT

Des Moines — (U.P.) — A thief with a strong back and an urge to beat the heat stole a 100-pound air conditioner from an office window Friday.

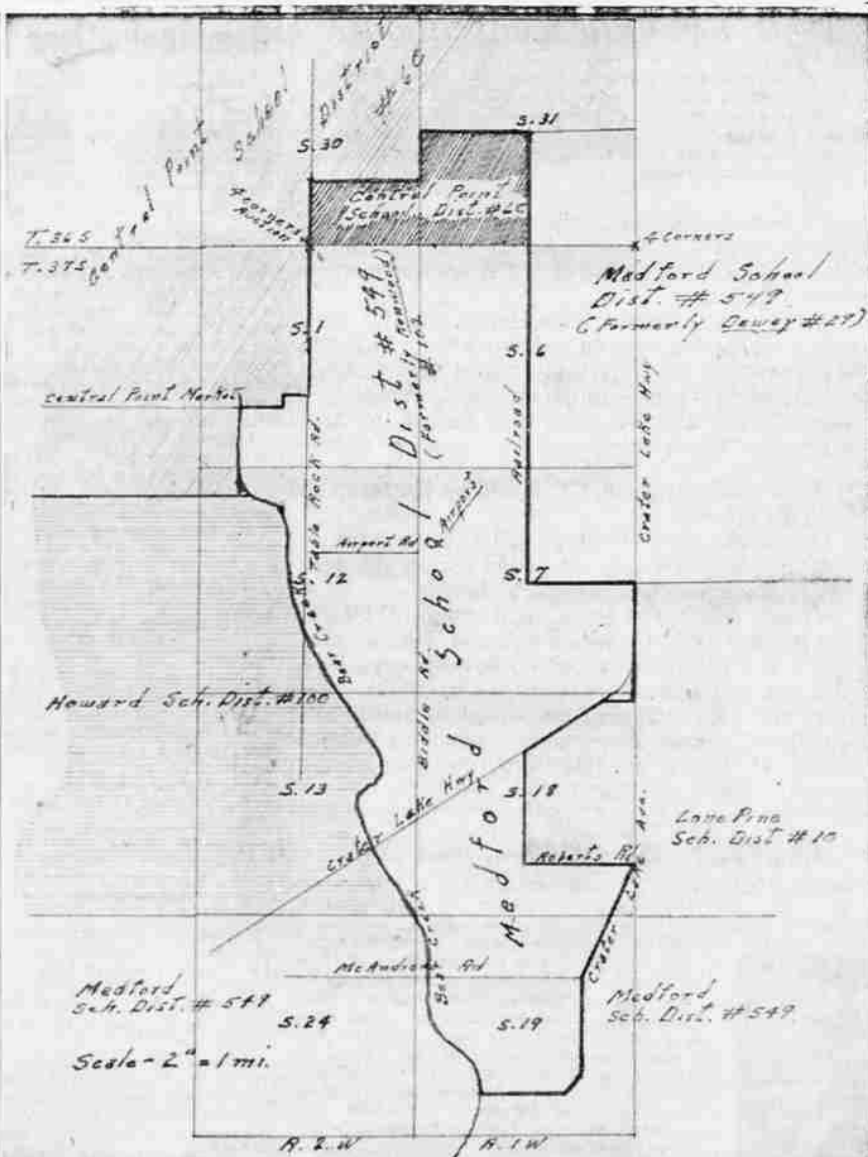

## New Rope Factory Planned at Salem

Salem — (U.P.) — The Plymouth, Mass., Cordage Co. has announced plans to construct a new rope factory on a 9½-acre North Salem site.

How big the plant will be has not been decided.

Salem Chamber of Commerce Manager Stanley Grove said the size of the plant will depend on results of a market survey now being made by the company.

The 132-year-old company has seven branch plants and two subsidiary companies in Canada. Its products include ropes of all kinds, harvest twine, paper-twist material used in manufactured products and other items.

## DISTRICT SHIFT—Revised boundaries of the former Kenwood school district 102, as changed by the Jackson county district boundary board are shown above.

Most of the former Kenwood district, except for the dark area on the northern tip, now Central Point 6-C, has been annexed by Medford school district 549-C. Another small area in the former Kenwood district, bounded on the south by Roberts rd., was granted permission by the boundary board to join Lone Pine school district 10. All elementary school students and students entering high school for the first time this fall must attend schools designated by their districts, according to County Superintendent of Schools Alf Mervold. He said that sophomores, juniors and seniors who have already attended one year of school at either Medford or Central Point High schools, but because of the boundary revisions are now located in the other district, can continue attending their former school if they desire to. The school district boundary revisions were a result of a law passed by the 1953 Oregon legislature ordering all organized school districts that had not maintained a public school for at least two years either to join a district or be annexed by a district operating a public school.



WAYNE STRUBLE To Head New Office

## Architects Open Office in Medford

Wayne Struble, member of the firm of James L. Payne, A.I.A., and Associates, Salem architects, has been named head of the firm's new Medford branch office at 611½ East Jackson st.

The company, headed by James L. Payne, has designed several commercial, industrial, religious and public structures throughout the state, including Medford's Methodist church chapel designed in 1955.

Struble is a native of Salem, married and the father of three children. He has been with the Payne organization 4½ years. He is a graduate of the school of architecture at the University of Oregon and also attended Oregon State college, Ohio Wesleyan university and Rensselaer Polytechnic Institute in New York. He is a member of Theta Chi fraternity.

## Former Superintendent Takes New Position

Ashland — Leland P. Linn, former superintendent of the Ashland school district, has taken an administrative position with the Neward, Calif., school district, it was learned here last week.

Linn attended the University of California at Berkeley until the end of July and visited relatives at Stackton and San Jose during August. Mr. and Mrs. Linn are now living at Newark, located near Menlo Park.

Use Mail Tribune Want Ads For Quick Cash The Community's Biggest Marketplace

## Lausman Gives Lead Blocks to Museum

Portland — Two high lead blocks with 36 inch diameter sheaves weighing 1,283 pounds each, have been donated by A. A. Lausman, Medford lumberman, to the Pioneer Logging museum, located in the park beside the old forestry building in Portland.

The king-size "pulleys" were manufactured in 1920 when high lead logging was at its heyday. The industry then used super-powered steam donkeys for hauling long distances and the motto was "speed and power." The blocks were hung high on spar trees to carry the 1½ inch diameter steel cables from 12x14 wood-burning donkey engines.

Such tackle has now gone largely out of use with the advent of crawler tractors, trucks and truck roads and small donkeys in the Douglas fir woods, but the blocks are considered to have great historical value.

The heavy blocks and their rigging were hauled to Portland from Medford by Pierce Freight lines without cost, according to Thornton T. Munger, chairman, Gallery of Trees committee.

## FRENCH GET IRISH STEW

Paris — (U.P.) — French troops moving into newly christened "Camp Verdun" on Cyprus were told by cooperative British cooks they would be welcomed with "some real French cooking," reports reaching here said. The troops were welcomed with Irish stew and plum pudding.

## On The Side

By E. V. Durling

(Distributed by King Features Syndicate, Inc.)

What is the most dangerous day of the week to drive an automobile in this country? The answer is Saturday. Next, in that respect, is Sunday. Most fatalities from auto accidents occur on week ends. There is a belief that most automobile accidents take place at night and on wet roads. That's wrong. Seventy per cent of fatal accidents take place in clear weather on dry roads. Excessive speed is, of course, the major cause.

### Says He

"The saying, 'Where the hair is thin the brains are thin' is a false and insulting statement maliciously circulated by those thick haired and thick headed nincompoops, who are envious of the success of bald-headed men," writes a Baltimorean. "Remember the so-called 'bald-headed row' in theatres? It was the first row. The highest priced row in the house. The bald-headed men had that price because of their outstanding salary earning ability. Look around any restaurant, night club or social gathering and you will note the most beautiful women are escorted by bald-headed men. That is because bald-headed men are not only good providers and generous spenders but are great lovers. Also keep in mind that, no matter who wins the next election, the United States will have a bald-headed president!"

### Among the Married

Music for expectant mothers. That is the general title of a recently issued long playing record. It includes such songs as "Try A Little Tenderness," "My Shining Hour," "My Blue Heaven," "My Baby's Comin' Home." No doubt this disc will have a soothing effect on expectant mothers. But how about the expectant fathers? How about the nerves of the papa-to-be? There should be a record for him, too. But what songs would be most appropriate? How about "Molly and I and the Baby?"

Or "Rock-a-Bye Your Baby With a Dixie Melody?" Or "Sonny Boy?" Other ditties the expectant father might find soothing are "Somebody's Coming to

Our House," "Thank Your Father," "Just a Baby's Prayer at Twilight" and "Baby's Got a Tooth."

### Please Note

The play by Lynn Riggs titled "Green Grow the Lilacs" only ran 64 performances but when it was musicalized and titled "Oklahoma," it ran in New York for 2,248 performances. So, it is not difficult to understand why so many producers are planning musicalized versions of straight stage plays.

### Asking

Queries from Clients. Q. Was Amelia Bloomer, originator of bloomers, a blonde or brunette? A. She was red-haired. Q. I claim there were never any trolley cars in the borough of Manhattan, only cable cars. Right? A. Wrong sir. However, there never have been any overhead trolley cars in Manhattan. They were underground and operated through a slot which made the cars bear a resemblance to cable cars. Q. What was Flo Ziegfeld's last show? A. A revival of "Show Boat" in 1932 featuring Dennis King and Paul Robeson. Q. Who first said, "Money will not bring you happiness but it soothes the nerves?" A. Sean O'Casey, the Irish playwright.

### Visual Phone

The visual telephone, which enables the callers to see each other, has been in operation in Europe for nearly 20 years. It will soon be available in this country. When the bell rings on

the visual telephone, you dial for a view of the caller. It will be very interesting to get a look at some of the people who have the wrong number. Especially if they are females with low throaty voices. Incidentally, when you call some woman, her answer may be much delayed. She is not going to let you see her until she applies some make-up or, if necessary, adds to her attire.

Use Tribune Want Ads Easy, Just Dial 2-6141

**SHADE TREES**  
In Containers  
TO PLANT NOW  
**\$1.98**  
Each  
Tulip Trees  
Chinese Elms  
Sweet Gums  
**Dwarf Fruit Trees**  
In Containers  
TO PLANT NOW  
—APPLES—  
Red Delicious  
Gravenstein  
Yellow Transparent  
PEARS—Comice, Bartlett  
**GARDEN CENTER NURSERY**  
(formerly Newhall's)  
½ mi. So. of Phoenix on Hwy. 99  
PHONE 2-7601

**Happy Hotpoint Says:**  
In 1947 Hotpoint embarked on a \$70,000,000 expansion program to produce better products at lower cost.  
**CITY APPLIANCE**  
127 No. Central Ave. Phone 3-5306

## Real Estate Meet Scheduled in Salem

Salem — The 1956 Oregon Real Estate Convention will be held here Sept. 16-18, with Clarence M. Turley, St. Louis realtor and president of the National Association of Real Estate Boards, as the keynote speaker.

Others on the program include Gov. Elmo Smith, Alec G. Nichols, of Los Angeles; Dr. Frank Bennett, president of Eastern Oregon College of Education, La Grande; and Grace Sebastian, president of the National Women's council, Sacramento.

Reservations for the convention may be mailed to the Real Estate convention committee, Box 549, Marion hotel, Salem.

## Sen. Jackson Leaves For Central Asia Tour

Moscow — (U.P.) — Sen. Henry M. Jackson (D-Wash) left Moscow Friday for a tour through Central Asia, where he plans to visit Alma-Ata, Tashkent and Kabul.

Jackson, who arrived in the Soviet Union Aug. 19, will stop in Pakistan and Israel on his return trip to the United States.

## Mothers - - Send them back to school in shoes that FIT... really FIT! America's Favorite Children's Shoes.

**LAREDO**  
Cherry red two-strap loafer. 12½ to 3. A to C. \$7.95

**WABASH**  
Always good brown moc. toe oxford. AA to 3. 8½ to 12... \$6.95  
12½ to 3... \$7.95

**LITTLE SIOUX**  
What every girl wants for school. Brown loafer. A to C. 12½ to 3... \$7.95

**LITTLE YUMA**  
Just the shoe for school or dress. AA to D. 8½ to 12... \$6.95  
12½ to 3... \$7.95

**SADDLE**  
Nothing better for school, Br. and white smk. and tan or all over white. AA to D. 8½-12 \$6.95  
12½-3 \$7.95

**Buster Brown**  
America's Favorite Children's Shoes

**SAXTON**  
Brown scuff tip and scuff back. 8½ to 12 \$6.95  
12½ to 3 \$7.95

Also Available at...  
Park View Dept. Store, Ashland  
Buster Brown Shoe Store, Grants Pass

**Buster Brown Shoe Store**  
15 South Central Fluhler Building

**NEW!**  
like home made

**SKIPPY**  
Pet STEW  
DOGS & CATS

**Montgomery Ward**  
**FORECAST FOR FALL 1956**  
More for your money at Wards

YOU DO GET MORE for your money when you shop Wards new Fall Sale Book! There's proof on every page... Just get your FREE copy now, then see for yourself all the extra savings on seasonal items for family and home. Shop today, for top values like these!

|                                      | REG.     | NOW     |
|--------------------------------------|----------|---------|
| Royal "Aristocrat" Typewriter        | \$111.23 | \$84.88 |
| Zipper Binder, Split Cowhide         | 3.49     | 2.98    |
| Boys' Lined Leather Jacket           | 14.98    | 12.98   |
| Girls' Lined Wool Tweed Classic Coat | 19.98    | 13.97   |
| Electric Hair Clipper Set            | 11.85    | 7.95    |
| Cold Weather Hunting Coat            | 13.95    | 12.44   |
| Clear Plastic Auto Seat Covers       | 16.45    | 15.47   |
| Westinghouse Porta-Vac               | 49.95    | 29.95   |
| Facial Cleansing Tissues, 4 Boxes    | 1.29     | 1.16    |
| Dacron Lace Tablecloth, 58x80 in.    | 15.98    | 11.97   |

SHOP AT HOME BY PHONE—CALL 2-4546, 2-8075