

The Mail Tribune Special Offer Closes Tomorrow Night at 11 o'Clock

The Great Special Offer Made to All Contestants for New Subscribers Proved Popular Beyond All Expectations and Many Candidates Are Entitled to the Extra Votes—Still Time to Get Many Subscribers Before This Offer Closes—Contest Does Not Close Until Saturday, October 29.

The Prizes

ONE FIVE-PASSENGER TOURING AUTOMOBILE ON DISPLAY IN FRONT OF THE MAIL TRIBUNE OFFICE

GRAND PRIZES

- TWO \$400 PIANOS.
- TWO \$100 DIAMOND RINGS.
- TWO BUSINESS SCHOLARSHIPS.
- TWO BEAUTIFUL LADIES' GOLD WATCHES.

Mother cuts out coupons,
So does Sister Ann;
Everybody cuts out coupons,
Even my old man.

—From the Lyrics of the Contest Editor

SPECIAL NOTICE

Sixty months new business to the Mail Tribune will entitle you to a special ballot of 100,000 votes. Each and every month over the sixty may be able to secure, will entitle you to a proper proportion of another 100,000. In other words the larger number of new months, the larger your special offer ballot will be, and the better the chance for winning the automobile and \$25 in gold will be.

The great special offer made to the contestants closes tomorrow night at 11 o'clock. In order to have subscriptions count on this special offer, all subscriptions must be received at the Mail Tribune office by this hour. To give the contestants in the territory outside the city the same amount of time to work as those inside the city, the management will accept all subscriptions sent to them that are mailed before 11 o'clock, Saturday evening, but the envelope must bear the postmaster's name and date and hour mailed, written on the outside of the envelope.

Two new six months subscriptions will count as one year on this offer. A two, three, four or five year subscription will also apply on this special offer as so many months new business. No contestant is restricted as to the number of times she may qualify for this offer. If she is able to secure ten yearly subscriptions she will receive a ballot of 200,000 votes, or in proportion to the number turned in. The larger number of new months, the larger your special offer ballot will be.

those who get out and worked. Do not let the days slip by and think you will get a bunch of subscriptions the last few days, but hustle today—right now—and see how many you can get. You may be able to get enough to easily win one of the grand prizes.

Small Payments. Candidates that have taken subscriptions for one, two or three months at the beginning of the contest should get these subscribers to pay for the rest of the year as they are now considered new.

For example, a person who has subscribed for the paper and paid 50 cents received 700 votes, by getting them to pay \$2.00 more you will be given 7000 votes less than the 50 cent payment, or 700 votes. The new months will also count in on the special offer now in vogue. When turning in such payments kindly mark your stub "second payment."

The contest closes Saturday evening, October 29, at 11 o'clock. The special offer closes Saturday evening, October 15, at 11 o'clock.

Be sure your name is on all ballots and coupons before putting them in the ballot box.

The contest department telephone number is Main 3027.

Coupons and nomination blanks must be cut around the outer dark lines. Nomination blanks are still good, and count for 20 votes each.

The contest department is always open. Call or telephone if you desire information. Old subscribers paying arrearages or in advance are entitled to votes. Ask for them.

Cut the coupon and nomination blanks from the paper and help that young woman win the prize.

Vote as often as you wish. It costs absolutely nothing to vote in the Mail Tribune popular contest.

For the benefit of those who are not able to get to this office during business hours the contest department will be open every evening until 9 o'clock.

DISTRICT NO. 1. Includes All the Territory in the City of Medford.

Marie Elbert, N. Front	243,170
Ellis Gausman, 197 N. Central	249,220
May Buchanan, 306 E. Taylor	242,720
Miss Bailey, N. Front	241,560
Miss Crawford, pianist, Nash	241,560
Bernice Carder, 210 W. Jackson	239,440
Grill	242,180
Francis Durham, 119 S. Holly	238,220
Bordina Boucome, Tenth St	241,720
Mabel Ray, 1104 W. Main	240,260
Hazelle Tice, 208 N. Central	237,960
John Flynn, 305 N. Tenth	243,720
Maud S. Gaine, S. Grape	240,260
Mary S. Haswell, S. O. Produce	238,180
Nellie Storm, 219 S. Central	273,650

Maybelle Jones, Hussey's store	220,850
Agnes McMahon, 107 1/2 S. Ivy	231,770
Mrs. W. M. Ford, Portland ave.	232,460
Myrtle Calhoun, S. R. Central	228,760
Anna Smith, 20 S. Ivy	226,740
Bertha Dalley, 108 S. Ivy	225,490
Mary Gore, 429 S. Central	219,140
Meda Bibe, 28 N. Court	220,190
Maude Ling, East Main	219,750
Jennie Dodge, 619 S. Oakdale	222,916
Eva Jane Johnson, 312 Oakdale	218,410
Anna Peterson, S. Holly	205,450
Kittie Burgess, 335 Orange	224,760
Ruth Van Dyke, 2 W. 12th	182,140
Edna Goodgrass, 344 S. Central	181,760
Eula Jacobs, 112 S. Central	179,820
Nellie Evans, Pacific Tel. Co.	179,820
Maybelle Kincaid, 209 Apple St.	169,260
Mary Payne, 135 N. Bartlett	135,820
Huby Burke, 30 and N. Bartlett	133,470
Hazelle Hazdale, S. Riverside	130,160
Harriett Paul, 825 W. Ninth	119,150
Mary Kirtland, 204 S. Grape	84,810
Ona Humphrey, 104 S. Grape	78,900
Kimra Wilson, Spirella Parlors	77,480
Mrs. E. Gregory, 232 E. Main	78,120
Jessie Cole, 705 N. Central	74,860
Ida Thornburg, S. Holly	62,170
Hattie Allen, 513 W. Tenth	66,270
Nina Bakeman, 140 N. Tenth	64,170
Julia C. Field, 710 E. Main	45,110
Clara Springate, 204 Central	43,670
Miss Andrews, east end E. Main	41,950
Lucy Harmon, Grants Pass	41,270
Luella Campbell, 714 W. 8th	41,270
Cladya Heard, east end E. Main	41,270
Enid Hamilton, N. Central	34,720
Mabel Mickey, 33 S. Fir	26,120
Grace McCoy, 219 S. Central	24,150
Enid Hartley, S. R. Third	24,150
Eather Murphy, 511 N. Fir	24,720
Vintha Hamilton, N. Central ave.	19,190
Elvira Hewes, 50 W. Main	18,660
Jessie Pandy, S. Holly	11,350
Millicent Potter, 145 N. Oakdale	7,260
Grace Brown, 1321 W. Taylor	5,740
Rebecca Clifton, 104 S. Newtown	210
Mrs. Plaster, Montgomery Co.	230
Eva Hayes, city	20
Fussy Davis, 1412 W. Main	30
Mrs. W. Bill, West Medford	20

Lea Middlebushel, Trail	14,450
May Ham, Ashland	10,240
May Howe, Trail	5,710
Inez Willets, Perist	2,150
Ella Stoles, Woodville	410
Clatouse McCredie, Central Point	310
Gertrude Nichols, Butte Falls	50

CITY NOTICES

ORDINANCE NO. 386.

An ordinance declaring the cost of the improvement of Summit avenue from W. Main St. to W. 4th St., and assessing the property benefited thereby, and declaring such assessment, and directing the entry thereof in the docket of city liens.

The city of Medford doth ordain as follows: Section 1. That no protests having been filed against the improvement of Summit avenue due notice of the intention of the council to cause said improvement to be made having been given, and said improvement having been ordered made the council has considered the matter and herewith ascertains the probable cost of making such improvement to be the sum of \$5194.80.

And said council further finds that the special and peculiar benefit accruing upon each lot or part thereof adjacent to said improvement and in just proportion to said benefits, to be the respective amounts hereinafter set opposite the number or description of each lot or part thereof, and such amounts respectively are hereby declared to be the proportionate share of each lot or parcel thereof, of the cost of such improvement, and is hereby declared to be assessed against said lot or parcels respectively, the name appearing above each description being the name of the owner of such lot or parcel.

ASSESSMENT FOR PAVING SUMMIT AVENUE FROM WEST MAIN STREET TO WEST FOURTH STREET.

Assessment No. 1—Picket, Klum & Murphy, Lot 1, block 2, Summit addition to the city of Medford, Oregon; frontage 50 feet on the west side of Summit avenue, and described in Vol. 72, page 121, county recorder's records of Jackson county, Oregon; 50 feet; rate per foot \$3.51; amount \$175.50.
Assessment No. 2—Picket, Klum & Murphy, Lot 2, block 2, Summit addition to the city of Medford, Oregon; frontage 50 feet on the west side of Summit avenue, and described in Vol. 72, page 121, county recorder's records of Jackson county, Oregon; 50 feet; rate per foot \$3.51; amount \$175.50.
Assessment No. 3—Picket, Klum & Murphy, lot 3, block 2, Summit addition to the city of Medford, Oregon; frontage 50 feet on the west side of Summit avenue, and described in Vol. 72, page 121, county recorder's records of Jackson county, Oregon; 50 feet; rate per foot \$3.51; amount \$175.50.

CITY NOTICES.

Assessment No. 4—Picket, Klum & Murphy, Lot 4, block 2, Summit addition to the city of Medford, Oregon; frontage 50 feet on the west side of Summit avenue, and described in Vol. 72, page 121, county recorder's records of Jackson county, Oregon; 50 feet; rate per foot \$3.51; amount \$175.50.
Assessment No. 5—Picket, Klum & Murphy, Lot 5, block 2, Summit addition to the city of Medford, Oregon; frontage 50 feet on the west side of Summit avenue, and described in Vol. 72, page 121, county recorder's records of Jackson county, Oregon; 50 feet; rate per foot \$3.51; amount \$175.50.
Assessment No. 6—Picket, Klum & Murphy, Lot 6, block 2, Summit addition to the city of Medford, Oregon; frontage 50 feet on the west side of Summit avenue, and described in Vol. 72, page 121, county recorder's records of Jackson county, Oregon; 50 feet; rate per foot \$3.51; amount \$175.50.
Assessment No. 7—Picket, Klum & Murphy, Lot 7, block 2, Summit addition to the city of Medford, Oregon; frontage 50 feet on the west side of Summit avenue, and described in Vol. 72, page 121, county recorder's records of Jackson county, Oregon; 50 feet; rate per foot \$3.51; amount \$175.50.
Assessment No. 8—Picket, Klum & Murphy, Lot 8, block 2, Summit addition to the city of Medford, Oregon; frontage 50 feet on the west side of Summit avenue, and described in Vol. 72, page 121, county recorder's records of Jackson county, Oregon; 50 feet; rate per foot \$3.51; amount \$175.50.
Assessment No. 9—Picket, Klum & Murphy, Lot 9, block 2, Summit addition to the city of Medford, Oregon; frontage 50 feet on the west side of Summit avenue, and described in Vol. 72, page 121, county recorder's records of Jackson county, Oregon; 50 feet; rate per foot \$3.51; amount \$175.50.
Assessment No. 10—Picket, Klum & Murphy, Lot 10, block 2, Summit addition to the city of Medford, Oregon; frontage 50 feet on the west side of Summit avenue, and described in Vol. 72, page 121, county recorder's records of Jackson county, Oregon; 50 feet; rate per foot \$3.51; amount \$175.50.
Assessment No. 11—Picket, Klum & Murphy, Lot 11, block 2, Summit addition to the city of Medford, Oregon; frontage 50 feet on the west side of Summit avenue, and described in Vol. 72, page 121, county recorder's records of Jackson county, Oregon; 50 feet; rate per foot \$3.51; amount \$175.50.
Assessment No. 12—Picket, Klum & Murphy, Lot 12, block 2, Summit addition to the city of Medford, Oregon; frontage 50 feet on the west side of Summit avenue, and described in Vol. 72, page 121, county recorder's records of Jackson county, Oregon; 50 feet; rate per foot \$3.51; amount \$175.50.
Assessment No. 13—C. W. Snyder. A parcel of land commencing at the northwest intersection of Summit avenue and West Main street, city of Medford, Jackson county, Oregon, and running thence north along the west line of Summit avenue 140 feet; thence west at right angles 113 feet; thence south at right angles 140 feet to the north line of West Main street; thence east along north line of West Main street to point of beginning and marked AW on the map of the city of Medford; frontage 140 feet on the west side of Summit avenue, and described in Vol. 65, page 321, county recorder's records of Jackson county, Oregon; 146 feet; rate per foot \$3.51; amount \$491.40.
Assessment No. 14—Picket, Klum & Murphy, Lot 1, block 1, Summit addition to the city of Medford, Oregon; frontage 50 feet on the east side of Summit avenue, and described in Vol. 65, page 321, county recorder's records of Jackson county, Oregon; 50 feet; rate per foot \$3.51; amount \$175.50.
Assessment No. 15—Picket, Klum & Murphy, Lot 2, block 1, Summit addition to the city of Medford, Oregon; frontage 50 feet on the east side of Summit avenue, and described in Vol. 65, page 321, county recorder's records of Jackson county, Oregon; 50 feet; rate per foot \$3.51; amount \$175.50.
Assessment No. 16—Picket, Klum & Murphy, Lot 3, block 1, Summit addition to the city of Medford, Oregon; frontage 50 feet on the east side of Summit avenue, and described in Vol. 65, page 321, county recorder's records of Jackson county, Oregon; 50 feet; rate per foot \$3.51; amount \$175.50.
Assessment No. 17—Picket, Klum & Murphy, Lot 4, block 1, Summit addition to the city of Medford, Oregon; frontage 50 feet on the east side of Summit avenue, and described in Vol. 65, page 321, county recorder's records of Jackson county, Oregon; 50 feet; rate per foot \$3.51; amount \$175.50.
Assessment No. 18—Picket, Klum & Murphy, Lot 5, block 1, Summit addition to the city of Medford, Oregon; frontage 50 feet on the east side of Summit avenue, and described in Vol. 65, page 321, county recorder's records of Jackson county, Oregon; 50 feet; rate per foot \$3.51; amount \$175.50.
Assessment No. 19—Picket, Klum & Murphy, Lot 6, block 1, Summit addition to the city of Medford, Oregon; frontage 50 feet on the east side of Summit avenue, and described in Vol. 65, page 321, county recorder's records of Jackson county, Oregon; 50 feet; rate per foot \$3.51; amount \$175.50.
Assessment No. 20—Picket, Klum & Murphy, Lot 7, block 1, Summit addition to the city of Medford, Oregon; frontage 50 feet on the east side of Summit avenue, and described in Vol. 65, page 321, county recorder's records of Jackson county, Oregon; 50 feet; rate per foot \$3.51; amount \$175.50.
Assessment No. 21—Picket, Klum & Murphy, Lot 8, block 1, Summit addition to the city of Medford, Oregon; frontage 50 feet on the east side of Summit avenue, and described in Vol. 65, page 321, county recorder's records of Jackson county, Oregon; 50 feet; rate per foot \$3.51; amount \$175.50.

Farm Land and Orchards

- 296 ACRES near Brownsboro, subject to Fish Lake Ditch, \$30,000.
- 240 ACRES, all bottom land, good water right, 12 miles from Medford, 3 1/2 miles from railroad station; \$80.00 per acre.
- 625 ACRES, 3 1/2 miles from Medford, 125 acres in 1 and 3-year-old trees, all fine soil; a first class set of buildings, teams and tools go in; the best value in Jackson county for the price; \$181 per acre.
- 53 ACRES Bear creek bottom, subject to irrigation; well located; \$250.00 per acre.
- 10 ACRES in full bearing orchard, 1 3-4 miles from Medford; seven-room house, fine team and tools go in; \$14,000. We have other propositions as good. Come and see us.

CITY LOTS AND RESIDENCES

- 1 ACRE, with two 5-room cottages and barn; West Side; \$3500.00.
- 4 LOTS 50x106, with five-room cottage, almost new; West Side; \$2500.
- 6-ROOM cottage, lot 60x100, close in and a beauty, for \$4500.00.
- 1 CORNER LOT, 50x118, on West Main, north and east front, sidewalk in and paid for; \$1000. TERMS ON ALL ABOVE LISTED.
- For particulars, call at office or phone 2722.

D. H. Jackson & Comp'y
118 1/2 WEST MAIN STREET

ATTACK EXTRAORDINARY The World's Famous ELLEN BEACH YAW

Prima Donna Soprano (Coloratura), Assisted by **Mr. Jay Plowe, Solo Flutist** (Late Royal Opera, Berlin) —And— **Mary Newman, Pianist** Will appear at **MEDFORD THEATRE** One Night **MONDAY, OCT. 17** Prices, \$2.50, \$2, \$1.50, \$1. Seats on sale Thursday, October 13.

The P. & E. R. E. will soon be at **Butte Falls, Oregon** We can then handle your orders. Place them now. Write or Phone us for prices. **Butte Falls Lumber Co.**

The One Right Way is the Hand-Tailored Way. Your clothes will fit perfectly, wear longer, look better and be absolutely satisfactory if furnished by **W. W. EIFERT—The Progressive Tailor.**

F. N. CUMMINGS T. W. OSGOOD **OSGOOD & CUMMINGS** THE BEST EQUIPPED ENGINEERING OFFICE IN SOUTHERN OREGON OFFICE: MEDFORD NATIONAL BANK BLDG.

R. F. Guerin & Co. 4 Medford National Bank Building —have— Two thousand dollars to loan at ten per cent. Ten thousand dollars to loan at eight per cent and other amounts at similar rates. First mortgage real estate security only.

Last Chance To Buy Close In Business Property at Such Tremendously Low Figures \$5000 LESS THAN ADJOINING PROPERTY

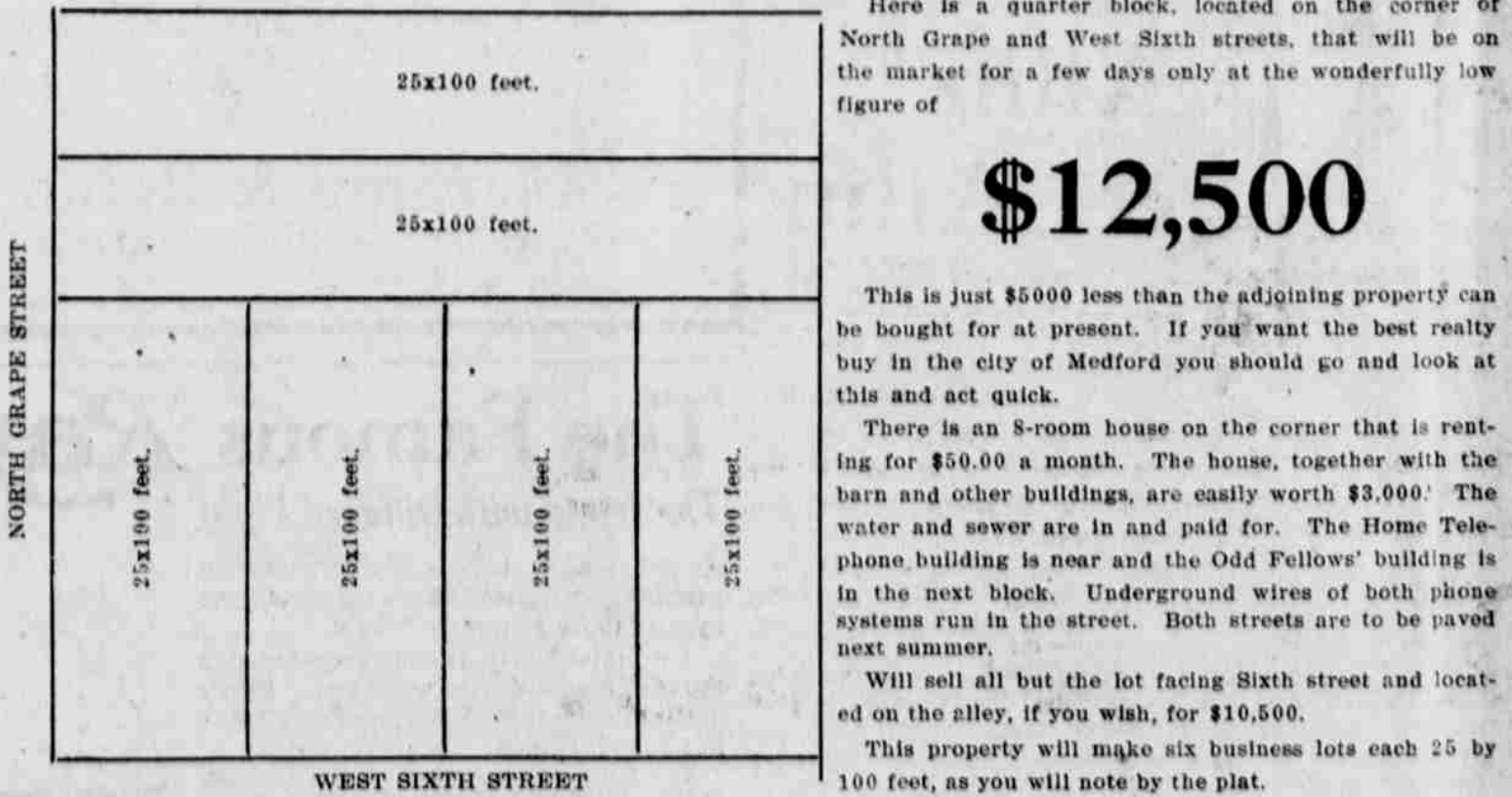

PHONE ME AT MY EXPENSE **W. E. WHITESIDE** CENTRAL POINT, OREGON