

THE PROOF OF THE ORCHARD IS THE FRUIT ON THE TREES.

Investigate Snowy Butte Orchards

On the ground and see for yourself what revenue the 10-acre bearing tracts promise for 1910. The plat shows the physical features of this property. Personal examination will demonstrate the actual condition.

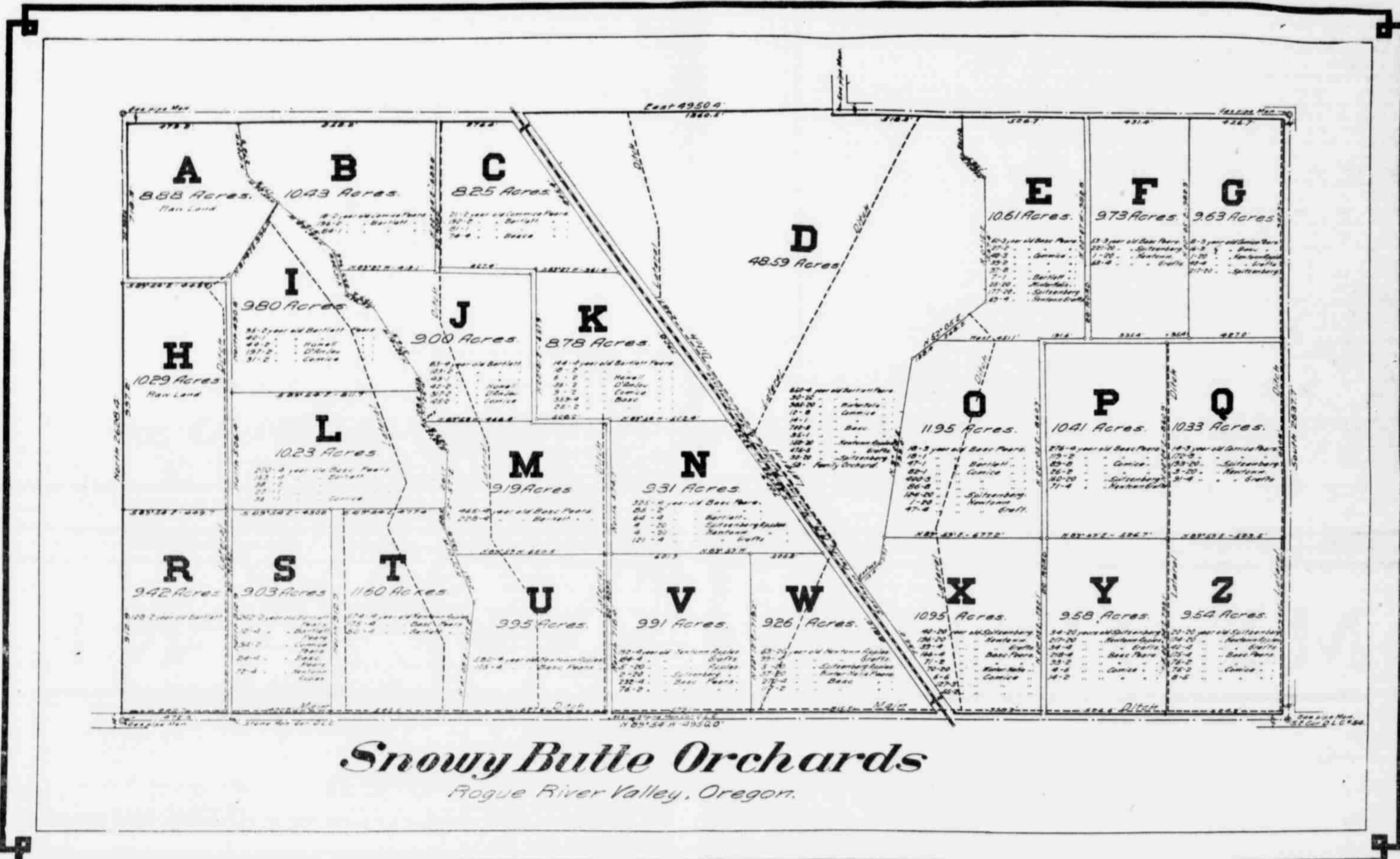

Tracts Have Already Been Sold to the Following Parties:

- | | | |
|------------------------------|-----------------------------------|-----------------------------|
| A. L. L. Love, Central Point | J. Charles. Parker, New York City | N. J. H. McInerny, New York |
| C. A. C. McFarlane, Portland | K. Mrs. J. F. Reddy, Medford | U. Edmund Burke, Chicago |
| E. H. H. DeGez, Pittsburg | L. F. A Malboef, Chicago | V. Edmund Burke, Chicago |
| I. John Masty, Tolo | M. George K. Bidloe, New York | W. W. L. McCallum, Spokane |
| | X. W. H. Gerig, Medford | Y. Mrs. E. C. Fean, Oakland |

More tracts have been contracted for, only a few left but they are choice. The price is extremely low. Look into that feature, the attractive terms and revenue in sight.

No better opportunity for investment exists in the entire valley. Call or write

Medford Land & Orchard Co.

18 North Front Street, Medford, Oregon