

# IONE SCHOOL DISTRICT BOUNDARY AS PRESENTED IN A PETITION TO THE UMATILLA-MORROW EDUCATION SERVICE DISTRICT

## IMPORTANT FACTS:

7.2% of Morrow County students attend the Ione Schools.

7.3% of Morrow County tax base would end up in the Ione District.

The PGE Coal Fired Plant is **NOT** in the Ione District.

No part of the old Lexington School District is in the Ione District.

Buildings will belong to the district that they are located in.

Each taxpayer's obligation under the current School Building Bond will remain the same.

All building projects must be completed as approved by Morrow County voters.

Ione **CAN** operate our schools on our share of state and local funding.

Ione students will receive class offerings that are just as good as those offered to them by the Morrow County School District.

Members of the Ione community will be able to supplement funding to Ione's schools by donating to a foundation, knowing that their money will be spent in Ione.

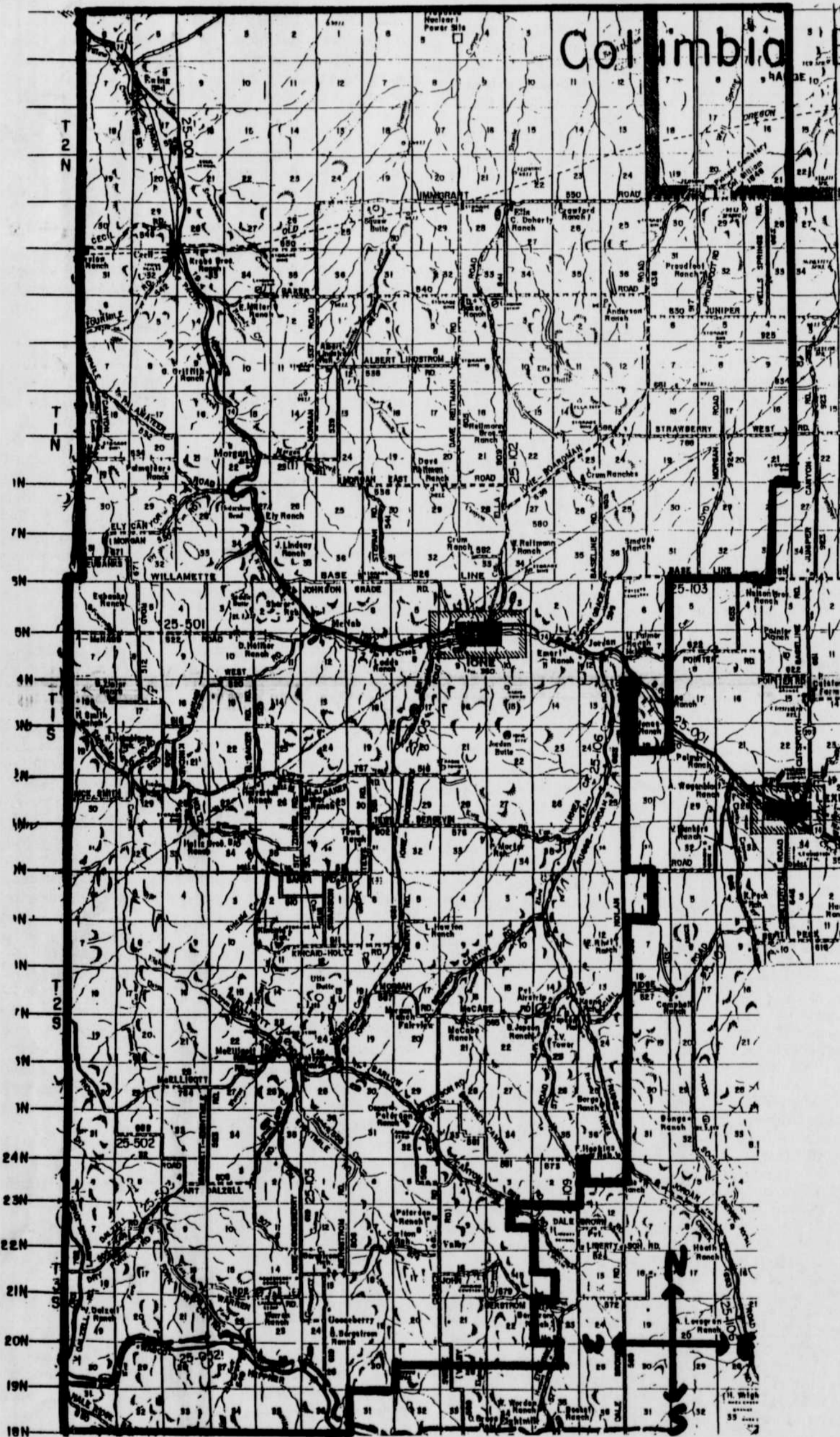

## SELF-DETERMINATION IS ABOUT IONE'S PARENTS AND COMMUNITY DECIDING WHAT IS BEST FOR IONE'S CHILDREN