

# OPEN CLASS SUPERINTENDENTS

## DEPTS. & DIVISIONS

1. Booths
2. Livestock
  - a. Goats, Sheep & Wool
  - b. Swine
3. Poultry & Small Animals
4. Saddle Horse Show
5. Commercial Crops
  - a. Grain
  - b. Grass & Hay
  - c. Commercial potatoes
6. Fruits & Vegetables
7. Flower Show
8. Home Economics
  - a. Clothing
  - b. Needlework
  - c. Canning
  - d. Foods
9. Arts, Crafts & Collections
  - a. Arts
  - b. Photography
  - c. Crafts
  - d. Collectors Corner
  - e. Miniature Car Races
10. Youth
  - a. Pet Show
  - b. Kids & Super Kids
  - c. Teen Corner

Ruth McCabe 422-7194  
 Gary Grieb 989-8585  
 Roger Palmer 676-9730  
 Eddie Brosnan 676-5881  
 Irene Anhorn 676-9639  
 Merlyn Robinson 676-9761

William (Bill) Rawlins 676-9435  
 William (Bill) Rawlins 676-9435  
 Jim Launer 676-5290  
 Dorothy Warren 989-8102  
 Dinah Jackson

Marilyn Bergstrom 676-9652  
 Ruth Bergstrom 676-9717  
 Bebe Munkers 676-9677  
 Mrs. George Currin 676-9769  
 Mrs. Darrel Vinson 676-5812

Betty Mills 676-5546  
 Steve Peck 989-8127  
 Marlene Gray 676-5395  
 Harold & Edna Peck 676-5318  
 Dan McBride 676-5254

Karen Thompson 676-9770  
 Karen Stack  
 Arlene Gray 676-5395  
 Maxine Gray

## LEGEND

1. Wash Racks
  - a. Beef
  - b. Swine & Sheep & Loading Chute
2. 4-H Beef Barn
3. Sheep & Dairy Barn
4. Swine Barn
5. Covered Show Ring
6. Poultry & Rabbit Exhibits
7. FFA Shop Exhibits
8. Auction Barn & Indoor Arena

9. Open Class Beef Exhibits
10. Open Class Exhibits
11. Fair Office
12. Country Store
13. Open Class Exhibits, Rodeo Dances
14. Rest Rooms
15. Pavilion Stage
16. Food Concession Stands
17. 4-H Home Ec. & misc. exhibits
18. Little League Field, special events

## FAIR GROUNDS MAP

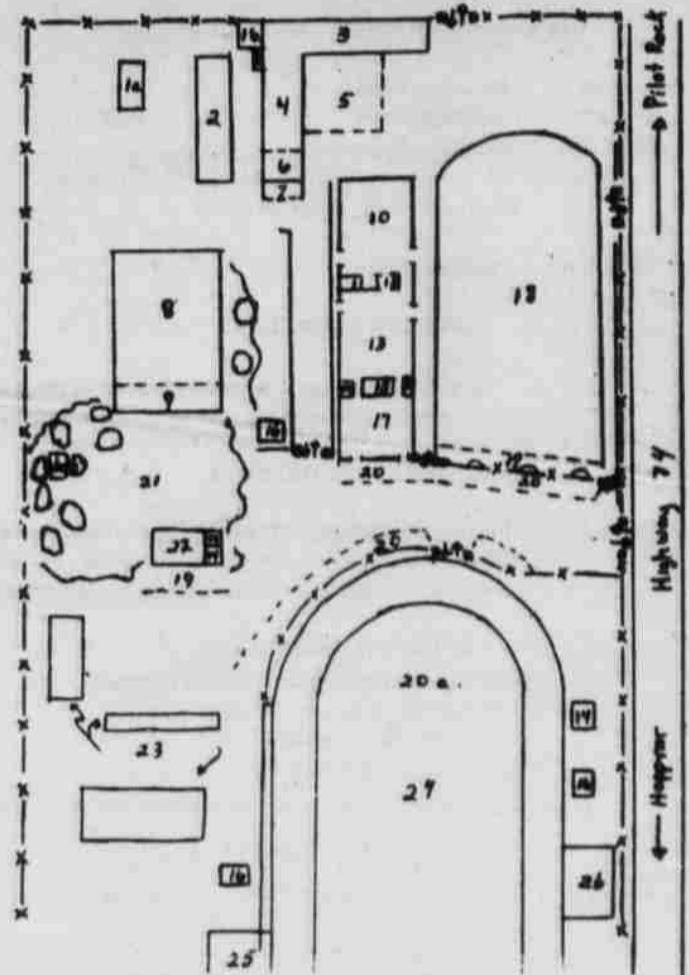

19. Reserved Trailer Parking
20. Vehicle Parking
  - a. Open to Vehicle parking during Fair only
21. Picnic Grounds
22. 4-H Dormitory
23. Horse Barns
24. 4-H Style Show, Fun Nite, Horse Show, Rodeo, other events
25. Buckaroo Stands
26. New Grandstand



## DEL'S MARKET

We're Your  
Super  
Country Store"

**Del & Phyllis Piper**  
**Lexington, Oregon 97839**  
**Phone 989-8133**

# Coast to Coast

TOTAL HARDWARE



**YOUR COMPLETE HARDWARE & HOME PRODUCTS CENTER**

106 E. May Ave. Heppner, Oregon  
**676-9961**

**Ralph & Chris Limanen**  
**WELCOME FAIR & RODEO FANS!**

## Ekstrom Farm Chemicals

Anhy. Ammonia    Aqua Ammonia  
 Nitra-sul  
 Sulfur & all Trace Elements  
 Soil Testing



**Phone 422-7505**  
*For All Your Fertilizer and Chemical Needs*