

BUDGET SUMMARY OTHER FUNDS

Table with columns: Historical Data (Actual, Second Year Preceding, First Year Preceding, Budget Current Year), Budget for Ensuing Year (Item, Approved). Rows include BOND INTEREST AND REDEMPTION, BOND CONSTRUCTION, TEACHERAGE-HOUSING, SCHOOL LUNCH, and PUBLIC LAW 89-10.

Shelter Course Set in Pendleton By Civil Defense

A three-day Shelter Management Instructor (SMI) course, presented by the Office of Civil Defense Training and Education of the Division of Continuing Education, will be conducted Wednesday, April 3 through Friday, April 5, at Pendleton. The course is designed to prepare participants to train others as shelter management personnel in their home communities, and will be conducted at the National Guard Armory, Tom Campbell, Umatilla County Civil Defense director, is in charge of local arrangements.

Club Officers Assume Duties

By DELPHA JONES

LEXINGTON—At the regular meeting of the Three Links Club of Holly Rebekah lodge last week, newly elected officers were installed for the coming year. Mrs. Kenneth Palmer served as installing officer, and presented each of the new officers with a shamrock pin.

Mrs. A. F. Majeske, who has been a patient in Pioneer Memorial hospital in Heppner, returned to her home on Sunday.

Mrs. Morris McCarl and children were recent callers at the home of her brother and sister-in-law, Mr. and Mrs. Donald Hunt, and family in Beaverton.

Mr. and Mrs. Frank McFadden and family of Heppner have moved into the William Nichols house in Lexington.

Mr. and Mrs. Joe Carr and family of Heppner are new Lexington residents, having moved into the Roberta Johnson home.

Women's Activities Committee of the Lexington Grange met at the home of Mrs. Wilbur Steagall last Thursday. The meeting was presided over by Mrs. Florence McMillan, chairman.

Mr. and Mrs. W. I. Miller of La Grande visited their son, Earl Miller in Lexington on Monday.

Mrs. Nora Turner, Mrs. Alfred Nelson, Jr., Mrs. Charles C. Jones, Mrs. Joe Yocom, and the hostess, Mrs. Steagall. Holly Rebekah Lodge met last Thursday for its regular meeting, with Noble Grand Ruth Robinson presiding. It was announced that there would be a PNG luncheon at the hall on April 30, honoring invited guests for the day, and on May 1 a dessert luncheon and card party would be held, starting at 1:00 p.m.

Word has been received in Lexington that Paul Nichols of Portland, and former resident here, underwent open heart surgery at Emanuel hospital last Thursday. At last report, he was doing as well as could be expected.

Mr. and Mrs. Vernon Munkers were Portland visitors last week, and while there they called on Mrs. Trannie Parker.

Mr. and Mrs. Archie Munkers and Mr. and Mrs. Roy Martin were visitors in Prineville over the week-end.

Mrs. George Zumwalt and children motored to Baker last week taking her grandchildren Mike, Larry and Victor Peterson, to their home after a few days spent in Lexington.

Mrs. Alonzo Henderson and daughter, Betty, were Lexington callers from their home in Hood River.

Mr. and Mrs. Bob Davidson were Portland callers last Tuesday.

Mrs. Lee King and daughter Norma, were visitors in Idaho over spring vacation.

Mr. and Mrs. C. C. Jones traveled to Burns and Mt. Vernon last week where Mrs. Jones conducted a WAC meeting of the Grange ladies of Harney and Grant Counties. They were overnight guests of her uncle and aunt, Mr. and Mrs. Byres Dearth, of Prairie City.

Sketch Shows Proposed New College Building

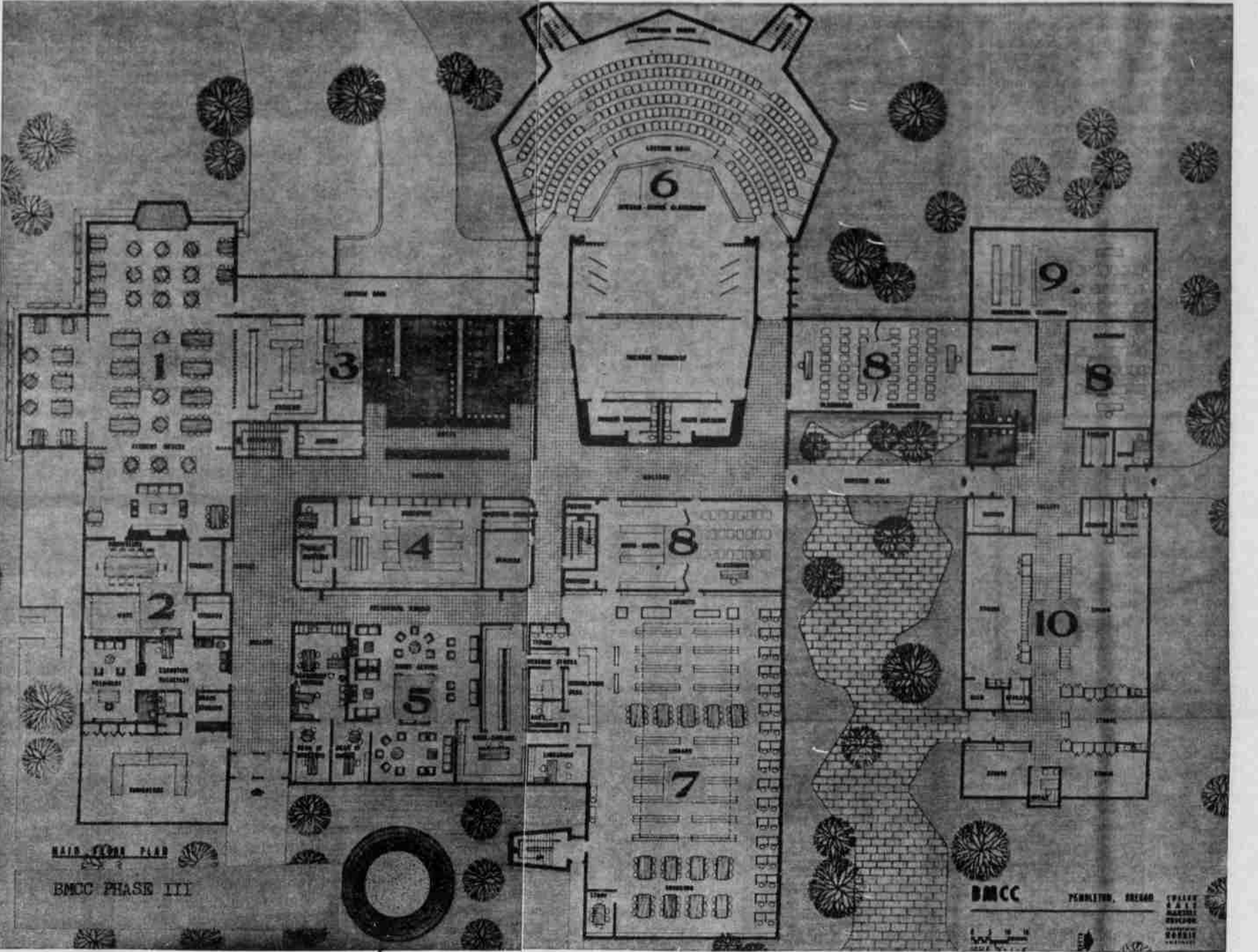

THIS SKETCH shows the proposed third building for Blue Mountain Community College, Pendleton, on which voters will cast ballots Tuesday, April 2, from 8 a.m. until 8 p.m. at polling places used for local school elections. (List of polling places

for each area in Morrow county is on page 6, section 1, of this paper). The cost of construction for the building, third and final phase in the college building program, would be covered by a bond issue. Part of the cost will

be covered by \$250,000 to be contributed by the state by legislative action, provided that the voter approval is given and decision is definite by June of this year. Otherwise the state fund will divert to some other community college district.

The bond issue would be repaid over a 20-year period. It would absorb a current serial levy approved two years ago by voters for construction on the college's vocational-technical building. By absorbing the serial levy, the amount to be

levied to taxes would be somewhat less than at present over the next three years, but the indebtedness will extend over a longer period.

Also on the ballot Tuesday will be the budget for the college for the year 1968-69, which, according to President Wallace McCrae of the college, is holding at about the same level as last year and will cost taxpayers about 90c per each \$1,000 true cash value of property assessed.

Phase III of the building program is designed to meet increasing needs of the college, add some departments and to take care of the rapid growth of the student body. One reason that the budget for 1968-69 can be held to a similar figure to the current year despite increasing costs is the fact that the heavy growth in the number of students is providing a corresponding increase in the receipts from tuition, President McCrae said.

In the sketch above, the large figures indicate the various general portions of the building as follows: 1. Student center, 2. Conference rooms, office areas, storage, 3. Kitchen for student center (at left) and rest rooms (right), 4. Bookstore, 5. Study center with book storage area at right, 6. Lecture hall to seat 225-250, with speech and drama classroom and theatre workshop areas below. (Largest space available now for lectures seats only 90, which has posed a problem, college instructors state), 7. Library, 8. (Note three separate areas) Student classrooms, one designed to include audio-visual, another designed to serve as two classrooms by using dividing folding doors, 9. Agricultural classroom, 10. Arts and music areas to provide for course for which there is a demand but currently no provision at the college.

Not shown is an upper level of the library which will house faculty offices, faculty lounge and reference stacks of books. Also not shown is a lower level to the left wing which will house journalism classroom, mechanical room, space for student activities and storage space.

It is expected that if the building is approved by voters, it will be ready for use by the fall term, 1969.

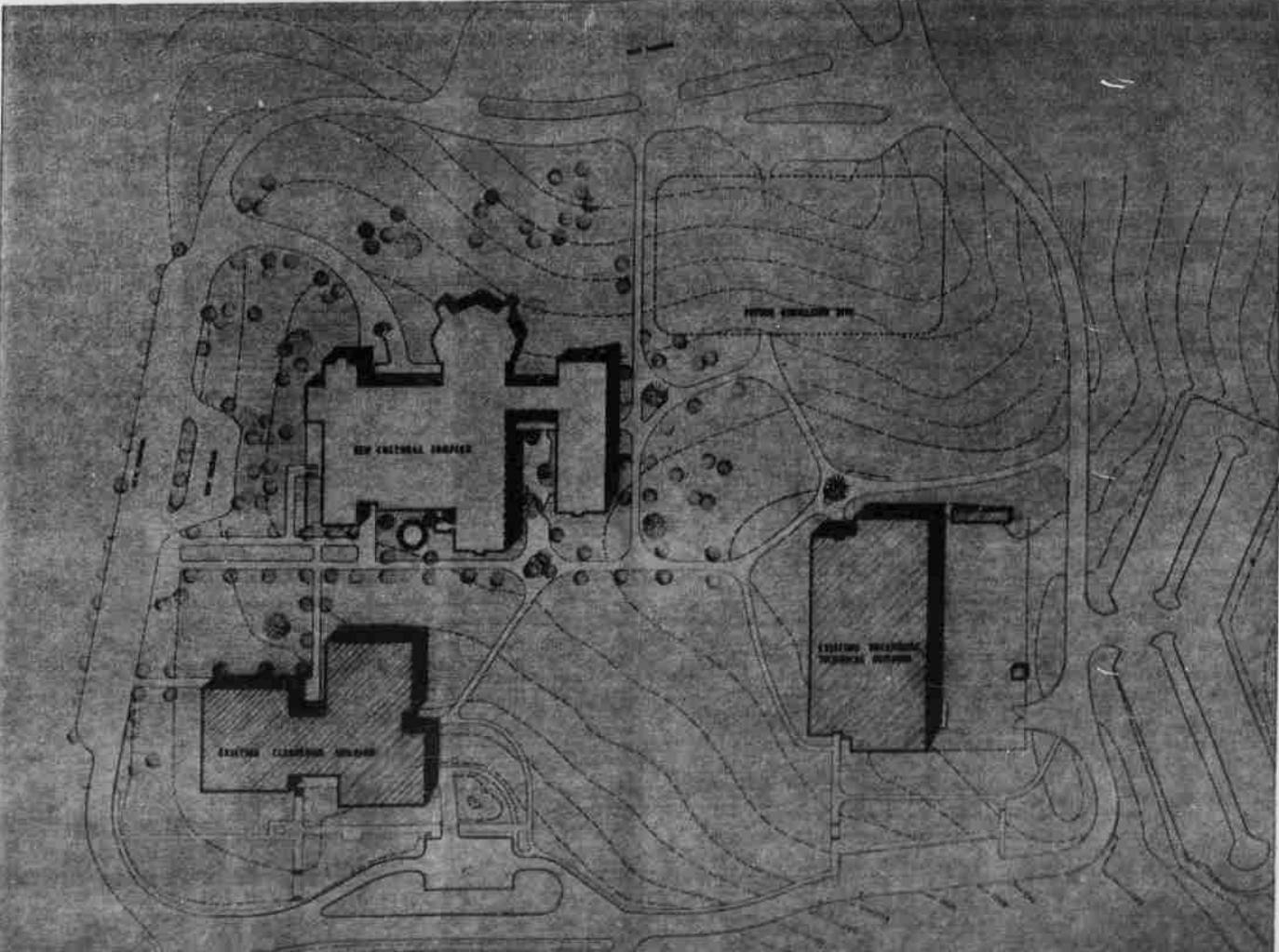

CAMPUS OF BLUE MOUNTAIN Community College is shown in this sketch with existing buildings shaded and the proposed third building outlined (left center). At the lower left is the existing classroom building and at lower right is the vocational-technical building. The third building, which would house library, classrooms, large lecture hall, art and music studios

and other facilities, will be constructed if voters approve a \$1,250,000 bond issue at a special election in the two-county district (Morrow and Umatilla) Tuesday, April 2. Details of the building are described above. All registered voters are eligible to cast ballots at the special election.

SUPPLEMENTAL BUDGET NOTICE OF SCHOOL BUDGET HEARING

NOTICE is hereby given that a meeting of the governing body of Morrow County School District No. R-1 of Morrow County, State of Oregon, will be held at Riverside High School on the 15th day of April, 1968, at 7:30 p.m. o'clock for the purpose of discussing with interested persons the budget for the fiscal year beginning July 1, 1968 and ending June 30, 1969, hereinafter set forth.

The budget was prepared on a basis of accounting consistent with that used in the preceding year. Major accounting changes, if any, and their effect on the budget are set forth in an accompanying statement.

A copy of the budget document is available for inspection at School District Office between the hours of 8:00 a.m. and 5:00 p.m. The budget document may be obtained for \$—, or parts of it may be obtained for \$— per sheet.

Signed DON McELLIGOTT District School Board Chairman

FINANCIAL SUMMARY

For the Ensuing Fiscal Year Beginning July 1, 1968

Table with columns: Tax Levy Computation (1), Total All Funds (2), Teacherage (4). Rows include Total Budget Requirements, Deduct: Total Budget Resources, Revenue Necessary to Balance Budget, Add: Est. of taxes to be levied but not rec'd in ensuing year, Taxes to be levied for Ensuing Year, Analysis of Taxes to be levied, Within 6% Limitation, Outside 6% Limitation, Not Subject to 6% Limitation, Total Taxes to Be Levied.

Adopted by District School Board: March 18, 1968

Signed ALICE VANCE, Clerk

DON McELLIGOTT, Chairman

BUDGET RESOURCES AND REQUIREMENTS—IN DETAIL OTHER FUNDS SUPPLEMENTAL BUDGET TEACHERAGE FUND

Table with columns: RESOURCES (4), Adopted (7), REQUIREMENTS. Rows include Accrued Cash Reserve, Total Budget resources, 1276 New Buildings, Total Budget requirements.