

Progress and Prosperity Go Hand in Hand

Heppner Planing & Chop Mill

Martin Reid Proprietor
Phone Main 564

We can supply you with every scrap of material needed in the erection of your new building.

LUMBER, HARDWARE, LIME, CEMENT, SAND, PAINT, PAPER AND GLASS

Special orders in mill work given prompt attention. Reliable cost estimates furnished prospective builders.

HEPPNER, OREGON

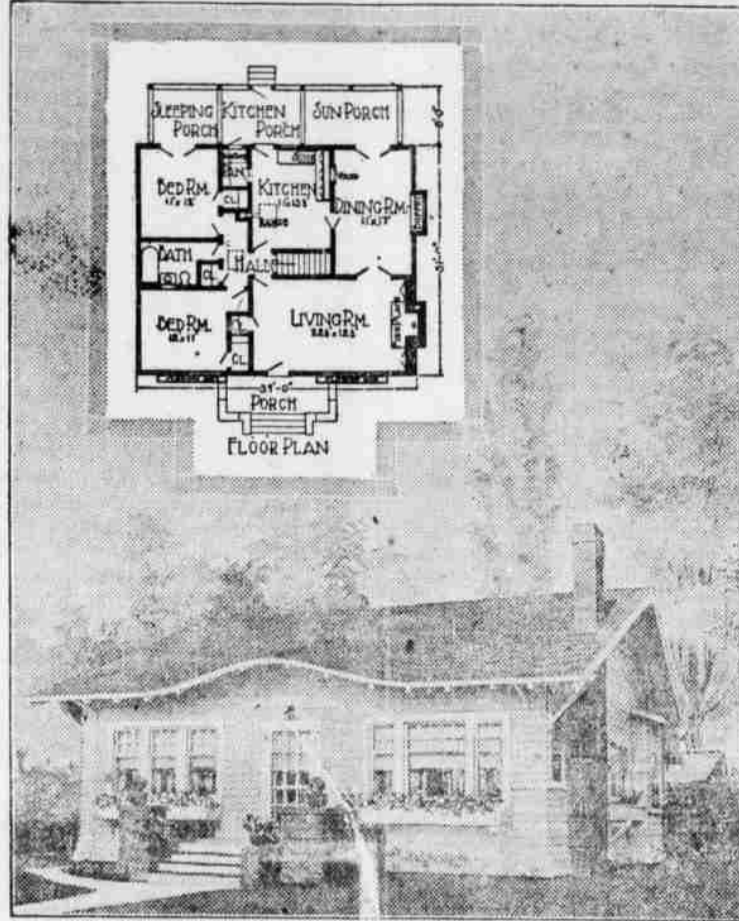

For a complete description of this modern Dutch Bungalow read Article on Page Three

T. G. DENNISSE

Architect and Contractor

Announces his readiness to serve the people of Heppner during the coming season of building activity. Will furnish estimates, prepare plans and specifications take contracts or undertake to superintend your work.

Office and work shop one door north of Postoffice Heppner, Oregon.

C. S. Lansdowne

Construction Engineer

DESIGNING AND CONSTRUCTION OF ALL TYPES OF BUILDINGS DONE UNDER CONTRACT

HEPPNER OREGON

CONCRETE WORK, FLUE BUILDING,

Plastering

All Work Guaranteed

YOURS FOR A BIGGER AND BETTER HEPPNER

E. L. Bucknum

West May Street Heppner, Oregon

THE PIONEERS

GILLIAM & BISBEE

For Over Thirty Years Heppner's Leading Dealers in the Best Lines of

BUILDERS' HARDWARE, SUPPLIES, MATERIALS AND TOOLS

We take especial pride in our department of

PLUMBING - HEATING

both as regards material and installation

SUBSTANTIAL CITY RISE FROM HEPPNER'S ASHES

That the coming summer will be marked with the greatest building activity known since the first board was sawed or nail driven in Heppner is the opinion of even our most conservative citizens. On every hand a spirit of optimism prevails. Nearly every owner of unimproved property is planning substantial improvement. Many with idle capital who own no property in the city are casting about for suitable locations to buy upon which to build as an investment. Many business people who were forced into unsuitable or inadequate quarters by the fire are clamoring for new quarters in modern, fire-proof buildings.

Heppner is going to grow. It is going to grow substantially and permanently. The Herald today on this page presents the advertisements of Heppner's leading builders, designers and dealers in building materials. It is one of present, practical interest to every one who contemplates building. The firms and individuals presented on this page are reliable home people. Their interests are in Heppner and Heppner people who contemplate building will consult own interests by patronizing them.

The way to build up the best town in the world is for every citizen to patronize home institutions and home people.

H. E. Crawford, chief architect for the Tum-a-Lum Lumber Co., of Walla Walla, accompanied by his assistant, David Cora, was in Heppner a few days during the week on business connected with the affairs of his company. While here the gentlemen submitted prospective plans for the new hotel to be erected by the Heppner Improvement company, for the new Gilliam & Bisbee building and for the new building to be erected at Lexington the coming summer for the Lexington State Bank.

May street, between Main and Chase streets, which was completely cleaned by the big fire, seems to be in line for many substantial improvements before the summer is over. In addition to the big Gilliam & Bisbee building which is assured for the Main street corner it is positively rumored that at least two other substantial business buildings are now contemplated for the same block.

The Morrow County Creamery, forced to give up their present location on Main street by the sale of that property to the Heppner Improvement company, has purchased a lot from Harry Cammatta, opposite the Farmers warehouse and will at once proceed with the erection of a concrete building 70x60. The building will be modern and specially designed for creamery purposes.

Gilliam & Bisbee are counting on a delightfully busy summer. What with loading with their own big building and taking care of their extensive trade in building materials, plumbing, heating, etc., they expect to "go strong" according to Lew Bisbee.

Whether it is one, two or three hotels to be built this summer Heppner will be de-lighted and everybody will turn out to the grand opening in a happy frame of mind and his best togs.

Fred Tash and Shelly Baldwin have each purchased two fine residence lots on Court street, just south of the court house, from Andrew Rood, sr., and it is understood they will later erect handsome residences thereon.

The work of excavating for the new apartment building on the McNamee property at Main and May streets, has been commenced and is understood will be rushed to completion.

Clyde Wells has awarded the contract for his residence, to be erected in east Heppner to C. S. Lansdowne and it is understood work will be started at an early date.

Lansdowne's concrete mixer has been moved from the Case building to the Gilman building on Willow street and the walls of that structure will be rushed to completion.

T. G. Dennisse wears that smile that don't come off when asked about the prospect for a busy summer in his line. "It's going to be great," he says.

Martin Reid reports busy days and evenings around his office lately getting things lined up for the busy season just ahead.

Bill Cronk was up from Ione Saturday and his car flew around the corner the chug chug of the engine sounded something like tum-a-lum-tum-a-lum-tum-a-lumber.

Ed Bucknum figures that he will have to begin mixing plaster pretty early in the spring if he hopes to keep ahead of the procession.

Johnson & Sons pioneer carpenters and contractors have a busy season mapped out for the coming summer.

NEW BARBER SHOP NEARS COMPLETION

The new barber shop of Patterson and Clark which is being fitted up in the Cohn building is nearing completion and when in operation will be one of the most complete and up-to-date establishments of its kind in eastern Oregon. Four chairs will be provided for and the baths in connection will be modern and complete. Johnson Bros., well known carpenters and contractors, are doing the inside finishing work.

FREE DIRT

If you can use any quantity of dirt either for filling in or for improving your lawn or garden come quick and take it away in any quantity, FREE FOR THE HAULING from my lot on the corner of Main and May streets. This offer is for quick action.

DENNIS McNAMEE 4114

FOR SALE—O. A. C. and Hanson stock White Leghorn roosters. Also a few of those famous "Oregon" F. B. BROWN, Heppner, Oregon. 29-40

JOHNSON & SONS

Contractors and Builders

OUR REFERENCES—Every job we have executed in Heppner during the past 45 years.

Build your home on paper first

THE RIGHT WAY—THE TUM-A-LUM WAY—IS TO PLAN YOUR WORK THEN WORK YOUR PLAN

The building game is new to the average home-builder. You cannot be expected to tell the carpenter or contractor all you have in mind—nor can you expect him to make a record of everything you speak of—everything you want.

Meet your contractor half way by providing him with a set of carefully prepared plans and specifications. These plans show all details and how much of everything.

It is the only economical way to build. It will do away with extras, disputes and misunderstandings.

Ordinarily these blue prints and specifications cost from \$150 to \$1000 for each house. We furnish them free to our customers.

If you are considering any kind of improvements your first step should be to see us. We can help you to save money.

Tum-a-Lum Lumber Co.

"WE TREAT YOU RIGHT"

Our Architectural Department is Always at Your Service

Heppner will lead all Eastern Oregon in building during 1919. Watch for results