

New campus: 250-270 students expected at middle school

Continued from Page 1

pus and a career technical center for high schoolers.

The new campus is off Southeast Dolphin Road in an area that feels quite rural despite its location south of Walmart.

"The space, as a whole, the location, the actual site is beautiful," Rogozinski said. "You're up there, away from ... much of the town. ... I give former Superintendent Mark Jeffery a lot of credit for finding this location."

A design team of community and staff members researched new campuses and really "got a bead on what we wanted to see in its finished form and that vision becoming reality is probably the most exciting thing."

Josh Jannusch is principal of the new middle school, having served as high school principal last year and high school vice principal the year before.

"It's very very very exciting, but also a little overwhelming, the things you just don't think about, the protocols and procedures that have to be developed from scratch," Jannusch said.

He predicts students will be "wowed" when they set foot inside.

"The building is just amazing with so much wide-open space, natural light," he said. "It feels like a college building. It feels different."

About 1,000 students are expected at all three campuses — Warrenton Grade School, Warrenton Middle School, and Warrenton High School. The new middle school will get 250 to 270 of them.

New teachers and administrators have been hired, the finishing touches are going in, and electives and extra-curricular activities are back.

Schedule

Grades K-5: 8 a.m. to 2:30 p.m. at Warrenton Grade School, 820 S.W. Cedar Ave., 503-861-3376.

Grades 6-8: 8:30 a.m. to 3:30 p.m. at Warrenton Middle School, 1050 S.E. Warrior Way, 503-861-2281.

Grades 9-12: 8 a.m. to 3 p.m. at Warrenton High School, 1700 S. Main Ave., 503-861-3317.

All students should register online at warrentonschools.com/apps/pages/registrationWHSD.

Open House

Who: Members of the community, students and parents.

When: 5:30 p.m. Thursday, Sept. 2

Where: Warrenton Middle School, 1050 S.E. Warrior Way.



Bruce Dustin

Warrenton Middle School Principal Josh Jannusch.

Students in all public schools will be required to wear masks this school year, a change from previous guidance that had allowed each district to set its own COVID-19 protocols. All three campuses will offer full-time in-person instruc-

tion five days a week.

An entirely remote learning option also is available through the district's Warrenton Academy of Virtual Education, or WAVE.

"With all the mask mandates and the reality of what we're facing now, it still allows us to run a normal seven-hour school day and ... a more robust set of enrichment classes for our middle school," Rogozinski said.

Oregon law requires individuals to wear masks on school buses, indoors while at school, and during indoor field trips. No masks are required when a student is outside, actively eating or drinking, playing a musical instrument that requires using the mouth, or alone in a private office enclosed by walls on all sides with a door

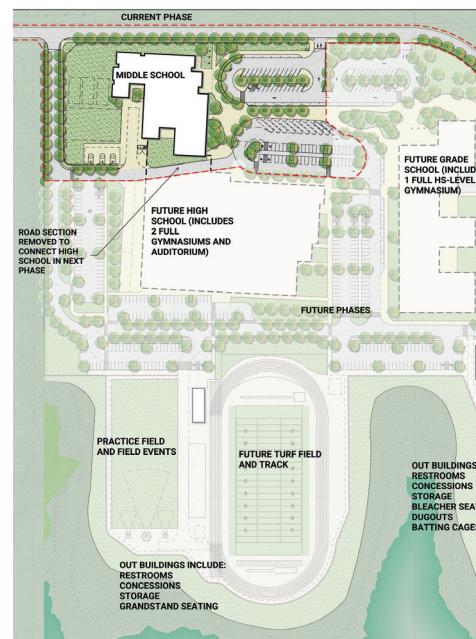

tored and sent home if needed. Those who test positive or who have been exposed to someone who has tested positive will be excluded from school for 10 to 14 days.

Other protocols such as heavy cleaning, social distancing and hand sanitizing also remain in place.

But there's good news this year, too.

In addition to enrichment activities and electives, students can work in small groups and eat in the cafeteria. They'll be able to spend time

that's closed.

Other precautions:

There will be a supervised health room where students who are ill with COVID-like symptoms can be moni-

with more of their classmates during lunch and recess.

Field trips are back. So are band, choir, and drama, along with a bevy of sports, clubs and other activities.

LANDSCAPE BARK

\$20 You Haul per yard

WARRENTON FIBER

389 NW 13TH St., Warrenton
Mon-Fri. 8-5 **861-3305**

HEALTHCARE THAT BENDS FOR YOU

COLUMBIA MEMORIAL HOSPITAL

columbiamemorial.org/telehealth