

Scarey and fun, there's lots to do this Halloween

The Columbia Press

Whether you like to be scared or merely amused, there's a Halloween attraction for you near you.

Here's a list of some of the top Halloween activities.

HAUNTED SHIP

The U.S. Coast Guard Cutter Alert recently was brought back after disappearing 50 years ago in the Bermuda Triangle. But the ship is haunted. That's the story anyway.

Tours of the haunted vessel are from 6 to 9 p.m. Oct 26-28 on the 17th Street dock adjacent to the Maritime Museum. Admission is free, but the Lower Columbia River Petty Officer's Association will have concessions available for donations.

HAUNTED HOUSE

Seaside Inverted Experience of-
See 'Halloween' on Page 8



Cindy Yingst/The Columbia Press

The D.K. Warren House on Skipanon Drive puts on quite a show.

Commissioner speaks out on bad behavior; woman runs as write-in

BY CINDY YINGST

The Columbia Press

A city commissioner chastised the behavior of fellow politicians this week and a woman announced her candidacy as a write-in for the commission position.

"I went home from the last meeting disappointed in myself for not speaking up," Commissioner Mark Baldwin said at the close of Tuesday's City Commission meeting. "I don't like the way the meeting ended last session and getting the police involved ... is something that never should have happened. It lacked good taste. What brought that on lacks good taste also."



Baldwin

Mayoral candidate John Washington and City Commissioner Rick Newton, who is running unopposed on the ballot for his seat, both engaged in an-

See 'Write-in' on Page 12

Decision on school bond comes down to safety, expediency and money

Warrenton-Hamond School District Superintendent Mark Jeffery answered our questions about the \$38.5 million school bond on the November ballot.

What are the top three things that will happen if the bond passes?

We'll hire a project manager to assist in finalizing the design as well as immediate implementation of school improvements at our grade school and high school.

We'll solicit input from the community and the board will select a Bond Accountability Committee to oversee bond construction and financing to inform the board and superintendent on keep-

ing the bond projects on time and on budget.

We'll begin preparing the site of the new Warrenton Middle School.

How much will it cost the average resident?

The total combined rate for the bond should be estimated at \$2.68 per \$1,000 of assessed value, so the cost will vary depending the actual assessed value of one's home.

Can't new construction pay taxes needed to build a new campus?

New construction in Warrenton School District will absolutely assist in keeping our bond rate lower for existing residents. It's difficult to forecast how many new homes

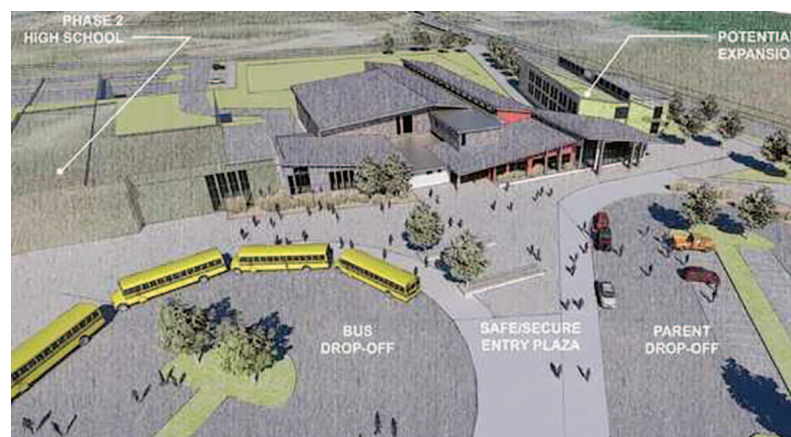

A drawing by DLR Group of what a new middle school campus might look like with room for additional grade levels.

will be constructed over the 30-year bond repayment timeline.

Where will the new campus be built?

We are currently pursuing

upland property located just east of Dolphin Avenue on the east side of Highway 101. The property is out of the tsunami inundation zone.

Why put the school on

the other side of Highway 101? Won't that be a bus-ing nightmare?

The main reason was the determination that the best long-term use of these tax dollars would be to locate the schools on a single campus on property above the tsunami zone.

All the property within the district, city and urban growth boundaries of suitable size was located east of Highway 101. Of those, there were limited safe options to meet the requirements of the current plan.

Part of our due diligence work was an initial traffic assessment and we are continu-

See 'School Bond' on Page 4