



The Blue Mountain Eagle Classifieds

Find Classifieds at www.MyEagleNews.com

I have a dream...

To place your ad visit www.MyEagleNews.com or call **541-575-0710**

502 Real Estate

502 Real Estate

502 Real Estate

502 Real Estate

101 Legal Notices

101 Legal Notices

Serving Eastern Oregon Since 1979
Give us a call today for Free Market Analysis.

Over 87% of buyers search the internet before purchasing. We are active members of the Regional & Local Multiple Listing Service and have exposure on numerous national websites.

OFFICE
Eastern Oregon Realty
541-575-2121
160 E. Main • John Day, OR 97845
JERRY FRANKLIN, GRI (ABR) SRES
Principal Broker/Owner, 541-820-3721
MICHAEL MADDEN
Broker, 541-620-4408
TRACI FRAZIER
Broker, 541-620-0925
LINDSEY MADDEN
Broker, 541-792-0031
DE ANN SANDOR
Broker, 360-690-5233

VIEW OUR LISTINGS
www.eastoregonrealty.net
www.rmls.com
www.realtor.com
www.farmseller.com
eastoregonalestate.com

Visit our website and videos for new multiple timbered and recreational properties with LOP tags @ eastoregonrealty.net

home, 2 decks, 1 covered with patio. Lg. fenced/landscaped lot. All appliances included. 367 S. Main St. Prairie City, OR 97869 **\$192,500** \$182,500 RMLS#19291861

RURAL RESIDENTIAL
3420RR No neighbors. Approx 3.7 miles out of Mt. Vernon. 20.27ac, fenced and cross fenced. Off-grid with 3 solar panels & a Genset Generator. Year around pond. 1,500 sq ft, 2bd/2ba. 21856 N. Hwy. 395 Mt. Vernon, OR 97865 **\$220,000** RMLS#19510060
3422RR Great private timbered property, 2bd/1ba with a multitude of guest houses/storage sheds. Has a timber deferral. 25848 Pine Creek Rd. John Day, OR 97845 **\$235,000** RMLS#19622981

LOTS AND LAND
3353A Price Reduction! Two tax lots with outstanding views of Little Canyon Mountain. Build your dream home on one or both of these lots. Phone line to the property, power, sewer & water available short distance away. S. Adam Dr. Canyon City, OR 97820 **\$25,000** \$15,000 RMLS#18349443
3384A Price Reduction. Beautiful Forested 120 Acres surrounded by the Malheur National Forest on all sides. Great recreational piece. Near Magon Lake. Four Corners, Prairie City, OR 97869 **\$440,000** \$120,000 RMLS#19265788

3440R Mtn. views in Mt. Vernon. 23-acre lot with city water, sewer and electrical. Move out the single wide and build your dream home. Seller willing to carry a contract to qualified buyers. 450 Thompson Ave. Mt. Vernon, OR 97865 **\$40,000** RMLS#19658927

RESIDENTIAL
3366R Upgrades from flooring to ceilings. Main level 2150sqft 3bd/2ba. Lower level 1565sqft family rm, 1bd/1ba, storage rooms. Walking distance to downtown. 317 S. Canyon Blvd. John Day, OR 97845 **\$265,000** RMLS#19574607
3433R Beautiful home nestled in the trees bordering BLM on 2 sides. 4bd/2ba, 2 story home. Decks, 2 car garage/with shop, storage above. Yard, fruit trees pond, barn. 26531 Nelson Rd. Canyon City, OR 97820 **\$329,000** RMLS#19682159
3406R Price Reduction. Beautiful 3bd/2ba

FEATURED LISTING

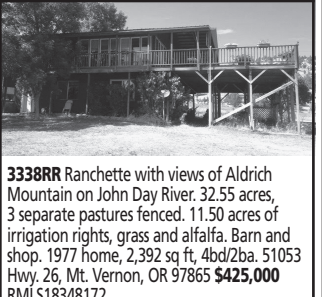

3338RR Ranchette with views of Aldrich Mountain on John Day River. 32.55 acres, 3 separate pastures fenced. 11.50 acres of irrigation rights, grass and alfalfa. Barn and shop. 1977 home, 2,392 sq ft, 4bd/2ba. 51053 Hwy. 26, Mt. Vernon, OR 97865 **\$425,000** RMLS#18348172

2891C Reduced. Prime comm. prop. in John Day growth pattern. Great location for business/retail, 212 ft of Hwy 26/395 frontage. Has rental income. Agent-owned. 741 & 742 W. Main, JD. **\$310,000** \$298,500! Possible owner finance. RMLS#12097489

3193C [REDUCED] BLUE MOUNTAIN MINI MARKET ON HWY 395. Gas Station/Mini Market. Ind concrete MH pad with hookups. Variance req to place home. Financials avail to qual buyers. Inventory purchased at closing. Sale subj to TL partition. Agent related to seller. 150 Mountain Blvd, MV. **\$299,000** \$179,000 RMLS#16339841

BUSY, BUSY! WE NEED LISTINGS

RECENT CLOSINGS
3416R 2/1 JD \$185,500
3409RR 2/1.5 40ac PC \$349,000
1520 2/2 JD \$183,000
3368R 3/2 MV \$90,000
1519 4/2 JD \$192,500
3428R 3/2 JD \$169,000
3423R 5/2 Dayville \$175,000
3415R 3/1 JD \$105,000
3426L 1ac. PC \$45,500
1525 4/2 JD \$189,000
1529 3/2 \$130,000 CC

PENDING SALES
3373L 1ac MV 41,000
3334R 3/2 \$135,000 JD
3413RR 3/2 \$120,000 Spray
1516 2/2 \$149,000 PC
3430R 3/2 \$225,000 JD
3392R 2/1 \$129,900 JD
3375RR 3/2 \$220,000 Unity
3417R 3/2 \$378,500 JD

YOUR PROPERTY COULD BE ON THIS LIST

DEAL OF THE WEEK



3410R PRICE REDUCTION. Cute private country cottage. 3bd/2ba .85 acres and fenced in yard. Includes appliances. 23X32 Carport with additional parking. City Utilities. 101 Brent Ln. Canyon City, OR 97820 **\$152,000** \$148,500 RMLS#19525939

NEW LISTINGS
3440R Mtn. views in Mt. Vernon. 23-acre lot with city water, sewer and electrical. Move out the single wide and build your dream home. Seller willing to carry a contract to qualified buyers. 450 Thompson Ave. Mt. Vernon, OR 97865 **\$40,000** RMLS#19658927

RESIDENTIAL
3366R Upgrades from flooring to ceilings. Main level 2150sqft 3bd/2ba. Lower level 1565sqft family rm, 1bd/1ba, storage rooms. Walking distance to downtown. 317 S. Canyon Blvd. John Day, OR 97845 **\$265,000** RMLS#19574607
3433R Beautiful home nestled in the trees bordering BLM on 2 sides. 4bd/2ba, 2 story home. Decks, 2 car garage/with shop, storage above. Yard, fruit trees pond, barn. 26531 Nelson Rd. Canyon City, OR 97820 **\$329,000** RMLS#19682159
3406R Price Reduction. Beautiful 3bd/2ba

COMM./DEV
3232C Price reduction. 1575 +/- SF. Good location for business or office space. Lg reception area & 3 soundproof rooms plus rear storage or work area. 166 SE Dayton, JD. **\$65,000** \$59,500 RMLS#17141618

DEAL OF THE WEEK
3410R PRICE REDUCTION. Cute private country cottage. 3bd/2ba .85 acres and fenced in yard. Includes appliances. 23X32 Carport with additional parking. City Utilities. 101 Brent Ln. Canyon City, OR 97820 **\$152,000** \$148,500 RMLS#19525939

DEAL OF THE WEEK
3410R PRICE REDUCTION. Cute private country cottage. 3bd/2ba .85 acres and fenced in yard. Includes appliances. 23X32 Carport with additional parking. City Utilities. 101 Brent Ln. Canyon City, OR 97820 **\$152,000** \$148,500 RMLS#19525939

DEAL OF THE WEEK
3410R PRICE REDUCTION. Cute private country cottage. 3bd/2ba .85 acres and fenced in yard. Includes appliances. 23X32 Carport with additional parking. City Utilities. 101 Brent Ln. Canyon City, OR 97820 **\$152,000** \$148,500 RMLS#19525939

WE PROVIDE QUALITY SERVICE FOR BUYERS AND SELLERS: EXPERIENCED AGENTS, SATISFIED CUSTOMERS, LASTING FRIENDSHIPS, HOME WARRANTY FOR BUYER/SELLER, IRS 1031 EXCHANGES, ACCREDITED BUYER/SELLER REPS, SENIOR REAL ESTATE REPRESENTATION

SELL IT FAST IN THE CLASSIFIEDS

King Crossword

- ACROSS**
1 Cleans the floors
5 Pouch
8 One of the Three Bears
12 Admitting customers
13 Time of your life?
14 Change for a five
15 Draped dress
16 Sailor
17 Western state
18 Deceptive
20 Melody
22 Lengthwise, to 16-Across
26 In spades
29 Actress Farrow
30 Mai — (cocktail)
31 Exceptional
32 Corral
33 Check
34 Film trickery, for short
35 One of the Brady Bunch
36 Cartoonist Trudeau
37 Everywhere
40 Surround
41 Attachments
45 Blunder
47 Rowing need
49 Help in crime
50 Padlock fastener
51 Oilfield struc-

1	2	3	4		5	6	7		8	9	10	11
12					13				14			
15					16				17			
18				19			20	21				
			22			23				24	25	
26	27	28			29				30			
31					32				33			
34				35					36			
37			38				39					
			40				41			42	43	44
45	46				47	48			49			
50					51				52			
53					54				55			

- DOWN**
1 Rolling stone's lack
2 Colorful fish
3 Graceful woman
4 Cold symptom
5 Attendant of Bacchus
6 — Khan
7 Foolproof
8 100 pence provider
9 Enemy of an "army"?
10 Shade of green
11 Shade of blonde
19 Plaything
21 Actress Merkel
23 Make corrections
24 Equitable
25 Wee
26 St. Louis landmark
27 Creche trio
28 Annoyingly proper
32 Internet radio
33 Numbers to be crunched
35 Cookie container
36 Deity
38 Ballerina in "Fantasia"
39 Ginormous
42 Last write-up
43 "Finding —"
44 Flight component
45 That girl
46 Fond du —, Wis.
48 Have something

FOR SALE BY OWNER
2509 sq. ft vintage 2 story 3 bedroom 1 1/2 bath home with full basement. Large fenced yard front and back, garage, covered patio, shop, covered RV storage area and barn adjoining 20 acres. 640 SE Hillcrest Rd, John Day. \$239,000. 541-316-8864 or 541-620-1322. Open house Saturday, January 11th 10-3.

REMEMBER TO RECYCLE
For Sale or Rent Business or office storefront located at 160 S.E. Dayton St. \$350/month. Call 541-820-3721.

631 For Rent
CANYON CITY — PARTIALLY FURNISHED STUDIO APARTMENTS. Utilities paid. No pets. No smoking. \$375 a month. Storage sheds to rent by the month. C&M Apartments, 541-620-1861 or 541-620-4828.

For Rent Newly Remodded 2 bedroom 1 bath Apartment on Canyon Creek with porch \$800.00 per month with deposits. For more information call 541-620-1976

This notice is to **Stephanie Burrows**, address unknown, that from the date of this posting she has three weeks to remove all personal goods from my shop at **711 Daly St, Prairie City, Oregon**, or they will be taken to an appropriate place and disposed of. They were abandoned on December 3, 2019, and no indication of any intent to remove these items has been received by the shop owner.
Mary Brown
711 Daly St.
Prairie City, Oregon

222 Truck/Auto Parts & Accessories

222 Truck/Auto Parts & Accessories

NAPA
JOHN DAY AUTO PARTS
Closed Sunday
721 W. Main St., John Day • 541-575-1850

Parts for Cars, Trucks, Tractors, Tools & Shop Equipment

101 Legal Notices

101 Legal Notices

101 Legal Notices

NOTICE OF SUPPLEMENTAL BUDGET HEARING

A public hearing on a proposed supplemental budget for Prairie City School District, for the current fiscal year will be held at Prairie City School Library. The hearing will take place on Tuesday, January 21, 2020 at 6:30 PM. The purpose of the hearing is to discuss the supplemental budget with interested persons. A copy of the supplemental budget document may be inspected or obtained on or after January 15, 2020 at Prairie City School District, between the hours of 8 AM and 4 PM.

SUMMARY OF PROPOSED BUDGET CHANGES
Amounts shown are revised totals in those funds being modified

Fund: Title 1			
Resource	Amount	Expenditure	Amount
Additional Title 1 Funds	\$17,836	Instructional Assistant	\$4,572
		Professional Development	\$5,000
		Supplies/Textbooks	\$8,264
Revised Total Fund Resources	\$74,293	Revised Total Fund Expenditures	\$74,293
Explanation of Changes: Staff Development with RTI (response to intervention) to include math, reading mastery textbooks, supplies to increase Title program to include Math. New instructional assistant to work with teachers (half here, half in High School Success).			
Fund: CTE Revitalization			
Resource	Amount	Expenditure	Amount
Additional Carryover	\$61,789	Capital Outlay	\$61,789
Revised Total Fund Resources	\$111,789	Revised Total Fund Expenditures	\$111,789
Explanation of Changes: Complete CTE Barn			
Fund: IDEA			
Resource	Amount	Expenditure	Amount
Additional IDEA Funds	\$9,444	Increased Staff	\$9,444
Revised Total Fund Resources	\$45,944	Revised Total Fund Expenditures	\$45,944
Explanation of Changes: Increase instructional assistant time.			
Fund: High School Success			
Resource	Amount	Expenditure	Amount
Additional Funds	\$24,321	Increase Staff	\$10,280
		Professional Development	\$4,041
		Greenhouse Development	\$6,000
		Extra Programs	\$4,000
Revised Total Fund Resources	\$77,876	Revised Total Fund Expenditures	\$77,876
Explanation of Changes: Greenhouse improvements, additional staff to work with students, professional developments for staff, and Missoula Children's program and field trips.			
Fund: SRSA / Rural Education Achievement Program			
Resource	Amount	Expenditure	Amount
Unexpected Carryover	\$5,449	Computers for Students	\$5,449
Revised Total Fund Resources	\$20,949	Revised Total Fund Expenditures	\$20,949
Explanation of Changes: New Title grant program. Move summer program expenses here to be able to provide program to more children.			
State Personnel Development Grant			
Resource	Amount	Expenditure	Amount
New Grant	\$19,859	Increase Staff	\$8,511
		Professional Development	\$7,000
		Supplies, Software and Hardware	\$4,348
Revised Total Fund Resources	\$19,859	Revised Total Fund Expenditures	\$19,859
Explanation of Changes: New grant. Funds for staff to help with staff development and travel, data management software, computer and supplies.			
Title Funds: REAP Flex			
Resource	Amount	Expenditure	Amount
Additional Funds	\$3,672	Expanded Options for Students	\$1,800
		TAG Student Travel	\$500
		Supplies for TAG	\$1,372
Revised Total Fund Resources	\$9,143	Revised Total Fund Expenditures	\$9,143
Explanation of Changes: Increase funds to pay for students TAG classes, robotics, field trips and supplies.			
Title Funds: Student Support and Academic Enrichment			
Resource	Amount	Expenditure	Amount
Additional Funds	\$2,234	Increase supplies for year round title	\$802
		Increase supplies for summer program	\$1,061
Revised Total Fund Resources	12,234	Revised Total Fund Expenditures	\$12,234
Explanation of Changes: Increased funds to pay for more supplies for year round and summer programs.			