

651 Help Wanted



GRANT COUNTY Road Department Safety & Risk Manager
Days / Hours: 40 hours per week (Four 10 hour days)
Salary/Benefits: \$3708 per month with full county benefits
Job Duties: Work collaboratively with the Road Department's leadership team, and perform a wide variety of tasks related to safety, risk management, and traffic control within the department. Applicants must be able to read, write clearly, communicate effectively, work cooperatively as part of a team, and engage in professional, constructive, respectful work-related interactions. Knowledge of workplace safety standards and record keeping. Thorough knowledge of the safety policies and procedures that must be followed to comply with local, state, and federal OSHA rules and regulations. Use of computer and standard office equipment. Operate pickup truck, radios and other equipment in a safe, effective, and professional manner. Participate in and complete safety and competencies training as directed, and work emergency call-outs as required. Prior experience with two-way radio communication systems and sign repair and installation is preferred.

Screening Requirements: Sixty hours of college-level coursework and two years of experience in the areas of safety and hazardous materials, or an equivalent combination of education, training and experience to sufficiently perform the essential functions of the job as described. Applicants must hold a valid Oregon Driver's License or have the ability to obtain one within 30 days of hire. A valid Oregon CDL Driver's License is preferred. Ability to prepare documents with a computer and maintain electronic files required. Applicant is required to pass a pre-employment drug test.

Application Closing Date and Time: May 7, 2019 at 4 pm. Obtain an employment application and complete job description from Human Resources Manager Laurie Wright, 201 S. Humboldt St., #280, Canyon City, OR 97820; 541-575-0059; by email at wrightl@grantcounty-or.gov or apply online at www.grantcountyoregon.net.
Grant County is an AA/EEOE.

Bob McDaniel Logging and Construction is offering 4 full-time temporary positions in Okanogan & Ferry Counties located in the State of WA. Anticipated period of employment is 5/22/2019 to 12/1/2019. Qualified workers must have 3 mos experience logging & working with heavy equipment & expect to perform duties such as operating machinery, climbing trees, cutting, inspecting & trimming trees, rigging & sorting logs. Wage is \$18.00/hr. Anticipate a 40-hour workweek, ¾ of the hours guarantee. Free housing available for workers including U.S. workers who cannot reasonably return to their permanent residence at the end of each workday. Tools, supplies & equipment will be provided at no cost to the worker. Transportation and subsistence expense to the worksite will be provided or paid for by the employer upon 50% completion of contract or earlier. Out of state applicants can apply at their nearest local SWA office or contact the employer by phone at 509-322-3428. For the SWA servicing the area of intended employment contact WorkSource Okanogan at 509-826-7540. Reference job order number 206009425.

651 Help Wanted

Apple Farmer Inc is offering 14 full-time temp. positions in Grant County located in the State of WA. Anticipated period of employment is 6/10/2019 to 10/11/2019. Qualified workers must have 3 mos tree fruit experience & expected to perform general farm labor such as thinning, training, pruning fruit trees as well as hand harvesting apples & cherries. Workers may also operate farm equipment. Wage is \$15.03/hr. Piece rate for apples \$20-25 per bin, cherries \$6 per 20 or 30lb lug. Inquire about bonus rates. Anticipate a 40-hr workweek, ¾ of the hrs guaranteed. Free housing avail. for workers incl. U.S. workers who cannot reasonably return to their permanent residence at the end of each workday. Tools, supplies & equipment will be provided at no cost to the worker. Transportation & subsistence expense to the worksite will be provided or paid for by the employer upon 50% completion of contract or earlier. Out of state applicants can apply at their nearest local SWA office or contact the employer by phone at 509-750-1521. For the SWA servicing the area of intended employment contact WorkSource Central Basin at 509-766-4105. Reference job order number 206740104.

Sather Management Inc is offering 50 full-time temp. positions in Chelan County located in the State of WA. Anticipated period of employment is 6/10/2019 to 10/25/2019. Qualified workers must have 3 mos tree fruit experience & expected to perform general farm labor such as thinning, training, pruning fruit trees as well as hand harvesting. Workers may also operate farm equipment. Wage is \$15.03/hr. Piece rate for apples \$19-25 per bin, cherries \$2.98-7.50 per 17lb or 25lb lug. Anticipate a 35-hr workweek, ¾ of the hrs guaranteed. Free housing avail. for workers incl. U.S. workers who cannot reasonably return to their permanent residence at the end of each workday. Tools, supplies & equipment will be provided at no cost to the worker. Transportation & subsistence expense to the worksite will be provided or paid for by the employer upon 50% completion of contract or earlier. Out of state applicants can apply at their nearest local SWA office or contact the employer by phone at 509-470-5742. For the SWA servicing the area of intended employment contact WorkSource Wenatchee at 509-665-3722. Reference job order number 206640243.

Full-Time Employment Job opening: Journeyman Electrician, Burns, OR
 Job requirements include, current Oregon journeyman electrician license, and in compliance with the National Electrical Code (NEC), a valid drivers license, must be able to work well individually or with others, must be motivated and hard working and in good physical condition, must have good critical thinking and problem solving abilities, and good communication skills. Job responsibilities would include various residential, commercial and agricultural electrical installations, repairs and troubleshooting which may require electrician to be outside in varying weather conditions. Starting wage is dependent on experience.
 If interested, please send a cover letter, resume, and 3 references to Jiffy Electric LLC, 56 S Diamond Ave, Burns, OR 97720 or email: jiffyelectricllc@gmail.com Burns, OR. (541)573-6050/jiffyelectricllc@gmail.com

651 Help Wanted

Monument School
 Job openings for 2019-2020 school year.
 Paraprofessional teacher assistant - 4 hours per day.
 Transportation bus driver - 4 hours per day.
 These job announcements will remain open until filled. Interviews begin on April 29, 2019. For more information, please call the Monument School office at 541-934-2646.



651 Help Wanted

Value Added Inc is seeking applications for residential and vocational support staff. Duties include, training individuals with intellectual and developmental disabilities in activities of daily living and employment related skills. Starting pay - 11.50-12.00 per hour d.o.e. Pick up applications at Sue ZQ's Thrift Store.

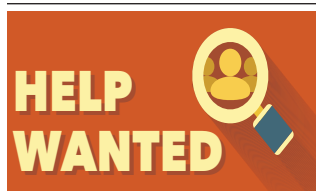

502 Real Estate

541-934-2946 Office
 541-519-6891 Cell
 41909 Cupper Creek Rd.
 Kimberly OR 97848

502 Real Estate



502 Real Estate

Julie Mansfield Smith
 Principal Broker/Owner
 cuppercreeklandco@gmail.com
 cuppercreeklandcompany.com

502 Real Estate

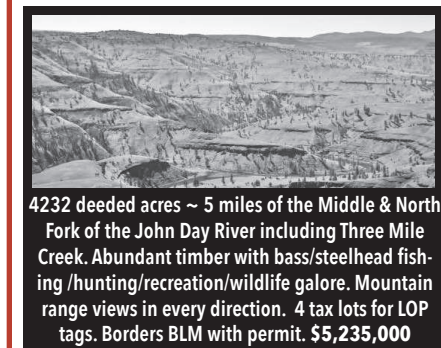

4232 deeded acres ~ 5 miles of the Middle & North Fork of the John Day River including Three Mile Creek. Abundant timber with bass/steelhead fishing/hunting/recreation/wildlife galore. Mountain range views in every direction. 4 tax lots for LOP tags. Borders BLM with permit. \$5,235,000

240 Acres Timberland in Heppner ~ Creek, rock pit, corrals. \$258,000. Possible terms OAC!
SOLD! 245 Acres land in Heppner with springs, timber. \$263,375
SOLD! 276 Ac Land in Kimberly ~ River frontage/ Water rites/Borders BLM. NOW \$350,000
SOLD! 3 Crow Ranch in Spray ~604 ac. dryland farm w/MH, shop, good springs. \$740,000
 LBH Ranch in Monument ~ 1031 Acres ~2/3 cabin, timber, creek, river views, borders BLM. \$1,195,000
 513 Ac. in Heppner ~ 2 creeks, springs, pond, timber, rock pit, corrals. 2 tax lots. Cabin needs TLC. \$607,500

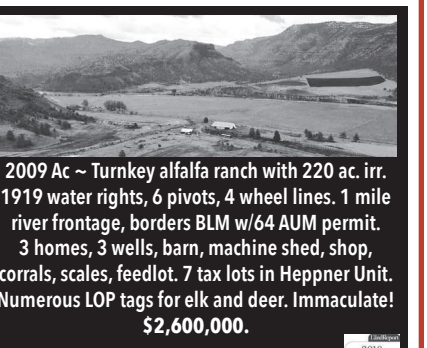

2009 Ac ~ Turnkey alfalfa ranch with 220 ac. irr. 1919 water rights, 6 pivots, 4 wheel lines. 1 mile river frontage, borders BLM w/64 AUM permit. 3 homes, 3 wells, barn, machine shed, shop, corrals, scales, feedlot. 7 tax lots in Heppner Unit. Numerous LOP tags for elk and deer. Immaculate! \$2,600,000.

WE HAVE QUALIFIED BUYERS LOOKING FOR LAND AND NEED MORE INVENTORY!

502 Real Estate

502 Real Estate

502 Real Estate

502 Real Estate

DUKE WARNER REALTY

Lori Hickerson, Principal Broker, GRI
 541-575-2617 • ljh@ortelco.net
Sally Knowles, Broker, GRI
 541-932-4493 • sknowles@ortelco.net
Babette Larson, Broker, GRI
 541-987-2363 • ddwr@ortelco.net
 Licensed In The State Of Oregon

"Your Professional Real Estate Choice in Grant County"

HOMES ON ACREAGE

4 Ac, 2 Story Custom Built Home!
 3/2, Open Floor Plan, Upgrades Throughout, View Deck, Shop w/Living Qtrs.
 Copper Crk Rd, Kimberly **\$345,000** #969

4+ AC W/FURNISHED LOG SIDED CUSTOM CABIN ON UNITY LAKE!
 Open Floor Plan, Loft, 3/1, Fenced, Private Dock, Large Shop. **\$349,000** #972
 (additional 5 ac w/well \$55,000)

560 Ac, Off Grid Beauty & Seclusion, 2 Story, Barn, Riding Area, Shop, Creek, LOP Tags, 86 Acres of Water of Record Rights. Luce Creek Rd, JD **\$995,000 #845**

COMMERCIAL

Commercial Property w/Living Space!
 173 N Canyon Blvd, JD **\$92,500** #898

Beautiful Office/Residence w/City Approval! Large Lot
 1392 SF, Kitchen, 2 Bath, Basement, Storage Shed.
 JD. **\$137,900** #930

Turn Key Business Opportunity!
 Art, Deli, Espresso, Ice Cream, Growlers.
 150 E Franklin Ave, DV **\$247,500** #955

DAYVILLE MERCANTILE, Est 1896!
 Beer, Bourbon, Beans & Bacon, Prime Location On 1 Ac, 6000+ Sf Store, 4 Bed Living Qtrs Plus Generate Additional Income With New Apartment Building. **\$499,000** #965

NEW LISTING
RENOVATED HILL TOP BEAUTY ON 1 ACRE! Spectacular Views, Quality Finishes Throughout, 1972 MF, 3/2, Deck, Large shop. **\$120,000** #984

7.5 AC HOBBY FARM! Fabulous Mt & Valley Views Bordering The John Day River, Cottage Style Home, 2/2, Large Metal Shop, Steel Machine Shed, Fenced, Concrete Pad. **\$280,000** #981

SMALL ACREAGE DREAM!
 Lovely Home On 5.52 Acres, 3/3, Views, Deck, Large Shop. **\$500,000** #985

NEW PRICE
8 Ac, Earth Bermed Home, 3/2, Sunroom, Views, Landscaped, Carport, Garage, Large Shop. 62013 Dug Out Ln, JD ~~\$475,000~~ \$435,000 #894

JOHN DAY/CANYON CITY
 2/1, Upgrades Throughout, RV Area.
 200 W Izee, CC **\$76,000** #931

Large Family Home, 4/2, Garage.
 205 Nugget St Cc **\$225,000** #952

PRAIRIE CITY
 Mt Views, 2/1, Deck, Shop, Room For RV.
 234 S Washington St, PC **\$48,000** #962

HUNTING/RECREATIONAL
310 Ac, Remote, Limited Access, LOP Tags.
 Wiley Crk Rd, DV **\$175,000** #763

Visit Us At: www.dukewarnerrealtyofeasternoregon.com

The real estate market is extremely active. If you are thinking about buying or selling please give us a call!

SERVICE DIRECTORY A Services Directory listing is \$9.95 per week for a single ad (13 week minimum). Call the Blue Mountain Eagle today! 541-575-0710.

<p>ANTIQUES / JEWELRY</p> <p>PRAIRIE CITY ANTIQUES AND FINE JEWELRY</p> <p>Wed. - Sat. 11 am - 5 pm Located at Prairie City Antiques 131 W. Front St. 541-820-3524 (Or by appointment.) 541-620-2198</p> <p>• Buy & Sell • Jewelry Repair • Antiques • Estate Liquidation • Gold & Silver</p>	<p>APPLIANCE REPAIR • HEATING • COOLING</p> <p>• Refrigeration & appliance repair • All makes & models • Major & minor appliances</p> <p>• Sales • Services • Parts & Installation</p> <p>M.D. ENTERPRIZES 541-575-2010 116 N. Clark St., Canyon City • CCB#87590 <i>Serving You Since 1989 Matt Turner, Owner</i></p>	<p>ATTORNEY</p> <p>RR LAW</p> <p>Law Office of Robert Raschio WITH ASSOCIATES JUSTIN MOREHOUSE & WILL THOMSON 541-575-5750 Full Service Law Firm</p>	<p>YOUR AD</p> <p>Have your FULL COLOR ad seen weekly for only</p> <p>\$9.95 PER WEEK</p> <p>WHAT A GREAT BUY! CALL US NOW! 541-575-0710</p>
<p>ATV's</p> <p>WORLD'S TOUGHEST ATV</p> <p>John Day POLARIS Sales & Service 541-575-0828</p> <p>West Hwy. 26, John Day</p> <p>ATV's can be hazardous to operate. ATVs with engine sizes larger than 90cc may not be ridden by anyone under 16 years of age. ATVs with 80cc engines may not be ridden by anyone under 12 years of age. ATVs with 40cc engines may not be ridden by anyone under 6 years of age. Always wear a helmet and be sure to take a training course. For safety and training information, see your Polaris dealer or call 1-800-342-3764. © 2015 Polaris Sales Inc.</p>	<p>AUTOMOTIVE</p> <p>WRIGHT CHEVROLET INC. SINCE 1959 Customer Satisfaction is our #1 goal</p> <p>The Wright Choice</p> <p>Sales & Service: 550 Main St. Fossil, OR Give us a call: 800-336-0057 / 541-763-4175 Sales: Bill or Paul; Services: Bill Sr.; Parts: Denny</p>	<p>AUTOMOTIVE</p> <p>Grant County Automotive</p> <p>For all your automotive needs!</p> <ul style="list-style-type: none"> • Automotive Repair • ATV Repair • Parts (Auto & ATV) <p>All makes & models, lube, oil filter/tune-up</p> <p>200 E. Main St., John Day (541) 575-0211</p>	<p>YOUR AD</p> <p>Have your FULL COLOR ad seen weekly for only</p> <p>\$9.95 PER WEEK</p> <p>WHAT A GREAT BUY! CALL US NOW! 541-575-0710</p>
<p>AUTOMOTIVE REPAIR & TOWING</p> <p>DOUG'S</p> <p>24-Hour Towing Mechanical Repair</p> <p>MOTOR VEHICLE REPAIR 541-575-0544</p> <p><i>"Honesty, Integrity, Quality"</i></p>	<p>DOORS</p> <p>The Genuine. The Original.</p> <p>OVERHEAD DOOR</p> <p>OVERHEAD DOOR COMPANY OF CENTRAL OREGON 63056 Lower Meadow Drive, Suite 150 Bend, OR 97701 CCB No. 167946 (541) 389-3667</p> <p>Central Oregon's Most Experienced Team of Door Professionals</p>	<p>FEED</p> <p>GIBCO AG & INDUSTRIAL</p> <p>Parts & Equipment Keystone Fencing & Chevron Lubes</p> <p>Feed Smart Lic • Payback • Nutrena</p> <p>Supplies Featuring: HW • Behlen • Powder River</p> <p>311 North Canyon City Blvd., Canyon City 541-575-2050 • Mon.-Sat., 8-6</p>	<p>GLASS</p> <p>Mobile Glass of Oregon, inc</p> <p>SEE US FOR RESIDENTIAL, COMMERCIAL & INDUSTRIAL NEEDS</p> <p>Insurance Claims Accepted 27825 Wilderness Road, John Day JELD-WEN 541-575-1055 ccb 175517</p>