

# Buying a house isn't always a walk in the park. We just want it to feel like one.



All in, for you.™

RESIDENTIAL • NEW CONSTRUCTION • INVESTMENT • MULTI-FAMILY • BARE LAND • COMMERCIAL



**OPEN HOUSE SAT 12-3**



\$1,750,000 | #220123882

**60617 Golf Village Loop, Bend**  
Single-story home in Widgi Creek. 3629 sq. ft., 3 bed suites on 12th fairway. Gate Code # 7 7 0 2.  
**KIRK SANDBURG, BROKER**  
541-556-1804 / kirk@windermere.com



**NEW LISTING  
OPEN HOUSE SAT 11-2**



\$425,000 | #21625966

**20712 Lavender Avenue, Sherwood**  
3 bed, 2 bath, 1751 sq. ft. remodeled townhome. Oversized garage with storage.  
**ALICIA WOBBE, BROKER**  
541-788-1903 / aliciawobbe@windermere.com



**OPEN HOUSE SUN 11-2**



\$975,000 | #220123633

**3143 NW Melville Drive, Bend**  
Gorgeous 3 bed home in Awbrey Glen. Hickory hardwood floors, solar, office suite.  
**MIKE TUCKER, BROKER**  
503-939-6155 / Mike@highdesertdwelling.com



**NEW LISTING  
OPEN HOUSE SAT 11-2**



\$455,000

**1885 SE Bear Creek Road, Bend**  
Adorable 3 bed, 2 bath home in Larkspur Community. 1048 sq. ft., Garage, Fully Remodeled.  
**MIKE TUCKER, BROKER**  
503-939-6155 / Mike@highdesertdwelling.com



**NEW LISTING**



\$84,500 | #220124581

**6100 S Hwy 97 #50, Redmond**  
2 bed in mobile home park. Park rent \$425 includes carport, storage, water, sewer, garbage  
**DIANA BARKER, CAITLIN DUCSIK, BROKERS**  
541-480-7777, 970-209-9055



**BACK ON MARKET**



\$392,500 | #220120016

**3050 NW 9th Place, Redmond**  
3 bed, 2 bath, 1288 sq. ft., large lot in cul-de-sac. 2-car garage, RV pad & shed. Fenced.  
**ALICIA WOBBE, BROKER**  
541-788-1903 / aliciawobbe@windermere.com



**PRICE REDUCED**

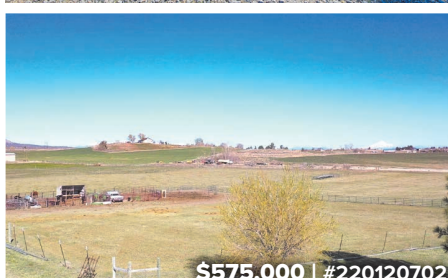

\$575,000 | #220120702

**1054 SW Dover Lane, Metolius**  
Hobby farm with Cascade views. 3 bed 2 bath, 36x36 shop. 6+ irrigated acres, fenced.  
**RACHEL BARE, BROKER**  
541-604-0085 / rbare@windermere.com



**NEW LISTING**



\$875,000

**2370 SW Helmholtz Way, Redmond**  
3 bed, 2 bath, 2100 sq. ft. on 1.56 acres with mountain views and attached RV garage.  
**JAMIE GARZA, BROKER**  
541-788-0860 / Levisongroupinfo@gmail.com



**PRICE REDUCTION**



\$1,200,000

**2552 NW Majestic Ridge, Bend**  
3 bed, 2.5 bath, 2746 sq. ft. River's Edge home. Master on main, large bonus room and office.  
**JAMES KEANE, BROKER**  
541-207-2270 / Jkeane29@gmail.com



**NEW PRICE**



\$1,399,000 | #220117448

**2622 SW Glacier Place, Redmond**  
Class A, single-level office building, fully leased. Large parking lot with add'l street parking.  
**KARIANN BOX/ AUDREY COOK, BROKERS**  
541-350-3055 / 541-480-9883



**NEW PRICE**

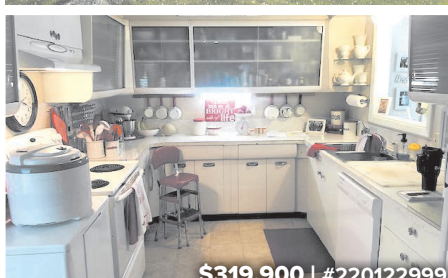

\$319,900 | #220122999

**1118 SW 15th Street, Redmond**  
Charming mid-century cottage, 2 bed, 1 bath, centrally located near schools and Dry Canyon.  
**KARIANN BOX/ AUDREY COOK, BROKERS**  
541-350-3055 / 541-480-9883



**NEW PRICE**



\$919,900 | #220116229

**4780 NE 21st Street, Redmond**  
1993 farmhouse. 4.8 acres. 4 bed, 3 bath, 1200 sq. ft. detached guest quarters. Outbuildings.  
**KARIANN BOX/ AUDREY COOK, BROKERS**  
541-350-3055 / 541-480-9883



\$225,000 | #220122746

**710 NW 13th Street, Redmond**  
Few remaining lots on the canyon rim over looking Dry Canyon in the heart of Redmond!  
**KRIS REES, BROKER**  
541-410-4756 / Krees47@gmail.com



\$230,000 | #220122217

**614 NW 13th Street, Redmond**  
Secure your spot now on spacious lot over looking Dry Canyon in Canyon Rim Village!  
**KRIS REES, BROKER**  
541-410-4756 / Krees47@gmail.com



**NEW LISTING**



\$725,000 | #220124663

**3663 SW 47th Street, Redmond**  
Mtn. Views. 1958 sq. ft, 3 bed 2 bath, garage. Outdoor living: pizza oven, fire-pit, greenhouse.  
**BARBARA MYERS, PRINCIPAL BROKER**  
541-480-7183/ barb@barbmyers.com



**NEW LISTING**



\$925,000 | #220124206

**1008 NW 95th Street, Redmond**  
Multi-gen opportunity, separate living area with kitchenette. 2nd primary suite, large fam room.  
**ANGELA BOOTHROYD, BROKER**  
541-410-2572 / aboothroyd@windermere.com



WINDERMERE CENTRAL OREGON REAL ESTATE

**BEND**  
807 SW Industrial Way  
541-388-0404

**REDMOND**  
821 SW 6th Street  
538 SW Highland Ave.  
541-923-HOME

**COMMERCIAL**  
538 SW Highland Ave.  
541-410-3484

**MADRAS**  
161 SE 5th Street  
541-475-7001

**SUNRIVER**  
57100 Beaver Drive  
Bldg. 22 Suite 220  
541-323-5888

