

John Snippen
was awarded the prestigious
International President's Elite
award for 2020.



"Thank you to my clients and business partners for making this possible."
John



JOHN SNIPPEN
Principal Broker, MBA, ABR, CRS, EA, GRI, PSA, SRES, SRS
541.948.9090, john@snippen.com



Modern single-level home in North Rim with stunning views from Mt. Bachelor to Mt. Hood. 4165 sq. ft., 3 bedroom, 2 bath with master chef kitchen, media room and art studio. \$2,900,000 • MLS 220116104
DEBBIE BENSON, Broker, 541.480.6448



Recently updated cozy cottage close to town in Prineville. 1088 sq. ft., 3 bedroom, cozy living room and larger kitchen with oversized mud/utility room. Fully fenced with new shed. \$265,000 • MLS 220107674
CAROL SWENDSEN, Broker, 503.880.2788



MLS 220116483

PENDING



SMALL ACREAGE CLOSE TO TOWN
\$1,150,000
Dana Miller, 541.408.1468
Principal Broker



MLS 220116528

NEW LISTING



TOWNHOME ON THE HAUL TRAIL
\$595,000
Kristi Kaufman/Catherine Scanland,
541.610.2878, 541.233.3191, Brokers



MLS 202002624



PLATTED PRINEVILLE SUBDIVISION
\$2,100,000
Mary Doyle, 541.280.4372
Principal Broker



MLS 220115846



FURNISHED SUNRIVER HOME
\$1,199,900
Tiffany & John Gidley, 541.480.8488,
503.851.5321, Brokers



MLS 220115705



HISTORIC TUMALO FARMS
\$1,750,000
Patty Dempsey, 541.480.5432
Principal Broker



MLS 220115878



AWBREY VILLAGE WITH VIEWS
\$850,000
Jen Bowen, 541.280.2147
Broker



MLS 220112180

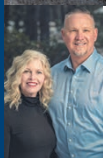

640 ACRES EAST OF BEND
\$795,000
Mike & Lori Dixon, 541.207.4625,
541.480.2310, Brokers



MLS 202003138



13 ACRE INDUSTRIAL PROPERTY
\$599,000
Sierra Holmly, 541.600.7777
Broker

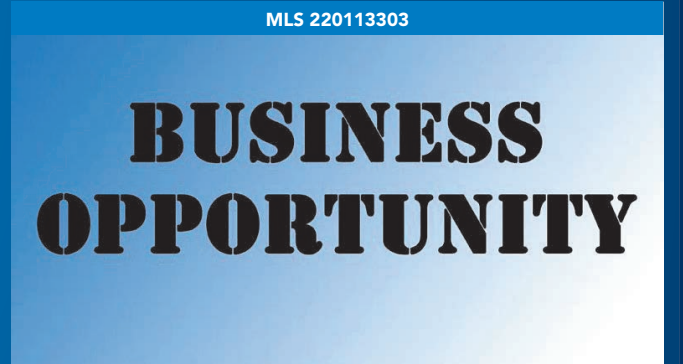

MLS 220113303



MOVING & STORAGE BUSINESS
\$450,000
Al Eastwood, 541.350.0987
Principal Broker



MLS 220114921



3 BEDROOM 7TH MTN RESORT CONDO
\$345,000
Matt Robinson, 541.977.5811
Principal Broker

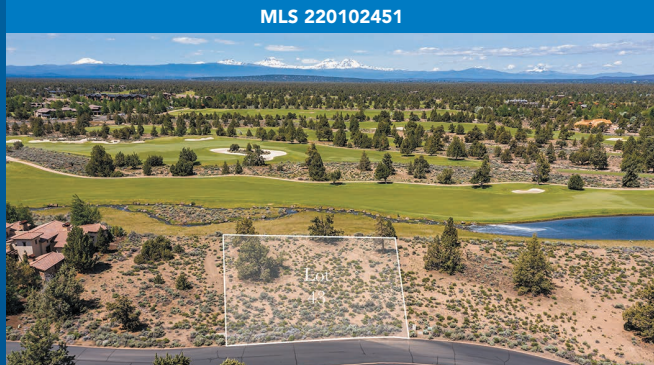

MLS 220102451



PRONGHORN ESTATES VIEW LOT
\$199,900
Annie Montgomery, 541.480.4301
Principal Broker

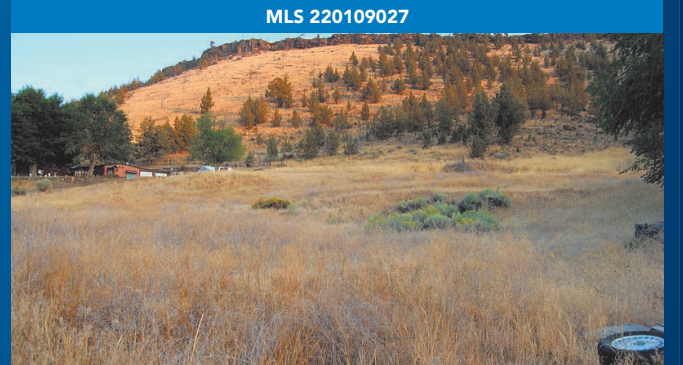

MLS 220109027



MEADOW LAKES GOLF COURSE LOT
\$175,000
Bill Pon, 541.815.4140,
Principal Broker



Multi-tenant, 6974 sq. ft. commercial building on a prime corner lot in the North Brinson Industrial Park. Includes plans for additional mixed-use building on this large 0.73 acre lot. \$1,995,000 • MLS 220110873
BILL PON, Principal Broker, 541.815.4140



Highly visible property on Greenwood Ave. and 10th St. The building has been renovated inside and out and is now available to lease! Ground 1479 sq. ft., \$1.95/SF/Mo. Top 1554 sq. ft. \$1.80/SF/Mo. • MLS 220115416
PAULA VAN VLECK, Broker, 541.280.7774

COLDWELL BANKER
BAIN

541.382.4123
www.bendproperty.com
486 SW Bluff Dr. in the Old Mill District
Open Monday-Friday 8am-5pm
Saturday by appointment.

