

# LYTLE, the COMING TERMINUS

of the Columbia Southern Railway.

On the Renowned Deschutes River

LOTS ARE NOW ON THE MARKET.

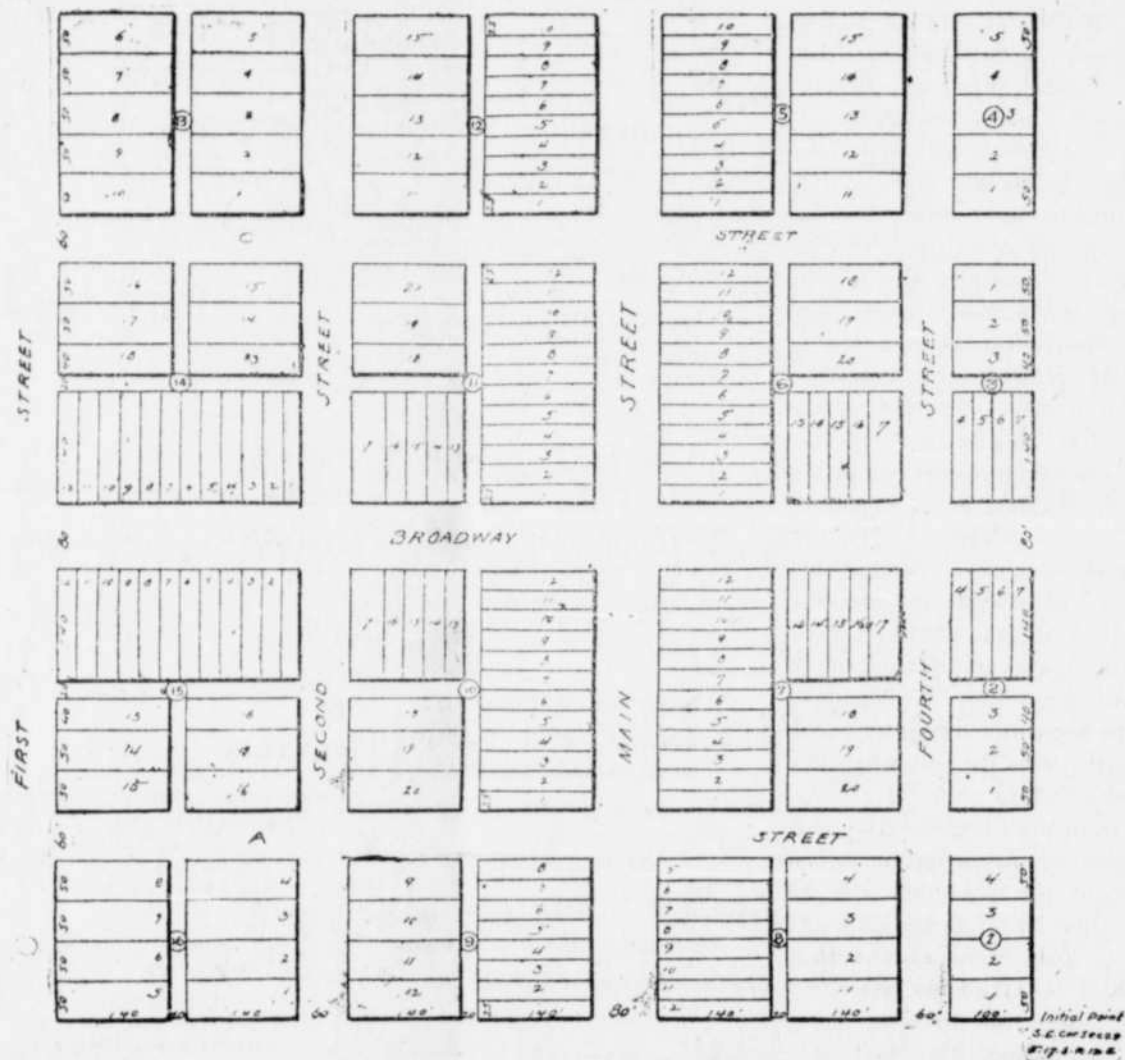
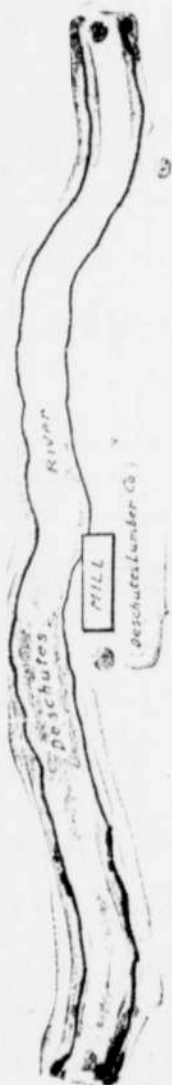

Located at the northernmost fringe of the famous yellow pine timber belt of Oregon the investor needs no further inducements to get in line with the purchasers of this valuable property. Lots are being disposed of rapidly. Particulars may be had by calling upon or writing to the

**Lytle Townsite Company,**  
Deschutes, Oregon.

## CONTRACTS MADE

COLUMBIA SOUTHERN EXTENSION ASSURED.

Presidents Harriman and Lytle Sign Agreements—Construction Soon to Begin.

(Oregonian Dec. 15.)

That the Columbia Southern Railroad will be extended from Shaniko to Bend and that work will be commenced early in next year is assured. The contracts between President Harriman and President E. E. Lytle, of the Columbia Southern, have been signed and all agreements have been satisfactorily entered into. All that now remains is to complete plans for the extension, have the material for the road shipped to the construction points, and commence building. Mr. Lytle announces that this will be done just as soon as possible. In talking of the matter yesterday Mr. Lytle said: "All doubt is now removed. The road will be built. There are no longer any disagreements between Mr. Harriman and myself. We have made satisfactory concessions, and the contracts signed."

"I cannot say more than this at present, because there yet remain

## DESCHUTES

The name of which was originally "The Bend," received its present name by a change being ordered by the Post-office Department about a year ago.

The Deschutes Townsite Company is now offering  
**CHOICE LOTS AT \$100 and UPWARDS**

The Oregonian's article printed herewith shows what an intense interest is being taken in this country by the people of a commercial center like Portland.

This will be—not a mere jumping-off place—but a city in a few years' time. Possesses all the natural advantages to make it such, timber, water power, irrigated land, etc.

Send in your order for a lot at once to the

**Deschutes Townsite Co**

**OREGON.**

some matters to be decided upon by myself, relative to the exact route of the extension. I think these matters will be settled in a few days and that all plans of the company relative to the extension may be made public."

Now that the agreement between Mr. Harriman and Mr. Lytle have been made, the bonds will be issued by the Columbia Southern immediately and the most, if not all of them will be taken up by Mr. Harriman. In this manner the money necessary to build 100 miles of road from Shaniko to Bend, will be raised. The estimated cost of this extension is \$1,500,000.

Several routes have been surveyed between the two points to be connected by the extension, and the officials of the road are having some difficulty in deciding upon the exact route to be chosen. All of them present good possibilities, but the question before the railroad people, how to select the best route for the road and for the country that will give railway service.

It is expected that dirt will fly on the grade for the extension next spring. Work will then be pushed with all the speed possible until the line is completed into Bend. The route is a comparatively easy one, and there are but few heavy grades to be dealt with