

LYTLE, the COMING TERMINUS

of the Columbia Southern Railway.

On the Renowned Deschutes River

LOTS ARE NOW ON THE MARKET.

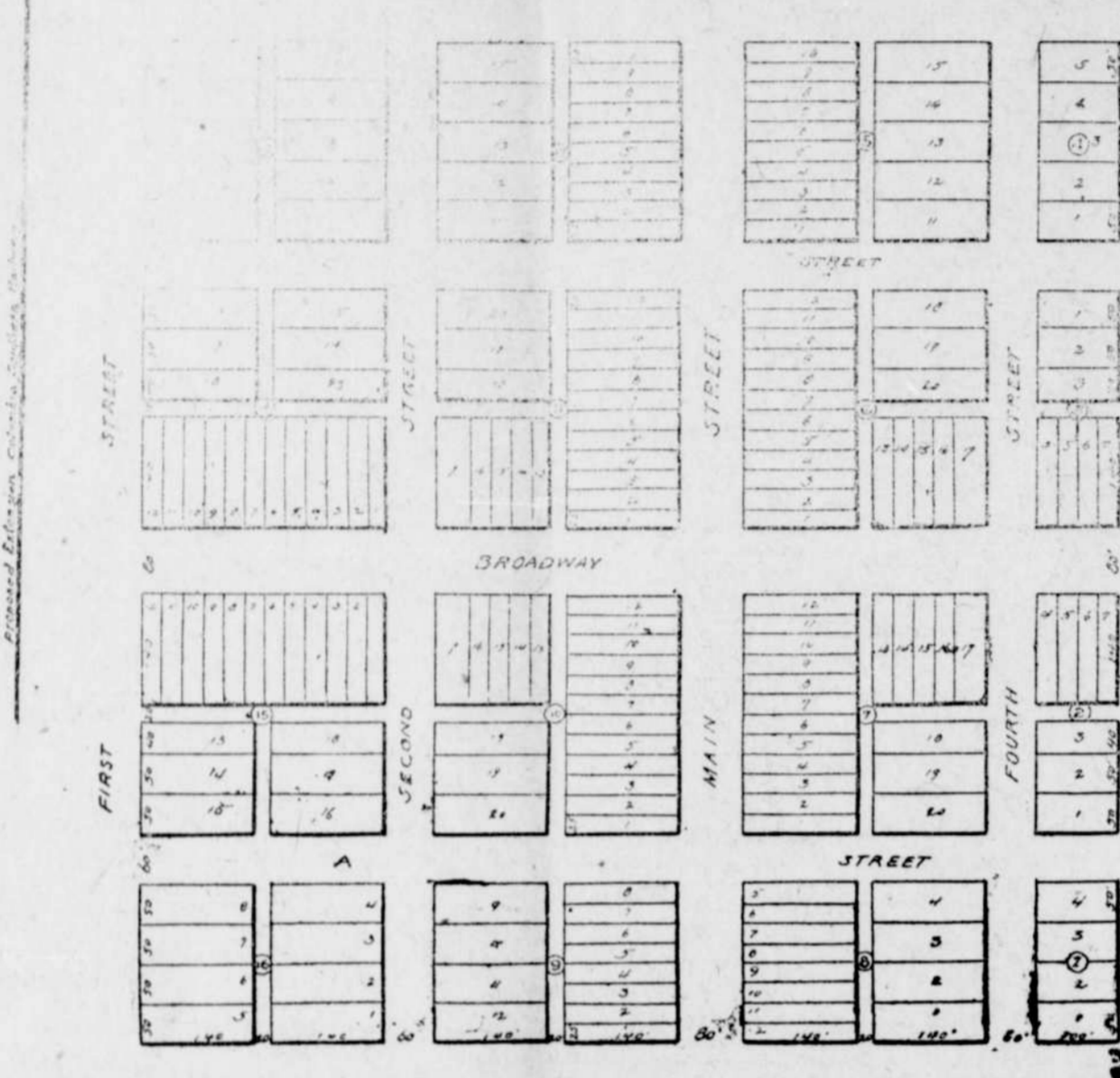

Located at the northernmost fringe of the famous yellow pine timber belt of Oregon the investor needs no further inducements to get in line with the purchasers of this valuable property. Lots are being disposed of rapidly. Particulars may be had by calling upon or writing to the

Lytle Townsite Company,

Deschutes, Oregon.

Timber Land, Act June 3, 1878.
NOTICE FOR PUBLICATION.
U. S. Land Office, Lakeview, Oregon,
October 17, 1903.

Notice is hereby given that in compliance with the provisions of the act of Congress of June 3, 1878, entitled "An act for the sale of timber lands in the States of California, Oregon, Nevada, and Washington Territory," as extended to all the public land states by act of August 4, 1892, the following-named persons have filed in this office their sworn statements, to-wit:

- Isaac R Young of Rosland, county of Klamath, state of Oregon; sworn statement No 2381, for the purchase of the NW 1/4 NE 1/4, R 9 E, W 1/4 and SW 1/4 NW 1/4 sec 8, Tp 22 S, R 9 E, W 1/4.
- Kliah Young of Rosland, county of Klamath, state of Oregon; sworn statement No 2382, for the purchase of the S 1/2 NE 1/4 and W 1/2 SE 1/4 sec 7, Tp 22 S, R 9 E, W 1/4.
- John Young of Rosland, county of Klamath, state of Oregon; sworn statement No 2383, for the purchase of the N 1/2 NE 1/4 and SW 1/4 NE 1/4 sec 11 and NW 1/4 NW 1/4 sec 12, Tp 22 S, R 9 E, W 1/4.

Laura F Abel of Rosland, county of Klamath, state of Oregon; sworn statement No 2384, for the purchase of the W 1/2 SW 1/4 sec 11 and W 1/2 NW 1/4 sec 14, Tp 23 S, R 9 E, W 1/4.

That they will offer proof to show that the land sought is more valuable for its timber or stone than for agricultural purposes, and to establish their claims to said land before G. B. Wardwell, U. S. Commissioner at Silver Lake, Oregon, on Tuesday, the 18th day of January, 1904.

They name as witnesses: Roy Johnson, Hugh Johnson, John Young, Kliah Young, Isaac Young, Laura F Abel, of Rosland, Oregon.

Any and all persons claiming adversely the above-described lands are requested to file their claims in this office on or before the said 18th day of January, 1904.

E. M. BRATTAIN, Register.

Fry's Family Medicines
Are manufactured by Daniel J. Fry at Salem, Oregon. He is a graduate of the Philadelphia College of Pharmacy and has had twenty-seven years' experience in the compounding and dispensing of drugs and medicines. If you are out of sorts, give us a trial; if we fail to give relief, we refund your money. Correspondence solicited and confidentially answered. Fry's Family Medicines are for sale by W. H. Staats, Deschutes and Smith & Will, Sisters.

Timber Land, Act June 3, 1878.
NOTICE FOR PUBLICATION.
U. S. Land Office, Lakeview, Oregon,
September 29, 1903.

Notice is hereby given that in compliance with the provisions of the act of Congress of June 3, 1878, entitled "An act for the sale of timber lands in the States of California, Oregon, Nevada and Washington Territory," as extended to all the public land states by act of August 4, 1892,

William G. Close, of Hubbing, county of St. Louis, state of Minnesota, has filed in this office his sworn statement No. 1988, for the purchase of the S. E. Q. of Section No. 15 in Township No. 21 S., Range No. 15 E., W. 1/4, and will offer proof to show that the land sought is more valuable for its timber or stone than for agricultural purposes, and to establish his claim to said land before G. B. Wardwell, U. S. Commissioner at Silver Lake, Oregon, on Saturday, the 26th day of December, 1903.

He names as witnesses: John Ryan, of Prineville, Oregon; John McCormack, of Hubbing Minn.; Frank Bogue, David Wilhelm, of Lava, Oregon.

Any and all persons claiming adversely the above-described lands are requested to file their claims in this office on or before said 26th day of December, 1903.

E. M. BRATTAIN, Register.

Timber Land, Act June 3, 1878.
NOTICE FOR PUBLICATION.
United States Land Office, Lakeview, Oregon,
October 14, 1903.

Notice is hereby given that in compliance with the provisions of the act of Congress of June 3, 1878, entitled "An act for the sale of timber lands in the States of California, Oregon, Nevada and Washington Territory," as extended to all the public land states by act of August 4, 1892, the following-named persons have filed in this office their sworn statements, to-wit:

Frank J. West, of St. Paul, county of Ramsey, state of Minnesota; sworn statement No. 1989, for the purchase of the NW 1/4 SW 1/4, sec. 14, N 1/2 S 1/2, and NE 1/4 SW 1/4, Sec. 13, Tp. 21 S., R. 14 E., W. M.

Lucy West, of St. Paul, county of Ramsey, state of Minnesota; sworn statement No. 1991, for the purchase of the NW 1/4 SW 1/4, Sec. 25, N 1/2 S 1/2, and S 1/2 SE 1/4, Sec. 27, Tp. 21 S., R. 14 E., W. M.

Alberta E. Buck, of Tacoma, county of Pierce, state of Washington; sworn statement No. 1992, for the purchase of the SW 1/4 NW 1/4, R 14 E, W 1/4, SW 1/4, Sec. 23 Tp. 21 S., R. 14 E., W. M.

George L. Buck, of Tacoma, county of Pierce, state of Washington; sworn statement No. 1993, for the purchase of the W 1/2 of R 14, sec. 23 Tp. 21 S. R. 14 E., W. M.

Jasper A. Martin, of San Jose, county of Santa Clara, state of California; sworn statement No. 1979, for the purchase of the S. W. 1/4, Sec. 11, Tp. 21 S., R. 14 E., W. M.

That they will offer proof to show that the land sought is more valuable for its timber or stone than for agricultural purposes, and to establish their claims to said land before G. B. Wardwell, U. S. Commissioner at Silver Lake, Oregon, on Tuesday the 29th day of December, 1903.

They name as witnesses: Frank J. West, Lucy West, of St. Paul, Minnesota; Alberta E. Buck, George L. Buck, of Tacoma, Washington; Jasper A. Martin, of San Jose, California. Any and all persons claiming adversely the above-described lands are requested to file their claims in this office on or before the said 29th day of December 1903.

E. M. BRATTAIN, Register.

Timber Land, Act June 3, 1878.
NOTICE FOR PUBLICATION.
U. S. Land Office, Lakeview, Oregon,
September 29, 1903.

Notice is hereby given that in compliance with the provisions of the act of Congress of June 3, 1878, entitled "An act for the sale of timber lands in the States of California, Oregon, Nevada and Washington Territory," as extended to all the public land states by act of August 4, 1892, the following-named persons have filed in this office their sworn statements, to-wit:

John H. Overturf, of Portland, county of Multnomah, state of Oregon; sworn statement No. 1913, for the purchase of the S. E. Q. Sec. 9, Tp. 21 S., R. 14 E., W. M.

That he will offer proof to show that the land sought is more valuable for its timber or stone than for agricultural purposes, and to establish his claim to said land before G. B. Wardwell, U. S. Commissioner at Silver Lake, Oregon, on Tuesday the 29th day of December 1903.

He names as witnesses: J. H. Overturf, Lawrence Fosdick, of Portland, Oregon; John L. Schuylerman, of Lyden, Washington; Samuel C. Hawthorne, of Aracoma, Nebraska; Isaac Williams, of Silver Lake, Or.; D Van Fossen, H A Foster, of Prineville, Or.

Any and all persons claiming adversely the above-described lands are requested to file their claims in this office on or before the said 29th day of December 1903.

E. M. BRATTAIN, Register.

Timber Land, Act June 3, 1878.
NOTICE FOR PUBLICATION.
United States Land Office,
Lakeview, Oregon, October 17, 1903.

Notice is hereby given that in compliance with the provisions of the act of Congress of June 3, 1878, entitled "An act for the sale of timber lands in the States of California, Oregon, Nevada and Washington Territory," as extended to all the public land states by act of August 4, 1892, the following-named persons have filed in this office their sworn statements, to-wit:

Marion E Carson, of Bemidji, county of Beltrami, state of Minnesota; sworn statement No. 2394, for the purchase of the W 1/2 NW 1/4, SW 1/4 NW 1/4, sec. 21, Tp. 21 S., R. 14 E., W. M.

Ole J. Melligan, of Bemidji, county of Beltrami, state of Minnesota; sworn statement No. 2395, for the purchase of lots 2, 11 & 12, sec 21, lot 3 & 21 Tp 21 S, R 14 E, W. M.

That they will offer proof to show that the land sought is more valuable for its timber or stone than for agricultural purposes, and to establish their claims to said land before G. B. Wardwell, U. S. Commissioner at Silver Lake, Oregon, on Thursday, the 28th day of January, 1904.

They name as witnesses: Louis Nelson, John J. Poken, Ole Erickson, of Deschutes, Oregon; Marion E Carson, Ole J. Melligan, of Bemidji, Minnesota.

Any and all persons claiming adversely the above-described lands are requested to file their claims in this office on or before the said 28th day of January, 1904.

E. M. BRATTAIN, Register.

Stonewall America's Leading Whiskey
FAMOUS HOP GOLD BEER.
Domestic and Imported Wines and Cigars
O'NEIL BROS., PRINEVILLE, OR.

Timber Land, Act June 3, 1878.
NOTICE FOR PUBLICATION.
U. S. Land Office, Lakeview, Oregon,
September 29, 1903.

Notice is hereby given that in compliance with the provisions of the act of Congress of June 3, 1878, entitled "An act for the sale of timber lands in the States of California, Oregon, Nevada and Washington Territory," as extended to all the public land states by act of August 4, 1892, the following-named persons have filed in this office their sworn statements, to-wit:

Hattie A. Cameron, of Bemidji, county of Beltrami, state of Minn. Sworn statement No. 3369, for the purchase of the W 1/2 NW 1/4 and W 1/2 SW 1/4 Sec. 24 Tp. 21 S., R. 14 E.

Erick Erickson, of McIntosh, county of Columbia, state of Minn. Sworn statement No. 3370, for the purchase of the SW 1/4 SE 1/4, S 1/2 SW 1/4, Sec. 12 and NE 1/4 NW 1/4 sec. 13, Tp. 22 S., R. 14 E., W. M.

Olla Olson, of Shevlin, county of Beltrami, state of Minn. Sworn statement No. 3371, for the purchase of the S 1/2 SE 1/4, Sec. 11, NE 1/4 NE 1/4, Sec. 14, and NW 1/4 NW 1/4 Sec. 13, Tp. 22 S., R. 14 E., W. M.

Anton Erickson, of Bemidji, county of Beltrami, state of Minn. Sworn statement No. 3372, for the purchase of the S 1/2 NW 1/4, SW 1/4 NW 1/4, Sec. 13, NE 1/4 SE 1/4, Sec. 14, Tp. 22 S., R. 14 E., W. M.

John A. Widness, of Shevlin, county of Beltrami, state of Minn. Sworn statement No. 3373, for the purchase of the SE 1/4 SW 1/4, Sec. 13, NE 1/4 NW 1/4 and W 1/2 NE 1/4, Sec. 24, Tp. 22 S., R. 14 E., W. M.

Arno Solberg, of Bemidji, county of Beltrami, state of Minn. Sworn statement No. 3374, for the purchase of the S 1/2 NW 1/4, NW 1/4 NW 1/4 Sec. 24 and N. E. 1/4 S. E. 1/4 sec. 25, Tp. 22 S., R. 14 E., W. M.

Alexander D. Cameron, of Bemidji, county of Beltrami, state of Minn. Sworn statement No. 2396, for the purchase of the S. W. 1/4 sec. 7, Tp. 22 S., R. 14 E., W. M.

That they will offer proof to show that the land sought is more valuable for its timber or stone than for agricultural purposes, and to establish their claims to said land before G. B. Wardwell, U. S. Commissioner at Silver Lake, Oregon, on Saturday the 2nd day of January 1904.

They name as witnesses: John A. Widness, of Shevlin, Minn.; L. Nelson, of Deschutes, Oregon; Hattie A. Cameron, Anton Erickson, Arno Solberg, Alexander D. Cameron, of Bemidji, Minn.; Olla Olson, of Shevlin, Minn.; Erick Erickson, of McIntosh, Minn.; Anders P. Bloom, of Spaulding, Minn.

Any and all persons claiming adversely the above-described lands are requested to file their claims in this office on or before the said 2nd day of January 1904.

E. M. BRATTAIN, Register.

PRINEVILLE-SILVER LAKE STAGE LINE.

DICK VANDEVERT, PROP.
Carries U. S. Mail, express and passengers through in two days. Takes you through the picturesque Deschutes Valley and the great yellow pine timber belt.
EXPRESS AND PASSENGERS WAYBILLED AT DESCHUTES POSTOFFICE.
L. A. BOOTH Prineville Agent.

The Echo is Reliable.