

LYTLE, the COMING TERMINUS

of the Columbia Southern Railway.

On the Renowned Deschutes River

LOTS ARE NOW ON THE MARKET.

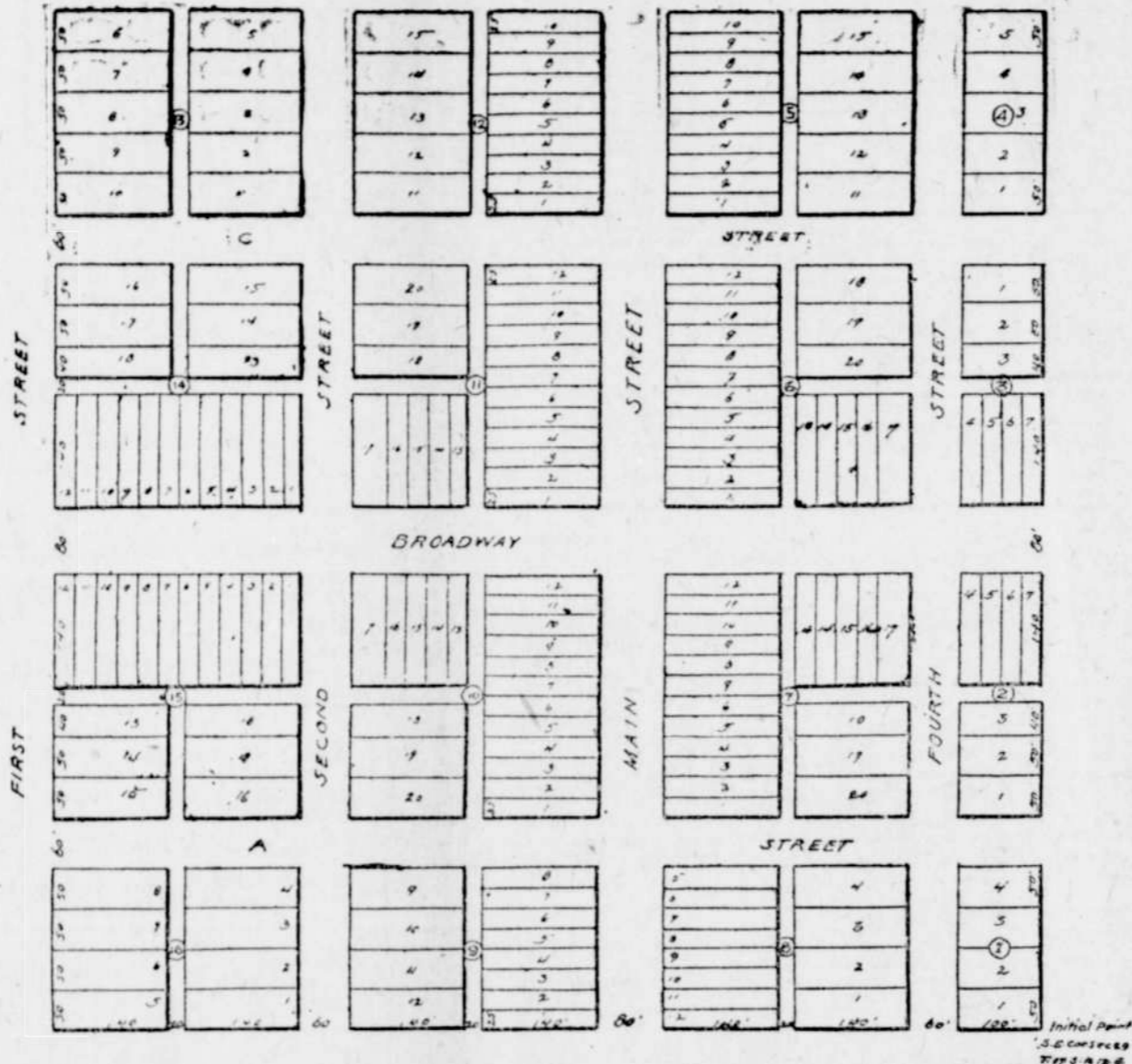

Located at the northernmost fringe of the famous yellow pine timber belt of Oregon the investor needs no further inducements to get in line with the purchasers of this valuable property. Lots are being disposed of rapidly. Particulars may be had by calling upon or writing to the **Lytle Townsite Company,** Deschutes, Oregon.

Timber Land, Act June 3, 1878. NOTICE FOR PUBLICATION.

U. S. Land Office, Lakeview, Oregon, September 29, 1903.
Notice is hereby given that in compliance with the provisions of the act of Congress of June 3, 1878, entitled "An act for the sale of timber lands in the States of California, Oregon, Nevada and Washington Territory," as extended to all the public Land States by act of August 4, 1892, the following named persons have filed in this office their sworn statements, to-wit:

Hattie A. Cameron, of Bemidji, county of Beltrami, state of Minn. Sworn statement No. 2039, for the purchase of the W₁ NW₁ and W₂ SW₁ Sec. 24 Tp. 21 S., R. 14 E.
Erick Erickson, of McIntosh, county of Columbia, state of Minn. Sworn statement No. 2040, for the purchase of the SW₁ SE₁, SW₁ SW₁, Sec. 12 and NE₁ NW₁ Sec. 13, Tp. 22 S., R. 14 E., W. M.
Ola Olson, of Shevlin, county of Beltrami, state of Minn. Sworn statement No. 2041, for the purchase of the SW₁ SE₁, Sec. 11, NE₁ NE₁, Sec. 14, and NW₁ SW₁ Sec. 15, Tp. 22 S., R. 14 E., W. M.
John A. Widness, of Bemidji, county of Beltrami, state of Minn. Sworn statement No. 2042, for the purchase of the N₁ SW₁, SW₁ SW₁, Sec. 13, NE₁ SE₁, Sec. 14, Tp. 22 S., R. 14 E., W. M.
John A. Widness, of Shevlin, county of Beltrami, state of Minn. Sworn statement No. 2043, for the purchase of the SE₁ SW₁, Sec. 13, NE₁ SW₁, and W₂ NE₁, Sec. 14, Tp. 22 S., R. 14 E., W. M.
Arne Solberg, of Bemidji, county of Beltrami, state of Minn. Sworn statement No. 2044, for the purchase of the SW₁ NW₁, Sec. 25 S., R. 14 E., W. M.
Alexander D. Cameron, of Bemidji, county of Beltrami, state of Minn. Sworn statement No. 2045, for the purchase of the SW₁ NW₁, Sec. 25 S., R. 14 E., W. M.
Anders P. Blom, of Spaulding, county of Beltrami, state of Minn. Sworn statement No. 2046, for the purchase of the S. W. 1/4 Sec. 7, Tp. 22 S., R. 14 E., W. M.

That they will offer proof to show that the land sought is more valuable for its timber or stone than for agricultural purposes, and to establish their claims to said land before G. B. Wardwell, U. S. Commissioner at Silver Lake, Oregon, on Saturday the 2nd day of January 1904.
They name as witnesses: John A. Widness, of Shevlin, Minn.; E. Nelson, of Deschutes, Oregon; Hattie A. Cameron, Anton Erickson, Arne Solberg, Alexander D. Cameron, of Bemidji, Minn.; Ola Olson, of Shevlin, Minn.; Erick Erickson, of McIntosh, Minn.; Anders P. Blom, of Spaulding, Minn.
Any and all persons claiming adversely the above-described lands are requested to file their claims in this office on or before the said 2nd day of January 1904.
E. M. BRATTAIN, Register.

WE
make a plat of any Township in the Dallas land District, (not in the Reerve) corrected up-to-date for 50 cents cash or Postage Stamps.
HUDSON & BROWNHILL
REAL ESTATE AND INVESTMENT CO.
THE DALLES OREGON

Timber Land, Act June 3, 1878. NOTICE FOR PUBLICATION.

U. S. Land Office, Lakeview, Oregon, October 17, 1903.
Notice is hereby given that in compliance with the provisions of the act of Congress of June 3, 1878, entitled "An act for the sale of timber lands in the States of California, Oregon, Nevada, and Washington Territory," as extended to all the public Land States by act of August 4, 1892, the following named persons have filed in this office their sworn statements, to-wit:

Isaac R Young, of Rosland, county of Klamath, state of Oregon; sworn statement No. 2381, for the purchase of the NW₁ NE₁, N₁ NE₁ and SW₁ NW₁ sec 8, tp 22 s, r 9 e, w m.
Kishiah Young, of Rosland, county of Klamath, state of Oregon; sworn statement No. 2382, for the purchase of the S₁ NE₁ and W₂ SE₁ sec 7, tp 22 s, r 9 e, w m.
John Young, of Rosland, county of Klamath, state of Oregon; sworn statement No. 2383, for the purchase of the N₁ NE₁ and SW₁ NE₁ sec 11 and NW qr NW qr sec 12, tp 22 s, r 9 e, w m.
Laura F Abel, of Rosland, county of Klamath, state of Oregon; sworn statement No. 2384, for the purchase of the W₁ SW qr sec 11 and W₁ NW qr sec 14, tp 23 s, r 9 e, w m.
That they will offer proof to show that the land sought is more valuable for its timber or stone than for agricultural purposes, and to establish their claims to said land before G. B. Wardwell, U. S. Commissioner at Silver Lake, Oregon, on Tuesday, the 18th day of January, 1904.
They name as witnesses: Roy Johnson, Hugh Johnson, John Young, Kishiah Young, Isaac Young, Laura F Abel, of Rosland, Oregon.
Any and all persons claiming adversely the above-described lands are requested to file their claims in this office on or before the said 18th day of January, 1904.
E. M. BRATTAIN, Register.

Fry's Family Medicines
Are manufactured by Daniel J. Fry at Salem, Oregon. He is a graduate of the Philadelphia College of Pharmacy and has had twenty-seven years' experience in the compounding and dispensing of drugs and medicines. If you are out of sorts, give us a trial; if we fail to give relief, we refund your money. Correspondence solicited and confidentially answered. Fry's Family Medicines are for sale by W. H. Staats, Deschutes and Smith & Wilt, Sisters.

Timber Land, Act June 2, 1878. NOTICE FOR PUBLICATION.

U. S. Land Office, Lakeview, Oregon, September 29, 1903.
Notice is hereby given that in compliance with the provisions of the act of Congress of June 2, 1878, entitled "An act for the sale of timber lands in the States of California, Oregon, Nevada and Washington Territory," as extended to all the public Land States by act of August 4, 1892,
William G. Close, of Hibbing, county of St. Louis, state of Minnesota, has filed in this office his sworn statement No. 1988, for the purchase of the S. E. qr of Section No. 15 in Township No. 24 S., Range No. 13 E., W. M., and will offer proof to show that the land sought is more valuable for its timber or stone than for agricultural purposes, and to establish his claim to said land before G. B. Wardwell, U. S. Commissioner at Silver Lake, Oregon, on Saturday, the 26th day of December, 1903.
He names as witnesses: John Ryan, of Prineville, Oregon; John McCormack, of Hibbing, Minn.; Frank Bogue, David Willehelm, of Lava, Oregon.
Any and all persons claiming adversely the above-described lands are requested to file their claims in this office on or before said 26th day of December, 1903.
E. M. BRATTAIN, Register.

Timber Land, Act June 3, 1878. NOTICE FOR PUBLICATION.

United States Land Office, Lakeview, Oregon, October 14, 1903.
Notice is hereby given that in compliance with the provisions of the act of Congress of June 3, 1878, entitled "An act for the sale of timber lands in the States of California, Oregon, Nevada and Washington Territory," as extended to all the public Land States by act of August 4, 1892, the following named persons have filed in this office their sworn statements, to-wit:

Frank J. West, of St. Paul, county of Ramsey, state of Minnesota; sworn statement No. 1989, for the purchase of the NW₁ SW₁, Sec. 14, N₁ SE₁, and NE₁ SW₁, Sec. 15, Tp. 21 S., R. 14 E., W. M.
Lucy West, of St. Paul, county of Ramsey, state of Minnesota; sworn statement No. 1991, for the purchase of the NW₁ SW₁, Sec. 23, NE₁ SE₁, and SW₁ SE₁, Sec. 23, Tp. 21 S., R. 14 E., W. M.
Alberta R. Buck, of Tacoma, county of Pierce, state of Washington; sworn statement No. 1992, for the purchase of the SE₁ NW₁, E₁ SW₁, and SW₁ SW₁, Sec. 23, Tp. 21 S., R. 14 E., W. M.
George L. Buck, of Tacoma, county of Pierce, state of Washington; sworn statement No. 1993, for the purchase of the W₁ E₁ sec. 23, Tp. 21 S., R. 14 E., W. M.
Jasper A. Martin, of San Jose, county of Santa Clara, state of California; sworn statement No. 1979, for the purchase of the S. W. 1/4 sec. 11, Tp. 21 S., R. 14 E., W. M.
That they will offer proof to show that the land sought is more valuable for its timber or stone than for agricultural purposes, and to establish their claims to said land before G. B. Wardwell, U. S. Commissioner at Silver Lake, Oregon, on Tuesday the 29th day of December, 1903.
They name as witnesses: Frank J. West, Lucy West, of St. Paul, Minnesota; Alberta R. Buck, George L. Buck, of Tacoma, Washington; Jasper A. Martin, of San Jose, California.
Any and all persons claiming adversely the above-described lands are requested to file their claims in this office on or before the said 29th day of December 1903.
E. M. BRATTAIN, Register.

Stonewall America's Leading WHISKEY
FAMOUS HOP GOLD BEER.
Domestic and Imported Wines and Cigars
O'NEIL BROS., PRINEVILLE, OR.

Timber Land, Act June 3, 1878. NOTICE FOR PUBLICATION.

U. S. Land Office, Lakeview, Oregon, September 26, 1903.
Notice is hereby given that in compliance with the provisions of the act of Congress of June 3, 1878, entitled "An act for the sale of timber lands in the States of California, Oregon, Nevada and Washington Territory," as extended to all the public Land States by act of August 4, 1892, the following named person has filed in this office his sworn statement, to-wit:

John H. Overturf, of Portland, county of Multnomah, state of Oregon; sworn statement No. 1945, for the purchase of the S. E. qr Sec. 9, Tp. 21 S., R. 14 E., W. M.
That he will offer proof to show that the land sought is more valuable for its timber or stone than for agricultural purposes, and to establish his claim to said land before G. B. Wardwell, U. S. Commissioner at Silver Lake, Oregon, on Tuesday the 29th day of December 1903.
He names as witnesses: J. H. Overturf, Lawrence Foadick, of Portland, Oregon; John L. Schuylerman, of Lyden, Washington; Samuel C. Hawthorne, of Arcadia, Nebraska; Isaac Williams, of Silver Lake, Or.
Any and all persons claiming adversely the above-described lands are requested to file their claims in this office on or before the said 29th day of December 1903.
E. M. BRATTAIN, Register.

Timber Land, Act June 3, 1878. NOTICE FOR PUBLICATION.

United States Land Office, Lakeview, Oregon, October 17, 1903.
Notice is hereby given that in compliance with the provisions of the act of Congress of June 3, 1878, entitled "An act for the sale of timber lands in the States of California, Oregon, Nevada and Washington Territory," as extended to all the public Land States by act of August 4, 1892, the following named persons have filed in this office their sworn statements, to-wit:

Marion E. Carson, of Bemidji, county of Beltrami, state of Minnesota; sworn statement No. 2536, for the purchase of the W₁ SE qr, SW qr NE qr, SW qr NW qr sec 11, tp 21 s, r 14 e, w m.
Ole J. Melligan, of Bemidji, county of Beltrami, state of Minnesota; sworn statement No. 2531, for the purchase of lots 2, 11 & 12, sec 31, lot 3 a 31 tp 22 s, r 15 e, w m.
That they will offer proof to show that the land sought is more valuable for its timber or stone than for agricultural purposes, and to establish their claims to said land before G. B. Wardwell, U. S. Commissioner at Silver Lake, Oregon, on Thursday, the 28th day of January, 1904.
They name as witnesses: Louis Nelson, John J. Doakken, Ole Erickson, of Deschutes, Oregon; Marion E. Carson, Ole J. Melligan, of Bemidji, Minnesota.
Any and all persons claiming adversely the above-described lands are requested to file their claims in this office on or before the said 28th day of January, 1904.
E. M. BRATTAIN, Register.

Stonewall America's Leading WHISKEY
FAMOUS HOP GOLD BEER.
Domestic and Imported Wines and Cigars
O'NEIL BROS., PRINEVILLE, OR.

Timber Land, Act June 3, 1878. NOTICE FOR PUBLICATION.

U. S. Land Office, Lakeview, Oregon, October 17, 1903.
Notice is hereby given that in compliance with the provisions of the act of Congress of June 3, 1878, entitled "An act for the sale of timber lands in the States of California, Oregon, Nevada, and Washington Territory," as extended to all the public Land States by act of August 4, 1892, the following named persons have filed in this office their sworn statements, to-wit:

Hasten H Crone, of Bemidji, county of Beltrami, state of Minnesota; sworn statement No. 2329, for the purchase of the E₁ NE qr sec 3 and S₁ NW qr sec 4, tp 22 s, r 9 e, w m.
Iver O Myhre, of Spaulding, county of Beltrami, state of Minnesota; sworn statement No. 2330, for the purchase of the S₁ SE qr sec 34, tp 22 s, r 9 e, w m.
Daniel H Ward, of VanPetten, county of Lee, state of Illinois; sworn statement 2331, for the purchase of the N₁ SE qr sec 34 and N₁ SE qr sec 35, tp 22 s, r 9 e, w m.
Elmer Johnson, of Bemidji, county of Beltrami, state of Minnesota; sworn statement No. 2332, for the purchase of the S₁ NE qr sec 34 and S₁ NW qr sec 35, tp 22 s, r 9 e, w m.
Aimee E Crone, of Bemidji, county of Beltrami, state of Minnesota; sworn statement No. 2575, for the purchase of the NE qr NW qr and W₁ NE qr sec 3, tp 22 s, r 9 e, w m.
That they will offer proof to show that the land sought is more valuable for its timber or stone than for agricultural purposes, and to establish their claims to said land before Jas H Driscoll, county clerk, at Klamath Falls, Oregon, on Friday, the 15th day of January, 1904.
They name as witnesses: Hasten H Crone, Aimee E Crone, Elmer Johnson, Clara J Steidl, of Bemidji, Minn.; Iver O Myhre, of Spaulding, Minn.; Daniel H Ward, of Van Petten, Minn.
Any and all persons claiming adversely the above described lands are requested to file their claims in this office on or before the said 15th day of January, 1904.
E. M. BRATTAIN, Register.

You get the best service by sending to Hudson & Brownhill for your corrected plats as you get the latest corrections of any township. This is impossible where you go to parties having duplicate government plats, as it would require a correction of all their plats from the land office every day. Besides the above firm charges you only fifty cents and guarantees to send it by return mail.