

LYTLE, the COMING TERMINUS

of the Columbia Southern Railway.

On the Renowned Deschutes River

LOTS ARE NOW ON THE MARKET.

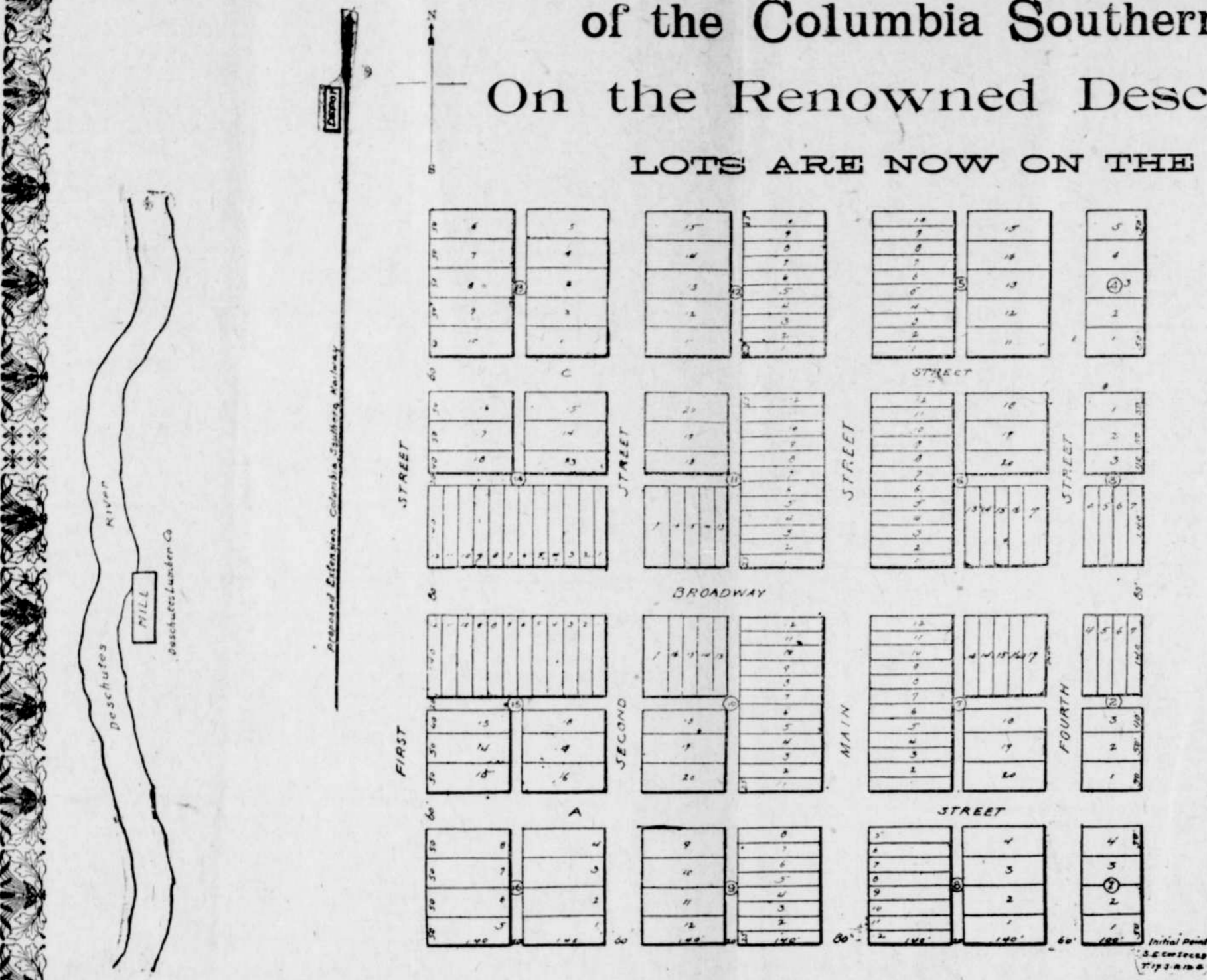

Located at the northernmost fringe of the famous yellow pine timber belt of Oregon the investor needs no further inducements to get in line with the purchasers of this valuable property. Lots are being disposed of rapidly. Particulars may be had by calling upon or writing to the

Lytle Townsite Company,
Deschutes, Oregon.

Timber Land, Act June 3, 1878. NOTICE FOR PUBLICATION.

U. S. Land Office, Lakeview, Oregon. September 29, 1903.
Notice is hereby given that in compliance with the provisions of the act of Congress of June 3, 1878, entitled "An act for the sale of timber lands in the States of California, Oregon, Nevada and Washington Territory," as extended to all the public Land States by act of August 4, 1892, the following named persons have filed in this office their sworn statements, to-wit:

Hattie A. Cameron, of Bemidji, county of Beltrami, state of Minn. sworn statement No. 2309, for the purchase of the NW $\frac{1}{4}$ NW $\frac{1}{4}$ and W $\frac{1}{2}$ SW $\frac{1}{4}$ Sec. 24 Tp. 21 S., R. 14 E.
Erick Erickson, of McIntosh, county of Columbia, state of Minn. sworn statement No. 2340, for the purchase of the SW $\frac{1}{4}$ SE $\frac{1}{4}$, SW $\frac{1}{4}$ SW $\frac{1}{4}$ Sec. 12 and NE $\frac{1}{4}$ SW $\frac{1}{4}$ Sec. 13, Tp. 22 S., R. 14 E., W. M.
Olla Olson, of Shevlin, county of Beltrami, state of Minn. sworn statement No. 2341, for the purchase of the SW $\frac{1}{4}$ SE $\frac{1}{4}$, SW $\frac{1}{4}$ SW $\frac{1}{4}$ Sec. 14 and NW $\frac{1}{4}$ NW $\frac{1}{4}$ Sec. 15, Tp. 22 S., R. 14 E., W. M.
Anton Erickson, of Bemidji, county of Beltrami, state of Minn. sworn statement No. 2342, for the purchase of the NW $\frac{1}{4}$ SW $\frac{1}{4}$, SW $\frac{1}{4}$ SW $\frac{1}{4}$ Sec. 13, NE $\frac{1}{4}$ SE $\frac{1}{4}$ Sec. 14, Tp. 22 S., R. 14 E., W. M.
John A. Widness, of Shevlin, county of Beltrami, state of Minn. sworn statement No. 2343, for the purchase of the SE $\frac{1}{4}$ SW $\frac{1}{4}$, Sec. 13, NE $\frac{1}{4}$ NW $\frac{1}{4}$ and W $\frac{1}{2}$ NE $\frac{1}{4}$ Sec. 24, Tp. 22 S., R. 14 E., W. M.
Arne Solberg, of Bemidji, county of Beltrami, state of Minn. sworn statement No. 2344, for the purchase of the NW $\frac{1}{4}$ NW $\frac{1}{4}$, NW $\frac{1}{4}$ SW $\frac{1}{4}$ Sec. 24 and N. E. $\frac{1}{4}$ S. E. $\frac{1}{4}$ Sec. 25, Tp. 22 S., R. 14 E., W. M.

That they will offer proof to show that the land sought is more valuable for its timber or stone than for agricultural purposes, and to establish their claims to said land before G. B. Wardwell, U. S. Commissioner at Silver Lake, Oregon, on Saturday the 2nd day of January 1904.

They name as witnesses: John A. Widness, of Shevlin, Minn.; E. Nelson, of Deschutes, Oregon; Hattie A. Cameron, Anton Erickson, Arne Solberg, Alexander D. Cameron, of Bemidji, Minn.; Olla Olson, of Shevlin, Minn.; Erick Erickson, of McIntosh, Minn.; Anders P. Blom, of Spaulding, Minn.

Any and all persons claiming adversely the above-described lands are requested to file their claims in this office on or before the said 2nd day of January 1904.

E. M. BRATTAIN, Register.

Timber Land, Act June 3, 1878. NOTICE FOR PUBLICATION.

U. S. Land Office, Lakeview, Oregon, October 17, 1903.
Notice is hereby given that in compliance with the provisions of the act of Congress of June 3, 1878, entitled "An act for the sale of timber lands in the States of California, Oregon, Nevada, and Washington Territory," as extended to all the public Land States by act of August 4, 1892, the following named persons have filed in this office their sworn statements, to-wit:

Isaac R. Young, of Rosland, county of Klamath, state of Oregon; sworn statement No. 2381, for the purchase of the NW $\frac{1}{4}$ NE $\frac{1}{4}$, NW $\frac{1}{4}$ NW $\frac{1}{4}$ and SW $\frac{1}{4}$ NW $\frac{1}{4}$ sec 8, tp 22 s., r 9 e., w. m.
Kisiah Young, of Rosland, county of Klamath, state of Oregon; sworn statement No. 2382, for the purchase of the SW $\frac{1}{4}$ NE $\frac{1}{4}$ and W $\frac{1}{2}$ SE $\frac{1}{4}$ sec 7, tp 22 s., r 9 e., w. m.
John Young, of Rosland, county of Klamath, state of Oregon; sworn statement No. 2383, for the purchase of the NW $\frac{1}{4}$ NE $\frac{1}{4}$ and SW $\frac{1}{4}$ NE $\frac{1}{4}$ sec 11 and NW qr NW qr sec 12, tp 22 s., r 9 e., w. m.

Laura F. Abel, of Rosland, county of Klamath, state of Oregon; sworn statement No. 2384, for the purchase of the W $\frac{1}{2}$ SW qr sec 11 and W $\frac{1}{2}$ NW qr sec 14, tp 22 s., r 9 e., w. m.

That they will offer proof to show that the land sought is more valuable for its timber or stone than for agricultural purposes, and to establish their claims to said land before G. B. Wardwell, U. S. Commissioner at Silver Lake, Oregon, on Tuesday, the 18th day of January, 1904.

They name as witnesses: Roy Johnson, Hugh Johnson, John Young, Kisiah Young, Isaac Young, Laura F. Abel, of Rosland, Oregon.

Any and all persons claiming adversely the above-described lands are requested to file their claims in this office on or before the said 18th day of January, 1904.

E. M. BRATTAIN, Register.

Fry's Family Medicines
Are manufactured by Daniel J. Fry at Salem, Oregon. He is a graduate of the Philadelphia College of Pharmacy and has had twenty-seven years' experience in the compounding and dispensing of drugs and medicines. If you are out of sorts, give us a trial; if we fail to give relief, we refund your money. Correspondence solicited and confidentially answered. Fry's Family Medicines are for sale by W. H. Staats, Deschutes and Smith & Wilt, Sisters.

Timber Land, Act June 3, 1878. NOTICE FOR PUBLICATION.

U. S. Land Office, Lakeview, Oregon, September 29, 1903.
Notice is hereby given that in compliance with the provisions of the act of Congress of June 3, 1878, entitled "An act for the sale of timber lands in the States of California, Oregon, Nevada and Washington Territory," as extended to all the public Land States by act of August 4, 1892, the following named person has filed in this office his sworn statement, to-wit:

William G. Close, of Hibbing, county of St. Louis, state of Minnesota, has filed in this office his sworn statement No. 1988, for the purchase of the s. e. qr of Section No. 15 in Township No. 24 S., Range No. 13 E., W. M., and will offer proof to show that the land sought is more valuable for its timber or stone than for agricultural purposes, and to establish his claim to said land before G. B. Wardwell, U. S. Commissioner at Silver Lake, Oregon, on Saturday, the 26th day of December, 1903.

He names as witnesses: John Ryan, of Prineville, Oregon; John McCormack, of Hibbing, Minn.; Frank Bogue, David Willeheim, of Lava, Oregon.
Any and all persons claiming adversely the above-described lands are requested to file their claims in this office on or before the said 26th day of December, 1903.

E. M. BRATTAIN, Register.

Timber Land, Act June 3, 1878. NOTICE FOR PUBLICATION.

United States Land Office, Lakeview Oregon, October 14, 1903.
Notice is hereby given that in compliance with the provisions of the act of Congress of June 3, 1878, entitled "An act for the sale of timber lands in the States of California, Oregon, Nevada and Washington Territory," as extended to all the public Land States by act of August 4, 1892, the following named persons have filed in this office their sworn statements, to-wit:

Frank J. West, of St. Paul, county of Ramsey, state of Minnesota, sworn statement No. 1580, for the purchase of the NW $\frac{1}{4}$ SW $\frac{1}{4}$, sec. 14, NE $\frac{1}{4}$ SE $\frac{1}{4}$, and NE $\frac{1}{4}$ SW $\frac{1}{4}$, Sec. 15, Tp. 21 S., R. 14 E., W. M.
Luey West, of St. Paul, county of Ramsey, state of Minnesota, sworn statement No. 1581, for the purchase of the NW $\frac{1}{4}$ SW $\frac{1}{4}$, Sec. 22, NE $\frac{1}{4}$ SE $\frac{1}{4}$ and SE $\frac{1}{4}$ SE $\frac{1}{4}$ Sec. 23, Tp. 21 S., R. 14 E., W. M.
Alberta R. Buck, of Tacoma, county of Pierce, state of Washington, sworn statement No. 1582, for the purchase of the SW $\frac{1}{4}$ NW $\frac{1}{4}$, SW $\frac{1}{4}$ SW $\frac{1}{4}$ and SW $\frac{1}{4}$ SW $\frac{1}{4}$ Sec. 23, Tp. 21 S., R. 14 E., W. M.
George L. Buck, of Tacoma, county of Pierce, state of Washington, sworn statement No. 1583, for the purchase of the W $\frac{1}{2}$ of E $\frac{1}{2}$ sec. 23, Tp. 21 S., R. 14 E., W. M.

That they will offer proof to show that the land sought is more valuable for its timber or stone than for agricultural purposes, and to establish their claims to said land before G. B. Wardwell, U. S. Commissioner at Silver Lake, Oregon, on Tuesday, the 25th day of December, 1903.

They name as witnesses: Frank J. West, Luey West, of St. Paul, Minnesota; Alberta R. Buck, George L. Buck, of Tacoma, Washington; Jasper A. Martin, of San Jose, California.
Any and all persons claiming adversely the above-described lands are requested to file their claims in this office on or before the said 25th day of December 1903.

E. M. BRATTAIN, Register.

Timber Land, Act June 3, 1878. NOTICE FOR PUBLICATION.

U. S. Land Office, Lakeview, Oregon, September 26, 1903.
Notice is hereby given that in compliance with the provisions of the act of Congress of June 3, 1878, entitled "An act for the sale of timber lands in the States of California, Oregon, Nevada and Washington Territory," as extended to all the public Land States by act of August 4, 1892, the following named person has filed in this office his sworn statement, to-wit:

John H. Overturf, of Portland, county of Multnomah, state of Oregon, sworn statement No. 1945, for the purchase of the s. e. qr sec. 9, Tp. 21 S., R. 14 E., W. M.
That he will offer proof to show that the land sought is more valuable for its timber or stone than for agricultural purposes, and to establish his claim to said land before G. B. Wardwell, U. S. Commissioner at Silver Lake, Oregon, on Tuesday the 29th day of December 1903.

He names as witnesses: J. H. Overturf, Lawrence Fosdick, of Portland, Oregon; John L. Schuylerman, O. Lyden, Washington; Samuel C. Hawthorne, of Arcadia, Nebraska; Isaac Williams, of Silver Lake, Or.
Any and all persons claiming adversely the above-described lands are requested to file their claims in this office on or before the said 29th day of December 1903.

E. M. BRATTAIN, Register.

Timber Land, Act June 3, 1878. NOTICE FOR PUBLICATION.

United States Land Office, Lakeview, Oregon, October 17, 1903.
Notice is hereby given that in compliance with the provisions of the act of Congress of June 3, 1878, entitled "An act for the sale of timber lands in the States of California, Oregon, Nevada and Washington Territory," as extended to all the public Land States by act of August 4, 1892, the following named persons have filed in this office their sworn statements, to-wit:

Marion E. Carson, of Bemidji, county of Beltrami, state of Minnesota; sworn statement No. 2530, for the purchase of the W $\frac{1}{2}$ h $\frac{1}{2}$ qr, SW qr, NW qr, SE qr, NW qr sec 11, tp 21 s., r 14 e., w. m.
Ole J. Melligan, of Bemidji, county of Beltrami, state of Minnesota; sworn statement No. 2531, for the purchase of lots 2, 11 & 12, sec 31, lot 3 a 31 tp 22 s., r 15 e., w. m.

That they will offer proof to show that the land sought is more valuable for its timber or stone than for agricultural purposes, and to establish their claims to said land before G. B. Wardwell, U. S. Commissioner at Silver Lake, Oregon, on Thursday, the 28th day of January, 1904.

They name as witnesses: Louis Nelson, John J. Deiken, Ole Erickson, of Deschutes, Oregon; Marion E. Carson, Ole J. Melligan, of Bemidji, Minnesota.
Any and all persons claiming adversely the above-described lands are requested to file their claims in this office on or before the said 28th day of January, 1904.

E. M. BRATTAIN, Register.

Timber Land, Act June 3, 1878. NOTICE FOR PUBLICATION.

U. S. Land Office, Lakeview, Oregon, October 17, 1903.
Notice is hereby given that in compliance with the provisions of the act of Congress of June 3, 1878, entitled "An act for the sale of timber lands in the States of California, Oregon, Nevada, and Washington Territory," as extended to all the public Land States by act of August 4, 1892, the following named persons have filed in this office their sworn statements, to-wit:

Hasten H. Crone, of Bemidji, county of Beltrami, state of Minnesota; sworn statement No. 2329, for the purchase of the e h $\frac{1}{2}$ ne qr sec 3 and s h $\frac{1}{2}$ nw qr sec 4, tp 22 s., r 9 e., w. m.
Iver O. Myhre, of Spalding, county of Beltrami, state of Minnesota; sworn statement No. 2330, for the purchase of the s h $\frac{1}{2}$ s h $\frac{1}{2}$ sec 34, tp 22 s., r 9 e., w. m.
Daniel H. Ward, of VanPetten, county of Lee, state of Illinois; sworn statement 2331, for the purchase of the n h $\frac{1}{2}$ se qr sec 34 and n h $\frac{1}{2}$ sw qr sec 35, tp 22 s., r 9 e., w. m.

Elmer Johnson, of Bemidji, county of Beltrami, state of Minnesota; sworn statement No. 2332, for the purchase of the s h $\frac{1}{2}$ ne qr sec 34 and s h $\frac{1}{2}$ nw qr sec 35, tp 22 s., r 9 e., w. m.
Aimee E. Crone, of Bemidji, county of Beltrami, state of Minnesota; sworn statement No. 2575, for the purchase of the ne qr NW qr and W $\frac{1}{2}$ h $\frac{1}{2}$ ne qr sec 3, tp 22 s., r 9 e., w. m.

That they will offer proof to show that the land sought is more valuable for its timber or stone than for agricultural purposes, and to establish their claims to said land before Jas. H. Driscoll, county clerk, at Klamath Falls, Oregon, on Friday, the 15th day of January, 1904.

They name as witnesses: Hasten H. Crone, Aimee E. Crone, Elmer Johnson, Clara J. Steidl, of Bemidji, Minn.; Iver O. Myhre, of Spalding, Minn.; Daniel H. Ward, of Van Petten, Minn.

Any and all persons claiming adversely the above described lands are requested to file their claims in this office on or before the said 15th day of January, 1904.

E. M. BRATTAIN, Register.

WE

make a plat on any Township in The Dalles and District, (not in the Reerve) corrected up-to-date for 50 cents cash or Postage Stamps.

HUDSON & BROWNHILL
REAL ESTATE AND INVESTMENT CO.
THE DALLES OREGON

Stonewall
America's Leading WHISKEY

FAMOUS HOP GOLD BEER.

Domestic and Imported Wines and Cigars

O'NEIL BROS., PRINEVILLE, OR.