

INSECT PESTS ARE CONTROLLED WHEN SPRAY IS APPLIED

By A. O. ALBEN (Oregon Agricultural College Student) A clean up spray of lime sulphur...

MODEL FARM SAVES FULLY A MILE A DAY

Improper Arrangement of Buildings Is Cause of Waste of Time and Energy, Nebraska College Authorities Declare



(By NEA Service) LINCOLN, Neb., Feb. 21.—It has been estimated by the Nebraska college of agriculture that the average farmer...

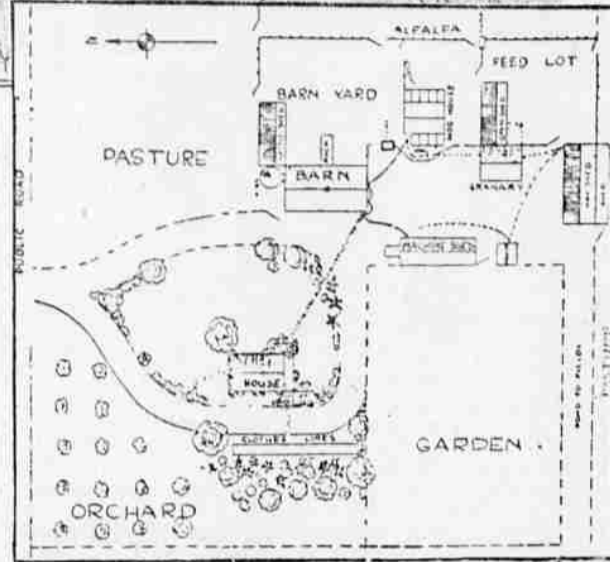

The buildings comprising the model include a comfortable, attractive farmhouse, set on a concrete foundation...

Working on the theory that every farm is a factory, in a sense, the Nebraska college expects, through the medium of its model farmstead...

When the horses and cows are attended to, his evening chores are completed. Location Noted Many other points were given consideration in planning the farmstead...

When starting out on his morning chores he goes from the house to the barn, where he tends the horses and colts...

Prune and peach twig miner, a small pinkish worm, works havoc by tunneling into the terminal growth of both bearing and non-bearing peach, prune, and apricot trees...

Apple Scab Apple scab is the most serious disease of the apple in Oregon. Since it is carried over on the old leaves of the season...

Prune Grape Vines Bearing grape vines must be covered every year, to get a profitable crop. This is done during February and March...

Early Lambs Best Lambs that come before March 15 are considered best. Given the right kind of food and care these early lambs can be put on the market...

CHICKS HIT EARLY BY DISEASE; HEAVY SPREAD FREQUENT

WHITE diarrhea infects the greatest number of baby chicks within the first 48 to 72 hours after hatching. From 2 to 4 per cent of the chicks infected at birth will cause the disease to spread to 40, 50 or even 75 per cent of the entire flock...

The best and only satisfactory way of handling chicks showing symptoms of white diarrhea is to move them from the incubator and kill them. Every "pasty" chick should be killed as soon as it is discovered...

The O. A. C. Experiment station recommends the use of fresh eggs from blood tested stock as the first step in stopping the spread of white diarrhea...

Legume cultures prepared by the bacteriology department of the experiment station are being sent to farmers in Oregon, California, Nevada, North Dakota and neighboring states...

Field peas for hay should be planted from February 15 to April 1. White Canadian, Blue Prussian, or Arthur varieties are drilled three-fourths to 1 1/2 inches deep...

Grass seed production, which has been of minor importance in western Oregon for a number of years, is becoming profitable and prominent in Lane county...

Red clover at the rate of 12 pounds an acre, or alsike clover at the rate of 8 pounds an acre, can be sown in the spring in various ways...

Success in growing pure grass seed depends on the grower's knowledge of grasses and their seeding habits, methods of handling and ability to put high grade seed on the market...

Oregon farmers are advised by the experiment station to sow pasture mixtures early. Good grass mixtures for spring sowing to establish permanent pastures are as follows...

Failure to provide the correct brooder temperature for small chicks often results in bowel trouble. From 95 degrees to 100, at the edge of the hover, is the correct temperature for the first few days...



BOISTEROUS miner, just down from the diggings with a full belt, elected himself bottle holder to Drake. He hauled his man to his feet, preening hard at his bleeding face...



Drake dodged the rush, recovering only in bare time to sidestep; then he turned, swung a right with his weight behind it...

When Drake returned to Mary, she stood up with a cry of dismay. He had been gone about twenty minutes. Now he came back to her smiling, bright eyed, but with a three-inch strip of plaster down one cheek...

"Don't look like that, Mary," he laughed, pressing her into her chair gently. "I'm not hurt. Little accident, that's all. Let's see, we were chatting about how we were to furnish the boarder..."

"Do stop your jesting!" she cried. "We were talking of no such thing! I won't hear a word until you have told me what has happened. Was it—?" Her eyes darkened, and she frowned as the truth, or possible truth, dawned upon her. He broke in, grinning...

"It looks as if he succeeded!" she retorted sharply. "Let us go, now, before somebody else tries. You look horrible!"

A tiny chill fell over Drake, Mary wanted to go back to the ship, and her baffled escort led her to the car in silence.

"It has been a bully evening, anyhow," he said heartily. She said nothing, taking her seat in the electric trolley beside him, as if resigned to something unpleasant. He peeped at her once, then with a loud sigh settled down to a window-gazing rite...

Drake stood up. Over the outer heads he saw the milling center of the crowd, and lists and sticks were flying thick. The car driver changed his gear, and the impending crowd slowly made way for it. But Drake had caught sight of a head he knew, two heads, in the very vortex of the mob...

Stevens crouched and rushed as soon as Drake stood clear. The crowd formed a circle, and the howling ceased as the fighters came together. Drake made an effort to avoid Jake's rush, other than to duck his head under the terrific lead that went over him with a round arm swish...

Drake dodged the rush, recovering only in bare time to sidestep; then he turned, swung a right with his weight behind it...

Drake dodged the rush, recovering only in bare time to sidestep; then he turned, swung a right with his weight behind it...

Drake dodged the rush, recovering only in bare time to sidestep; then he turned, swung a right with his weight behind it...

which drives a man on even after conscious collision fails he stumbled to his feet, regarding his head with one arm, and stabbing fiercely at a blur before him with his short-gripped club...

"Orontes! Orontes!" That cry sounded strange. It was near, yet seemed far off. Drake fought doggedly. There was that stirring under his feet. He knew he was to be tripped again. He could not see the man who still fought beside him...

"Orontes! Orontes!" the cry was close. The blur of faces began to vanish like mist.

"Aye, Orontes! Give 'em hell!" bellowed the crowd. Groggily Drake and Jake Stevens called for another onslaught. Drake snared his breath for fighting. His inner friend tottered and gasped. But through the crowd stormed the team driver and conductor, with controller and switch bar, and with them marched Mary Manning, splendid daughter of old Neptune, snatching force, right and left and turning murderous eyes to the foaming arena...

"What's the trouble?" demanded a policeman running up, looking queerly into the bruised and bleeding faces, and at Mary.

"Gang setting about these two blokes. This gent and we stopped off my car to help the under dog," roared the policeman.

"It's my first mate," explained Drake. "I'm Captain Drake, of the ship Orontes, lying in Table Bay. We're all right, thanks. If we could get an automobile, I'd be glad."

"I'll send one along sir," said the officer, and went off with his men. Drake glanced at Mary. She was all soft womanliness now, examining her eyes big and dark.

"I'm afraid neither Mr. Stevens nor I could be called respectable now," said Drake with a grimace. The friendly miner grinned as Mary finished cleaning a cut on his chin.

"I don't care what you are or what you look like. I think you are both splendid!" she cried. "You, too," she added, Swift as a swallow she seemed to dart forward, and dabbled a kiss right between the miner's eyes as the car drove up. She was blushing furiously as she ran into the auto. The miner stared, grinned, and stood robbed of speech.

"To be continued"

THE BUTTON SHOP Pleating, Buttons and Hemstitching, 50 7th Ave. East. Phone 1715-J.

Hall's Catarrh Medicine will do what we claim for. It rid your system of Catarrh or Deafness caused by Catarrh. Sold by druggists for over 40 years. F. J. CHENEY & CO., Toledo, Ohio

PUBLIC DANCE DREAMLAND HALL Every Wednesday and Saturday Night

Wood and Coal Wood under cover any length King Coal Oak Cord Wood Ash Slabwood Maple MANERUD-HUNTINGTON FUEL CO. 1st National Bank Bldg. Room 201 Phone 651

For Railroad information CALL 44 or 57 SOUTHERN PACIFIC FOURTH AND WILLAMETTE AND 20 HAMPTON BUILDING

Old Time Dance At Veneta Saturday Night Feb. 21. Everybody Welcome

Powder Puff Beauty Shop Upon the impression you constantly make rests the failure or success of your life. Let us help to make you beautiful. Shingle and Curl, 50c Opposite Heilig Phone 1712

Special Prices on Beds A mohair davenport will beautify your home. See our exclusive line. We can please you. Johnson Furniture Co 685 WILLAMETTE

UMATILLAS BUY OWN SEED WHEAT, EXPECT BIG CROP

PENDELTON, Feb. 21.—Umatilla county is anticipating a big crop of wheat in the harvest of 1925 despite the disastrous freeze-up of December, that resulted in winter-killing of wheat on a wholesale basis all over the country...

Despite the condition in other countries that made necessary the passing of a relief fund of \$1,500,000, farmers here have been able to finance their reseedling work through the local banks. Not a single Umatilla county grower has been compelled to seek state aid in purchasing his supply of seed.

County Agent Fred Beaudin estimates that the total damage to the county's fall sown acreage at 75 per cent. His estimate includes a 50 per cent outright loss and a 25 per cent reduction in the yield of the spring grain from fall sown yields. Despite this fact the county agent thinks that Umatilla county will produce more wheat this year than was produced last, when dry weather cut the crop from its approximate 7,000,000 bushel yield to one of about 4,500,000 bushels.

Conditions as to actual freezing were duplicated in counties of Oregon and southeastern Washington in the same general wheat belt and are not as heavy in Umatilla county as those having a lighter annual rainfall.

Standard Bushel Crate Is Easily Made This One is Handiest of Its Kind Yet Made

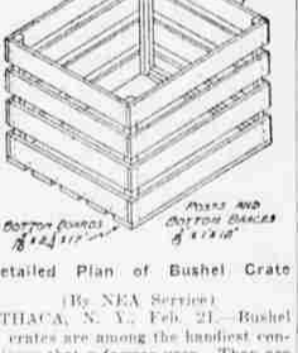

(By NEA Service) ITHACA, N. Y., Feb. 21.—Bushel crates are among the handiest containers that a farmer uses. They are simple enough to be built by anyone. The New York State college of agriculture, here, describes such a crate, and gives a sketch and list of materials to aid anyone in making one for himself.

Here are the needed materials: For the side and bottom, 13 pieces, 5-16 of an inch by 2-1/4 inches by 17 inches. For ends, 8 pieces, 5-16 of an inch by 2-1/4 inches by 14 inches. For posts and bottom braces, 6 pieces, 7/8 of an inch by 1 inch by 12 inches. Nails for boards, 1-1/2 pound 5-penny common. Nails for bottom braces, 4 nails 10-penny box.

Direction for Nailing The nails that are to be driven in straight are the middle ones at the ends of the boards, and the 6-penny box nails that are driven through side boards and posts and into the ends of the bottom braces. All other nails are to be driven slanting so as to give them greater holding power.

GRASS SEED TAKES ON IMPORTANCE AS LANE COUNTY CROP

Grass seed production, which has been of minor importance in western Oregon for a number of years, is becoming profitable and prominent in Lane county, says the experiment station. The acreage of pure grass grown for seed in western Oregon has increased very much in the last few years.

The high quality seed produced in western Oregon marks it as superior to that grown in many other sections. The seed produced here is large, plump, of good color, and high germination and is easily cleaned to high purity.

Unlimited markets for pure grass seed are available locally and in many other sections of the country. A number of large seed houses in the United States have representatives in western Oregon grass growing sections. Investigating and contracting for future deliveries of pure grass seed.

Success in growing pure grass seed depends on the grower's knowledge of grasses and their seeding habits, methods of handling and ability to put high grade seed on the market. It is important that growers market only pure seed for on the quality of the seed produced now depends the development of this industry.

Farm Reminders

Red clover at the rate of 12 pounds an acre, or alsike clover at the rate of 8 pounds an acre, can be sown in the spring in various ways. Broadcasted in fall sown grain in February as soon as germination will occur is a desirable method of planting at this time.

Clover should be seeded on deep, well-drained, sweet or slightly acid soils. A light coating of top soil and plaster on many soils helps to secure a good stand and a good crop.

Sow vetch in February and not later than March 1. Fall plantings are best, but those who want vetch for hay can sow now at the rate of 80 pound per acre of common vetch.

Oregon farmers are advised by the experiment station to sow pasture mixtures early. Good grass mixtures for spring sowing to establish permanent pastures are as follows: 6 pounds of English ryegrass; 3 pounds each of Kentucky blue grass, orchard grass, tall oat grass, and red clover; 2 pounds timothy; and 1 pound of white clover an acre on well drained soils...

Sowing should take place from February 15 to March 15 if the grass is to be well established.

Failure to provide the correct brooder temperature for small chicks often results in bowel trouble. From 95 degrees to 100, at the edge of the hover, is the correct temperature for the first few days. Too much heat is as bad as not enough. Confine the chicks fairly close to the stove the first two days by means of boards, 12 inches wide nailed together at the corners, minimized the danger of chilling.