

TR Hunter Real Estate

1749 Highway. 101, Florence OR 97439

www.trhunter.com

541-997-1200 • 800-210-7453

TR
HUNTER
REAL ESTATE
1749 HIGHWAY 101, FLORENCE
541-997-1200



Price Reduction



86236 Xylo St – One owner custom home with expansive Siuslaw River views. Vaulted great room with pellet stove, built-in bookshelves, and dining area. Kitchen with pantry and eat bar. Beautiful location with RV parking and hookups. **\$525,000.** #2962-19251445



35 Easy St – Come relax at the Coast in this adorable 444 sqft home with paved parking, and room for RVs with hookups. Nice picnic area and sun deck as well. Roof recently replaced. Located in the Coast Village with security gate, pool, laundry, rec facility and more. **\$139,000.** #2612-17129165

Price Reduction



1515 2nd St – Stunning, like new 3 bdrm, 2 bath home located in Old Town. Many high end upgrades including quartz countertops and engineered hardwood flooring. Lovely covered front porch, 2-car garage, and RV parking with full hookups. **\$495,000.** #3000-19166540



85545 Pine St – 10+ acres with Siuslaw River and Old Town views! 4 bdrm, 4 bath luxury home with plenty of room for everyone. Park-like setting with old growth timber and huge shops. Media room, bar and entertainment area, and much more. **\$1,250,000.** #2745-17283691



84594 Branch Rd – Two homes on a large, 2.88 acre country parcel. Included is primary residence, detached 2 car garage, horse barn, and a rental unit. A large shop is included on the adjacent 1 acre. Come see for yourself. **\$325,000.** #2932-19331690



1601-516 Rhododendron Dr – Green-trees West home with a 2-car garage, newer floor, covered deck, and private, low maintenance, mini yard. This home is in great condition and will qualify for an FHA loan. **\$149,000.** #2953-19124700



3959 Hwy 101 – Commercial opportunity with Highway 101 frontage located in the North Florence commercial district. Highway District zoning allows for many different uses. The adjacent 1.22 acre lot to the west has frontage on Oak Street and is also for sale. **\$249,000.** #2703-17034510



10818 Hwy 36 – Large commercial building on two city lots at the junction of Hwy 36 and 126 in Mapleton, a high traffic area. Metal building with high open beam ceiling, 3 phase power on one meter. Check with Lane County for zoning uses. Property is being sold "as is". **\$50,000.** #2802-18047518



4836 Laguna Ave – Lake and forest views from this 4,000 sqft home just minutes from Florence. Boat, fish and kayak from your private dock. Remodeled in 2003. This house has hardwood floors, gourmet kitchen, and large master suite with walk-in closet. Pole barn and large 3 bay RV barn provide plenty of parking. **\$1,399,000.** #2850-18330278

trhunter.com • trhunter.com • trhunter.com



Fairway Estates - Choose your lot in this pristine, new gated community. Whether you desire to live in a brand-new neighborhood, enjoy fairway and lake views or appreciate walks on nature trails, this is the community for you. Located within city limits.

\$72,500-\$129,000. #2965-19453173



Jake Mann Lane #8700 – Ocean and valley views, southern exposure, and gorgeous sunsets, have captivated many homeowners living in Rhodo View Dunes Estates. This lot is ready to build, with all utilities to the lot line and paved road to the building site. **\$75,000.** #1875-10028201



33 Easy St – Two bdrm, two bath home in Coast Village. Open concept living room with vaulted ceilings, 2-car carport plus RV parking with hookups. Coast Village is gated, has a community center, pool, spa, and more. **\$198,000.** #3001-19479839



302 Manzanita Dr – Room to roam inside and out of this lovely Florentine Estates home with end of the road privacy. Expansive kitchen with tons of storage! Master suite has his and hers WI closets, jetted tub, double vanity plus a WI shower. 2-car garage plus a mud room. **\$349,900.** #2944-19377517



2305 Coastal Highlands Dr – In town 1674 sqft, 3 bdrm, 2 bath home with living, family and dining room, and a 2 car garage with extra parking. **\$245,000.** #2902-18108434



Dunewood Dr #75 – Seller Financing on this 2.2 acre lot overlooking pristine wetlands and dunes. **\$85,000.** #1721-9028640



87977 Kelsie Way – Desirable Heceta South location, almost 1 acre lot with septic and water already installed. Partially cleared and ready for home plans. Only a few lots left in Heceta South. **\$81,500.** #2533-18277067



Maple Lane #2 – The privacy of a gated community, the convenience of living in town, and the serenity of living in the woods in your newly-built home. Great value on this in-town lot with all city services. Possible seller terms. **\$14,000.** #2213-13391606



Reserve at Heceta Lake – Beautiful views, seasonal lake and nature preserve areas with lake access for all property owners. Underground utilities plus Heceta water, cable, internet and phone. Septic approvals and permits paid for every lot. Protective CC&R's to safeguard your investment. Priced from **\$78,000 to \$157,500.** #1310-6054648



9th Street #4000 – This high visibility lot is a great investment to build your commercial complex, with the street cut-in already in place. Located in the center of town, bordering an undeveloped section of Hemlock Street. All city services available. **\$43,900.** #2846-18439319

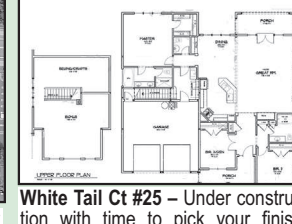

White Tail Ct #25 – Under construction with time to pick your finishing touches. Main floor living with 3 bdrms, 2.5 baths plus bonus room. Vaulted great room with French doors and a fireplace. Large master suite with walk-in closet, soaking tub, walk-in shower and double vanity. **\$495,000.** #2916-18640910



1340 Kingwood St – Mid-century modern, beautifully remodeled including mother-in law quarters. Main home is 2-story with 2 bdrms, a den, and 2.5 baths. Sunny yard with lovely landscaping and raised garden beds. Lower home has 1 bdrm, 1 bath plus a loft. **\$389,000.** #2997-19601804



Upper Deadwood Creek Rd #300 – Beautiful 15.45 acres tucked away in Deadwood. Enjoy a year round creek in this mountain setting. Zoned F2 Impacted Forest, and bordered by 693 Dept of Agriculture acres. Check with Lane County about building possibilities. **\$95,000.** #2636-18456906



37th Street #1300 – Great in-town .15 acre lot. Zoned for multi-family dwelling. Build your duplex here! **\$65,000.** #1978-10080860



Limpit Lane #228 – Excellent building site in this quiet neighborhood with paved streets, electrical, water hook-ups at the lot line, and septic approved. Wooded lot priced at **\$54,500.** #1541-14427123

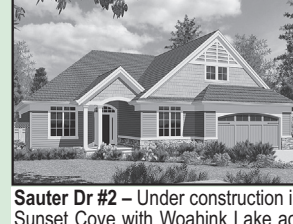

Sauter Dr #2 – Under construction in Sunset Cove with Woahink Lake access. 2467 sqft, 3 bdrm, 2 bath on almost half an acre. High, vaulted ceiling and fireplace in the great room. Master suite has a walk-in closet, shower, soaking tub and double vanity. 2 car garage with shop space. **\$495,000.** #2915-18520167



85337 Hwy 101 – Commercial opportunity on Highway 101 just south of Florence. Great highway frontage and visibility. This property is now cleared and ready for your imagination. **\$68,000.** #2646-16071172



Lake Point Dr #26 – Beautiful lake-front lot with cleared building site, underground utilities, Heceta water, and septic permit. **\$78,000.** #1311-6054700



Chets Trail #2100 – Rare 5 acre secluded parcel in the woods. Septic approved, well in place, power to the lot. Fantastic lake frontage with two potential building sites and Woahink Creek running through the lot. Bring your home plans! **\$175,000.** #2371-14010831



South Cove Drive #22 – Elevated lot in the gated community of South Shore with potential lake views. Clear the lot, build your dream home, and receive shared access to Woahink Lake. South Shore HOA dues of \$450 per year. **\$130,000.** #2368-14570133



Kelsie Way #57 – Large, wooded view lot near the beach, with private access in an upscale neighborhood, and utilities to the lot line. **\$79,500.** #1990-15139930



4837 Summit Ave – Lake view cottage in Westlake. Beautiful 2 bdrm, 1 bath home with Siltcoos Lake views. Features include metal roof, fireplace, cozy kitchen, carport, and a large shop/garage on its own electrical meter. Westlake boat ramp nearby. **\$340,000.** #2925-19166116



89310 Leverage Dr – Enjoy this 3 bdrm, 2 bath home with vaulted ceilings, separate living and family rooms, and sunroom to the large backyard. Kitchen with cook island, double oven and pantry. Master bath has custom shower and heated floors. **\$359,000.** #2901-18621943



Ocean View Drive #8100 – 1.25 acre hillside building site in upscale Rhodo View Dunes Estates. Homesite offers views of North Fork Siuslaw slough. Potential to divide and develop lots, utilities available. **\$35,000.** #1879-10004463

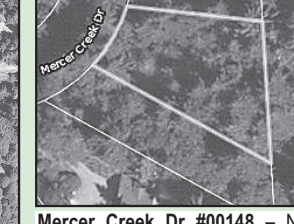

Mercer Creek Dr #00148 – Nice, wooded .32 acre lot near Sutton Lake in an area of fine homes. This wonderful North Lakes area lot is waiting to be developed and built on. Property has mature trees and native vegetation. Water and power available. **\$67,500.** #2597-16420336

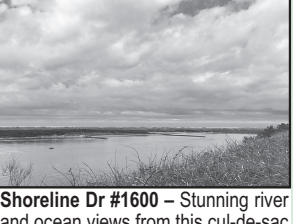

Shoreline Dr #1600 – Stunning river and ocean views from this cul-de-sac lot in gated Shelter Cove. Build your dream home with underground utilities, city water and sewer available. Level and cleared with end-of-road privacy. An engineer's report is on file as well as a home plan. **\$179,000.** #2664-16013673



Maple Lane #3 – The privacy of a gated community, the convenience of living in town, and the serenity of living in the woods in your newly-built home. Great value on this in-town lot with all city services. Possible seller terms. **\$14,000.** #1102-6916025



4060 Munsel Creek Dr – In-town, 3 bdrm, 2.5 bath home backs up to a greenbelt. Spacious open floor plan with new vinyl tile flooring, vaulted ceilings and skylights. Oak kitchen cabinets with granite countertops plus a pantry. RV parking with hookups. **\$398,900.** #3003-19047184



85289 Hwy 101 – Live and work from home! This multiuse property has spacious living quarters with a large storefront on the first floor. Property has 100' of HWY 101 frontage. Updated security with cameras, security doors and reinforced windows. **\$230,000.** #2998-19171672



Maple Lane #6 – Buildable, private lot in Rhodo View Dunes Estates. Build your custom home in this gated subdivision with all city services. Possible seller terms. **\$19,995.** #2210-13084475



1900 Chets Trail #1900 – Siltcoos Lake area lot with well in and septic approved. Possible lake views with a creek running through the lot, and possible owner financing. **\$150,000.** #2716-17602718