



# TR Hunter Real Estate

1749 Highway. 101, Florence OR 97439

www.trhunter.com

541-997-1200 • 800-210-7453



**88865 Shoreline Dr** – Stunning ocean views abound in this updated beach front Kla-Ha-Nee home, with 3 bdrms, 2.5 baths plus bonus studio with walk in closet. Updated kitchen with all new appliances, 2-car garage, as well as an RV garage with room for your beach toys. **\$739,000.** #2864-18456475



**New Listing**

**951 Jasper Ln** – Well-kept, conveniently located Seabrook Townhouse. Beautiful hardwood floors throughout the open-concept main floor. Upstairs you will find two master suites and plenty of storage space. Two covered decks and a 1-car garage. **\$214,000.** #2892-18466160



**88841 Rhododendron Ln** – Own your own peninsula on Mercer Lake. This beautiful 2412 sqft custom 2 level, lakefront home boasts bamboo flooring, granite kitchen, views from most rooms, stone fireplace, large covered front porch, expansive back deck, 3-car garage, and a large master suite w/ views you will enjoy. It has 2 private sandy beaches. **\$1,100,000.** #2874-18491794



**85545 Pine St** – 10+ acres with Siuslaw River & Old Town views! 4 bdrm, 4 bath luxury home with plenty of room for everyone. Park like setting with old growth timber and huge shops/garages. Media room, bar and entertainment area, and much more. **\$1,350,000.** #2745-17283691



**1035 Royal St Georges Dr** – Stunning 3,642 sqft custom home in gated Sandpines Golf Links. Gorgeous views of the greens and lake. Gourmet kitchen with top of the line appliances, island and granite counters. Master suite with jet tub and walk-in shower. All this and an elevator! **\$850,000.** #2455-15194493



**85082 Hwy 101** – Highway 101 frontage with 5 acres, let me show you this property! 1945 house with well and septic. Great buildable area on the west end of property, bring your dreams and imagination! **\$159,000.** #2825-18414771



**89510 Hwy 101 #15** – Cute as a bug's ear! This 1991, 2 bdrm, 1 bath mobile only has an additional 10x10 enclosed porch with a doggie door. All appliances are included with a new shower/sink, and 2016 refrigerator. Buck Lake is stocked with fish, so bring your pole and tackle! **\$55,000.** #2880-18535864



**88269 Pond St** – 2199 sqft, 3 bdrm, 3-1/2 bath beach bungalow with self-contained guest quarters upstairs. 2 beach access points at either end of the street, whitewater ocean views. **\$599,000.** #2887-18312881



**1601-559 Rhododendron Dr** – Meticulously kept 2 bdrm, 2 bath with breathtaking Siuslaw River views. 700 sqft bonus room with full bathroom above the attached 2 car garage. Paved driveway with extra parking as well as RV parking and hookups. Don't miss this gem! **\$329,000.** #2886-18521725

trhunter.com • trhunter.com • trhunter.com



**85121 Hwy 101** – Rare live/work opportunity on .56 acre! 2700 sqft retail space with Hwy 101 frontage and large display windows. The 1396 sqft, 2 bdrm home has a new roof and fenced backyard, 2 RV sites with hookups, plenty of room for gardening, garage, boat parking, etc. **\$185,000.** #2818-18496607



**3897 Ocean View Dr** – Ocean views in almost every room of this home in gated Rhodo View Dunes. High-end finishes include tile and hickory flooring, granite, double built-in ovens, and gas range with a down-draft. Beautiful master suite and deep 3-car garage. Landscaped with a sprinkler system. **\$625,000.** #2853-18528509



**214 Cloudcroft Ln** – Under Construction in Idylewood. Upgrades throughout, including tile and waterproof laminate wood floors, granite counters and high ceilings. Spacious master suite with double vanity and walk-in closet. 3-car garage. Still time to choose your finishing touches! **\$429,000.** #2844-18133634

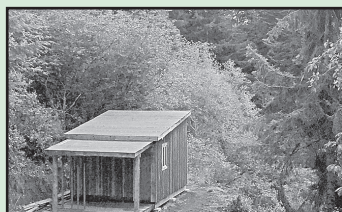

**Bay Breeze Rd #1600, North Bend** – Beautiful handcrafted 12x16 real wood, off-grid vacation cabin nestled in the woods, yet still close to town. Buy it as is, or have the seller install upgrades. Come see this beautiful property! **\$59,500.** #2877-18559974



**88097 Lake Point Dr** – Under construction, 3 bdrm, 2 bath home with time to make upgrades. Open concept with granite counters, vaulted ceilings, wood flooring and tiled bathrooms. Vaulted master suite includes spa tub, tile walk-in shower and walk-in closet. **\$529,000.** #2771-17091558



**89373 Dahlin Rd** – Located above the Dahlin Arm of Mercer Lake, this property features 5 acres of privacy! The 2496 sqft, 3 bdrm, 2 bath home has a 2 car garage as well as a 40x60 shop. Deeded Mercer Lake access with registered dock site is included! **\$449,000.** #2840-18292894



**871 8th St** – Large, custom built split-level home on quiet dead-end street. 5 bdrm, 3 bath with lots of living and closet space. Rear deck, fully fenced yard with fruit trees and large storage area with power. Wonderful home in a great neighborhood. **\$377,000.** #2637-16266291



**88063 Lake Point Dr** – New construction with high-end touches throughout. Kitchen includes an island, soft-close cabinets, and a pantry. Master suite offers a double vanity, walk-in tile shower, and walk-in closet with laundry hook-ups. Additional bdrms, bonus room, loft and laundry room upstairs. **\$525,000.** #2770-17607544

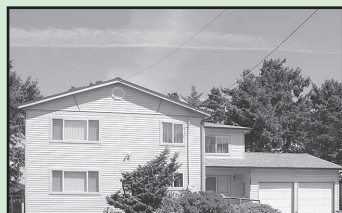

**88505 3rd Ave** – Great full-time home or a vacation rental. Ocean views with 2546 sqft, 4 bdrms, 3.5 baths, an oversized double garage plus room on the side for your RV. Well maintained home and low maintenance yard with end of road privacy. **\$449,000.** #2820-18546268



**87637 Hwy 101** – 1.53 acres in City limits on Hwy 101 zoned Service/Industrial, many development options. Renovate the current home, build or relocate a business. 30x60 shop, subdividing into smaller lots a possibility. Spruce St access available at the back when street is extended by the City. **\$299,000.** #2794-18084993



**118 Sailor Ln** – Coastal getaway in Coast Village Gated Community. This property includes a 2008 travel trailer parked under the ramada, furnished and ready to go. Enjoy security and recreational facilities on the central Oregon coast! **\$79,900.** #2849-18051180



**10818 Hwy 36** – Large commercial building on two city lots at the junction of Hwy 36 and 126 in Mapleton, a high traffic area. Metal building with high open beam ceiling, 3 phase power on one meter. Check with Lane County for zoning uses. Property is being sold "as is". **\$65,000.** #2802-18047518

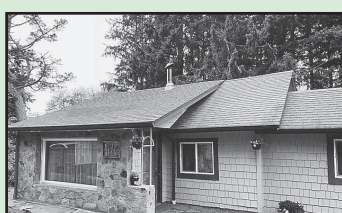

**90310 Hwy 101** – North Lakes area home near beaches and horse trails. Cute 2 bdrm home on 1.77 acres with large deck. Parking space for RVs and toys. Enjoy the many outbuildings/shops and yard with a fish pond and mature landscaping. **\$285,000.** #2891-18466892



**Ocean View Dr #4900** – This lot is ready to build your custom dream home located in Rhodo View Dunes Estates. Direct southern exposure, and gorgeous ocean sunsets have captured many homeowners in this upscale, gated community. **\$150,000.** #2720-17012629



**Hwy 101 S #2000, #2001, #2300** – One of a kind 48 acre Siltcoos Lakefront parcel. Zoned RR1 in Dunes City with potential 6-8 lot subdivision. Visit Dunescityhall.com for community and zoning information. Gated entry, call for an appointment today! **\$395,000.** #2715-17018995



**Levage Drive #600** – This home site is cleared and ready for your building project. Enjoy filtered Sutton Lake views in this established neighborhood. Heceta Water and power available at the lot line. Owner financing available OAC. **\$69,000.** #2822-18170517



**Hwy 101 #2700** – Lovely buildable 8.28 acre parcel, zoned RR5 with large firs and cedars, and a very small year-round creek. Partially cleared and fenced, includes a metal stable with cement floor. **\$175,000.** #2870-18586519



**Ocean View Dr #7400** – Build your dream home to accentuate the ocean, river, and city views! Elevated lot ready for your house plans. Gated community of custom homes and underground utilities enhance your living experience. Adjacent lot also for sale. **\$83,000.** #2760-17457532



**Boy Scout Rd #1600** – Approx. 1 acre Siltcoos waterfront home site, 5 tax lots included. 100 feet of lakefront, street access to the property, home site cleared with driveway, utilities available. **\$215,000.** #2783-18405554



**Ocean View DR #07300** – Expansive views of the city of Florence, the Siuslaw River, and Ocean. Gated community of custom homes; all utilities to be underground. Towering views, perfect for your dream home along the Central Oregon Coast. Adjacent lot can be purchased for a bargain **\$82,000.** #2759-17392172



**Shoreline Dr #40** – .46-acre Siuslaw Riverfront lot in Shelter Cove gated community. Located on a quiet cul-de-sac, this lot offers incredible river, ocean and sunset views. Utilities at the lot line, this land is waiting for your new home! **\$140,000.** #2843-18611838



**Shoreline Drive #108** – Buildable lot in Kla-Ha-Nee. Enjoy the sight and sounds of the ocean from your new home. Borders Siuslaw Nat'l Forest land and common area. Adjacent lot is also for sale. Wetland present on lot. Property corners are flagged and the HOA has approved hook-up to the community septic system. **\$49,999.** #2882-18208638

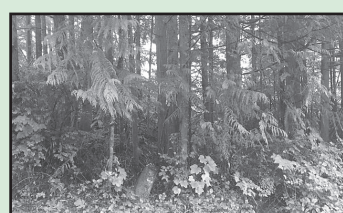

**Cedar St #800** – Nice corner lot south of Florence near dunes, beach and town. Paved roads to this wooded lot with lots of possibilities. Quiet neighborhood with nice, newer homes around. Needs cleared and developed, so bring your ideas. Priced to sell! **\$35,000.** #2785-17017018

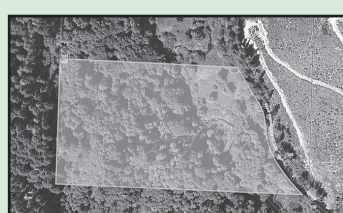

**Upper Deadwood Creek Rd #300** – Beautiful 15.45 acres tucked away in Deadwood. Enjoy a year round creek in this mountain setting. Zoned F2 Impacted Forest, and bordered by 693 Dept of Agriculture acres. Check with Lane County about building possibilities. **\$95,000.** #2636-18456906

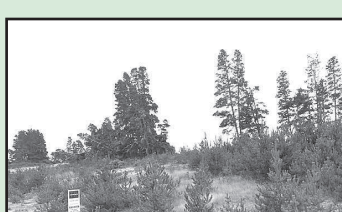

**Starving Dr #97** – Roomy home site in the Reserve overlooks woods, dunes and wetlands, with plenty of room to build your new home or have Seller build it for you! **\$94,000.** #2871-18405554



**White Tail Ct #25** – Wind-protected .27 acre lot with south-facing backyard in lovely Fawn Ridge East gated community. Build your dream home, minutes from the beach and shopping. All city services available. **\$55,000.** #2888-18566980



**Heceta Lake Estates** – Want to build your dream home near the beach? Try one of these 2 lots, or both for extra privacy. Ideal cul-de-sac location off Heceta Beach Road. Manufactured homes OK. Each lot priced at **\$79,500.** #2833-18350635 & 2834-18411160



**Shoreline Dr #1600** – Stunning river and ocean views from this cul-de-sac lot in gated Shelter Cove. Build your dream home with underground utilities, city water and sewer available. Level and cleared with end-of-road privacy. An engineer's report is on file as well as a home plan. **\$179,000.** #2664-16013673



**9th Street #4000** – This high visibility lot is a great investment to build your commercial complex, with the street cut-in already in place. Located in the center of town, bordering an undeveloped section of Hemlock Street. All city services available. **\$43,900.** #2846-18439319



**91 Windleaf Way** – Build your dream home close to the beach on this beautiful .31 acre lot in Heceta South. This is a great community with very nice homes. Seller is willing to carry, so bring us an offer and start planning your future in Florence. **\$68,000.** #2799-18615048

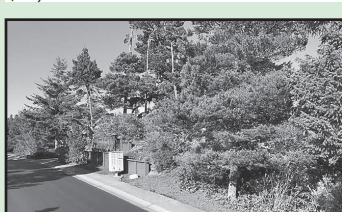

**316 Manzanita Dr** – Enjoy living in the beautiful gated community of Florentine Estates. Pick your floor plan and place your new home on this gorgeous lot within walking distance to the clubhouse, pool, sauna, work out room and tennis courts. **\$69,000.** #2775-17422491

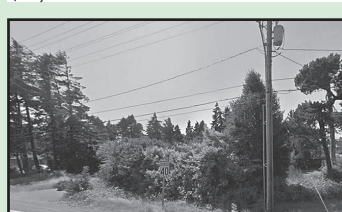

**3959 Hwy 101** – Commercial opportunity with Highway 101 frontage located in the North Florence commercial district. Highway District zoning allows for many different uses. The adjacent 1.22 acre lot to the west has frontage on Oak Street and is also for sale. **\$275,000.** #2703-17034510



**Highway 101 S #4600** – Small subdivision of approx. 10 acre lots offers protective CC&Rs, private roads and privacy. Underground utilities installed, high producing well, septic approved. Located on corner of Clear Lake Rd and Hwy 101. Across the highway from the National Dunes Recreational Area. **\$201,000.** #2806-18004896

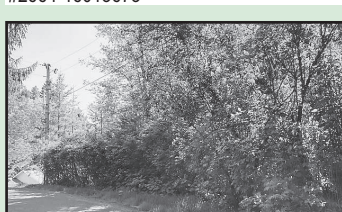

**Mercer Creek Dr #173** – Build your dream home on this beautiful North Lakes area lot. Nestled in the trees and near Sutton Lake, this lot is .30 of an acre and ready for you to develop. Wind protected, quiet neighborhood, no HOA and close to all Florence has to offer. **\$67,500.** #2830-18215029



**Shoreline Drive #106** – Enjoy your dream home, only steps from the ocean, on this buildable lot in Kla-Ha-Nee. The property corners are flagged and the HOA has approved hook up to the community septic system. Driveway to be approved by the HOA. Adjacent lot also for sale. **\$47,999.** #2881-18159589

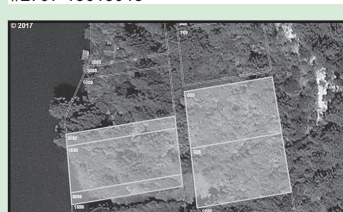

**Booth Island #1300** – Boat to your own island retreat with 1.2 acres of pristine island living on Siltcoos Lake. Over 100' of lake frontage. Fish for Salmon, Steelhead, Trout and Bass. Kayak the Siltcoos River down to the Pacific Ocean. Nearby rentals are available at Westlake Resort. **\$99,000.** #2729-17237076