

LOTS IN AND AROUND THE FLORENCE AREA



\$27,500

LOT 26 WISTERIA @ SANDPINES

GREAT in-town lot at an affordable price. Located in gated community of Sandpines Gold Residential Community. This lot is ready for your next new home project. Site-built only with protective CCR's. #11114-MLS#15064775



\$48,000

32ND STREET

Multi-use Highway District property. Ideal for your new business. Possible variance for residential use. #10997 MLS#15197330



\$155,000

HIGHWAY 101 SOUTH

Great opportunity to create a place of your dreams in front with Residential in back. Gorgeous big trees. Will require a well and septic. Contiguous parcel with Pitch & Putt property listed for sale @ \$375,000. #11100 MLS#15240611

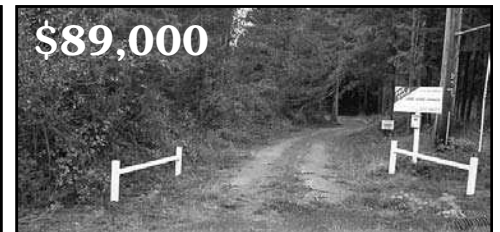

\$89,000

GRAND AVENUE

Heavily treed, flat, private lot on quiet country road just south of the Siuslaw River. Perfect for your new manufactured or stick built home. Plenty of room for all your toys. Close to beach, dunes, lakes and river. New well and septic approval. Complete home package available. Seller may help with financing. #10339 MLS#11552237



\$38,500

OCEAN & CITY VIEWS

Ocean & city views in gated community. Spectacular views from Rhododendron Dunes. Buildable lot in an upscale area. Very private with sunsets over the Pacific. Close to Ocean Dunes Golf Course. #10283 MLS#11661214



\$75,000

CALL YOUR ARCHITECT!

Wide avenues, lush vegetation, beautiful home, large lots. Sound like a great place to build your dream home? This private, end of cul-de-sac location is in an exceptional gated community located within minutes of all conveniences. Just a short stroll to the esplanade and spectacular views overlooking the river, dunes and ocean beyond. #10962 MLS#15658694



\$119,000

LOT 2 SUMMERBELL

Great, level 1 acre building parcel, wooded with underground utilities. Exceptional opportunity to own a wonderful homesite in an area of beautiful homes in the south Woahink Lake area. Seller plans have changed so they are offering at a fraction of what they paid. Possible owner financing. #10912 MLS#14013607



\$85,000

VACANT LOT IN SOUTH SHORE

Beautiful, one acre parcel in prestigious South Shore. All level, trees and Woahink Lake access. Gated community with fine homes. #9496 MLS#10094497



\$49,900

SEA WATCH BUILDING PARCEL

Above grade building parcel with all City utilities. Sea Watch is a high quality subdivision with high quality homes along the Siuslaw River. #11137 MLS#15320164



\$79,900

READY FOR YOUR DREAM HOME

Large level lot in very desirable Willow Dunes subdivision of high-end homes in the center of Florence on the Central Oregon Coast. This lot is ready for your new dream home. Over 1/4 acre with all city services at the street. Golf cart entrance to Ocean Dunes Golf Course from subdivision. Beaches, dunes, lakes, river, golf, casino, Old Town shopping - all right here. #10920 MLS#14466878



\$95,000

ERHART ROAD ACREAGE

Rare 4 acre wooded parcel in the south lakes area. Septic approved. A well will be needed. Here's your site for future dream home, whether it be a cabin, manufactured/modular or luxury; on acreage with easy access a quick drive to Siltcoos & Woahink Lakes, dunes, trails and old growth forests. #10950 MLS#14570653



\$75,000

HARVARD STREET

Heavily treed, flat, private lot on quiet country road just south of the Siuslaw River. Perfect for your new manufactured or stick built home. Plenty of room for all your toys. Close to beach, dunes, lakes and river. Septic approval. Complete home package available. Seller may help with financing. #10337 MLS#11286015



\$55,000

LARGE LEVEL LOT

Waiting for your new manufactured or stick built home. Almost 1/4 acre right in the heart of the city on a quiet dead end street. Near historic Old Town, Siuslaw River, Ocean beaches, lakes and dunes. Water & sewer are already in and power is at the street. Possible owner terms. #10724 MLS#13198938



\$119,000

SEA WATCH ESTATES - LOT 7

DESIRABLE SEA WATCH ESTATES. Excellent, level, above grade building lot complete with custom home plans. #10414 MLS#12366452



\$89,900

WOODED HOMESITE NEAR SOUTH LAKES

Exciting new offering: One heavily wooded home site on 1.88 acres. Underground utilities, water, paved roadway and septic approved. Stick-built homes only with tree preservation setbacks. Offered with possible owner financing makes this a great opportunity to build now or later. #10925 MLS#14419930



\$49,500

ALDER DRIVE

One of the most peaceful, secluded lots just minutes from town. Over half an acre where you could park your RV and develop later. #10798 MLS#14296334