

TRIBAL FACILITIES

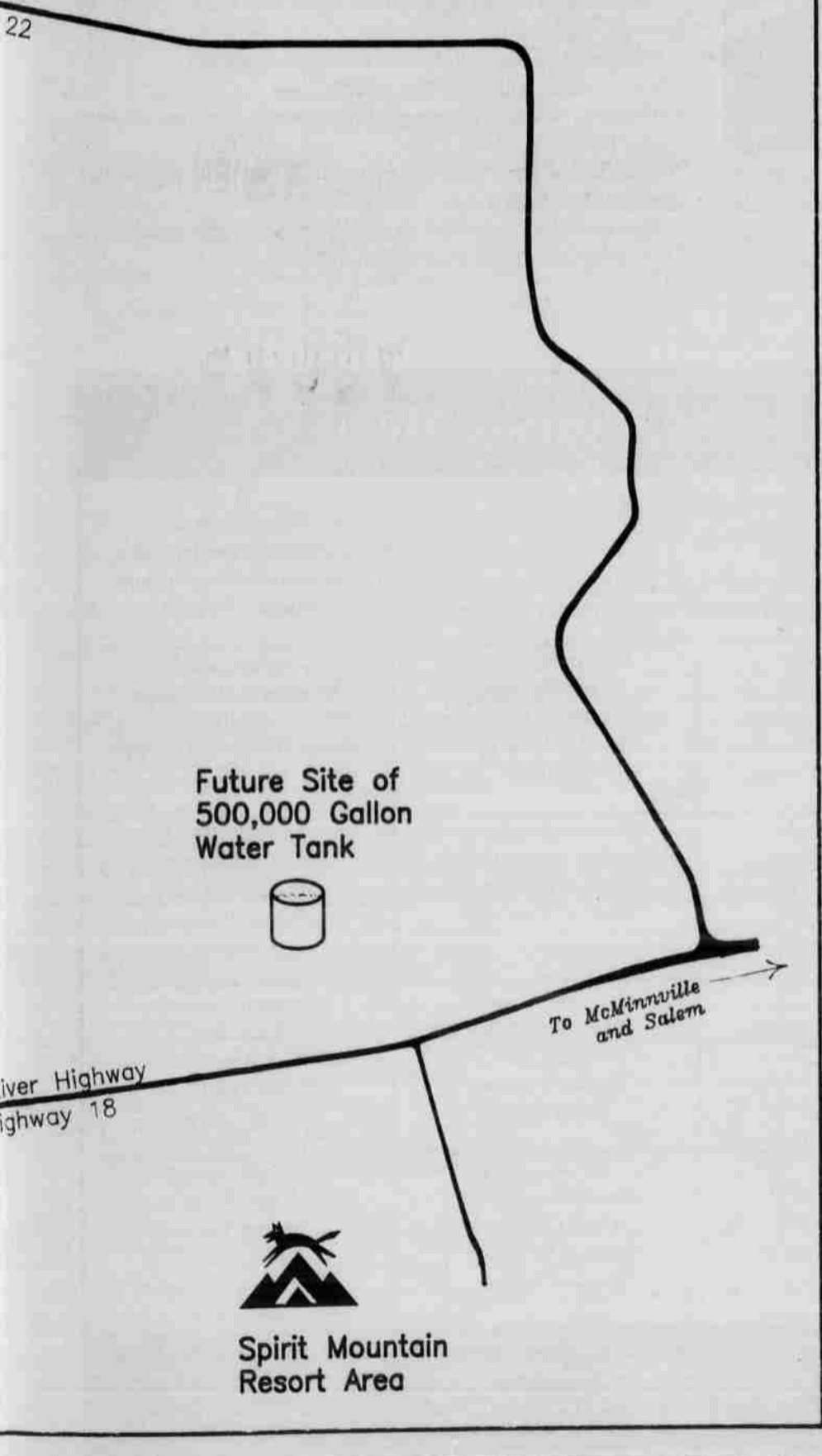
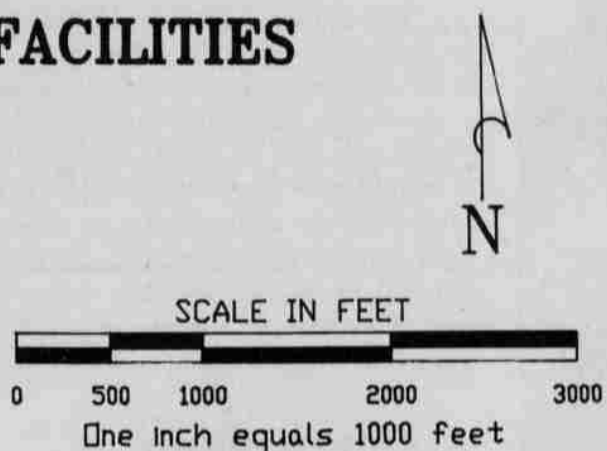

Tribe continues to expand program offices

By Tracy Dugan

If you have been a recent visitor to the tribal offices, you are probably aware of the expansion and relocation that has been taking place during the last few weeks.

This has been a much-needed development for the tribal program employees. For a long time, there have been too many staff members cramped in small offices, some have gone periods of time without an office at all.

The Tribe is growing very rapidly, and tribal members' needs are growing and changing, too. That's why the Tribe purchased a two-story modular building last fall, and restored it.

The modular is now complete and will be used by Spirit Mountain Development Corporation as a training center as well as house the Small Business Development and Education program offices.

This map depicts some of the land in Grand Ronde that the Tribe owns and occupies, and where each program is located. We hope that you will save this map and that it will be of some assistance when in Grand Ronde for tribal business or recreational activities.

The Tribe now operates departments from more than one dozen different facilities, in Grand Ronde, and within a radius of no more than one or two miles. (Nanitch Sahallie Youth Residential Treatment Facility in Salem is another tribal-owned property.)

The main modular complex, at 9615 Grand Ronde Road, now houses the Human Resources department, Accounting and Finance, Tribal Court, Tribal Council chambers and offices, Health and Wellness Services and Clinic, Policy and Planning, and Grants. It is also where the tribal attorney's office is located.

Mental Health and the Dental Clinic are still located at the Community Center, as well as the Elders' Mealsite and conference rooms. The main receptionist is now in the Community Center, too.

To make room for the casino, Natural Resources has moved to a parcel of tribal land on Hebo road.

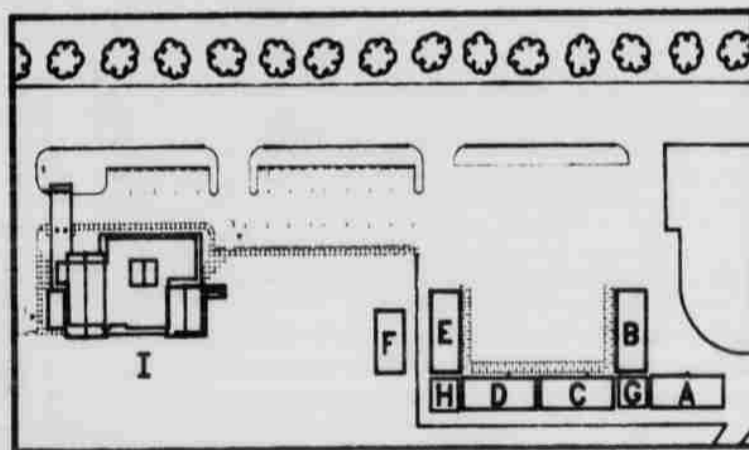

- A. Administration, Human Resources
- B. Tribal Government
- C. Accounting and Finance
- D. Policy and Planning, Enrollment, Newsletter
- E. Health Clinic
- F. Wellness and Prevention
- G. Mail Room and Purchasing
- H. Health Support Services
- I. Community Center, Main Reception Area, Dental Clinic, Mental Health