

Vote of 35,000,000 Expected at Tuesday Election Over Nation

War Detracts Much Interest

Listlessness Seen as New York's Race Billed at Top

By The Associated Press

The voters of the nation, obviously more interested in the war than in politics, will make their biennial selection—Tuesday of senators, representatives, governors and scores of lesser offices. With 53,613,052 qualified to vote indications were that only about 34,800,000 would actually do so.

Republican leaders forecast a sizable swing to their standard generally, with a gain of at least 35 seats in the house of representatives. Democrats contended the elections would not show a net republican gain of more than 15 seats.

As always in off-year elections, the house contests attracted attention as an indication of the general trend of political sentiment between presidential elections.

In addition, because of its bearing upon the 1944 presidential picture and because of President Roosevelt's participation in the preliminaries, many were watching the race for the governorship of New York.

The republican nominee is Thomas E. Dewey, who polled the most votes on the first ballot for the presidential nomination at the 1940 republican national convention. His election and two years as governor of New York, some thought, might make him a formidable candidate for the presidency in 1944.

His democratic opponent is Attorney General John J. Bennett, jr. He was nominated with the support of James A. Farley, the party's state chairman, over the opposition of Mr. Roosevelt, who preferred Sen. James M. Mead. Some time later, however, Mr. Roosevelt endorsed Bennett as against his opponents.

A third candidate is Dean Alfange, nominee of the American labor party, which in 1938 supported Gov. Herbert H. Lehman in his close but successful race against Dewey. Alfange has the backing of Mayor F. H. LaGuardia of New York.

Mrs. Clare Boothe Luce, playwright and author, has attracted national attention by her campaign for the house in the fourth district of Connecticut. She is opposed by the incumbent, LeRoy D. Downs, Democrat, and by Lester Barlow, the explosives inventor who is running as an independent.

From all sections came reports of listlessness among the voters and an absence of sharp and attention-compelling issues. Attendance at political rallies has been slim. In some places, efforts were made to make an issue of pre-war isolationism with varying consequences.

While the republicans are claiming a gain of 35 house seats, that would not give them control of that branch of congress. The present lineup is 257 democrats, 165 republicans, five-seats held by members of minor parties and eight vacancies. Of the vacant seats, seven were filled by democrats and one by a republican at the 1940 election.

A swing away from the administration has long been regarded as normal in off-year elec-

Find Your Voting Precinct Here

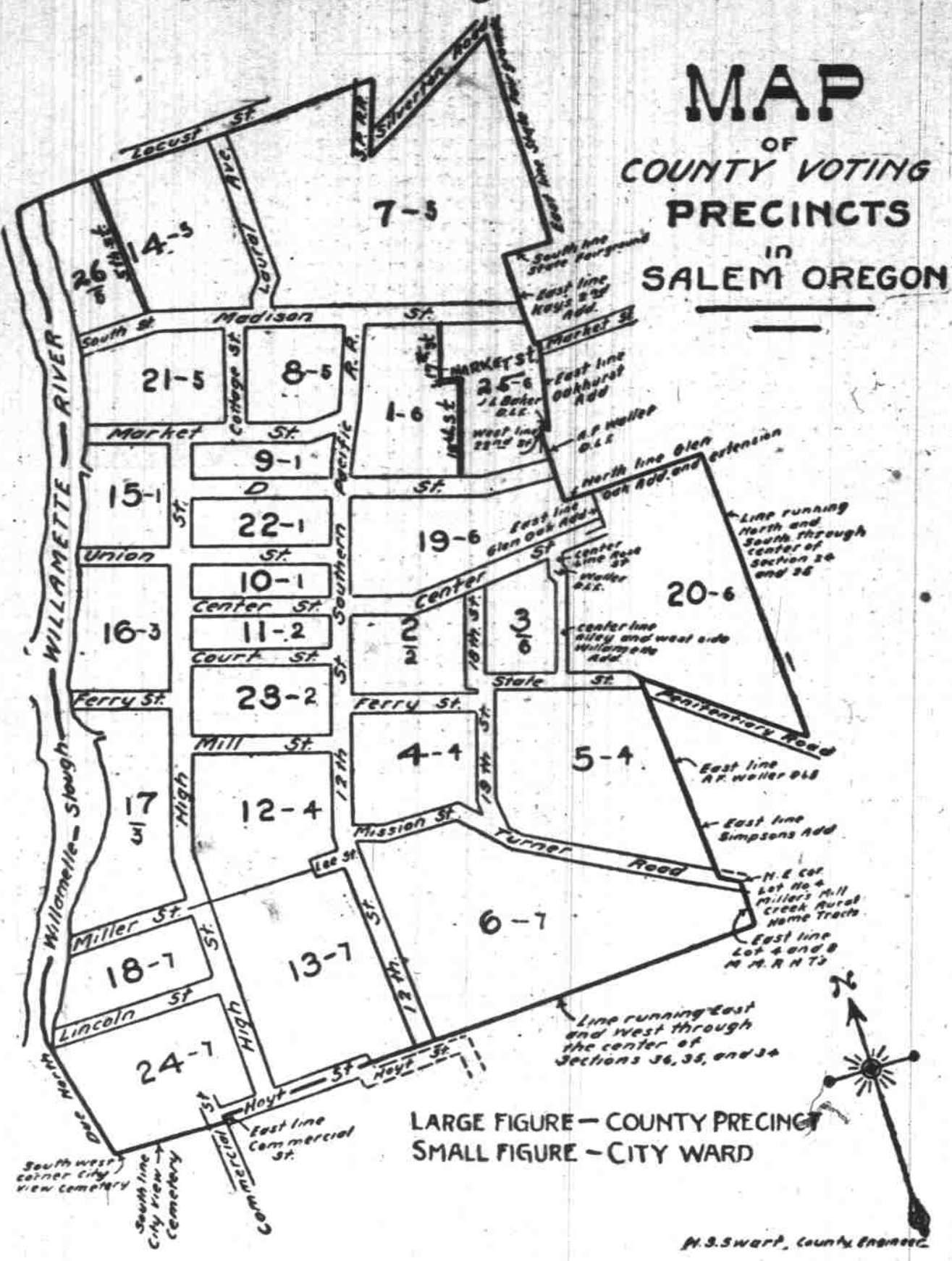

Map above shows precincts (large figures) and wards (small figures) for Salem at Tuesday's local, state and national election. There will be only one citywide contest for a city office, that between L. F. LeGarde and Alfred Mundi for city recorder. Only ward races are between Charles Helzel and R. O. Lewis for fourth ward aldermen, and Clark Craig and Lloyd Moore for sixth ward alderman.

Gasoline, Tire Lack Seen as Bar to Trade

PORTLAND, Ore., Oct. 31.—(AP) The Pacific Northwest regional planning commission warned Saturday that gasoline rationing and the tire shortage will interfere with trade in this section.

"In a region of great distances like the Pacific Northwest... wartime shortages will have a constantly increasing effect on the region's trade as gasoline rationing goes into operation and the need for replacement of tires and automobiles becomes more and more pressing," the commission said.

In addition some imports will be reduced. Automobiles are manufactured no longer, but petroleum products comprise almost 40 per cent of the imports of the northwest states of Washington, Oregon, Idaho and Montana, the commission said.

The warning was contained in a "supplementary analysis of the external trade of the Pacific Northwest," designed as a guide to development of the region's industries. It is based on a report earlier this year on external trade and covers the period from 1934 to 1939.

"Dependence upon outside sources for support of the region's transport system is especially marked," the report said, naming gasoline, automobiles and fuel oil as the three leading imports.

Shipments from the region averaged \$536,000,000 annually with lumber, flour and wheat the leading products.

\$25,000 Limit Said Wrong

WASHINGTON, Oct. 31.—(AP) Chairman George (D-Ga.) of the senate finance committee declared Saturday the \$25,000 limitation on net salaries would cause the treasury to lose tax revenue, would boost administrative costs and penalize the man who works for his income.

In sweeping criticism of the salary order, which was issued by Stabilization Director James F. Byrnes and countersigned by President Roosevelt, George told reporters he believed it would "work a terrific disadvantage on the fellow who is working for something as against the fellow who is just sitting and cutting coupons."

The order would limit salaries to \$25,000 after federal taxes, life insurance commitments and fixed obligations, but would not affect income from investments.

Meat Lack Threatened

PORTLAND, Oct. 31.—(AP) Meade Hadley, Oregon meat council advisor, said Saturday the Portland area will be practically without meat the rest of the year unless quotas are increased.

He said slaughterers had delivered this month almost the entire amount permitted by the office of price administrator for October, November and December.

Meade declared quotas were established on a national basis and no allowance was made for the fact that Portland's population has increased.

Washington Draft Quota Cut Half

SEATTLE, Oct. 31.—(AP) The November draft quota for the state of Washington has been cut to less than 50 per cent of the October figure, Col. Walter J. DeLong, state selective service director, revealed Saturday.

The reduction was ordered by national selective service headquarters, Colonel DeLong said, and follows by a few days an order originally reducing the state quota by 25 per cent.

No reference was made to possible December quotas.

Marion County Polling Places

Following is the list of precinct polling places in Marion county, where voters will go to cast their ballots in Tuesday's general election.

The list is the same as that for last May's primary election with the exception of five Salem precincts, whose polling places for this week's election are as follows: Salem No. 4, state central heating plant, 12th and Ferry streets; Salem No. 8, Conover's market, 1190 South 12th; Salem No. 15, 695 North High; Salem No. 18, changed from church hall to basement of Leslie Methodist church, Myers and South Commercial streets.

- AUMSVILLE—City Hall.
- AURORA—K. P. Hall.
- BREITENBUSH—Detroit school house.
- BROOKS—School house.
- BUTTEVILLE—IOOF Hall in Butteville.
- CHAMPOEG—Champoeg Memorial Bldg.
- CHEMAMA—Chemama Grange Hall.
- CROISAN—Roberts Grange Hall.
- DONALD—Masonic Hall at Donald.
- ENGLEWOOD—Swegle school house No. 78.
- FAIRFIELD—Fairfield grange hall.
- FAIRGROUNDS—Middle Grove school house.
- E. GERVAIS—High school auditorium.
- W. GERVAIS—Anna Tanzler residence.
- HAYESVILLE—Hayesville school house on Pacific highway.
- HOREB—Richards store.
- CENTRAL HOWELL—Central Howell school house basement.
- N. HOWELL—North Howell grange hall.
- E. HUBBARD—City hall in Hubbard.
- W. HUBBARD—Hovenden building.
- JEFFERSON—Masonic Hall in Jefferson.
- LIBERTY—Liberty Community Hall.
- MACLEAY—Macleay grange hall.
- MARION—WOW Hall in Marion.
- MEKEE—Belle Passi school house.
- MEHAMA—Wm. P. Mulkey office.
- MILL CITY—Mill City State Bank.
- MONITOR—IOOF Hall.
- E. MT. ANGEL—City Hall.
- W. MT. ANGEL—Mt. Angel garage.
- FRINGLE—Pringle school house.
- QUINABY—Robertson's warehouse.
- ROSEDALE—Rosedale school house.
- SALEM NO. 1—Basement U. B. Church, cor. 17th & Nebraska.
- SALEM NO. 2—1st floor Court St. Christian church, 17th and Court.
- SALEM NO. 3—Four Square church bmt., 19th & Breyman streets.
- SALEM NO. 4—State Central Heating plant, 12th & Ferry streets.
- SALEM NO. 5—Basement Richmond school.
- SALEM NO. 6—Conover's Market, 1190 South 12th street.
- SALEM NO. 7—St. Vincent de Paul Hall.
- SALEM NO. 8—Basement, Jason Lee church, Jefferson and Winter.
- SALEM NO. 9—Basement Baptist church, corner D & North Cottage.
- SALEM NO. 10—Basement Salem Women's club building, 460 North Cottage.
- SALEM NO. 11—Hotel Senator.
- SALEM NO. 12—Deaconess hospital basement, corner Oak and Winter.
- SALEM NO. 13—Basement Leslie Jr. high school.
- SALEM NO. 14—Immanuel Baptist church, Hazel avenue and Academy.
- SALEM NO. 15—695 North High.
- SALEM NO. 16—City Hall.
- SALEM NO. 17—Banquet room, Marion hotel.
- SALEM NO. 18—Leslie Methodist church basement, Myers and North Commercial.
- SALEM NO. 19—East entrance basement Washington school.
- SALEM NO. 20—Church, 2335 Chemeketa.
- SALEM NO. 21—Basement First Church of God, 1425 North Cottage.
- SALEM NO. 22—Parrish Junior high.
- SALEM NO. 23—Court House.
- SALEM NO. 24—Basement Friends church, corner Washington and South Commercial.
- SALEM NO. 25—Basement Englewood school auditorium.
- SALEM NO. 26—Basement Highland school.
- EAST SALEM—Rickey school house.
- SALEM HEIGHTS—Salem Heights Hall.
- ST. PAUL—St. Paul Community Hall.
- SCOLLARD—Wengeroth's store in Woodburn.
- SCOTTS MILLS—IOOF Hall in Scotts Mills.
- SHAW—Shaw Hall in Shaw.
- SIDNEY—Grange Hall.
- SILVERTON HILLS—Silverton Hills Community Hall.
- N. SILVERTON—Basement St. Paul Catholic church.
- S. SILVERTON—Evergreen school house.
- E. SILVERTON—Council chambers, Silverton.
- STAYTON—Murphy-Gardner Lumber Co. office.
- W. SILVERTON—Knights of Pythias Hall.
- W. STAYTON—W. Stayton school house Dist. No. 61.
- E. STAYTON—Grange hall in Stayton.
- SUBMITTY—COF Hall.
- TURNER—Masonic Hall.
- UNION HILL—Union Hill grange hall.
- WACONDA—Britt Aspinwall's garage.
- E. WOODBURN—Methodist church in Woodburn.
- W. WOODBURN—City Hall in Woodburn.

Voter Cards Available From Clerk

Clerk's certificates to voters registered in Marion county but temporarily residing elsewhere are still available through his office, County Clerk Lee Ohmart said Saturday. The certificate permits the holder to vote, but for state officers only in the county where he is now residing.

The clerk's office is to be closed for all but election business on election day, Tuesday. At all hours of the day, however, there will be a person or persons in the office to provide assistance to election boards or to answer queries or take care of any other business related to the election.

Votes cast for less than four candidates for the state legislature are not disqualified because off allure to vote for the number specified, Ohmart emphasized in answer to inquiries as to the legality of "single shooting" votes. No more than the specified number may be selected by any voter for any office, but where less than the number allowed are selected the vote as cast counts, he said.

Hunter Wins Stork Chase

HILLSBORO, Oct. 31.—(AP) Walter Robbins wanted to spend his one-day hunting trip chasing deer.

Instead, he chased the stork. Robbins, a shipyard worker, was on his way to the hills. He was flagged down by the driver of a stalled car which was carrying Mrs. Glenn Ingles of Banks to the hospital for delivery of a baby.

Mrs. Ingles was transferred to Robbins' car and the race was on. A police car followed Robbins' speeding vehicle but didn't stop him.

Hospital attendants said Mrs. Ingles arrived there just in time.

Rosedale Man Is Hospital Patient

ROSEDALE—H. C. Carter is in a local hospital for medical attention following a heart attack at his home the first of the week.

Mrs. Katherine Thomas of California visited her parents, Mr. and Mrs. Bert Hamilton, this week.

Mr. and Mrs. Jack Turnbull are renting their farm and moving to town the first of the week.



Elected
ALFRED (AL) MUNDT
for
City Recorder
Deputy City Recorder for the Past Eighteen Years
Honest • Experienced • Capable
Qualified by Experience
Paid Adv.

They're Guadalcanal Heroes too



A group of US navy pharmacists, assigned to the US marine corps as "corpomen" carry a wounded marine through sweltering jungle heat and rain less than 100 yards from the battle line during an engagement with the Japs on Guadalcanal. The "corpomen" act as stretcher bearers and administer first aid to the wounded during battle.—Associated Press Telemat.

Pearce Heads Woods Output

SEATTLE, Oct. 31.—(AP) Prof. J. Kenneth Pearce of the University of Washington college of forestry has been appointed to take charge of lumber production problems in the 12 western states, it was revealed Saturday when the university regents granted him a leave of absence.

His appointment as "principal industrial specialist" in the war production board will become effective Monday.

His assignment includes handling the problems of logging, logging transportation, saw mills, mills, shingle mills, planing mills, lumber mills and creosoting plants in the 12 western states.

Pearce joined the university faculty in 1934 after concluding a 10-year job of reorganizing and modernizing the lumber industry of India. He worked two years as a laborer in lumber camps immediately after graduating from high school.

Portland Bank Clearings Climb

PORTLAND, Ore., Oct. 31.—(AP) Bank clearings for October set an all-time record of \$336,559,213 in Portland, but building permits continued to fall off.

October clearings brought the total for the first 10 months of 1942 to \$2,681,134,803. Clearings for October of last year were \$250,992,868 and for last month \$320,454,892.

Building amounted to \$878,045 under 481 permits compared to 515 permits aggregating \$1,218,595 for October of last year.

Cottage Grove Cyclist Killed

CANYON CITY, Ore., Oct. 31.—(AP) State police investigated Saturday a motorcycle wreck on the Ochoco highway Friday night that killed Ralph Watkins, 20, Cottage Grove.

The machine was found on the roadside near the 101 ranch with Watkins nearby in a critical condition. He died shortly of a fractured skull.

Watkins was en route to a visit with an uncle, Ed Watkins, Dayville.

Elect **Clare M. BRABEC**
Marion County
REPRESENTATIVE
in the Oregon Legislature
Will serve unselfishly and conscientiously the interests of Marion County people and support an all-out effort to win the war.
Vote 24X Clare M. Brabec
Paid Adv.

Reelect Your Congressman
James W. MOTT
REPUBLICAN
A recognized Leader in Congress with a Record of outstanding Achievement—
WHY CHANGE?
READ VOTERS PAMPHLET

Re-elect
L. H. McMahan
Present
Circuit Judge
Experienced
Efficient • Impartial
(Paid Ad) D. B. Cooley
Salem, Oregon