

# Our Size

We are not the largest bank in the country, neither are we the smallest. We are large enough to meet the legitimate needs of our patrons and small enough to give personal attention to detail.

**First National Bank**  
ASHLAND, OREGON.  
Oldest National Bank in Jackson County

### COUNTY COURT PROCEEDINGS.

The following is a schedule of expenditures of Jackson county, Oregon, together with a list of claimants and articles or services for which the claim is made, and which were passed upon by the County Court for Jackson county, during the month of January, 1916:

The following bills were allowed relative to the County Salary Fund, to-wit:

<b>County Court and Commissioners.</b>	
F. H. Madden, commissioner's compensation	\$ 20.00
F. L. Tou Velle, county judge's salary	150.00
H. B. Taylor, stenographer hire	3.44
Wm. C. Loeffer, commissioner's compensation	20.00
Wm. C. Loeffer, commissioner's compensation	45.40
Wm. C. Loeffer, commissioner's compensation	25.00
<b>Total</b>	<b>\$263.84</b>
<b>Sheriff's Office.</b>	
W. H. Singler, sheriff's salary	\$208.33
H. B. Taylor, clerk hire	5.31
E. W. Wilson, deputy sheriff's salary	125.00
<b>Total</b>	<b>\$338.64</b>
<b>Clerk's Office.</b>	
F. D. Coleman, deputy hire	\$ 80.00
G. A. Gardner, clerk's salary	250.00
H. B. Taylor, clerk hire	56.25
<b>Total</b>	<b>\$386.25</b>
<b>Treasurer's Office.</b>	
Merrill Blakely, deputy hire	\$ 80.00
Fred L. Colvig, treasurer's salary	100.00
<b>School Superintendent's Office.</b>	
A. R. Chase, supervisor's salary	\$120.00
E. R. Peterson, supervisor's salary	120.00
J. Percy Wells, superintendent's salary	150.00
May B. Wells, deputy hire	25.00
<b>Total</b>	<b>\$415.00</b>
<b>Fruit Inspector's Office.</b>	
J. C. Aitken, deputy inspector's compensation	\$ 55.00
J. P. Hopkins, deputy inspector's compensation	80.00
I. R. Kine, deputy inspector's compensation	49.50
<b>Total</b>	<b>\$184.50</b>
<b>Assessor's Office.</b>	
W. T. Grieve, assessor's salary	\$125.00
Etta Purkeyppie, deputy hire	80.00
Katie M. Grieve, deputy hire	65.00
Leslie W. Stansel, deputy hire	78.00
<b>Total</b>	<b>\$348.00</b>
<b>Collection of Taxes.</b>	
D. H. Allaway, labor	\$ 78.00
W. H. Bowen, labor	78.00
G. R. Harper, deputy's salary	100.00
<b>Total</b>	<b>\$256.00</b>
J. A. Norris, janitor's salary	60.00
J. W. Wilson, janitor's salary	50.00
Dr. J. F. Hart, salary of poor farm superintendent and helper	208.33
John Blaess, ferryman's salary	25.00

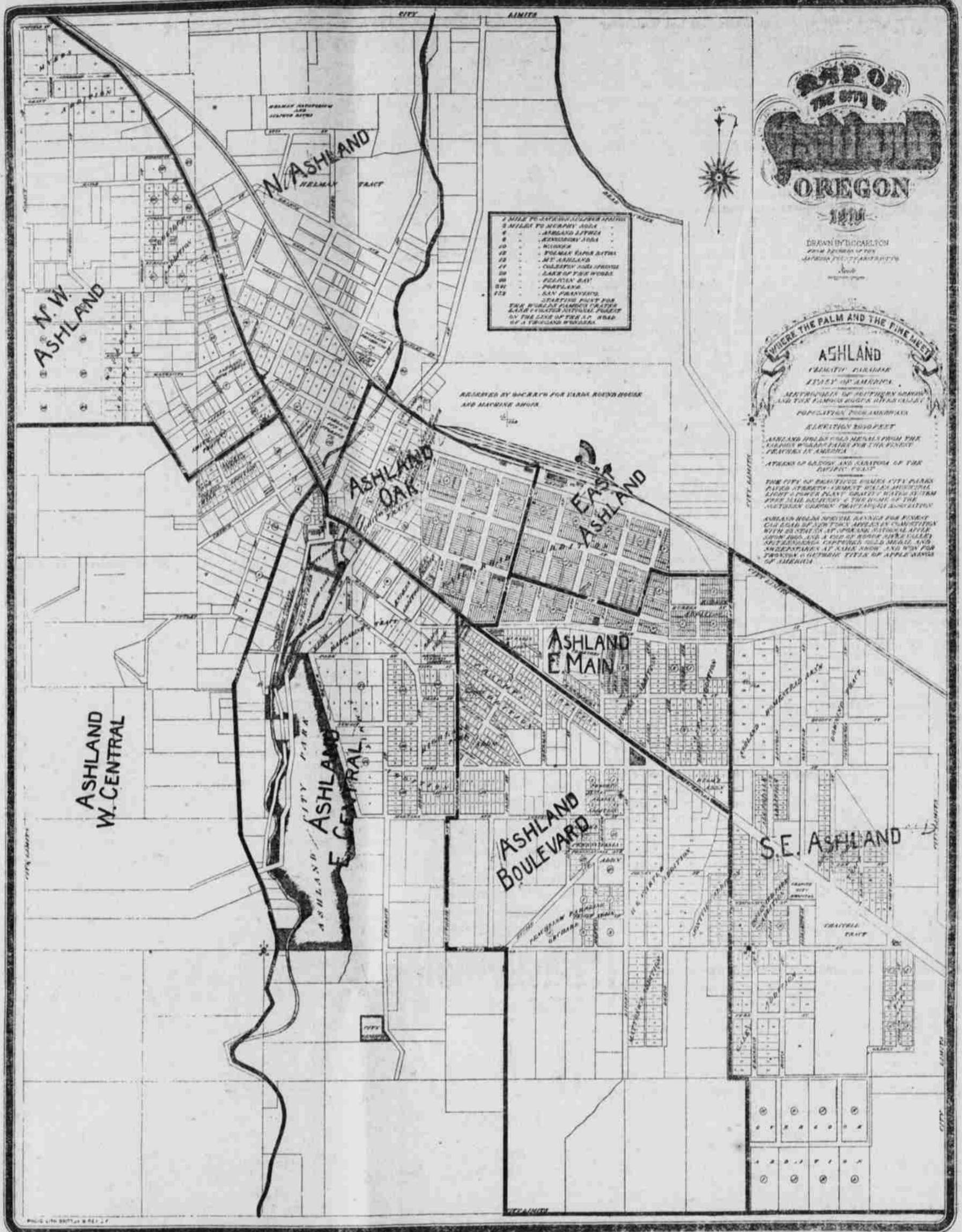

## ASHLAND VOTING PRECINCTS MAPPED OUT CUT THIS OUT AND SAVE

### WHY THE BEST OF CHEWS IS "SPEAR HEAD"

Its Rich, Sweet, Mellow Flavor Has Been Famous for a Generation

### MADE OF CHOICEST RED BURLEY

The secret of tobacco satisfaction is known only to the man who chews *plug tobacco*. The reason is that a good chew gets right next to your taste, while the leaf in *plug tobacco* is in a state of fresh, juicy richness that is not possible in any other form of tobacco.

There's no tobacco in the world that can give you the hearty, wholesome flavor that you get from a delicious chew of *Spear Head*.

*Spear Head* is made exclusively of ripe, red Kentucky Burley—the most richly-flavored chewing tobacco that grows. Still more, only the very choicest red Burley leaf is used for *Spear Head*.

The choice leaf is selected with the most painstaking care, is stemmed by hand, is thoroughly washed free of all foreign matter, and is pressed into *Spear Head* plugs so slowly that not a drop of juice or an atom of the natural flavor escapes.

Try *Spear Head*, and you'll get a sweet, mellow, luscious, satisfying chew that cannot be obtained in any other tobacco. In 10c cuts, wrapped in wax paper.

<b>Recorder's Office.</b>		A. B. Hammond, constable fees	38.50	Co., freight on supplies	.55	<b>Collection of Taxes.</b>		Dora Belle Cress	10.00	
Chauncey Florey, recorder's salary	\$166.56	A. B. Hammond, constable fees	6.15	Ulrich Bros. transportation of supplies	.75	Medford Printing Co., supplies	\$ 40.00	Anna L. Corum	10.00	
Vera E. Lane, clerk hire	4.00	J. B. R. Morelock, assisting drawing jury list	2.00	<b>Total</b>	<b>\$143.88</b>	<b>Tax Rebates.</b>		Mrs. H. A. Creighton	17.50	
Mildred Neil, deputy hire	75.00	P. H. Myers, assisting drawing jury list	2.00	<b>Treasurer's Office.</b>		John Rocho	\$ 43.84	May J. Dow	40.00	
<b>Total</b>	<b>\$245.66</b>	O. W. Murphy, car hire	4.00	Fred L. Colvig, express on office supplies	\$ 1.25	John Rocho	144.84	Lucy May Davis	25.00	
<b>Surveyor's Office.</b>		Benton Pool, assisting drawing jury list	2.00	Home Tel. & Tel. Co., telephone bill	2.50	John Rocho	9.17	Olive Ellis	17.50	
A. T. Brown, surveyor's compensation	\$107.60	A. J. T. Smith drawing jury list	3.00	<b>Total</b>	<b>\$ 3.75</b>	W. G. Sanders	27.66	Nettie Green	25.00	
A. J. Rose, deputy hire	104.00	John Siler, witness	4.20	<b>Coroner's Office.</b>		Jennine Jones	10.00	Liella Frances Hilderbrand	17.50	
<b>Total</b>	<b>\$211.60</b>	Jasper Tungate, witness	4.70	John A. Perl, coroner's fees	\$ 54.40	Idabel Klum	25.00	Lizzie Heath	25.00	
Charles L. Hanson, compensation of sealer of weights and measures	44.84	G. O. Taylor, justice fees	15.30	Dr. E. R. Seeley, coroner's physician	5.00	Dollie Love	32.50	Jennie Jones	10.00	
The following bill was allowed relative to the County Stamp Fund, to-wit:		G. O. Taylor, justice fees	35.55	<b>Total</b>	<b>\$ 59.40</b>	Amanda M. McNeil	10.00	Idabel Klum	25.00	
Fred L. Colvig, treasurer	\$125.00	<b>Sheriff's Office.</b>		<b>School Superintendent's Office.</b>		Estella Nelson	40.00	Dollie Love	32.50	
Distributed as follows, to-wit:		Ashland Record, supplies	\$ 1.75	The J. K. Gill Co., supplies	\$ 1.49	Emma Paulson	25.00	Amanda M. McNeil	10.00	
Sheriff's office	19.00	Home Tel. & Tel. Co., telephone bill	3.10	Home Tel. & Tel. Co., telephone bill	4.25	Mary E. Payne	17.50	Estella Nelson	40.00	
Clerk's office	23.00	Jacksonville Post, supplies	8.00	Medford Book Store, supplies	59.95	Maria E. Robbins	10.00	Emma Paulson	25.00	
Treasurer's office	52.00	Medford Book Store, supplies	9.30	Medford Printing Co., supplies	2.75	Laura E. Stewart	35.00	Maria E. Robbins	10.00	
School superintendent's office	20.00	Postal Tel. & Cable Co., telegrams	1.96	Southern Oregon Traction Co., freight on supplies	.25	Catharine E. Silver	17.50	Laura E. Stewart	35.00	
Assessor's office	2.00	W. H. Singler, sheriff's traveling expense	59.00	J. Percy Wells, superintendent's traveling expense	50.50	<b>Widows' Pensions.</b>		Catharine E. Silver	17.50	
Recorder's office	9.00	So. Oregon Traction Co., freight on supplies	1.48	J. Percy Wells, express on office supplies	6.53	Earnstine Austin	\$ 17.50			
The following bills were allowed relative to the General County Fund, to-wit:		<b>Total</b>	<b>\$ 84.59</b>	May B. Wells, assisting with teachers' examination	12.00	Printha A. Blackburn	32.50			
<b>County Court and Commissioners.</b>		<b>Clerk's Office.</b>		<b>Assessor's Office.</b>		Mrs. J. A. Byerly	35.00			
Home Tel. & Tel. Co., telephone bill	\$ 6.75	Bushong & Co., supplies	\$ 51.23	W. T. Grieve, assessor's traveling expense	\$ 38.40	Minnie Boardman	25.00			
Postal Tel. & Cable Co., telegrams	.50	G. A. Gardner, express on office supplies	1.69	Glass & Prudhomme Co., supplies	6.14	Nellie G. Bush	10.00			
W. U. Tel. Co., telegrams	3.06	Glass & Prudhomme Co., supplies	68.64	Home Tel. & Tel. Co., telephone bill	3.30	Orpha Betz	10.00			
<b>Total</b>	<b>\$ 10.31</b>	Home Tel. & Tel. Co., telegrams	4.40	Medford Book Store, supplies	8.05	<b>Total</b>		<b>\$247.77</b>		
<b>Justice Court.</b>		Jacksonville Post, supplies	.90	<b>Total</b>	<b>\$ 137.72</b>	<b>Widows' Pensions.</b>				
Oliver Adams, constable fees	\$ 3.10	Medford Book Store, supplies	2.96	<b>School Superintendent's Office.</b>		Mary E. Payne	17.50			
Everett Abbott, witness	4.20	Medford Printing Co., supplies	9.00	The J. K. Gill Co., supplies	\$ 1.49	Rosa M. Robbins	10.00			
B. L. Barkley, meals for prisoners	1.75	Postal Tel. & Cable Co., telegrams	3.76	Home Tel. & Tel. Co., telephone bill	3.30	Laura E. Stewart	35.00			
C. C. Buck, casting jury list	2.00	Southern Oregon Traction		Medford Book Store, supplies	8.05	Catharine E. Silver	17.50			
J. C. Burton, drawing jury list	3.00			<b>Total</b>	<b>\$ 55.89</b>	<b>Total</b>		<b>\$247.77</b>		
T. W. Goodman, livery hire	3.50					<b>Widows' Pensions.</b>				

**McNair Bros. Ashland, Oregon**