

COOS BAY TIMES

An Independent Republican newspaper published every evening except Sunday, and Weekly by The Coos Bay Times Publishing Co.

Entered at the postoffice at Marshfield, Oregon, for transmission through the mails as second class mail matter.

M. C. MALONEY, Editor and Pub. DAN E. MALONEY, News Editor

SUBSCRIPTION RATES. In Advance. DAILY. One year \$5.00 Six months \$2.50 Less than 6 months per month .50 WEEKLY. One Year \$1.50

The policy of the Coos Bay Times will be Republican in politics, with the independence of which President Roosevelt is the leading exponent

PROSPEROUS COOS COUNTY.

The Coquille Sentinel editor journeyed to Myrtle Point the other day and noted the energy and push of some of the people of that pretty town in the west of improvements.

What has become of the old-fashioned man who caught the children and "bearded" them by rubbing his face over theirs?

COOS BAY, ROSEBURG & EASTERN RAILROAD & NAVIGATION COMPANY. TIME TABLE NO. 4.

Table with columns for destination (South, North), time of departure, and arrival. Includes routes to Marshfield, Summit, Junction, Beaver Hill, Coquille, Johnsons, Schroeders, Norway, and Myrtle Point.

WITH THE TOAST AND TEA

GOOD EVENING. The art of life is to know how to enjoy little and endure much.

HAZLITT. The Optimist is tearful— He hopes for better days; He says the outlook's cheerful

Explaining our position. The Pessimist is happy. He laughs at everything. If life's unfair he doesn't care.

There are more kinds of shiftlessness than there are kinds of religion. Not one man in a hundred has sense enough to take care of money after he gets it.

EASTSIDE

For special bargains in Eastside Residence lots at "go as you please terms." See Title Guarantee and Abstract Company, H. Sengstacken, Manager.

Thanksgiving is Coming. We have everything you need for the table in the grocery line. That's our specialty.

C. W. WELCOTT THE FAMILY GROCER. PHONE 971. Front St. Marshfield.

NOTICE TO BIDDERS. Notice is hereby given that sealed bids will be received by the Common Council of the City of Marshfield, Coos County, Oregon, up to half past seven o'clock in the afternoon of Monday, November 30th, 1908.

EVERYBODY'S MAGAZINE. JUST OUT. This Christmas number is just one round of beauty, color, and good cheer.

NORTON and HANSON'S BOOK STORE. Masters and McLain General Contractor's Building Material and Beaver Hill Coal

Office: Broadway & Queen St. Phones 2011 - 826

NOTICE OF ANNUAL MUNICIPAL ELECTION OF THE CITY OF MARSHFIELD.

Notice is hereby given that on Tuesday, the first day of December, 1908, there will be held at the City Hall of the City of Marshfield, Coos County, Oregon, a regular general election, for the purpose of electing two members of the Common Council to serve for the term of three years each; for the purpose of electing one Recorder to serve for the period of one year; and for the purpose of submitting to the legal voters of said City for their approval or rejection an ordinance to amend Section 110 of the Charter of said City to increase the limit of indebtedness to five per cent of the assessed valuation of the property within the corporate limits of the City; and for the purpose of submitting to the legal voters of said City for their approval or rejection an ordinance to amend Subdivision 34 of Section 28 of the Charter of said City to authorize and empower the Common Council to issue and dispose of Bonds of said City not exceeding the sum of \$42,000.00 payable in not less than ten nor more than twenty years, with interest at the rate of five per cent, for the purpose of redeeming and paying off the warrant indebtedness of said City.

The said election will be held between the hours of nine o'clock A. M. and six o'clock P. M. That John C. Merchant, A. P. Owen, and R. C. Cordes have been heretofore by the Common Council of said City appointed as Judges of said election, and D. L. Rood, C. H. Marsh and George Farrin as Clerks of said election.

J. M. UPTON Recorder for City of Marshfield, Coos County, Oregon.

As a rule, people do not think as much of their ancestors as they think of their heirlooms. It is terribly hard to pursue such a course that it pleases both an old and a young person.

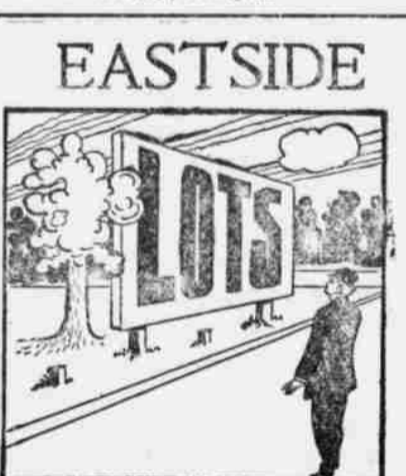

FRUIT CAKE and Plum Pudding at Corthell's. Bought a job lot of APPLES, for sale cheap while they last.—Anona Cash Grocery.

THANKSGIVING DINNER. Family Parties of 4 or More 75c per Plate. Single Dinners \$1.00. CORTHELL'S DELICATESSEN Phone 561.

Title Guarantee & Abstract Co. HENRY SENGSTACKEN, Manager

Thanksgiving is Coming. We have everything you need for the table in the grocery line. That's our specialty.

PARKSIDE POULTRY RANCH. Empire, Oregon. JOHN W. KING, Prop. Eggs from thoroughbred Buff Orpington chickens for sale \$1.50 to \$5.00 for setting of 15.

FINANCIAL

First Trust and Savings Bank \$100,000 Capital, Fully Paid STANDS FOR CONSERVATIVE BANKING Pays Interest on Time and Savings Deposits

The officers and the entire directorate are citizens of Marshfield and vicinity who own and control the capital stock—Whose every interest and success means the success of this community.— We solicit your business and accounts.

DIRECTORS. JOHN S. COKE, STEPHEN C. ROGERS, HENRY SENGSTACKEN, M. C. HORTON, WILLIAM GRIMES, JNO. F. HALL, W. S. CHANDLER, DR. C. W. TOWER, DORSEY KREITZER.

OFFICERS. JNO. S. COKE, President. DORSEY KREITZER, Cashier. M. C. HORTON, Vice President and Manager.

Flanagan & Bennett Bank

PAID UP CAPITAL AND UNDIVIDED PROFITS \$75,000. Does a general banking business and draws on the Bank of California, San Francisco, Cal.; First National Bank, Portland, Ore.; First National Bank, Roseburg, Ore.; Hanover National Bank, New York, N. M. Rothchild & Son, London, England.

INTEREST PAID ON TIME DEPOSITS

THE FIRST NATIONAL BANK OF COOS BAY

Strictly a Commercial Bank. The Corn Exchange National Bank, Chicago, Ill. Wells Fargo Nevada National Bank, San Francisco, Cal. The United States National Bank, Portland, Ore. The National Park Bank, New York, N. Y. The Bank of Scotland, London, England. The Credit Lyonnais, Paris, France.

STEAMERS

CALIFORNIA AND OREGON COAST STEAMSHIP COMPANY.

Steamer Alliance. B. W. OLSON, Master. COOS BAY AND PORTLAND. SAILS FROM PORTLAND SATURDAYS, 8 P. M. SAILS FROM COOS BAY TUESDAYS, AT SERVICE OF TIDE.

Portland & Coos Bay S. S. Line

S. S. BREAKWATER. Sails from Portland Wednesday at 8 p. m. Sails from Coos Bay Saturdays at Service of Tide. S. S. CZARINA. SAILING BETWEEN SAN FRANCISCO AND COOS BAY, CARRYING FREIGHT AND COMBUSTIBLES ONLY.

Steamer M. F. Plant

SAILS FROM SAN FRANCISCO, AT 2 P. M. EVERY TUESDAY FROM COOS BAY EVERY FRIDAY AT SERVICE OF THE TIDE. No reservation held after the arrival of the ship unless ticket is bought.

F. S. DOW, Agent

Steamer Wilhelmina

LUDVIG CHRISTENSEN, Master. Sailing for Bandon every Monday. For full information, apply Chas Thom owner, or H. W. Skinner, agent.

"ALERT"

Captain C. E. Edwards. Time-Table. Leaves Allegany, daily at 7 a. m. Returning—Leaves Marshfield 2 p. m.

STEAMER FAVORITE

Two trips daily between Bandon and Coquille connecting with all Marshfield trains. Leaves Bandon . . . 6:45 a. m. Leaves Bandon . . . 1:20 p. m. Leaves Coquille . . . 9:15 a. m. Leaves Coquille . . . 4:00 p. m.

COQUILLE RIVER TRANSPORTATION CO.

HIGH GRADE MEATS

The odor of good roast beef however appetizing, can only be suggestive of the delicious taste and flavor that goes with every piece of meat we sell. All our meats are the choicest we can produce.

Business Directory

- Doctors. D. R. E. GOLDEN, Physician and Surgeon. D. R. A. C. BURROUGHS, Homeopathic Physician. D. R. GEORGE W. LESLIE, Osteopathic Physician. D. R. GEO. E. DIX, Physician and Surgeon. D. R. J. W. INGRAM, Physician and Surgeon. D. R. A. L. HOUSEWORTH, Physician and Surgeon. MRS. NETTIE HOVEL, Midwife. Lawyers. CLARKE, BLAKE & LILJEQVIST, ATTORNEYS-AT-LAW. J. W. RENNETT, Office over Flanagan & Bennett Bank. COKE & COKE, Attorneys at Law. Miscellaneous. W. S. TURPEN, Architect. MARSHFIELD TURKISH BATHS. CRIBBS & MASON, Photographers. HOTELS. The LATTIN Hotel. MARSHFIELD HOTEL. Steamer Flyer.