

# Madras Potatoes Are Top Liners

## SPECIAL ON DINERS

Great Northern Writes To Commercial Club About Large Potatoes

That the fame of the products of the "Madras Country" in Northern Crook County is becoming spread far and wide is evidenced by a communication from the dining car service of the Northern Pacific, to the Madras Commercial Club. The attention of President John F. Stevens of the Oregon Trunk was called to the display of vegetables in the Commercial Club rooms at the time he and his party were in Madras last month, and the size of the potatoes immediately attracted his attention, with the result that the Madras potatoes will be advertised as a special on the dining cars of the Northern Pacific.

The following letter was received by the Madras Commercial Club in regard to large potatoes:

### Northern Pacific Railway

Seattle, Wash., Feb. 25, 1911. Mr. W. F. Hammer, President Commercial Club, Madras, Oregon. Dear Sir: I am in receipt of communication from President John F. Stevens of the S. P. & S. Ry. Co., in which he advises that you will perhaps be able to give me some information relative to our securing some extra large potatoes, such as we serve on our diners.

Would it be asking too much of you, if you would kindly put me into communication with the proper parties of your city to correspond with regarding supply. The potato we supply must have an individual weight of two pounds each.

Thanking you in advance for any assistance you may render, and assuring you that if we are able to make purchase in your city, that we shall be more than glad to give credit where credit is due. I presume we are asked no less than 500 times a day what section or town potatoes come from that we are serving.

Yours very truly,  
H. J. Titus,  
Superintendent Diner Service.

The potatoes grown in Northern Crook County are not exceeded in quality by those grown in any other locality, and it is a question whether they can be beaten by any locality in either size or amount of productions per acre. Heretofore potatoes have been raised in only limited quantities owing to no transportation facilities, but now that there is adequate transportation this industry will rapidly grow in volume and be one of the best paying crops in this section.

### MADRAS FLOUR MILL EXPORTS

The Madras Milling Company made their first exportation of flour to outside points Monday, the shipment going to Porter Bros.' construction camp near Moody. There were 50 barrels contained in this shipment.

The Oregon Trunk is finding it somewhat difficult to handle all of the freight offered for shipment at this time, as the road up until March 1 will be in the hands of the contractors, but outgoing freight and stock shipments were given all the facilities possible. Traveling Freight and Passenger Agent P. F. Harding is spending several days in Madras to give these matters his special attention.

# Farm and Garden

## TRACTION PLOW MAKES GOOD

Saves Time, Money and Horses and is Gaining Ground Rapidly.

The traction plow saves time, money and horses. It is steadily gaining ground on its merits. Rapidly it is downing the prejudice that has led farmers unacquainted with its power to assume that it is impracticable in the average field. Its real worth is asserting itself convincingly in actual work. Where it has been given adequate opportunity to become a part of the regular farm equipment and to fall in line with the regular routine work of the season it has made itself indispensable, says the Breeder's Gazette.

Men used to say that such an implement was a preposterous impossibility in the small field. It would take half the field to turn around in. The work of turning up its rough job of work would cost more than to do the whole thing with horses. Reasoning stubbornly in this vein, some farmers still argue to themselves that the four horse gang plow is too big for them to use. Holding close to their mind's eye the thought of the slow turning and the dog eared corners, the outside strip and the dead furrows to be finished with the small plow, they blind themselves to the machine's accomplishments. Perhaps an hour may be lost in dragging the single plow about in plowing out the corners, but what is that compared with the days and days saved in covering the bulk of the field?



Photo by American Press Association. ENGLISH STEAM PLOW.

Good Land Going to Waste. Kansas farmers are wasting hundreds of thousands of dollars' worth of good land, according to J. B. Koontz, general freight agent of the Santa Fe. Along the line of his road, Mr. Koontz says, there are 25,000 acres of land covered with useless straw stacks. Mr. Koontz figures that if the ground occupied by the straw was sown to wheat every year the yield on a fifteen bushel average would be 375,000 bushels. At 90 cents a bushel the crop from the stock area alone would bring \$337,500.

Humus is a necessary element of fertile soil. The best way to put it into the soil is to follow the system of crop rotation which shall include clover or alfalfa. In addition to this all the stable manure should be put back on to the soil and a liberal supply of straw should be used in bedding, to save the liquid manure.

### Dairy Doings.

While bran can be used with a decided advantage in making up the rations of the dairy cows, it should not be used to excess, as it will make the cream hard to churn, while the butter will be pale rather than a golden yellow.

The purchaser of a bull should select an animal that is a good individual and whose dam and grandam on his sire's side have good butter fat records. His sire must, of course, show the characteristics of the good dairy type.

Many of the Maine farmers who gave up cows and went into potato growing a few years ago are coming back to cow keeping. A testing outfit does not cost much, and it pays dividends. A cow that is merely boarding will eat as much as one producing a profit, and the only way to distinguish between the two is through the use of the Babcock test and the scales.

A farmer who has been traveling in Switzerland and Germany noticed that cows were used quite commonly for drawing loads or plowing on the little farms of those countries. He found that the cows could be worked to a moderate extent without much reducing their milk yield, and he suggests that the idea might be practical for small farmers in other countries.

The rule for feeding grain in the University of Wisconsin experiment station dairy herd is to give as many pounds of grain as the cow produces pounds of butter fat per week. Underfeeding is as wasteful as over-feeding.

# MADRAS, The Gateway To Central Oregon DEPOT ADDITION, The GATE TO MADRAS

Madras Will Make the LARGEST City In Central Oregon! Conditions Have Made It So

- 1st. It has a good many times the farming acreage.
- 2nd. A 3-4 Circle must come through Madras to make other points.
- 3rd. Coal within 10 miles, Gold mines in 15 miles and Timber 15 miles.
- 4th. Good project of irrigation of 75,000 to 100,000 acres of land.
- 5th. Two main lines of R. R. and possible spur of another.
- 6th. New City Water, Flour mill, Churches and a School system hard to beat anywhere.
- 7th. These conditions should guarantee a city of

10,000 people in TEN years. 8th. Madras has N-E-V-E-R been boomed, lots being CHEAPER than other places of the Deschutes. We Look for lots to DOUBLE in value in 60 to 90 days.

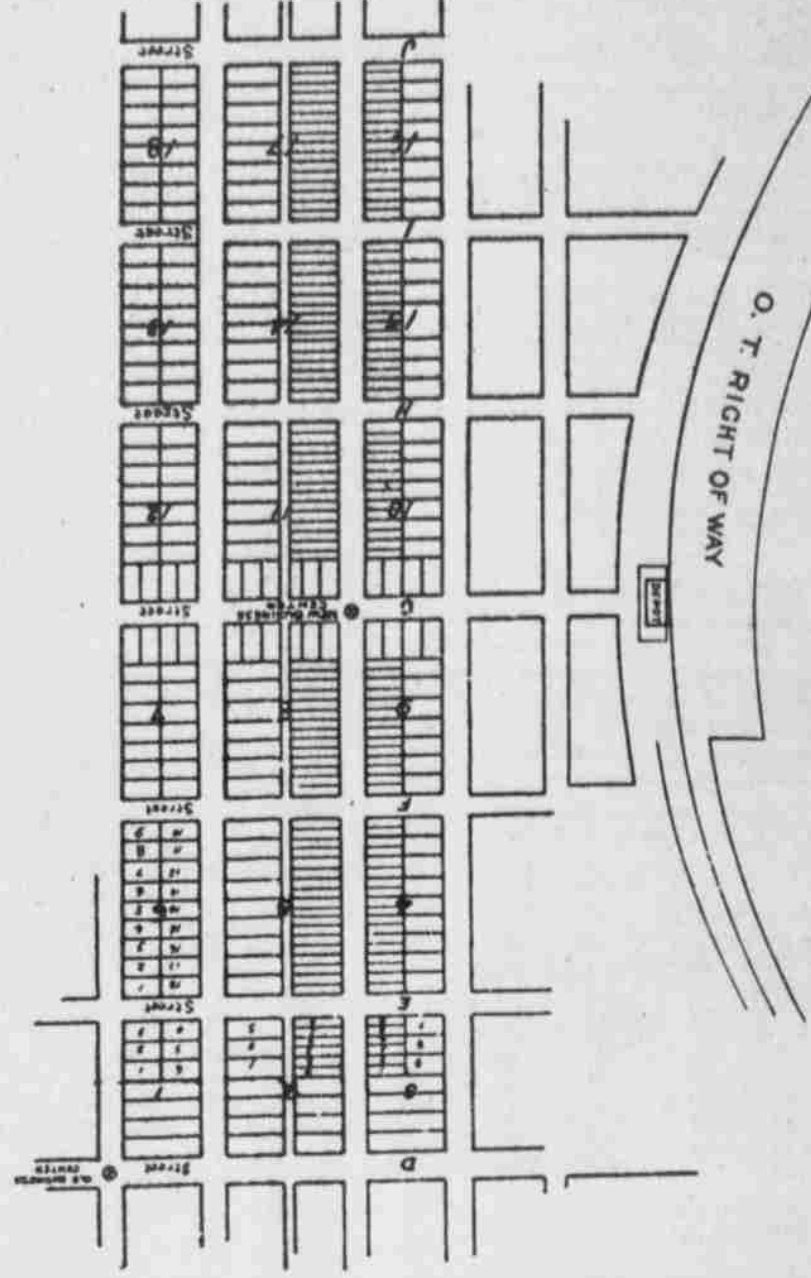

Depot Addition  
The Best Of  
MADRAS

Why not buy in Depot Addition where lots are selling from 25 to 50 per cent. of adjoining lots. Prices

\$50.00  
To  
\$250.00

Per Lot.  
Terms: 1-5 Cash Balance in EQUEAL Payments of 3, 6, 9 and 12 Months.

We are selling our lots in MADRAS and not in all parts of the GLOBE, nor are we paying the large Commissions, giving purchasers the benefit.

Our office will be on the grounds at the corner of 3d & "G" Streets,  
The New Business Center  
WM. H. LANCASTER COMPANY

**Scott E. Gordon**  
CIVIL ENGINEER  
AND SURVEYOR  
Madras, Oregon  
Property Lines Run  
Townsite Surveying  
City Work, Maps, Plans,  
Estimates, Etc.

Unanimous Anyway.  
Hi Tragedy—Yes, we opened in Oshkosh.  
Lowe Comerdy—And what did your audience think of your Hamlet?  
Hi Tragedy—Why—er—he went out before I had a chance to ask him—Catholic Standard and Times.  
Charity.  
"Thank heaven, I never have had to depend on charity for anything."  
"Are you sure of that? It seems to me the people who put up with your manners must have to project a good deal of charity in your direction."  
Chicago Record-Herald.

**Warren Smith**  
PROPRIETOR  
Elite Tonsorial Parlors  
NO LONG WAITS  
**BATHS**  
MADRAS, ORE.

**MADRAS Well Drilling**  
ARTESIAN AND SURFACE WELLS  
DEPTH GUARANTEED  
ESTIMATES FURNISHED  
INQUIRE AT PIONEER OFFICE  
MADRAS, OREGON

**COLONIST FARES**  
From the middle and Eastern portions of the United States and Canada to  
OREGON, WASHINGTON & NORTHWEST  
WILL PREVAIL DAILY  
March 10 To April 10  
OVER THE  
**Oregon-Washington Railroad Navigation Co.**  
and connections, the  
**Oregon Short Line, Oregon Pacific and Chicago & North-Western**

**You Can Prepay Fares**  
The Colonist fares are Westbound only, but if you have relatives or friends or employees in the East whom you desire to bring to this state you can deposit the value of the fare with your local railroad agent, and an order for a ticket will be telegraphed to any address desired.  
**Let The World Know**  
Of our vast resources and splendid opportunities for  
**HOME BUILDING**  
Call on the undersigned for good instructive printed matter to send East, or give him the addresses of those to whom you would like to have such matter sent.  
**WM. McMURRAY**  
General Passenger Agent  
PORTLAND, OREGON

**Notice**  
Notice is hereby given that we, Douglas Hood and G. V. Stanton, copartners, doing business under the firm name and style of Hood & Stanton, will, for the purpose of enforcing our lien for feeding and caring for the stallion hereinafter described, sell a public auction, on the 2nd day of March 1911, at the hour of 2 o'clock in the afternoon of said day, at the front door of the livery and feed barn of Hood & Stanton, in the City of Madras, Crook County, Oregon, one black Belgian stallion, about 4 years old, weight about 2,000 pounds, a med Piston De Avenas, which stallion was formerly owned by the Madras Black Belgian Horse Company, and which said stallion was delivered into our custody and care during May, 1910, by the owners and lawful possessors thereof, to feed and care for said stallion. And that our charges for furnishing grain, feed and hay for said stallion and for our work and labor in taking care of the aforesaid stallion from May 1st, 1910, and until March 2, 1911, are of the just and reasonable value of \$294.60, no part of which has been paid, although more than three months have expired after the grain, hay and feed was furnished and the labor and care bestowed. That the money realized from the sale of the above described stallion will be first applied to the payment of our lien for furnishing feed, grain and hay for said stallion and for work and labor in caring for same in the total amount of \$294.60 and the costs and expenses of this sale, the balance of selling price, if any, will be disposed of according to law.  
Dated at Madras, Crook County, Oregon, this 2nd day of February, 1911.  
Douglas Hood,  
G. V. Stanton.  
Doing business as Hood & Stanton.  
E. Bergland,  
Attorney for Hood & Stanton.

**For Good Farms**  
City Property and Business Chances  
**SEE D. W. BARNETT**  
OFFICE MAIN STREET, MADRAS, OREGON  
Also local agent for Depot Addition to Madras and the new town of Metolius. Prices right.

**BLACKSMITH**  
HORSESHOEING  
General Repair  
West of Hood & Stanton's  
**THOS. H. MADRAS**  
Madras, Oregon

**FIRE INSURANCE**  
Insure your town property, farm buildings including your threshed grain in your granaries and in warehouses against FIRE.  
**"Old Line"**  
Strictly Reliable Companies  
Sun Insurance Co., London  
St. Paul Fire and Marine of St. Paul.  
Norwich Union Fire Insurance Society.  
Liverpool and London and Globe Insurance Company  
Rates on application.  
**HOWARD W. TURNER, AGT**

**E. CROSBY**  
EVERYTHING IN  
PRINTING & KODAK  
E. DALLES, OREGON  
Exclusive Agent For  
**AN**  
P. O. Box  
N. Y.  
Photography  
Always printing  
orders  
our  
tion.  
new  
LOG  
Mur-  
Devel-  
FOR SALE—At the Pioneer  
Level Blanks of all kinds,  
and Typewriter paper, 100  
Sale contracts, Notes and Rec