

# METRO *Life*

The Portland Observer

SECTION B

## Community Calendar

### Animal Control looks to create fundraising

Responding to the funding cutbacks forced by measure 47, officials from Multnomah County Animal Control are putting together a "Friends of the Shelter" group which they hope will be able to find available dollars in the community to continue services. Although not an aggressive fund-raising group, it is hoped that this group will be able to take advantage of funding opportunities typically unavailable to government agencies.

### East County Meeting on Traffic Concerns

On April 17 at 6:30 p.m. there will be a four cities meeting at Gresham City Hall, 1333 N.W. Eastman Parkway, to address the impending closure of the 238th Avenue/Interstate 84 Interchange by the Oregon Department Of Transportation. There is great public concern about the project and some East County officials predict traffic failures, as the 207th Avenue Connector will not be completed before the closure of 238th. For those unable to attend in person, the meeting will be televised on Multnomah County Cable Access (Paragon cable, channel 30).

### County, Portland to Further Discuss Consolidation

The Multnomah County Board of Commissioners and the Portland City Council will meet for a second joint briefing on the subject of City/County consolidation on April 22nd, 3:00-5:00 p.m. in the Portland Building, second floor auditorium. Topics to be addressed include potential short term service consolidations, legal and legislative issues regarding existing consolidation laws, review of a draft resolution pledging support for consolidation, and the parameters of the proposed consolidation threshold study.

### Alice in Wonderland

1,000 Children Laughing and Applauding Strange Creatures From Wonderland!

4,000 Portland area school children will have an opportunity to experience a live ballet performance thanks to four special school-day performances of Metro Dancers production of Alice in Wonderland. The full-length ballet is being presented to the general public by Metro Dancers April 26, 1997 at the Portland Center for the Performing Arts. The special school-day performances will be held on Thursday and Friday, April 24th and 25th. Contact Nancy Thompson for more information at 823-3660.

### American Institute of Graphic Arts Exhibition

The Portland chapter of the American Institute of Graphic Arts has organized a traveling exhibit that will be shown at the Portland Community College Northview Gallery. The gallery is located on the Sylvania Campus, 12000 S.W. 49th Avenue, on the second level of the GT building. There will be an opening reception on April 10 from 6 to 8pm at the gallery.

### Starting a business?

Portland State University's Business Outreach Center and Sabin Community Development Corporation will sponsor a "Going Into Business" seminar. The two session workshop will be held on April 23 and 30 from 7pm to 9:30pm. There will be a \$10 charge to cover the cost of the materials for the workshops. Participants must attend both sessions. To register for the seminar, or if you have any questions, call Eric Beene at Sabin CDC at 287-3496. The class size is limited, so register as soon as possible.

**SUBMISSIONS:** Community Calendar information will be given priority if dated two weeks before the event date.

## Packy's Birthday Party

Portland's famous elephant, Packy, will celebrate his 35th birthday at Metro Washington Park Zoo on Saturday, April 12. Party hours are 11 am to 3 pm.

Party-goers can wear floppy elephant ears, sign Packy's giant birthday card and dance the Packy Shuffle. Youngsters can meet costumed characters Eliza and Elliot Elephant, and Allegra, preschool puppet girl on the Nickelodeon Channel. There will be games, music and birthday cake for all. Emcees for the big bash will be personalities from 97.1 KISN FM.

After Packy has finished his "special" cake, everyone is invited to stop by Albertsons' canopy for a piece of the "people" cake. The 4'x8' masterpiece is created each year by Albertsons Food Stores.

Packy's birthday party is sponsored by TCI Cablevision, 97.1 KISN FM, TV Host Magazine, Southwest Airlines and Albertsons Food Stores.

Packy was the first elephant born in the Western Hemisphere in 44 years. His birth on April 14, 1962 made international news and the City of Portland went wild. Packy was named by Gresham resident Wayne W. French whose entry was the winner in a radio station naming contest.

Packy is one of the largest Asian elephants in the United States; he stands 10'3" at the shoulder and tips the scales at 14,350 pounds. He is the father of seven calves. Asian elephants are an endangered species.

Admission to the event is free with regular zoo admission. Tri-Met buses #59 and #63 serve the zoo. Parking is limited, shuttle buses will operate.

Washington Park Zoo's celebrity elephant, Packy, turns 35 on Saturday, April 12.

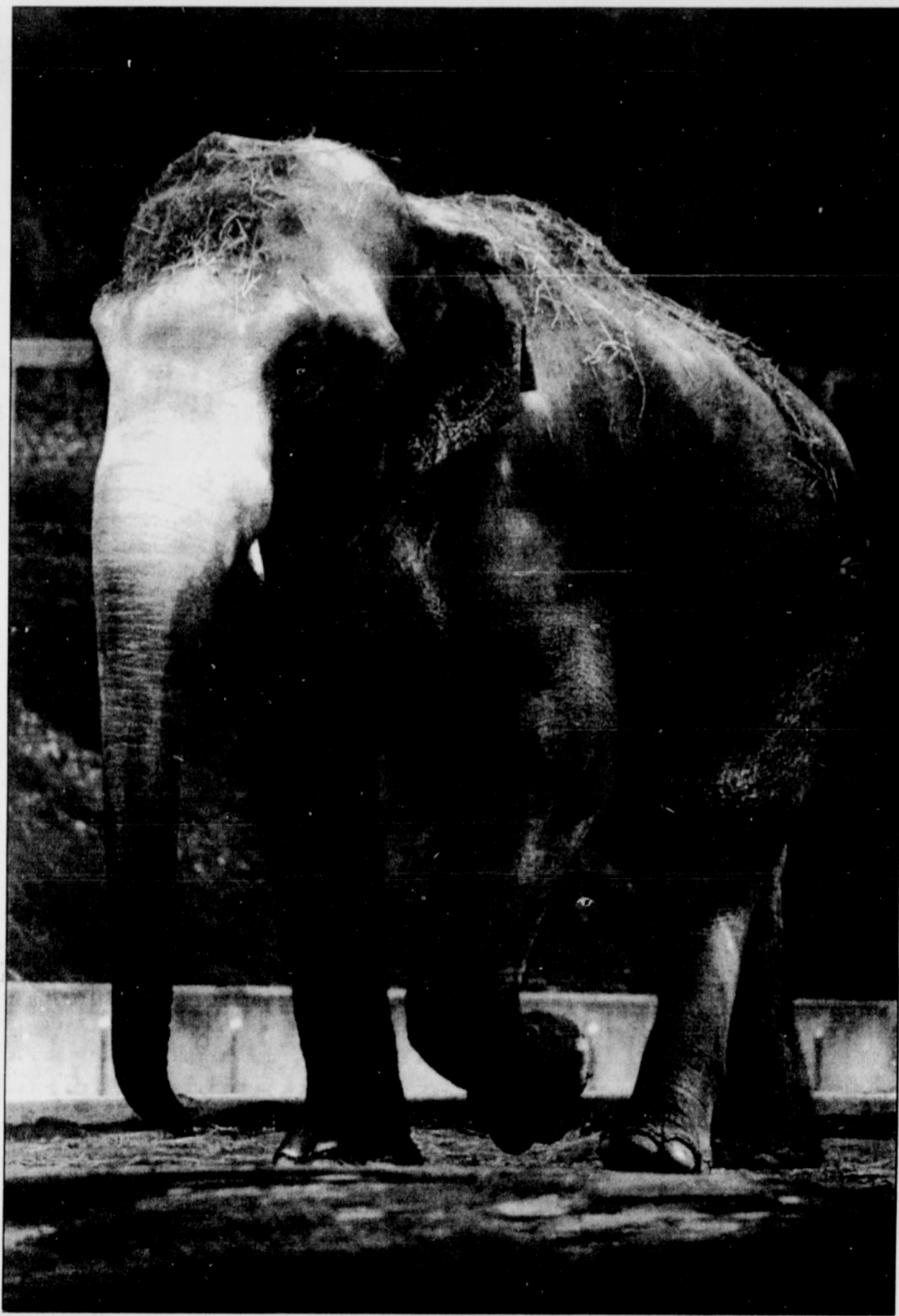

## Developer plans innovative housing project



BY LEE PERLMAN

Developer James Winkler plans to build 42 row houses such as those pictured above.

Winkler's row houses will be located in the interior of the block bounded by Northeast Martin Luther King Jr. Boulevard, Seventh Avenue, and Knott and Russell streets. The 12,000 square foot, two-bedroom units should sell for \$125-130,000 apiece, he says.

The project will have an s-shaped "woonerf," a European pedestrian road that allows auto access but is designed to discourage through traffic (right).

Winkler hopes to complete the project by the end of the year.

He also holds an option to develop the western end of the block, most recently occupied by a storage facility before it was gutted by a fire last year.

## Earthquake Brochures

The Portland Bureau of Fire, Rescue and Emergency Services is offering earthquake emergency preparedness brochures to provide for the diverse populations in our city. Aside from English, there are translations in Cambodian, Chinese, Hmong, Lao, Mien, Romanian, Russian, Spanish and Vietnamese. If neighborhood associations, business associations, citizen organizations, churches, or individual citizens may request any of these brochures. The brochures offer basic information on what to do before, during and after an earthquake; how to shut off gas and water valves; and basically secure your home. Along with the brochures in various languages, there is a two-sided printed sheet in the diverse languages of the city's communities.

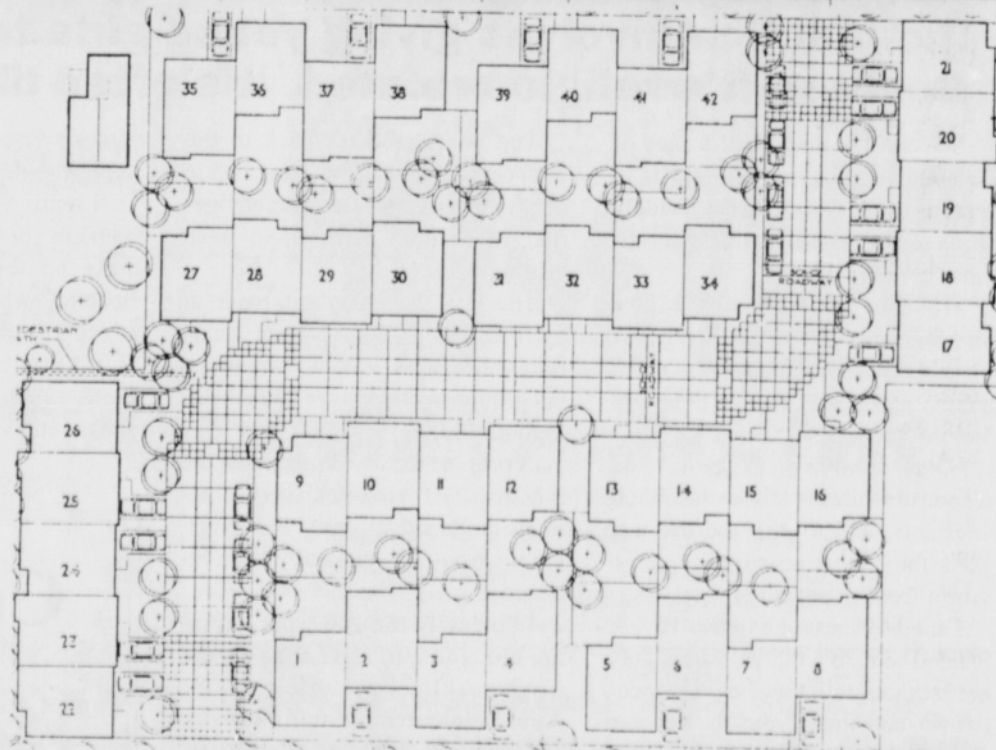

## "Smithsonian Voices of Discovery" Lectures

Smithsonian scholars will present public lectures on American musical theater, American ceramics, and the environment at Lewis & Clark College as part of the "Smithsonian Voices of Discovery" speakers' program.

This is an unprecedented series of public programs showcasing the extensive knowledge of Smithsonian scholars.

All three events begin at 7:30 p.m. in the

Council Chamber, Templeton Student Center, Lewis & Clark College, 6015 SW Palatine Hill Road. All lectures are free.

• **Friday, April 11, "Fifty Years of American Ceramics: 1945-1995,"** by Kenneth Trapp, curator-in-charge of the Renwick Gallery, the National Museum of American Art.

• **Saturday, April 12, "How Native Ecosystems Respond to Climate Change and Rising CO2,"** by Bert Drake, staff scientist

studying plant physiology and ecology at the Smithsonian Environmental Research Center

• **Monday, April 14, "Another Op'nin', Another Show: The American Musical Theater,"** by Dwight Bowers, historian in the Division of Cultural History at the National Museum of American History. The lecture is co-hosted by the Dr. Robert B. Pamplin, Jr., Society of Fellows.

The Smithsonian designed the lecture

series in conjunction with the "America's Smithsonian," a 300-object traveling exhibition at the Portland Expo Center, April 3 to May 6.

The "Smithsonian Voices of Discovery" is made possible with support from the Rose E. Tucker Charitable Trust.

To reach Lewis & Clark College, take the Terwilliger Exit off of I-5 and follow the signs. For more information, call (503)768-7963.