

FALSITY OF GRAFT CHARGE CONFESSED

Story Reflecting on County Commissioner Holman Is Traced to Source.

TALE STARTS IN BARROOM

William E. Reupell Makes Affidavit Saying Statement of Dividing Alleged Ill-Gotten Sum Made Without Cause.

A scurrilous story reflecting on the official and private record of Rufus C. Holman, chairman of the Board of County Commissioners, was run to earth yesterday through the combined efforts of various county officials and discovered to be nothing more than the idle vaporing of a narrow discussion and the child of a man's imagination.

William E. Reupell, the man who originated the story, when confronted by Mr. Holman, readily confessed that he had no cause whatever to make any such statement and signed an affidavit to that effect.

The District Attorney at once consulted Holman and he heard the story from Reupell and repeated it to various persons, also made affidavit that there was no foundation whatever for the statements and that he had no knowledge of anything reflecting on Mr. Holman.

The story in effect was that Reupell had sold an order of rope to the county for \$350, that he had not delivered the rope, but that the county had paid him for it and that he had paid Mr. Holman \$100 from his \$350 net revenue.

BOY SMOKERS PROVE AGES

One, Who is Only 19, Has His Case Put Over and Is Released.

Five boys proved that they were less than two months past 21 years of age when they were arraigned in Municipal Court yesterday by Patrolman Maxwell, who found them smoking cigarettes at Fourth and Stark streets.

SELLWOOD TO CELEBRATE

Thursday Set as Second Anniversary Entertainment This Year.

Sellwood Commercial Club will celebrate its second anniversary Thursday.

MAP SHOWING APPROXIMATE RATINGS OF COST OF HARDSURFACING PAVING TO BE CONSTRUCTED IN MULTNOMAH COUNTY THIS SUMMER

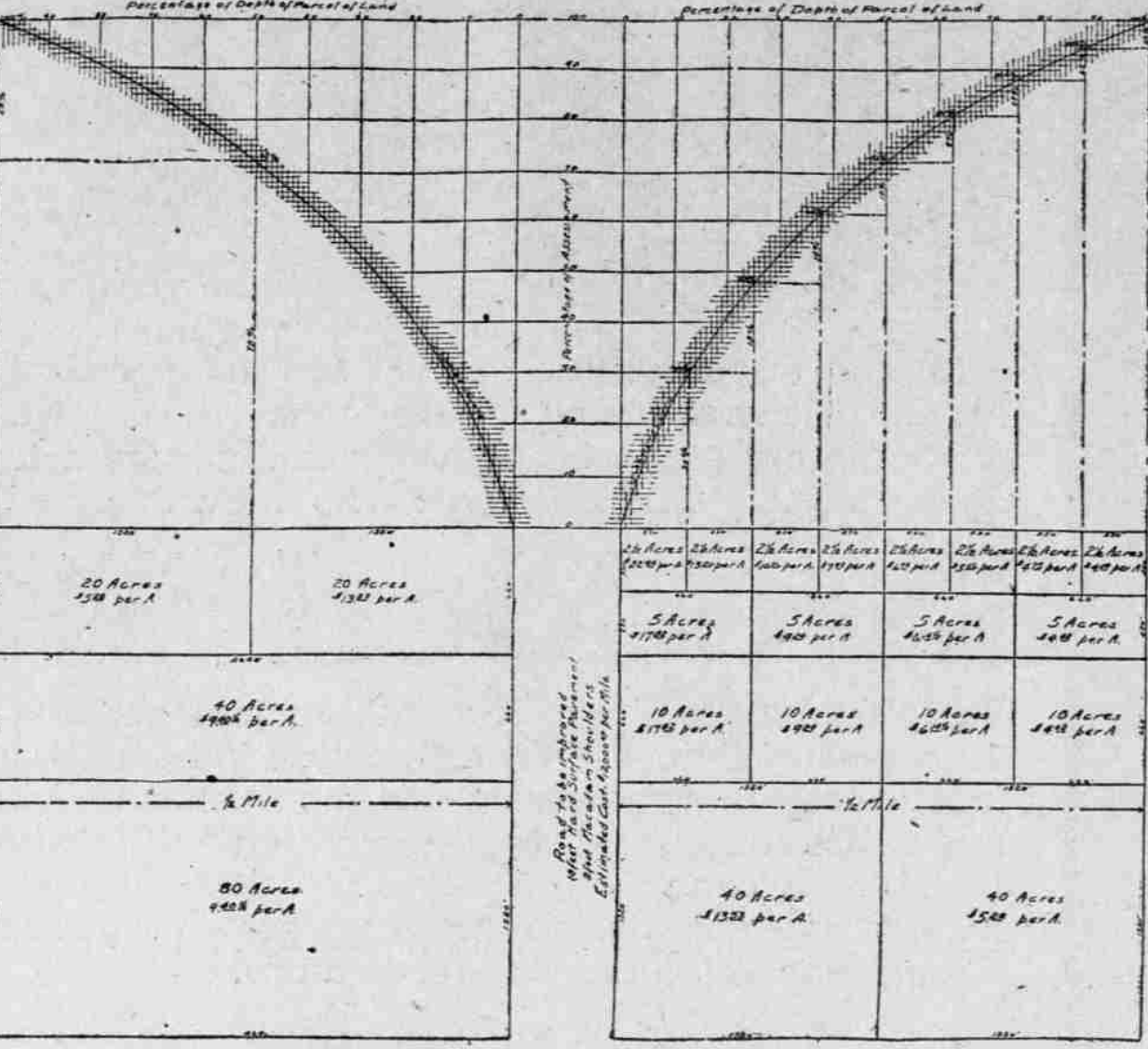

SYSTEM OF CURVE BENEFIT ADOPTED BY COMMISSIONERS AND ROADMASTER YEON.

'BLUE SKY' ATTACKED

Local and Foreign Corporations Assail Law.

MANY ALLEGATIONS MADE

Infringement of Constitutional Rights Is Charged in Addition to Unduly Severe Punishment for Violators.

State of Oregon, County of Multnomah, vs. J. Y. Calahan, et al.

Three Corporations Plaintiffs.

Specific 'Violations' Noted.

It is charged that the act violates constitutions of the United States and the state of Oregon in several particulars:

(1) Violates the Oregon constitutional provision that an 'act shall embrace a single subject, and matters properly connected therewith, which subject shall be expressed in the title.'

SOMERS MAPS TO AID

Rate of Assessment to Be Explained by Official.

ACREAGE FIGURES COST

Mile of Road Work Will Run Up to \$12,000, of Which Amount County Pays Half and Property Owners Other Half.

J. Y. CALAHAN IS VISITOR

Nickle Plate Official Expresses Sorrow at Death of Mr. Sebastian.

John Y. Calahan, of Chicago, assistant general passenger agent of the Nickel Plate Railroad, was in Portland yesterday and called on his numerous friends here.

NEW BUSINESS IS SOUGHT

O.-W. R. & N. Co. Will Canvass Willamette Valley Territory.

A more aggressive campaign for both freight and passenger business is to be waged by the O.-W. R. & N. Co. in the Willamette Valley.

WORLD WORKER FOR W. C. T. U. VISITS PORTLAND.



Miss Lucy Broad.

Miss Lucy Broad, world worker in the W. C. T. U. movement, who made her first lecture appearance in this vicinity on her present tour, at the Gresham Church Sunday, will speak in various churches of Portland this week.

and a passenger solicitor will cover the Western Oregon territory between Portland and Ashland.

SOMERS MAPS TO AID

Rate of Assessment to Be Explained by Official.

ACREAGE FIGURES COST

Mile of Road Work Will Run Up to \$12,000, of Which Amount County Pays Half and Property Owners Other Half.

To meet the many requests for information as to the cost to the property owners of the hard-surfacing of roads, Assistant Roadmaster McMullen has prepared maps which will be distributed to organizations showing rate of assessment under the Somers system of curve benefits, which has been adopted for all assessments for hard-surfacing in Multnomah County.

Mr. Calahan was greatly grieved yesterday to learn of the death of John Sebastian, the veteran head of the Rock Island passenger department.

An accurate estimate of the cost to any taxpayer of hard-surfacing any road can be obtained by determining, first, the number of acres in each unit or zone, and applying the rate as indicated on the map.

The percentage figures are derived from a parabolic curve, which has been determined after a study of a large number of cases and public improvements of almost every nature.

Five hundred dollars is the price of the Ford runabout; the touring car is five fifty; the town car seven fifty—f.o.b. Detroit, complete with equipment.

Headquarters for Boys' and Children's Apparel of All Kinds. Portland Agents for Children's "Pony" and "Buster Brown" Hosiery. Olds, Wortman & King. Store Hours—9 to 6 Daily, Including Saturday.

Double Stamps

With Cash Purchases in All Departments Today

The Best Made Suit in "Boy"-dom That's "Right-Posture"

The Fine Sturdy Lines of the Coat—the Athletic Shoulder and Waist—Make a KEEN APPEAL to Mr. America Junior. EVERY button put on to stay—every seam reinforced—every stitch silk! "Right Posture" Clothes are built by skillful workers with special attention to every little detail of finish.



Boys' New Spring Top Coats

Main Floor—Made to our special order from extra good quality wool serge. Nicely tailored throughout. Pants peg top with double taped seams. Handsome Norfolk models in all sizes 6 to 18 yrs. Spl. \$5.00

Children's Wash Suits, \$1.50 to \$5

Main Floor—In selecting the Children's Wash Suits here you are sure to get the very latest effects, for our entire stock is new and fresh. Full line of popular fabrics beautifully made.

Knit Underwear and Hosiery

Center Circle, First Floor—Women's 50c Silk Lisle Hose in plain black or split foot, double heel and toe. 3 pairs for \$1.00

Spring Sale Garden Tools, Paints, Etc.—3d Flr.

Center Circle, First Floor—Women's \$3.50 Italian Silks Knickerbockers in colors only. On sale today at \$2.69

Go East Through the Canadian Rockies

The Canadian Pacific Railway, flung across five hundred miles of titanic Mountain Ranges, exhibits from its railroad observation cars unparalleled panoramas of precipitous canyons, glaciers, forests and snow-capped Alps. It takes you Over the Roof of America.

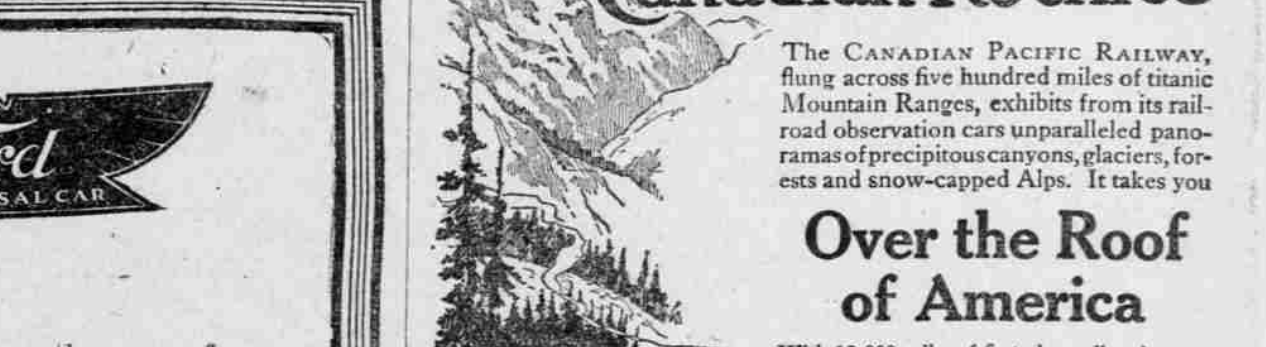

With 18,000 miles of first class railroad across the American Continent (all steel bridges—no trestles), and with superb steamship fleets on two oceans, the CANADIAN PACIFIC RAILWAY has grown to be the greatest transportation system in the world. In the Canadian Rockies it opens up Fifty Switzerlands in One.