

# SECOND PLAT OF Laurelhurst

The Addition with Character

# PLAT BLOCKS 44 TO 67 INCLUSIVE AND BLOCK 'C' Laurelhurst

SITUATED IN THE E.B. DAVIDSON D.L.C.  
IN SEC. 36 T.19 N. 1 E. W.M. & SEC. 31 T.19 N. 2 E. W.M.

HERE IS THE GREATEST  
BUY IN HOME PROPERTY  
EVER OFFERED IN PORTLAND

Highly Improved and Restricted Residence  
Lots as Cheap as the Non-Improved  
Kind and on Terms Just as Easy

LOTS \$600, UP  
AND WITH EVERY IMPROVEMENT

Asphalt Streets From 28 to 48 Feet Wide, 6-Foot Cement Walks,  
9-Foot Parking Strips, Handsome Cluster Lights, Shade Trees  
15 to 20 Feet High, Water, Sewer, Gas, Electric Lights, Etc.

THESE PRICES WILL BE FOR A SHORT  
TIME ONLY AND WE WILL THEN AD-  
VANCE THEM TO WHERE THEY BELONG

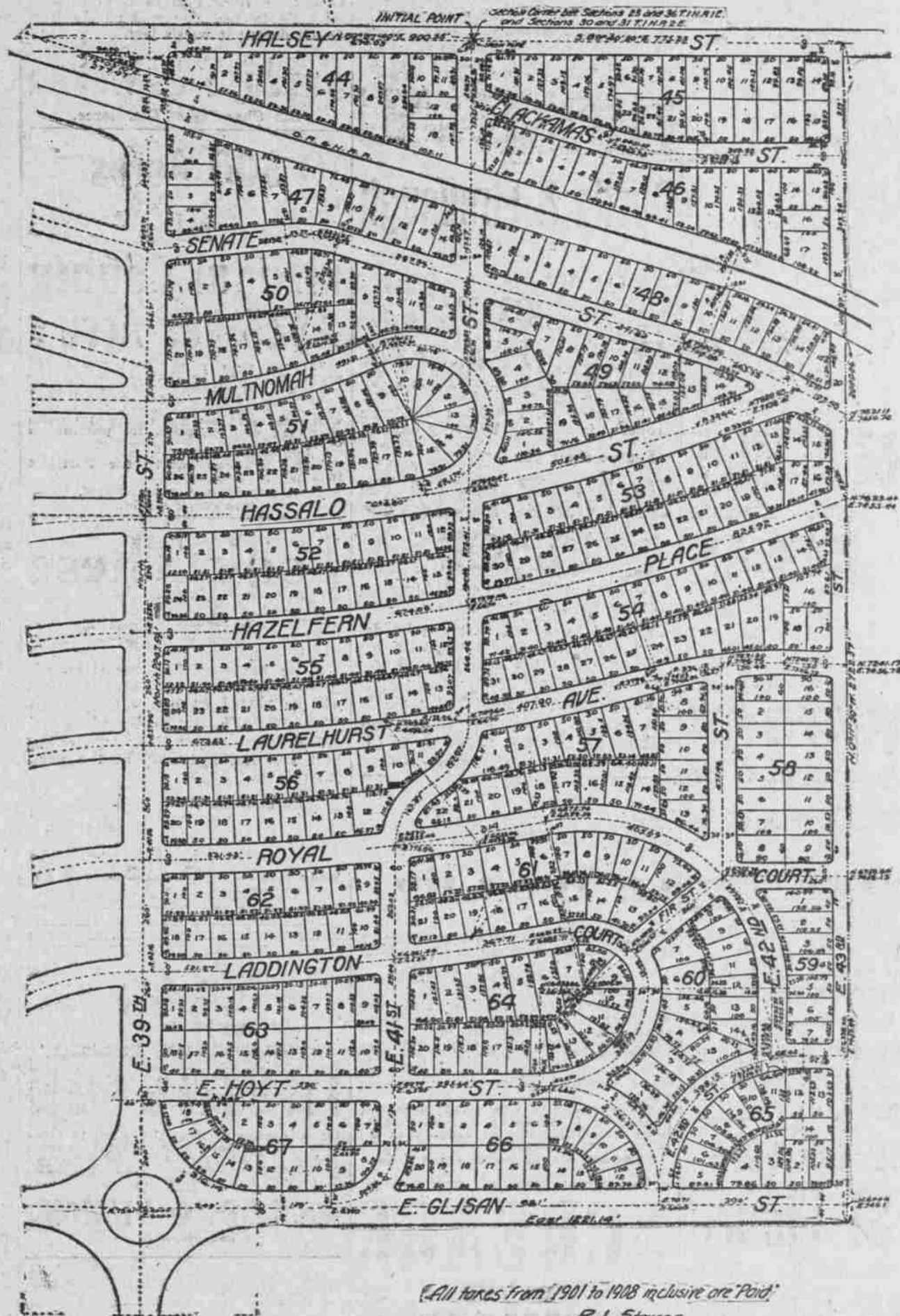

Compare the Following Prices With Prices of Lots in Other Additions—  
Compare Laurelhurst With Other Additions

Never in the History of Portland Have High-Class Residence Lots Been Offered at Such Prices—They Never Will Be Again—We Make Them Now to Open Up Our New Plats of Laurelhurst—Watch Tomorrow's Papers for the Other Plat—Our First Section of Laurelhurst Is Practically Sold Out

## READ THESE PRICES

Lot 11, in block 49, size 53x 88.....	\$600.00	Lot 15, in block 49, size 49x 88.....	\$625.00
Lot 12, in block 49, size 75x 88.....	\$600.00	Lots 16 and 17, in block 49, size 51x88, each.....	\$625.00
Lot 13, in block 49, size 50x113.....	\$675.00	Lot 14, in block 54, size 50x100.....	\$650.00
Lot 7, in block 49, size 50x126.....	\$650.00	Lot 15, in block 54, size 62x108.....	\$625.00

16 Lots Ranging in Size From 50x100 to 50x120 at \$650—22 Lots Ranging From 50x100 to 65x130 at \$675 and Others for a Short Time at Corresponding Prices, for Lots in the Closest-in, Most Highly Improved Residence District of Portland

**AUTHORIZED BROKERS**  
Charles K. Henry & Co.  
Wakefield, Fries & Co.  
Geo. D. Schank,  
H. P. Palmer-Jones Co.  
Holmes & Menefee  
Mall & Von Horstel.  
Yonkie & Rountree.  
R. F. Ryan & Co.  
Frick-Dodds Co.  
Ruff-Kleinsoerge Land Co.  
Dubois & Crockett Realty Co.  
Chapin & Herlow.  
Hans & Ringler.

Take Montavilla or Rose City Park cars direct to the property. Both lines run to and through Laurelhurst. Or phone us what day and hour to call and we will show you the property in our autos. Deal with any of our authorized agents if you prefer.

**Salem, Or., Agent**  
A. N. MOORES  
1 and 2 Bush-Breyman Block

**Eugene, Or., Agents**  
MAGLADRY & SHUMATE

**Laurelhurst Co.**  
522-526 Corbett Building  
Phones—Main 1503, A 1515