

C. D. & D. C. LATOURETTE ATTORNEYS AT LAW Commercial, Real Estate and Specialties Office in Commercial Bank Building OREGON CITY OREGON

COMMERCIAL BANK OF OREGON CITY CAPITAL \$100,000 Transacts a general banking business Makes loans and collections, discounts bills buys and sells domestic and foreign exchange, and receives deposits subject to check. Open from 9 a. m. to 4 p. m. D. C. LATOURETTE, President F. J. MEYER, Cashier

C. N. GREENMAN THE PIONEER EXPRESSMAN (Established 1865) Prompt delivery to all parts of the city OREGON CITY OREGON

DR. GEO. HOEYE DENTIST All work warranted and satisfaction guaranteed Crown and Bridge work a specialty Caulfield Building OREGON CITY OREGON

DR. FRANCIS FREEMAN DENTIST Graduate of Northwestern University Dental School, also of American College of Dental Surgery, Chicago Willamette Block OREGON CITY OREGON

E. I. SIAS DEALER IN WATCHES, CLOCKS, JEWELRY Silverware and Spectacles CANBY OREGON

G. E. HAYES ATTORNEY AT LAW Stevens Building, opp. Bank OREGON CITY OREGON

GEO. T. HOWARD NOTARY PUBLIC REAL ESTATE AND INSURANCE At Red Front, Court House Block OREGON CITY OREGON

M. C. STRICKLAND, M. D. (Hospital and Private Experience) Special attention paid to Catarrh and Chronic Diseases Office hours: 10 to 12, a. m.; 4 to 6, p. m. Willamette Building OREGON CITY OREGON

G. SCHUEBEL W. S. UREN ATTORNEYS AT LAW Dentist & Abbot Will practice in all courts, make collections and settlements of estates. Furnish abstracts of title, lend you money and lend your money on first mortgages. Office in Enterprise building. OREGON CITY OREGON

O. W. EASTHAM ATTORNEY AT LAW Land Titles Examined, Abstracts Made, Deeds, Mortgages, Etc. drawn, Money Lended. Office over Bank of Oregon City. OREGON CITY, OREGON

ROBERT A. MILLER CARL HABERLACH ATTORNEYS AT LAW Will practice in all Courts of the State Wehnard Building. Opposite Court House OREGON CITY, OREGON

W. H. YOUNG'S Livery & Feed Stable Finest Turnouts in City OREGON CITY, OREGON

S. J. VAUGHAN'S Livery, Feed and Sale Stables Nearly opposite Suspension bridge First-Class Rigs of All Kinds OREGON CITY, OREGON

MITCHELL WAGONS Most possible to build. No wagon is or can be better than a Mitchell, because the cream of wood stock is used, only after being thoroughly seasoned. The wagon is well ironed, well painted, well proportioned, and runs the highest of any. It is nearly 30 years since the first Mitchell wagon was built, and they have been built continuously ever since by the Mitchell. When you buy a Mitchell you get the benefit of this 30 years' experience.

MITCHELL, LEWIS & STAYER CO. First and Taylor Sts., Portland, Oregon.

CASTORIA. The Kind You Have Always Bought Bears the Signature of

TOO MUCH

Exercise is as bad as too little for the growing girl. It is very easy for her to overdo, and this is especially dangerous at that critical period of a young girl's life when she crosses the line of womanhood. It is not an uncommon thing to lay the foundation for years of after misery by neglect of necessary precautions at the first "change of life."



"For a number of months I suffered with female trouble," writes Miss Agnes McGowan, of 122 Bank Street, Washington, D. C. "I tried various remedies, but none seemed to do me any permanent good. The doctors said it was the worst case of internal trouble they ever had. I decided to write to you for help. I received a very encouraging reply and commenced treatment at once. I had not used your Favorite Prescription a week before I began to feel better, and as I continued, my health gradually improved, and is improving every day."

Dr. Pierce's Common Sense Medical Adviser, in paper covers, is sent free on receipt of 21 one-cent stamps to pay expense of mailing only. Address Dr. R. V. Pierce, Buffalo, N. Y.

KIMBALL PIANOS.

Their Popularity and Prestige with American People Still Increasing Daily. EIGHTY PIANOS DAILY. A Demand That is Without Parallel in the History of Piano-Forte Building.

"There is no limit to the capacity of the W. W. Kimball Co. as a piano manufacturer," says the New York Musical Courier. "Every one will admit that. The capacity runs in every direction. There is no limit to factory capacity; no limit to the capacity to absorb every excellent idea in piano structure; no limit to the capital necessary to get the greatest experts and specialists, and no limit to secure the very finest material and put it together in the very best style. That all must be admitted."

"If piano people desire to see what is constituted under the 'original,' we advise them to look at the several new designs and styles of Kimball Uprights. Look at them, they are entirely outside of the ordinary character of piano case work. The finish is simply exquisite. Then look at the interior. The ordinary plate styles and furnishings are supplanted by new features simply startling. Then try the pianos, test them severely. Go through the questions of dip, of pianists, and the tone is rich, resonant and refined. The Kimball piano of the present day must be viewed as one of the greatest successes in recent piano history."

"Of course, with this piano, and the millions behind it, and the brains and the energy and the knowledge of the business, and the condition of the piano trade to aid it, there is no difficulty in predicting the future grandeur of the Kimball house. With old houses retiring or going to pieces, new alignments ensuing, a rearrangement of the conditions of the past proceeding visibly before us, the Kimball house assumes an importance that at most necessarily is felt throughout the musical world of America with electric effect. It is now being felt, and the impulse is so great as to be startling in its character."

Having prepared our readers for what we are now to state, we hereby announce that the W. W. Kimball company is producing eighty pianos a day in its enormous factories.

Eiler's Piano House, the general western agency for the Kimball pianos, has just received three more car loads of these world-famous pianos, and under present conditions is selling them to the people at much less than factory prices. Attend to your piano matter at once by writing to Eiler's Piano House, 351 Washington Street, the retail warehouses in the new music building, Portland, Oregon. Branch houses, San Francisco, Sacramento, Calif., and Spokane, Wash.

He Kept His Leg. Twelve years ago J. W. Sullivan, of Hartford, Conn., scratched his leg with a rusty wire. Inflammation and blood poisoning set in. For two years he suffered intensely. Then the best doctors urged amputation, "but," he writes, "I used one bottle of Electric Bitters and my leg was sound and well as ever." For Eruptions, Eczema, Tetter, Salt Rheum, sores and all blood disorders Electric Bitters has no rival on earth. Try them. George A. Harding will guarantee satisfaction or refund money. Only 50c.

CASTORIA. The Kind You Have Always Bought Bears the Signature of

Dreadful Attack of Whooping Cough. Mrs. Ellen Harrison, of 300 Park Ave., Kansas City, Mo., writes as follows: "Our two children had a severe attack of whooping cough, one of them in the paroxysm of coughing would often faint and bleed at the nose. We tried everything we heard of without getting relief. We then called in our family doctor who prescribed Foley's Honey and Tar. With the very first dose they began to improve and we feel that it has saved their lives." Refuse Substitutes. Charman & Co.

CASTORIA. The Kind You Have Always Bought Bears the Signature of

HEADACHE DR. MILES' PAIN EXPELLER

DR. MILES' PAIN EXPELLER

DR. MILES' PAIN EXPELLER

DR. MILES' PAIN EXPELLER

CORRESPONDENCE

Carus. John M. Jones, of Beaver Creek is cutting rock for the foundation of his father's new house, which the latter intends to have built this summer.

Mrs. C. Vanderhake, of Oregon City, who has been visiting Mrs. Jagger, returned to her home Friday. Miss Edna Irish was the guest of Miss Vada Faust Sunday.

Miss James Jones is visiting her sister, Mrs. Evans, of Portland. Born, to the wife of Mr. Wilson, a daughter, on April 4th. Mother and child are doing well.

Mr. Brien has come home from the Bagby mill. Mr. Bagby and wife made Mrs. Wingfield a pleasant visit the first time this winter on account of bad roads.

Mrs. Ellen Sawtell made Mrs. Wingfield a visit this week. Mr. Bowers has moved his cattle to Gribble Prairie to pasture.

Many years ago among the Jews all the laws were made by God Almighty, and men that could not pay their debts were sold to work out their debt, but every seven years was a year of jubilee; then all debts were cancelled, and all slaves went free. Even the land had to rest. Do we not think it was a year of jubilee? Suppose we have a year of jubilee soon?

Elder Moore will hold a meeting at the Beaver Lake schoolhouse in the near future.

Highland. Mr. Wallace, who was hurt in a runaway, is able to be around again. Mrs. Jones is looking well in this part of the country.

Farmers are putting their crops in and will be through seeding if the good weather lasts a few days more.

Mr. Shockey and boys are running two teams while the weather is good. That's right, Bob, keep ahead of the rain. The land had to rest. Do we not think it was a year of jubilee? Suppose we have a year of jubilee soon?

A social dance was given at the home of Hiram Danna last Saturday night. There were about 18 numbers in attendance, and all report having had a good time. They tripped the light fantastic till the wee small hours.

There will be a literary society organized at Highland next Saturday night. Every day turn out and make it a success. TINS SHUGLER.

Obituary. Died, on March 28, on the Abernethy, near Oregon City, Mrs. Annie, wife of Jesse Mayfield, of an abscess on the lung. The remains were laid to rest in Highland cemetery on March 29, 1902.

The deceased was born near Beaver Creek, Dec. 15, 1827, at a place lived with her widowed mother until January 27, 1901, when she married Jesse Mayfield, of Highland, who still survives here.

The bereaved family consists of a husband, mother, brother and uncle, who have the sympathy of a large circle of relatives and friends that mourn her loss.

Oh! Mother, husband, brother, uncle, A dear one from us has gone, When God has seen fit to know that When God hastens to say, "They will be done."

Her suffering ended with the day, Yet lived she near its close, And breathed the long, long day away, In statu-licet repose.

But when the sun in all his state Illumined the western skies, She passed through glories' evening gate, And walked in Paradise.

After the dreariness and aching pain, The weary struggles which have proud in vain. After our souls are past, He will give us rest at last. BERTHA.

The Ill Wind that blows nobody good is bent on errands of mischief in the fall and winter. It produces that most dangerous of common complaints a bad cold. Your cold will not become bronchitis, nor consumption if you make timely use of Allen's Lung Balm. Take it frequently until the cough and the stopped up feeling in the chest are gone. Contains no opium and will not disturb digestion.

You Know What You Are Taking When you take Grove's Tasteless Chill Tonic because the formula is plainly printed on every bottle showing that it is simply Iron and Quinine in a tasteless form. No Cure, No Pay. 50c.

P. C. & O. Ry. Co. 25c is the regular Sunday round trip rate between Oregon City and Portland. Get your tickets at Harding's drug store.

Foley's Honey and Tar contains no opiates, and will not constipate like nearly all other cough medicines. Refuse substitutes. Charman & Co.

A VALUABLE MEDICINE. For Coughs and Colds in Children. "I have not the slightest hesitancy in recommending Chamberlain's Cough Remedy to all who are suffering from coughs or colds," says Charles M. Cramer, Esq., a well known watch maker, of Colombo, Ceylon. "It has been some two years since the city dispensary first called my attention to this valuable medicine and I have repeatedly used it and it has always been beneficial. It has cured me quickly of all chest colds. It is especially effective for children and seldom takes more than one bottle to cure them of hoarseness. I have persuaded many to try this valuable medicine, and they are as well pleased as myself over the results." For sale by G. A. Harding.

The MAN and the HOUR meet by the time of an Elgin Watch

Punctuality's watch word is Elgin. Worn everywhere; sold everywhere; guaranteed by the world's greatest watch factory. Booklet mailed free.

ELGIN NATIONAL WATCH CO., ELGIN, ILLINOIS.

Tired Out

"I was very poorly and could hardly get about the house. I was tired out all the time. Then I tried Ayer's Sarsaparilla, and it only took two bottles to make me feel perfectly well."—Mrs. N. S. Swinney, Princeton, Mo.

Tired when you go to bed, tired when you get up, tired all the time. Why? Your blood is impure, that's the reason. You are living on the border line of nerve exhaustion. Take Ayer's Sarsaparilla and be quickly cured. \$1.00 a bottle. All druggists.

Ask your doctor what he thinks of Ayer's Sarsaparilla. He knows all about this grand old family medicine. Follow his advice and we will be satisfied. J. C. Ayer Co., Lowell, Mass.

REALTY TRANSFERS.

Furnished Every Week by Ciekamas Abstract & Trust Co.

A Smitgen to S. Peterson, lots 4 and 5 and ne of se of sec 19, 5, 3 e. 1000 I Cooper to S. A. Cooper, 83 1/2 as in sec 19, 5, 3 e, decree of court. J. Ernatterger to J. Flick, blk 2, 3, 6, 7, 11, Sellwood Add. 3250 A Svenson to J. A. Mullenhoff, w 1/2 of nw of sec 4, 2, 3 e. 2800 C. H. Johnson to J. M. Johnson, lots 11 to 40, blk 86, 5 to 18, blk 99, Minthorn 1 F. N. Partch to C. H. Warthen, 80 as in sec 8, 2, 2 e. 1000 W. F. Skeen to J. C. Lehman, sw of ne and lot 1, sec 23, 5, 1 e. 1600 M. L. Surman to J. Surman, 67 lots and her interest in the unplatted part of E. Oregon City 1 G. L. E. Association to F. Harris, lots 9 and 10, blk 75, Gladstone 350 H. H. Gregory to R. Clark, lots 1 and 2, and 20 as in sec 20 and 39 as in Sprink elm, 3, 2 e. 3815 G. B. Linnick to M. E. Foster, 100 as in Foster com. 30 S. E. Latt to E. F. King, lots 8 and 9 of blk 8, Parkview 20 N. Hubler to R. M. Lakin, 1/2 as in Whitcomb 175 N. Holtenbeck to J. E. Heig, w 1/2 of lots 1, 5, 6, 7 and 8 in blk 16, Canemah 10 F. J. Nicholson to M. Skirvin, 1/2 of nw, sec 24, 4, 2 e. 100 M. E. Nicholson to T. H. Nicholson, 1/2 of sw of sec 24, 4, 2 e. 100 E. J. Nicholson to M. Skirvin, 1/2 of nw and w 1/2 of sw of sec 24, 4, 2 e. 1 F. C. Forbes to L. T. Pierce, 9.50 as in Abernethy com. 1000 S. O. Mitchell to J. T. McIntyre, se of sec 24, 2, 6 e. 300 C. Scott to A. E. Thomas, lots 113 and 114, Friends Oregon Colony 250 W. A. Proctor to E. Beers, 130.74 as in sec 28, 1, 4 e. 1 Proctor & Beers to U. S. Griffiths, 5 as in sec 27, 1, 4 e. 125 W. A. Proctor to F. Beers, tract in sec 27, 1, 4 e. 223 F. Beers to W. A. Proctor, 130.74 as in sec 27 and 28, 1, 4 e. 25 A. E. Holcomb to F. Brasse, roadway A. L. Frazer et al to A. Thayer, 1/2 of sec 2, 8, 3 e. 1 S. Miller to O. B. Hoffman, tract in sec 5, 5, 1 e. 100 G. Dieckman to F. Dieckman, 10 as in sec 26, 1, 2 e. 10 I. N. Norton to B. M. Dinkie, 15 int in 1/2 of nw of sec 21, 5, 1 e. 160

Good for Rheumatism. Last fall I was taken with a very severe attack of muscular rheumatism which caused me great pain and annoyance. After trying several prescriptions and rheumatic cures, I decided to use Chamberlain's Pain-Exeller, which I had seen advertised in the South Jerseyman. After two applications of this Remedy I was much better, and after using one bottle, was completely cured.—Sallie Harris, Salem, N. J. For sale by G. A. Harding.

U. I. CASE

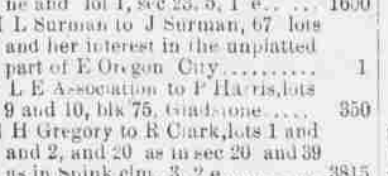

TRIUMPH SULKY PLOW Guaranteed to be the best Sulky Plow in the world. This is a broad statement, but we stand ready to prove it in the field with any plow made. Send for Special Catalogue. Mitchell, Lewis & Staver Co. PORTLAND, OREGON.

E. E. G. SEOL Will give you a Bargain in Wall Paper Wall Tinting and in General House Painting Paint Shop near Depot Hotel Oregon City Second-Hand & Junk Store Highest Prices Paid for Second-Hand Goods, Hides, Junks, Metals of all Kinds, Etc. Second-Hand Goods Bought and Sold Goldstone, Sugarman & Co. New Plumbing and Tin Shop A. MIHLSTIN JOBBING AND REPAIRING a Specialty Opposite Caulfield Block OREGON CITY

W. I. CASE

W. I. CASE

W. I. CASE

W. I. CASE

W. I. CASE

W. I. CASE

W. I. CASE

W. I. CASE

W. I. CASE

W. I. CASE

W. I. CASE

W. I. CASE

W. I. CASE

Wall Paper

Now is the time to buy your wall paper and Murrow, the paper hanger, will sell it to you cheaper than you can buy it in Portland. Drop a card in the postoffice and have sample-book brought to your house, or telephone Ely Bros.' store J. MURROW, Oregon City

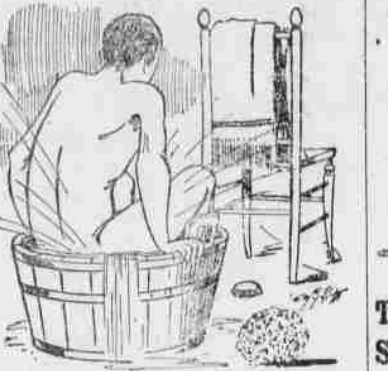

THE MORNING TUB cannot be enjoyed in a basin of limited capacity nor where the water supply and temperature is uncertain by reason of defective plumbing or heating apparatus. To have both put in thorough working order will not prove expensive if the work is done by F. C. CADKE!

U. I. CASE

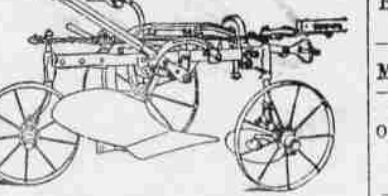

TRIUMPH SULKY PLOW

Guaranteed to be the best Sulky Plow in the world. This is a broad statement, but we stand ready to prove it in the field with any plow made. Send for Special Catalogue. Mitchell, Lewis & Staver Co. PORTLAND, OREGON.

E. E. G. SEOL Will give you a Bargain in Wall Paper Wall Tinting and in General House Painting Paint Shop near Depot Hotel Oregon City Second-Hand & Junk Store Highest Prices Paid for Second-Hand Goods, Hides, Junks, Metals of all Kinds, Etc. Second-Hand Goods Bought and Sold Goldstone, Sugarman & Co. New Plumbing and Tin Shop A. MIHLSTIN JOBBING AND REPAIRING a Specialty Opposite Caulfield Block OREGON CITY

W. I. CASE

W. I. CASE

W. I. CASE

W. I. CASE

W. I. CASE

W. I. CASE

W. I. CASE

W. I. CASE

W. I. CASE

W. I. CASE

W. I. CASE

W. I. CASE

W. I. CASE

O. R. & N. OREGON SHORT LINE

AND UNION PACIFIC TO THE EAST

The O. R. & N. Co. Gives the Choice of THREE TRAINS DAILY

TWO VIA THE OREGON SHORT LINE ONE VIA THE GREAT NORTHERN

9:00 a. m. 9:00 p. m. TO SALT LAKE, DENVER, OMAHA, CHICAGO and KANSAS CITY. TO SPOKANE, MINNEAPOLIS, ST. PAUL, and CHICAGO.

Ocean Steamers leave Portland every 5 Days for SAN FRANCISCO

Boats leave Portland daily for Willamette and Columbia River Points. Monthly Steamers to China and Japan.

For full information call on or address nearest O. R. & N. Ticket Agent, or address A. L. CRAIG, G. P. A., Portland, Oregon

ASTORIA & COLUMBIA RIVER RAILROAD CO.

LEAVES DEPOT FIFTH AND I STS., PORTLAND ARRIVES

8:00 A. M. For Maygers, Rainier, Astoria, Warrenton, Flavel, Hammond, Fort Stevens, Goshart Park, Seaside, Astoria and Seaside Express, Daily, Astoria Express, Daily. 7:00 P. M. 11:10 A. M. 9:40 P. M.

Ticket Office, 355 Morrison st. and Union Depot. J. C. MAYO, Gen. Pass. Agt., Astoria, Ore.

PORTLAND-ASTORIA ROUTE STR. BAILEY GATZERT Daily Round Trips, except Sunday TIME CARD Leave Portland, Mon., Wed. and Fri. 7 A. M. Leave Astoria, Tues., Thurs. and Sat. 7 P. M.

THE DALLES-PORTLAND ROUTE STRS. TAHOMA and BONITA Daily Trips Except Sunday STR. TAHOMA Leave Portland, Mon., Wed. and Fri. 7 A. M. Leave The Dalles, Tues., Thurs. and Sat. 7 A. M. STR. BONITA Leave Portland, Tues., Thurs. and Sat. 7 A. M. Leave Dalles, Mon., Wed. and Fri. 7 A. M. Landing, Foot Alder Street BOTH PHONES, MAIN 321 PORTLAND, OREGON -AGENTS-

John M. Fillion.....The Dalles, Ore. A. J. Taylor.....Astoria, Ore. Prather & Hemman.....Hood River, Ore. Wolford & Myers, White Salmon, Wash. J. O. Wyatt.....Vancouver, Wash. R. B. Gilbreth.....Lyle, Wash. John M. Totton.....Stevenson, Wash. Henry Olmstead.....Carson, Wash. E. W. CRICHTON, PORTLAND, ORE.

The Dalles, Portland and Astoria Navigation Co's Strs. Regulator & Dalles City Daily (except Sunday) between The Dalles, Hood River, Cascade Locks, Vancouver and Portland

Touching at way points on both sides of the Columbia river. Both of the above steamers have been re-nit and are in excellent shape for the season 1902. The Regulator Line will endeavor to give patrons the best service possible.

For Comfort, Economy and Pleasure travel by the steamers of the Regulator Line. The above steamers leave Portland 7 a. m. on Dalles at 8 a. m. and arrive at destination in 24 p. m. time for outgoing trains. Portland Office, Oak St. Dock. The Dalles Office, Court Street. A. C. GALLAWAY, General Agt.

GO EAST VIA

THE DENVER AND RIO GRANDE WESTERN

Only transcontinental line passing directly through Salt Lake City, Leadville, Pueblo, Colorado Springs and Denver.

Three splendidly equipped trains daily to all points East. Through Sleeping and Dining Cars and Free Reclining Chair Cars. The most magnificent scenery in America by daylight. Stop overs allowed on all classes of tickets.

For cheapest rates and descriptive literature address J. D. MANSFIELD, General Agent, Portland, Oregon

214 Third Street, Portland, Oregon