

Baptists host ministry

Sandy Baptist Church will host a group of young people next week who are part of M.O.P. (Ministry of Operation Penetration, an arm of the Conservative Baptist Association). The group, led by Jerry Grant, will organize and conduct a daily vacation Bible school at the church throughout the week, Aug. 15-20. The school will begin at 9 a.m. and dismiss at noon each day. Activities will include drama, Bible stories, music, games and refreshments. On Friday, Aug. 20, children will participate in a program from 10:30 a.m. to noon which parents are encouraged to attend. To arrange transportation, call 622-4283, 668-4322 or

668-5322. In addition to the Bible school, the M.O.P. team will sponsor activities for high school students Tuesday through Friday, Aug. 17-20. These activities will include a trail hike and fireside evening session, a picnic, Bible study and a youth-oriented concert on Friday evening.

For times and locations of these activities, call the church at 668-4064 or for more information, call 622-4283.

The community is also invited to see and hear the group perform in the Sunday evening service, Aug. 15, at 6 p.m.

The team has been touring Oregon and California this summer.

Jubilee sets meeting

"You Are Beautiful" is the topic for Jubilee this Monday, Aug. 16.

Jan Stahl, a consultant for "Image of Loveliness" classes for the past seven years, will be the special speaker. She will discuss her seven-day wonder dress—the basis for a coordinated wardrobe, individual color analysis—the basis for choosing colors that enhance skin tone, discovering beauty assets, the basis for beauty and why it's important for women to be beautiful, and

"beauty may be skin deep, but ugly goes clear through."

Jan and her husband, Brent, live in Gresham with their three children. She enjoys creative homemaking and her singing ministry at Easthill Church where she also teaches Kingdom Kids, girls in grades four to six, using a curriculum she authored.

Mime group slips into Sandy

The nationally acclaimed Oregon Mime Theatre makes its way soundlessly into Sandy next Friday, Aug. 20, with a performance at the Sandy Community Center at 10 a.m.

The presentation is sponsored by Clackamas County Arts Council and Sandy Public Library.

"With mime, the interplay between the mime actor and the audience is a kind of holy thing," said Dutch-born Francisco Reynders, who is both performer and founding director of the company that also includes Elizabeth Page and Burl Ross.

"Something is created during the silence that is unexplainable in words," he added, "Yet, if done well, it will be understood by everyone."

Without the assistance of sound effects, elaborate costumes or props, the audience will see a hair-raising mountain climb, the life of everywoman from birth to death, a man trapped on a conveyor belt and the majestic flight of an eagle.

In short, the program is a series of mime works that, in Reynders' words, attempt to "tickle the full range of human emotions"—not the least of which is laughter.

Audience participation plays an important role. The children cease being onlookers and become part of the action on stage.

The Oregon Mime Theatre, now in its eighth season, tours from its home base in Lake Oswego. The company has performed before audiences across the nation from packed igloos in Alaska to standing-room-only crowds in Jacksonville, Fla.

Tickets are \$1 and may be purchased at the library.

The Oregon Mime Theatre is a non-profit organization made possible with support from the National Endowment for the Arts and an award from the Western States Art Foundation.

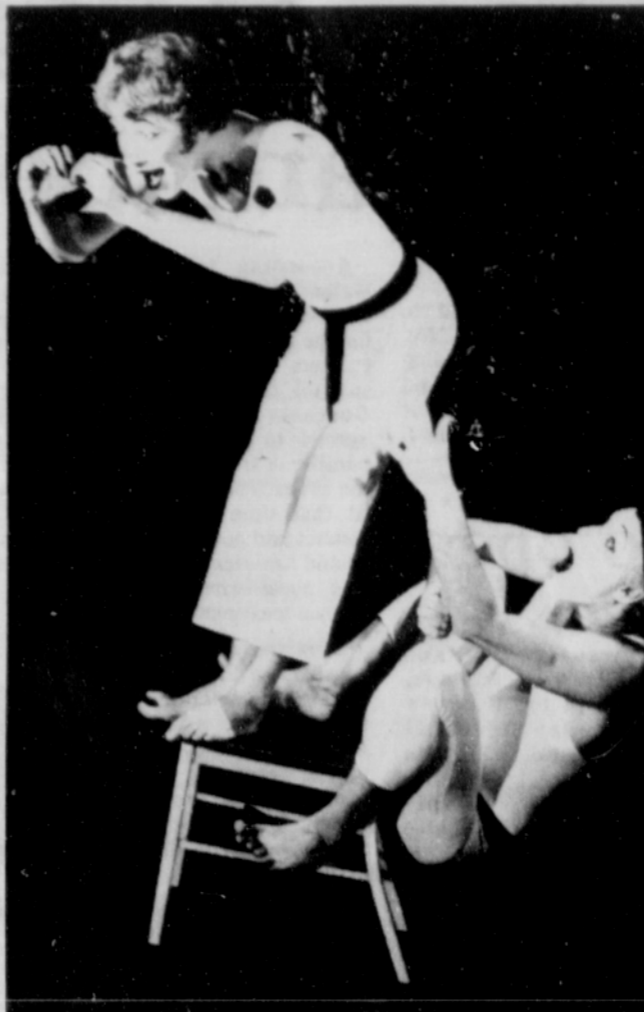

Oregon Mime Theatre slips silently into Sandy next Friday with a 10 a.m. performance at Sandy Community Center.

St. Jude's slates sale

The second annual yard sale sponsored by St. Jude's Home will be next Thursday through Saturday, Aug. 19-21, in the spacious back courtyard of St. Jude's, 39641 Scenic St.

The gigantic sale will open to the public at noon at close at 6 p.m. on Thursday. Hours on Friday and Saturday will be 10 a.m. to 4 p.m. In keeping with last year's sale, all items will be sold at half price on Saturday.

Staff members, friends and families of residents have donated clothing,

toys, records, books and furniture for the sale. The proceeds will be used to purchase a color television for the residents' lounge.

A movie projector and screen were purchased with the proceeds of last year's sale.

Pie will be sold by the slice. Coffee, other baked goods and fresh produce will also be available. Anyone who purchases items totaling \$5 or more will receive a chance on a black and white television set. Back-to-school clothes will be featured.

YES!

I would like to subscribe to the Sandy Post

name _____
address _____
phone _____

please bill me
 check enclosed

Yearly in Clackamas County \$9.00
Yearly in Multnomah County \$10.00
Elsewhere in Oregon \$11.50
Elsewhere in Pacific Northwest \$14.00
Elsewhere, per year \$17.00
MAIL TO: The Sandy Post, P.O. Box 68, Sandy, OR 97055

Come to Church

COMMUNITY PRESBYTERIAN CHURCH

Sunday school 9:30 a.m.
Sunday school 9:45 a.m.
Morning worship 11:00 a.m.
Home Bible Study 6:00 p.m.

Nursery Care During Worship
Pastor John H. Van Lierop
Home 668-6100
Church 668-4543
Corner of Meier & Scenic, Sandy

IMMANUEL LUTHERAN CHURCH

Worship 8:30 a.m.
Sunday School 9:30 a.m.
Bible Study 9:45 a.m.
Worship 11:00 a.m.

A Cordial Welcome is Extended to All
PASTOR FRANK KOEPEK
668 6232 - Church

This space for rent
Call
668-5548

SANDY ASSEMBLY OF GOD

Sunday School 9:45 a.m.
Morning Worship 10:45 a.m.
Evangelistic Service 6:00 p.m.

Family Night
Wednesday 7:00 p.m.
Dale Edwards Church
PASTOR Phone 668-5589

St. MICHAEL'S CATHOLIC CHURCH

Sat. eve Mass 7:30 p.m.
Sunday Mass 10:00 a.m. - 6 p.m.

St. John's Catholic Church
Welches, Oregon
Mass 6 p.m. Sat., 8 a.m. Sun.
18090 SE Longensand
Sandy, Oregon
Father Carl Gimpl 668-4446

Boring Community Methodist Church

Corner of Church and Richey Roads
9:15 a.m. Sunday school
9:45 a.m. Worship service

Pastor:
Elizabeth Hampton Gray
"The pioneer church with a future"

SANDY SEVENTH-DAY ADVENTIST CHURCH

Proctor and University
Sabbath School 9:30 a.m.
Morning Service 11:00 a.m.

You Are Welcome
Pastor
BERNIE CLARK
668-9249 - Home
668-6144 - Church

Sandy Church of the Nazarene

Currently meeting at:
17150 University Ave., Sandy
(Seventh Day Adventist Church)

Sunday School - 9:45 a.m.
Morning Worship - 11:00 a.m.
Evening Service - 6:30 p.m.
Pastor Robert F. Schaifers
668-5712

ORIENT DRIVE BAPTIST CHURCH

(Southern)
15150 S.E. ORIENT DRIVE
BORING, OREGON

(2 1/2 miles from Sandy)
BIBLE STUDY - 9:45 A.M.
MORNING WORSHIP - 11:00 A.M.
CHURCH TRAINING - 1:00 P.M.
AFTERNOON WORSHIP - 2:00 P.M.
(PASTOR) Ted Davis
CHURCH PHONE - 668-6083
HOME PHONE - 668-6261

Church of the Good Shepherd

(Episcopal)
Sunday Communion
9 a.m.

Midweek services
Tues.-Thurs. 10 a.m.
Little Pioneer church
on West Pioneer Blvd.
Father David Lounsbury
668-5663 or 238-8870

Sandy Baptist Church

We invite you to join us for fellowship.
Church 668-4064

Sunday
9:45 Sunday School
11:00 Morning Worship
6:00 Evening Worship

Wednesday
7:30 p.m. Prayer Meeting

FELLOWSHIP BIBLE CHURCH

We emphasize Biblical teaching, supportive fellowship, children's learning center & regular home meetings.

MEETING AT:
Sandy High School (Bluff Road)
Sunday mornings (9:30-11:30)

First Church of Christ, Scientist

1525 West Powell Boulevard
Gresham, Oregon 97030

Sunday Service 10:00 a.m.
Sunday School 10:00 a.m.
Wednesday evening 8:00 p.m.

Children's Room available at all services. You are warmly invited to attend.
666-3212

Living Way Fellowship (Foursquare)

Discovery 9 a.m.
Worship service 10 a.m.
Wed. eve. service 7:15 p.m.

Pastor 'en World
17275 Strauss
668-4949
(Formerly St. Michael's Hall)

RIEGELMANN'S August SAVINGS

Our storewide discounts will give you exceptional savings on the new appliance, television, La-Z-Boy recliner or video recorder. Use our convenient credit terms and don't forget that your present appliance or T.V. is always worth money at Riegelmann's.

Frigidaire Sale!

100% Frost-Proof
19.9 Cubic Foot REFRIGERATOR-FREEZER



- Textured Steel Doors
- Fully Adjustable Cantilevered Glass Shelves
- Get ice from separate door... save energy
- Electric-Saver switch
- Flowing Cold Meat Tender Drawer

MAYTAG

CASH IN!
WITH INSTANT DISCOUNTS
on all
JET CLEAN DISHWASHERS



GET YOUR REFUND DIRECT FROM MAYTAG
Call and collect Refund Voucher
Cash from your local store on special
market days of Dishwashers ALL
and Maytag magazine ads.

Cash-in with Instant Discounts on Maytag Heavy-Duty Washers & Big Load Dryers



HURRY! Sale ends Aug. 14th!

NEW & USED SPECIALS!

NEW IMPERIAL
10 cu. ft. upright Freezer
while they last \$298

NEW FRIGIDAIRE
Disposal Reg. \$49.50 \$34.50

RCA Color T.V. Console
25" Used. Guaranteed 90 days parts & labor \$289

19" Solid State Color
Portable T.V. \$219

USED WHIRLPOOL
Washer/Dryer Pair \$418
Guaranteed 90 days parts & labor pair

HOURS Mon.-Fri. 9-8:30
Wed.-Thurs. 9-6, Sat. 9-5
CLOSED SUNDAY

EASY TERMS OR
USE YOUR BANK CARDS

FREE DELIVERY AND
INSTALLATION WITH FULL
SERVICE AFTER THE SALE



MEMBER
ASSOCIATED
VOLUME
BUYERS

YOUR TRADE-IN
IS WORTH MONEY

TELEVISION

APPLIANCES

LA-Z-BOY RECLINERS

301 e. powell gresham, 665-4158

Well Now...

Looking for
Crickets,
Frogs
and
Great
Terms?
See
Salmon
Creek
Estates
Adult
Condominiums



"Take it from me, Salmon Creek Estates is a great place to be. I know. I live here."
"Trooper" Dick Curtis

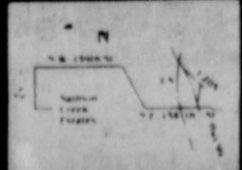

Model Open
11 a.m. Dusk
(206) 574-1381
(206) 574-1366
Vancouver, WA