

Public Notices

BEFORE THE STATE HEALTH DIVISION OF THE DEPARTMENT OF HUMAN RESOURCES OF THE STATE OF OREGON

Order for Public Hearing

In the Matter of the Formation of a County Service District in Clackamas County, Oregon due to a Danger to Public Health in an Area Coinciding with the Boundaries of the Service Territory Allocated by the Public Utility Commissioner for Operation of the Alder Creek Barlow, Riverside, Sleepy Hollow, Mt. Hood Country Club and Wildwood Annex Water Systems, pursuant to the Provisions of ORS 431.705 to 431.760.

The State Health Division previously received a certified copy of an Order and Resolution of the Clackamas County Board of Commissioners, acting as the Clackamas County Board of Health, dated January 8, 1981, expressing the Board's belief that a danger to public health exists in the above-captioned area, and requesting the State Health Division to investigate the conditions and to initiate proceedings for the formation of a new county service district, without vote or consent in the affected area, pursuant to ORS 431.705 to 431.760. Copies of such Order and Resolution are attached hereto marked Exhibit "A" and "B" respectively, and are by this reference incorporated herein and made a part hereof. The Board has also caused preliminary plans, specifications, and a time schedule to be submitted to the Division relative to the service facilities considered necessary for removal or alleviation of the alleged conditions causing a danger to public health.

The Division has reviewed and investigated the conditions in the subject territory and has found substantial evidence that a danger to public health as defined in ORS 431.705 exists, including conditions of improper construction, operation and management of the water systems serving the area and of impure and inadequate domestic water in the area. The Division finds that a public hearing should be held before a hearing officer designated by the undersigned, pursuant to the provisions of ORS 431.705 to 431.760, 183.310 to 183.500, and rules adopted thereunder.

IT IS THEREFORE ordered that a public hearing be held before the designated hearing officer pursuant to the provisions of ORS 431.705 to 431.760, 183.310 to 183.500, and Oregon Administrative Rules, Chapter 333, Section 333.12.001, and Sections 12.035 through 12.045, as amended effective August 19, 1981. The hearing is to commence at the hour of 10:30 a.m. on the 13th day of October 1981, at the Wemme Lion's Club on Highway 26 in Wemme, Oregon, a place near the above-captioned area. The purpose of the hearing is to determine (1) whether a danger to public health exists due to conditions in the subject territory, including improper construction, operation or management of the water systems serving the area and impure or inadequate domestic water in the area; and (2) whether such conditions could be removed or alleviated by the provision of services facilities.

Dated this 11th day of September, 1981.
Kristine M. Gebble, Assistant Director, Human Resources Administrator, Health Division

Exhibit A BEFORE THE BOARD OF COUNTY COMMISSIONERS OF CLACKAMAS COUNTY, State of Oregon

In the Matter of Adopting a Resolution to initiate Proceedings for the formation of a County Service District.
ALDER CREEK WATER COMPANY
ORDER NO. 81-58

This matter coming before the Board of Commissioners at this time and it appearing to the Board that a resolution has been presented to the Board requesting the State Health Division to initiate proceedings for the formation of a County Service District in Clackamas County, Oregon; and

It further appearing to the Board that a hearing was held in the matter on Thursday, January 8, 1981, at 9:30 a.m., Courthouse Annex, 906 Main Street, Oregon City, Oregon, at which time testimony was considered; and

It further appearing to the Board that based upon the testimony presented, the Board of Commissioners felt it was in the best interest of Clackamas County to adopt said Resolution.

NOW, THEREFORE, it is hereby ordered that the Board of County Commissioners, acting as the Board of Health of Clackamas County, adopts Resolution No. 1 requesting the formation of a County Service District in Clackamas County, said boundaries to coincide with the Alder Creek, Barlow, Riverside, Sleepy Hollow, Mt. Hood Country Club, Wildwood Annex systems.

Dated this 8th day of January, 1981.
Chairman Ralph Groener
Commissioner Stan Skoko
Commissioner Robert Schumacher

Exhibit B BEFORE THE BOARD OF HEALTH OF CLACKAMAS COUNTY, STATE OF OREGON

In the Matter of Requesting the State Health Division Initiate Proceedings for the Formation of a County Service District in Clackamas County, Oregon.

RESOLUTION NO. 1

Whereas, investigations have been reported to his Board concerning the Alder Creek Water Company; and

Whereas, those investigations indicate inadequate service facilities, resulting in improperly disinfected water, microbiological contamination, excessive turbidity and inconsistent and unreliable service; and

Whereas, ORS 431.705 to 431.760 provides for formation of a county service district when the Board of Health believes that conditions dangerous to the public health exist; Now, therefore,

Be it resolved that the Clackamas County Board of Health believes that conditions, as cited above, dangerous to the public health exist in the territory described as:

Alder Creek, Barlow, Riverside and Sleepy Hollow System — Beginning at the Southwest corner of Section 19, Township 2 South, Range 6 East, Willamette Meridian, thence East to the Southeast corner of Section 20, thence North to the center line of U.S. Highway Route 26, also known as Mt. Hood Highway; thence East along said center line to its intersection with the West line of the East half of Section 22; thence North to the midchannel line of the Sandy River; thence West downstream along the said midchannel line to its intersection with the West line of Section 19; thence South to the Southwest corner of Section 19, the point of beginning.

Mt. Hood Country Club — Beginning at the Northeast corner of Section 26, Range 6 East, Township 2 South, Willamette Meridian, thence East to the West meander line of the Salmon River located in Section 25, Range 6 East, Township 2 South, thence South along the West meander line of the Salmon River to the point where it intersects the South line of the Northwest quarter of said Section 25; thence West to the Southwest corner of the Northeast quarter of Section 26; thence North to a point that is 1,782 feet North of the said point in Section 26; thence due East 1,535.34 feet along a line parallel with the North line of said Section 26; thence Northeast on a line that is North 10 degrees East to its intersection with the North line of Section 26; thence East to the Northeast corner of said Section 26, which is the point of beginning.

Wildwood Annex — A parcel of land in Clackamas County, Oregon, located in Sections 28, 29, 32, and 33 of Township 2 South, Range 7 East, Willamette Meridian, and more particularly described as follows:

Beginning at the point which is the section corner of Sections 28, 32, and 33, Township 2 South, Range 7 East, Willamette Meridian, thence West in a straight line along the North line of Section 32, 3,960 feet more or less, to the Northwest corner of the Northeast quarter of the Northwest quarter, Section 32; thence South a distance of 1,460 feet more or less, to the North meander line of the Sandy River; thence East along the North meander line along the Sandy River, to a point that the North meander line along the Sandy River intersects the South line of the Northeast quarter of Section 32; thence East a distance of 2,350 feet more or less along the South line of the Northeast quarter of Section 32 to the section line which is 2,640 feet more or less South of the section corner, Sections 28, 29, 32 and 33; thence North along the section line between Sections 32 and 33, a distance of 2,640 feet more or less to section corner, Sections 28, 29, 32 and 33 which is the point of beginning; and

BE IT FURTHER RESOLVED that this Board requests the State Health Division to ascertain whether conditions dangerous to the public health exist in the above described territory and whether such conditions should be removed or alleviated by the provision of service facilities; and

BE IT FURTHER RESOLVED that the State Health Division be requested to initiate the formation of a new service district under ORS 431.705 to 431.760 without vote or consent in the affected territory as described above; and

BE IT FURTHER RESOLVED that the Administrator of the Department of Human Resources is directed to forward to the State Health Division a copy of this resolution, together with the time schedule and preliminary plans and specifications, prepared in accordance with ORS 431.715(3).

Dated this 8th day of January, 1981.
Robert Schumacher
Ralph Groener
Stan Skoko
P981.10
9.24
10.1



Homelite® XL 10" Gas Powered Chainsaw

\$69 SAVE 30.99
Reg. 99.99

- Automatic oiling
- Lightweight 7.2 lbs with bar and chain
- Safety tip



PRICES GOOD TODAY THRU TUES., OCTOBER 6, 1981

Heating Sale

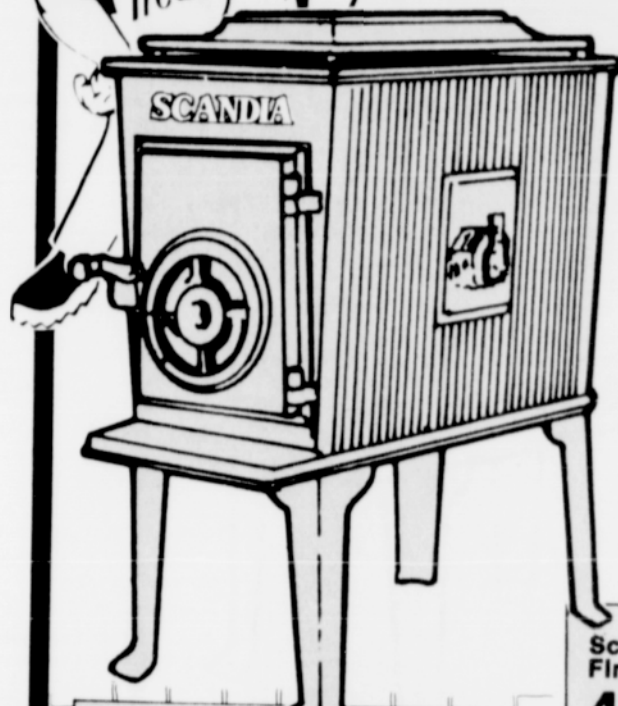

Scandia® Boxwood Heater
SAVE 15.99

\$84 Reg. 99.99

- 20 1/2" x 12 3/8" x 25"
- Accepts 16" length wood
- Cast iron construction, #150

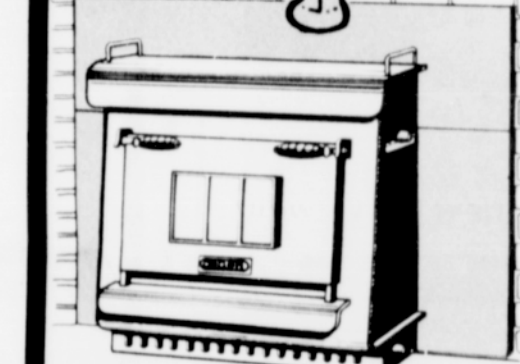

Scandia® Cast Iron Fireplace Insert
469.99
SAVE 50.00 Reg. 519.99

• Baffled for efficiency

Aspen® Steel Fireplace Insert

SAVE 70.00 **599.99**

Reg. 669.99

- Optional blower fan
- Automatic thermostat

Aspen Steel Wood Stove Save 50.00 Reg. 499.99 **444.99**

Firestop Plasterboard Save 64.00 Reg. 5.97 **5.33**
4' x 8' Asbestos Board Save 5.00 Reg. 33.99 **28.99**

A NEW TOOL A FRED MEYER EXCLUSIVE

The Meyer Vise Clamp System

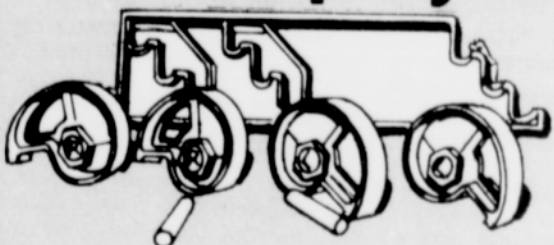

Makes An Excellent Christmas Gift

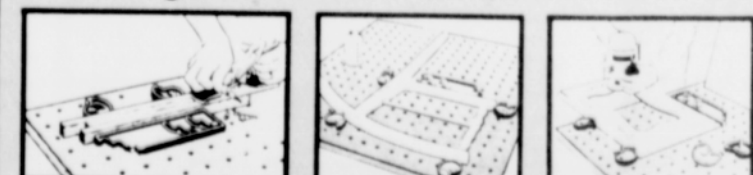

SAVE 2.00 **10.99** Reg. 12.99

- Holds all shapes at any angle
- Simple mounting and removal - no bolts or screws
- Use for planing, sawing, sanding, routing, jiggling, assembly, gluing and more
- Mounts to any workbench, stationary or portable.

See This New Tool Demonstrated At The Following Fred Meyer Home Improvement Centers

GRESHAM/GLISAN - Fri. Oct. 2 - 11 AM to 1 PM
STARK, INTERSTATE - Fri. Oct. 2 - 3 to 5 PM
BEAVERTON/TUALATIN - Sat. Oct. 3 - 11 AM to 1 PM
TIGARD/OAK GROVE Sat. Oct. 3 - 3 to 5 PM
OREGON CITY/CLACKAMAS - Sat. Oct. 3 - 1 to 3 PM

Homelite® 16" Gas Powered Chainsaw

\$197 SAVE 32.99

- Reg. 229.99
- Automatic oiling of bar and chain
- Sure grip handle bar

Homelite® 20" Gas Powered Chainsaw

\$259 SAVE 50.99

- Reg. 309.99
- Solid state ignition
- Automatic oiler
- Anti vibration system
- #330



Meet Timber Jim at the Following Stores On Sat., Oct. 3

BEAVERTON 9 to 10 AM	TUALATIN 11 AM to 12 PM
OREGON CITY 1 to 12 PM	GRESHAM 3 to 4 PM

Timber Jim is the popular Timbers Mascot. Jim knows the safe way to handle wood cutting equipment and will describe the correct way to handle the chain saw as well as how to sharpen and service it.



Sanyo® Kerosene Heater

SAVE 15.99 **\$114** Reg. 129.99

- Use only in well-ventilated areas
- Operates 21 hours on 1 gallon fuel
- 6,000 BTU heat output
- #G23H

Sanyo® Deluxe Kerosene Heater SAVE 20.00 Reg. 164.99 **144.99**
6,000 BTU's • G28H

Folding Steel Table Legs

SAVE 5.02 **13.97** Reg. 18.99

- Auto lock prevents collapse
- Fold compactly for storage
- Black enamel finish
- Easy to attach to slab door or plywood

Premium KD 2"x4"x8' Stud Grade

SALE PRICE **1.11**

2"x2"x8' Stud Grade KD **77¢**
2" x 6" x 8' Stud Grade KD **2.17**

FRED MEYER COUPON

Oregon Chainsaw Bar & Chain Oil

SAVE 99¢ Reg. 1.00 ea. 1.99

- Reduces friction and extends bar & chain life #26365 Quart
- Cash value 1/20th of 1*
- Valid today thru Tues., Oct. 6, 1981
- Home Improvement or Hardware FM 00

FRED MEYER COUPON

POLYSEAMSEAL Clear Caulk

SAVE 1.94 WITH COUPON Reg. 3.89

- Dries clearer than silicone caulk, without the mess or smell
- Cash value 1/20th of 1* • Valid today thru Tues., Oct. 6, 1981 • Home Improvement or Hardware FM 00

FRED MEYER COUPON

Circuit Tester

SAVE 79¢ WITH COUPON Reg. 1.49

- Cash value 1/20th of 1*
- Valid today thru Tues., Oct. 6, 1981
- Home Improvement or Hardware FM 00

FRED MEYER COUPON

Elmer's Wonder Bond Plus Wood & Leather Glue

SAVE 50% **99¢** WITH COUPON Reg. 1.99

- Fast acting glue for porous materials
- Handy reusable bottle, #E563
- Cash value 1/20th of 1*
- Valid today thru Tues., Oct. 6, 1981
- Home Improvement or Hardware FM-00

Each of these advertised items must be readily available for sale at or below the advertised price in each Fred Meyer store, except as specifically noted in this ad. 39-1187

Fred Meyer Complete Home Improvement Centers

OREGON CITY	INTERSTATE	GLISAN	OAK GROVE	SOUTHWEST	STARK	GRESHAM	CLACKAMAS	TIGARD	BEAVERTON	TUALATIN
-------------	------------	--------	-----------	-----------	-------	---------	-----------	--------	-----------	----------