

WANT ADS

Too Late to Classify

1970 CB Honda 350, custom handlebars, sissy bar, candy apple green with white, low miles. This bike is in very exceptional condition. Have to see to appreciate \$600 or best offer on bigger bike. See at Phillips 66 station at 181 and Stark or call Steve after 4 p.m. 666-7277. J 28pd

RUMMAGE SALE - Corner of Dodge Park Blvd. and Altman Rd. B 28

Sun Landscaping
New lawns borders
Flowering shrubs
Landscaping You Can Live With
Ed Markette, 760-4097 S 28

EXPERIENCED POWER sewing machine operator. Good wages, steady work. Damascus area. 658-3866. D 28

PHOTOGRAPHY-WEDDING, publicity, family portraits. 666-7575 or 666-1038. R 11

PROFESSIONAL MEN - small businesses, ideal SE location, modern air conditioned offices, ample parking, easy access. Security patrolled. Also C-3 working storage areas. Telephone 665-9500. W 11

HELP WANTED for janitor work, couple hours at night. 668-4181. M 11

HELP WANTED for laundry work evenings. 668-4181. M 11

GERMAN SHEPHERD puppies, 19-20 purebred, 1 white left. 668-4742. K 28

LOST: FAIRLEED black on Ep-person Road between 4:30 & 5 p.m. Friday. Picked up by person in pickup. Call 665-0444. Reward. P 28

GO TO PONTIAC convertible 1966, white with black top & interior, velvet touch brakes, Michelin tires, great shape. \$892. 666-5680. C 28pd

SUBURBAN BEST, spacious 3 bedroom ranch, 15 min. from downtown Pld., large dining area, 21 ft. family room with old-fashioned heater, custom drapes, carpeting, double garage, large fenced yard. Only \$23,500. Maxine Moe Realty, Gladstone 656-2906. M 28

WE WISH to thank our many friends for their kindness in our recent loss of husband and father. A special thanks for contributions to the Heart Fund and Shriners Hospital.
Alma Alexander and Family
Madras, Ore.
A 28

Laundry Workers

NEW HOSPITAL linen service. Requires all classifications of laundry workers; experienced and inexperienced. Apply in person to Mr. R. Kietsa, July 14 between 10 a.m. and 3 p.m. Portland Hospital Service Corp., 22820 NE Halsey, Fairview.
Equal Opportunity Employer P 28

PUREBRED ENGLISH Pointer pups, very reasonable. 761-8366. P 28

FOR RENT-Duplex, new two bedroom, near school, garage, appliances, shag carpet, drapes, washer, dryer hook up. Patio, lawn. 761-8366. P 28

WANTED to lease and hire, owner and operator of 16 to 20 ft. farm flatbed truck. Approximate period of Sept. 1 through October. Call Ken Crutcher, Oregon Bulb Farms, 8:30 a.m. to 4:30 p.m., 663-3133. O 28

1964 HONDA Trail 90, \$125. Vespa, \$45. 658-2302. A 29

'67 SQUAREBACK VW, stick shift, 4 speed, light blue, chrome wheel covers, radio, very clean, good tires. \$825. 665-3558 after 6 p.m. N 28

BORING-LARGE 2 bedroom furnished apartment. Water, garage paid. \$130. 663-3210. V 28

FOUND: BACK pack, new. Identify. Inquire Gresham Office Supply. OS 28pd

REWARD-LIVER and white Springer Spaniel, "Sparky." License No. 10478. Near Fairview. 665-0223. M 28

SELL YOUR HOUSE WITH A CLASSIFIED AD

Color portrait of your child, 1.49.

Truly professional portraits. Select from several poses.

- Large 5x7" size photo... 1.49 each
- Set of 4 wallet size... 1.49 set



GRESHAM
JCPenney
Tues., Wed., Thurs., Friday, July 18 thru 22 10 'til 5



A SHED behind the Victor F. Bonogfsh house, Sandy, went up in flames on Tuesday afternoon, July 11. Here firemen put out the last of the fire in the skeleton of the burned shed.

PUBLIC NOTICES

COURT ORDER NO. 72-409
BEFORE THE BOARD OF COUNTY COMMISSIONERS OF CLACKAMAS COUNTY, STATE OF OREGON.
In the Matter of Calling a Hearing on the Appeal of the Temporary Permit application of GEORGE H. EN- TENMANN, having been denied by the Board of Adjustment to renew the permit to use a travel trailer as a temporary residence pending construction of a permanent residence on property located on the south side of Cedar Drive, Brightwood Area.
Appellant: GEORGE H. EN- TENMANN

This matter coming regularly before the Board of County Commissioners to be heard, and it appearing to the Board that George H. Entenmann made application to the Clackamas County Board of Adjustment for a temporary permit on property described as Tax Lot 1401, Section 22B, T2S, R6E.

It further appearing to the Board that said application was heard at a scheduled meeting of the Clackamas County Board of Adjustment on the 5th day of June, 1972, at which time the Board made a motion to deny the request on the basis that the applicant has no definite building plans, and also it is within a possible flood plain area.

IT IS HEREBY ORDERED that the hearing in the above matter be held on the 26th day of July, 1972, at the hour of 10:00 A.M. in Room 201, County Courthouse, Oregon City, Oregon, to afford the general public an opportunity to be heard on the above appeal, and

IT IS FURTHER ORDERED that the County Clerk is hereby directed to publish a notice of said hearing in the Sandy Post, a newspaper of general circulation in the County, on the 13th day of July, 1972.
DATED this 22nd day of June, 1972.

NOTICE OF BOND SALE
Sealed proposals will be received by the undersigned until 8:00 o'clock p.m. on the 1st day of August 1972, and immediately thereafter will be publicly opened by the District School Board of School District No. 46, Clackamas County, Oregon, for the purchase of four lots, less than one and accrued interest, of the following described negotiable general obligation coupon bonds of the bonds of the County of Clackamas, Oregon, to-wit:

- \$25,000.00 on December 1, 1973
- 25,000.00 on December 1, 1974
- 30,000.00 on December 1, 1975
- 30,000.00 on December 1, 1977
- 50,000.00 on December 1, 1978
- 35,000.00 on December 1, 1979
- 35,000.00 on December 1, 1980
- 40,000.00 on December 1, 1981
- 40,000.00 on December 1, 1982
- 45,000.00 on December 1, 1983
- 45,000.00 on December 1, 1984
- 50,000.00 on December 1, 1985
- 50,000.00 on December 1, 1986
- 55,000.00 on December 1, 1987
- 55,000.00 on December 1, 1988
- 60,000.00 on December 1, 1989
- 65,000.00 on December 1, 1990
- 65,000.00 on December 1, 1991
- 70,000.00 on December 1, 1992

The bonds of the issue that mature after December 1, 1982, will be redeemed at the option of the school district in regular numerical order at par and accrued interest upon December 1, 1982 and upon any interest date thereafter.

The bonds will bear interest payable semiannually on June 1 and December 1 at such rate or rates, in multiples of four tenths (4/10) or one tenth (1/10) of 1%, not exceeding a net effective rate of seven (7) percent per annum, as shall be specified by resolution of the Board. The bonds shall have but one coupon for the interest due on any interest-paying date. Both the principal of and the interest upon the bonds will be paid at the office of the county treasurer of Clackamas County, Oregon, at Oregon City, Oregon.

The bonds will be sold to the highest bidder, but the district school board reserves the right to reject any or all bids. Unless all bids are rejected, the bonds will be awarded to the bidder complying with the terms of the notice of sale, and submitting the bid which, if none of the bonds are called for redemption prior to the final maturity date thereof, provides the lowest cost to the school district.

Each bid must be unconditional, must be accompanied by a certified check or cashier's check in favor of the district, or upon a bank doing business in the State of Oregon, in the sum of \$17,500.00, and must be enclosed in a sealed envelope addressed to the undersigned and marked on the outside "Proposal for the sale of the bonds of the school district against any loss resulting from failure of the bidder to comply with the terms of his bid."

The successful bidder will be furnished, without cost, with the approved opinion of the County of Rankin, Walsh and Regen, printed on the reverse side of the bonds at the expense of the district, to the effect that the bonds are valid and legally binding general obligations of the Clackamas County School District No. 46, and, unless paid from ad valorem taxes levied upon all of the taxable real property within the district without limitation as to rate or amount under present laws. The firm will also furnish a statement in such approving opinion that they have taken into account the provisions of the law of the State of Oregon, including the provisions of the present system of financing public school purposes, and that it does not modify or qualify the conclusions stated in their opinion. The successful bidder shall be conditioned on the availability and delivery of the bonds, which certificate will make reference to the litigation referred to above and will state the issue is not a party to such litigation.

The bonds will be delivered complete, without undue delay, at the expense of the school district, at such city in Oregon as the successful bidder shall name.

ANTON A. BRYANT, Clerk, School District No. 46, Clackamas County, Oregon, 207 Pleasant St., P.O. Box 547, Sandy, Oregon 97055. SP-29

ADVERTISEMENT FOR BIDS
Sealed bids will be received by the Sandy Elementary Schools, at the superintendent's office, until 2:00 p.m., Pacific Daylight Time, on Tuesday, August 1, 1972, for the Sandy Elementary School, Kitchen Remodel and I.M.C.

The work is described as follows:
Existing kitchen equipment will be relocated and a new food preparation area established in the existing cafeteria. A classroom will be remodeled to serve as an I.M.C. satellite library room.

Additional sets of drawings, specifications and forms of contract documents may be obtained by prime bidders only upon a deposit of \$30.00. Plans and specifications may be obtained from Bloodworth, Hawes, Peterson & Associates, Architects, 7000 S.W. Varns Road, Portland, Oregon 97223.

The deposit in full upon the procurement of the drawings, specifications and forms of contract documents will be refunded within two weeks after the opening of bids, but to nonbidders only if returned no later than two weeks prior to the bid opening.

Additional prints may be purchased for the cost of reproduction. All bidders must comply with Chapter 279, Oregon Revised Statutes, relating to the qualification of bidders.

No bid will be considered unless fully completed in the manner provided in the "Instructions to Bidders" upon the Bid Form provided by the Architects, and accompanied by a certified check or bid bond executed in favor of the Sandy Elementary Schools, P.O. Box 547, Sandy, Oregon, 97055, in an amount not less than ten percent of the total amount of the Bid, to be forfeited as fixed and liquidated damages should the bidder neglect to refuse to enter into a contract and provide suitable bond for the faithful performance of the work of the event the contract is awarded to him.

Sandy School District No. 46 reserves the right to reject any or all bids and to waive all informalities. No bidder may withdraw his bid after the hour set for the opening thereof, until after the elapse of thirty days from the bid opening.

SCHOOL DISTRICT NO. 46
Clackamas County, Oregon
Portland, Oregon 97223
P.O. Box 547
Sandy, Oregon 97055

By: **Anton A. Bryant**, Clerk
PUBLICATION AND DATES
Sandy Post, Sandy, Oregon, July 13, 1972, July 20, 1972. SP-29

Bird seasons hearing dated

Regulations for 1972 upland game birds, waterfowl, small game and furbearer seasons will be set Aug. 12 by the Oregon Game Commission.

The meeting open to the public will be held in the Commission's Portland headquarters, 1634 SW Alder, at 10 a.m.

Major staff proposals on seasons will be published two weeks prior to the meeting.

Local girl on honor roll

Joyce Bergeson, Boring, was among 414 students who were on the spring quarter honor roll at Clackamas Community College. She was on the President's List, which requires a grade point average of 3.5 minimum.

SANDY BUSINESS DIRECTORY

Johnny Sez
- BUYING? -
- SELLING? -
- TRADING? -

24-Hour Phone Service when calling Johnny
665-3491 with
J.J. WALKER
288-5045
4950 N.E. Union Portland

BERGH MACHINERY CO.
See Us for New Jacuzzi Pumps and Repairs on All Makes of Pumps.
Loop Hwy. & Boring Road Gresham, Oregon
Telephone: 663-4353

CHECK THE CLASSIFIEDS

Classified Business, Professional Directory

For Your Card In This DIRECTORY - Phone 668-4448

CONCRETE READY MIX

MT. HOOD READY MIX
Ready Mix Concrete - Crushed Rock - Sand and Gravel
Phone 668-6515
Plant located at Firwood Junction

PHYSICIANS

Dr. Matthew I. Sgh
Osteopathic Physician and Surgeon
Office Hours: 8:30 a.m. to 6 p.m.
Sat. 8:30 a.m. to 12 noon
Daily except Wed. - Sun.
Off. Ph.: 668-6123 Across from Sandy Rexall
Hosp. Ph.: 234-0411 In Sandy Shopping Center Sandy, Ore.

SECURITY

Metropolitan Security
J. W. NICHOLSON
2006 S. E. DIVISION STREET
PORTLAND, OREGON 97202
Phone: (503) 232-0298

ELTON D. LEAVITT, M.D.
Physician and Surgeon
Office Hours: 9:00 a.m. to 5:00 p.m.
Daily except Wed., Sun. Sat. 9-1 P.M.
668-4117 MEDICAL BLDG., SANDY

CONSTRUCTION

CAT WORK - ALL TYPES
LANDSCAPING - ROAD BUILDING
LAND CLEARING
Glen Sheppard 668-4626 or 668-4635

OPTOMETRIST

DR. ROBERT D. SCHOUTEN
OPTOMETRIST
Office Hours 9 a.m. to 5:30 p.m. Daily
Closed Thursday and Sunday
114 W. Proctor 668-4313
Across from Trail Plaza Sandy

DEPARTMENT STORE

OPEN 9 a.m. to 8 p.m.
Cedar Plaza
DEPARTMENT STORE
668-4144

PLUMBING

BENSHOOF
Plumbing & Heating
Sales, Service, Installation
Sandy 668-4993

FUNERAL HOMES

SANDY FUNERAL HOME
303 Pleasant St.
Sandy, Oregon
Ken Hallgren, Owner 668-6015

REFRIGERATION

Repairing & Installing of Commercial Equipment a Specialty 663-3956 668-4804
RAY & ANN'S
COMMERCIAL APPLIANCE & REFRIGERATION
GUARANTEED SERVICE
THE RHANOVON B. 211 S. BAY BLVD. S.W. BILLYE ROAD SANDY, OREGON 97055 BETWEEN BAY & GRAND

FURNACES

Mattson's Heating & Appliance
SALES - SERVICE AND INSTALLATION
WE GUARANTEE OUR WORK
Bus. 637-3045 FREE ESTIMATES
EAGLE CREEK, OREGON

JERRY'S REFRIGERATION & APPLIANCE

All Major Appliance Repairs COMMERCIAL DOMESTIC
days 668-5688 evenings 330-4707

TRUCK LINES

SANDY TRUCK LINE
Moving General Freight
668-4148

REAL ESTATE

Cabins Lots Homes Acreage May We Sell Your Property?
MT. HOOD PROPERTIES REALTORS
Offices at Wemme & Brightwood Toll Free
Phone 622-3111 or 622-3112 227-0115

NURSING HOMES

BAUNACH Home for the Aged
Veterans - Social Security - Welfare
Gracious Living on Limited Income
Fine Food 668-6190

SAND and GRAVEL

ROCK CREEK SAND AND GRAVEL
Crushed Rock, Fill and Top Soil
658-3138

McGUIRE NURSING HOME

668-4633
Home for invalids, convalescent patients and those needing nursing care.
Martha C. McGuire, R.N.

LAND SURVEYOR

MARX & CHASE
Registered Land Surveyor
Registered Land Surveyor, Surveying, Mapping, Subdivisions. Office located at...
225 E. Burnside Ext. Gresham

UPHOLSTERING

SANDY UPHOLSTERY SHOP
Manning Webb
Now Open 9 a.m. - 5 p.m.
119 Main St., Sandy, Ore.
668-4033
FREE ESTIMATES

JOHN G. REPPETO

Registered Land Surveyor
8320 S. E. Stark St.
Portland, Oregon
Business Phone 253-0001 Home Phone 665-4471

TELEVISION

Christensen's TELEVISION SERVICE
"We Specialize in Both Sales & Service"
668-5110 110 W. Proctor

KNITTING MACHINES

BARBARA'S KNIT SHOP
Knitting Machines - Yarns
Designing - Custom Knitting
Rt. 3, Box 92 Sandy, Ore. 668-6843

Hoodland TV & Appliance

Service On All Makes Color & Black & White 622-4650
OR
Serving Sandy-Hoodland 761-7374

ELECTRICIAN

Bus. 668-5060 Mobile 202-4548
Timberline Electric
ELECTRICAL CONTRACTOR Residential - Commercial
502 S.W. Main Sandy, Oregon Dick Rasmussen

SAUNA

BOWMAN'S SAUNA AND MASSAGE
Wemme, Oregon
Thursdays 12 to 6
Phone for Appointments
JOHN SHERMAN Licensed Masseuse (503) 622-3101 Ext. 257

CONTRACTORS

JIM TURIN & SONS
PAVING CONTRACTORS
622-4491 After 6 p.m. Welches Rd. Wemme, Ore.



THIS HOME BUILT ON YOUR LOT FOR ONLY \$14,950!

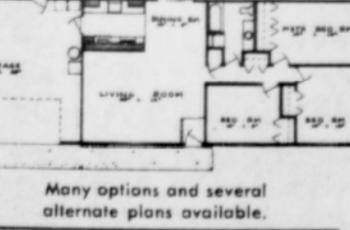

If you own a lot*, this is your answer to a new home—a modern home with quality construction, smart planning and a promise of happy living for you and your family!

This is a roomy home with every foot of space planned for contemporary living. Three bedrooms, large inviting living room and dining area, a delightful kitchen with an electric range, hood and self-cleaning oven, wall-to-wall carpeting, ceramic tile window sills and a big double garage.

Tualatin Development Company is well-known for its quality and reliable construction work. Our years of experience and knowledgeable management make it possible for us to build you this home for only \$14,950 on your lot using all top-quality materials and workmanship.

*If you do not have property, we will help you locate a site.

MODEL TUALATIN HOME OPEN every day from noon to dark. It is located on Pacific Highway (U.S. 99W) just beyond the entrance to King City, 1 mile south of Tigard. Come see this excellently built and planned home and let us tell you how we can build it for you on your lot.

TUALATIN DEVELOPMENT CO., INC.

builders of "good living" projects... King City, Indian Hills, Royal Mobile Villas and King City Townhouses.
SALES BY TDC CO. REALTORS
15575 S.W. 116th Avenue
King City (Tigard), Oregon 97223
Phone: 620-2412 or 639-7220

MAIL TODAY!

Tualatin Development Co., Inc.
15575 S. W. 116th Avenue, Box K
Tigard, Oregon 97223

Send me a FREE copy of your new brochure showing all the details and plans for the Tualatin Home.

I own some property. I can get property.
 I'm really interested—check twice!

Name _____
Address _____
City _____
State _____ Zip _____ Phone _____

During 1970 (the most recent figures available) the average worker suffered 14.6 disability days — which means he was healthy about 96 per cent of the time.