

# Building levy to provide new science complex

By Cyndi Bacon  
Of The Print

The temporary science complex, which the College has used for 12 years, is scheduled to be replaced upon passage of the three year rate-based serial levy on April 4.

Passage of the serial levy will raise approximately \$3 million over the next three years for construction purposes.

The serial levy will cost taxpayers 30 cents per \$1,000 assessed property value.

The science complex is the first building priority set by the Long Range Planning Committee.

The planning committee consists of the planning officer, two school board members, two administration members, two faculty members, two classified employees, two student representatives and two members of the community not affiliated with the College.

Priorities were set in meetings and discussions held over an 18-month period ending October 1977, according to Don Fisher, facility development and planning officer.

"The master plan is very viable," Fisher said. "Whatever in the future comes up, the plan is flexible enough to change with it," to up date current campus growth and course trends, he said.

General classroom and common area, site development, and science facilities including chemistry, biology, physical science and geology are all planned in the construction of the science complex.

As shown in the overall concept diagram, the building site is planned for the west end of the parking area near the south end of Barlow hall.

Part of the construction money will be used for the second series of priorities which is the planning of additional space for vocational curriculums primarily in the machine shop, automotive repair, welding, hydraulics and industrial-technical areas.

The money raised from the serial levy will not be enough to fully construct the science and vocational facilities, according to Fisher. Construction funds from the state legislature will help make up the rest needed for full construction.

"Science is on the top of the list (of priorities)," said Bill Ryan, dean of college services. "Past that, it's just waiting to see what the legislature will decide as to how much money will be allotted. We may not know just how much we get until May of 1979, but we do know we will be getting some (money)."

If guidelines and decisions are followed, the overall concept diagram is only similar in character to the actual final building plans, according to Rob Barrentine of Reddaway Associates, which is the architectural firm along with Rockrise Odermatt Mountjoy Associates, now working on the schematic design and design development phase of the science complex.

If the serial levy passes, the architects will go ahead with the construction documents which are bids, final plans and specifications, according to Fisher.

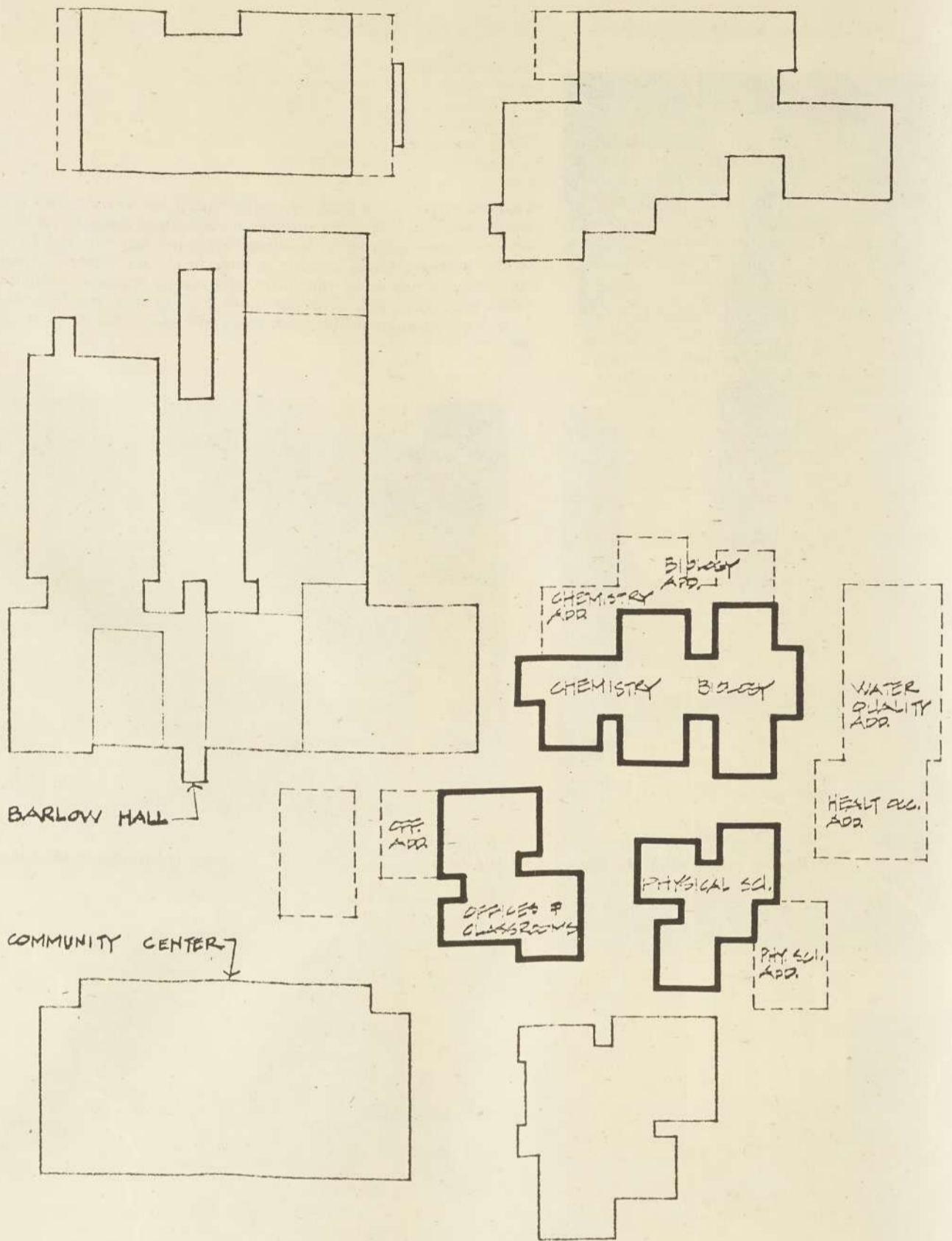

OVERALL CONCEPT DIAGRAM

The dark lines at right represent space provided for the proposed science complex. The dotted lines around the buildings represent space provided for additions if future course growth warrants it. The two

buildings located at the far top of the map are the proposed auto and welding facilities. The Overall Concept Design is similar in character to actual future construction and shows space allocation only.

**TRI-CITY BOWL**  
MOLALLA AVE  
AT WARNER-MILNE RD  
P O BOX 292  
OREGON CITY, OR 97048  
SEV HARKSON  
OWNER/MANAGER

**Pool  
Pinball  
Bowling**

635-2603

**Clean City**  
FULL SERVICE CLEANERS

- Professional Dry Cleaning
- Budget Bulk Cleaning
- Laundry Service
- Alterations
- Leather Care

Two Locations To Serve You  
OREGON CITY 1103 LINN AVE 656-1861  
GLADSTONE 445 PORTLAND AVE 656-5550  
Open Mon. Thru Sat.

The word gets around. . .

**HAIR'S WHERE IT'S AT**

for professional hair styling

Open 8:30-5:00 Tuesday thru Saturday  
Open evenings Tuesday, Wednesday and Thursday by appointment only

239 N. W. 2nd Ave.  
Canby, Ore. 97013

Holly Mall 266-2322

