

561 Ranches

561 Ranches

561 Ranches

561 Ranches

561 Ranches

561 Ranches

561 Ranches

561 Ranches



**Missing Something?**  
Capital Press has what you're looking for and more!

**Capital Press**  
1-800-882-6789  
CapitalPress.com

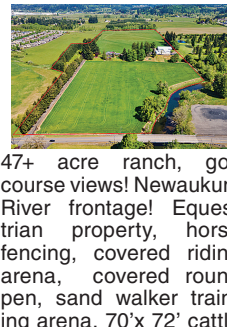

47+ acre ranch, golf course views! Newaukum River frontage! Equestrian property, horse fencing, covered riding arena, covered round pen, sand walker training arena. 70'x 72' cattle building with equipment, 6 bay parking garage, 2 bay shop. 2 barns, multiple grass paddocks, irrigation equipment. Beautiful 4300+ sq. ft home. \$2,200,000. Chehalis, WA. Contact Paula Burrows 360-520-4810 RE/MAX PREMIER GROUP

**HOT! SAVINGS at Capital Press**  
1-800-882-6789  
CapitalPress.com

**Income-Producing RANCH**  
**LOWER CLEARWATER CANYON RANCH**  
Approximately 685 acres canyon range land above Clearwater and Potlatch Rivers, east of Lewiston, Idaho via Cherry Lane Bridge. Good fall and spring cattle pasture. Stock water improvements. Home site with well and outbuildings; newer pole building, big old barn, good machine shed, shop with living quarters. Access by county road. **Two cell towers provide significant monthly income.** Whitetail, Mule Deer, Game Birds. Asking \$875,000. Send inquiries to: odieproperties@gmail.com

**CEDARVILLE, CA. HAY & CATTLE RANCH.**  
296+/- ACRES flood irrigated meadows, 1st water right, comfortable vintage home, barns, corrals \$1,420,000; **176+/- ACRES fenced spring grazing ground north of Davis Creek, CA.** with ponds & well \$175,000. Buy one or both. Call 530-250-7122

**Check Out our line ads @ CapitalPress.com**  
Call in your classified ads by Wednesday:  
10:00 .... Display Ad  
Noon ..... Line Ad  
1-800-882-6789

Looking For A Relaxed Off Grid Lifestyle? This Property Is A "Must See"! 2544 Deeded Acres with 283 Irrigated & 2260 BLM. Run 75 to 100 Head Of Cattle, Prior 18 Years Guest Ranch Sleeps 12, Hunt Trophy Mule Deer, 8 Ponds, Home, Shop, Barn, Stalls, Greenhouse, Hay Storage. 30 Miles From Lakeview, OR. \$2,200,000 RMLS #21237893 541-575-2617 www.dukewernerrealtyeasternoregon.com ljh@ortelco.net

**Buying or Selling**  
Capital Press is here to help you!  
1-800-882-6789 or FAX 503-370-4383  
CapitalPress.com

**KNIFE LAND**  
Timbered Land - OR  
Timbered land parcels in NE Oregon ranging in size from 795± to 9,772± acres, all with great hunting and recreation. \$1,140,000 - \$9,319,000  
Winchester Ranch - ID  
605± acres with log home and shop, 2 barns, and cabin. Pasture, farmland and timber. \$2,999,000  
Reubens Farm - ID  
200± acres has farmland, a pond, timber, pole barn with 220 power, covered RV pad, and building site with well, septic, power, and great views. \$829,000  
208.345.3163 knipeland.com

**Capital Press CLASSIFIEDS**  
1-800-882-6789  
CapitalPress.com

**BEAUTIFUL RANCH IN NEVADA**  
**950± acres \$5,250,000**  
Santa Rosa Meadows Ranch. Paradise, Humboldt County, Nevada.  
New 1,700 ft<sup>2</sup> Custom Home; 1,116 ft<sup>2</sup> shop; 1,080 ft<sup>2</sup> garage; 600 ft<sup>2</sup> carport; 1,026 ft<sup>2</sup> home; 6 wells; 4,814 ac. ft. water rights; 3 pivots, Feedlot, Pens, corrals, scale, walk-in freezer; & more  
**Berney Realty, Ltd.**  
Cari Norcutt  
Broker - Owner  
775-426-8023

**CAPITAL PRESS LINE CLASSIFIEDS**  
Fast Results! Easy to Do!  
CALL TOLL-FREE: OR ONLINE  
1-800-882-6789 | 24/7/365  
CapitalPress.com

**THE WHITNEY LAND COMPANY**  
EST. 1970  
**Farm, Ranch, & Recreation**  
**541-278-4444**  
101 S.E. 3rd St., Pendleton, OR 97801  
www.whitneylandcompany.com

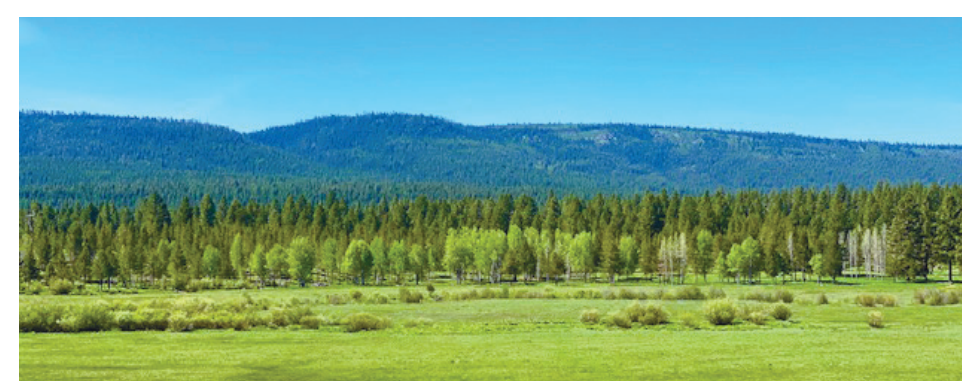

**Jim Whitney** CJM/Owner/Principal Broker  
**Todd Longgood** Owner/Broker  
**Gary Jellum** Broker  
**Timothy "Scott" Coe** Broker  
**Blake Knowles** Broker  
**Travis Bloomer** Broker  
**Christopher Stuvland** Principal Broker  
Licensed in the state of Oregon

**Powder River Keating Ranch** - Baker County, Keating, OR - 1536 +/- acres. **\$4,899,000** CP#00619  
**Hilltop Acres** - Douglas County, Winston, OR - 387+/- acres. **\$4,250,000** CP#02317  
**Imnaha River Ranch** - Wallowa County, Imnaha, OR 4655 +/- acres **\$3,800,000** CP#01020  
**Brown Canyon Imnaha River Ranch** - Wallowa County, Imnaha, OR 4404 +/- acres **\$2,400,000** CP#01120  
**Daybreak Ranch** - Baker County, OR - 4,825 +/- acres. **\$2,299,000** CP#01618

**Hermiston Development Property** - Umatilla County, Hermiston, OR - 40+/- acres. **\$2,229,000** CP#02216  
**Athena Crop and Range Parcels** - Umatilla County, Athena, OR - 1200+/- acres **\$2,106,330** CP#00919  
**Lostine River Ranch** - Wallowa County, Lostine, OR, 356 +/- acres. **\$1,800,000** CP#00821  
**Hail Ridge Farm** - Gilliam County, Heppner, OR - 2573 +/- acres **\$1,700,000** CP#03018  
**Tachella Wheat Farm** - Umatilla County, Pendleton, OR - 113 +/- acres **\$1,381,080** CP#00320

**Walker Farm** - Umatilla County, Stanfield, OR 67 +/- acres **\$1,350,000** CP#02620  
**Umatilla River Mountain Property** - Umatilla County, Pendleton, OR - 1906 +/- acres. **\$1,324,670** CP#00319  
**Whitney Valley Ranch** - Baker County, Sumpter, OR - 782 +/- acres **\$1,250,000** CP#01220  
**Pinherio Ranch** - Baker County, Unity, OR 1876 +/- acres **\$1,219,400** CP#01520

**Scott Ranch** - Umatilla County, Pendleton, OR - 39 +/- acres **\$1,149,000** CP#00421  
**Spriet Ranch** - Baker County, Baker City, OR - 115 +/- acres. **\$1,100,000** CP#00121  
**Low Eiseman CRP Farm** - Umatilla County, Milton-Freewater, OR, 1026 +/- acres. **\$1,025,000** CP#01021  
**Sutton Creek Pivot Ranch** - Baker County, Baker City, OR - 554 +/- acres **\$970,000** CP#00521

**The Arritola Ranch** - Baker County, Haines, OR, 39 +/- acres. **\$840,000** CP#00321  
**Double Bar F Ranch** - Malheur County, Ontario, OR - 115 acres **\$800,000** CP#00721  
**Phipps Meadow Ranch** - Grant County, Sisters City, OR - 278 +/- acres **\$795,000** CP#01920  
**Pilot Rock CRP** - Umatilla County, Pilot Rock, OR - 1160 +/- acres **\$750,000** CP#02420

**Storie Ranches** - Umatilla County, Pendleton, OR - 522 +/- acres. **\$560,000** CP#00519  
**Omlin Ranch** - Morrow County, Heppner, OR - 600+/- acres. **\$550,000** CP#01620  
**Imnaha Timber Tract** - Wallowa County, Imnaha, OR - 156 +/- acres **\$350,000** CP#00621  
**Spring Hollow Wheat Farm** - Umatilla County, Adams, OR - 200 +/- acres **\$320,000** CP#00419  
**Greenhorn Property** - Baker County, Greenhorn, OR - 100+/- acres. **\$200,000** CP#01419  
**Theater Road Buildable Parcel** - Umatilla County, Pendleton, OR - 22 +/- acres **\$150,000** CP#01519

564 Farms 564 Farms 564 Farms 564 Farms 564 Farms 564 Farms 564 Farms 564 Farms

**FarmSeller FARMSELLER.COM Find the land, farms, and ranches you're looking for**

**DIRECTORY OF PREMIUM AGENCY MEMBERS**

 Brook Havens Cascade Sotheby's International Realty 541-604-0788	 Patty Cordoni Cascade Sotheby's International Realty 541-771-0931	 Pam Mayo-Phillips Cascade Sotheby's International Realty 541-480-1513	 Linda Long Crater Lake Realty Chiloquin, OR 541-783-2759	 Jerry Franklin Eastern Oregon Realty John Day, OR 541-575-2121
 Tim Cobb Farmland Company Spokane, WA 509-624-4408	 Robert Bacon Fischer Nicholso Realty Klamath, OR 541-545-1510	 Stacey Moyles Century 21 Showcase Klamath Falls, OR 541-882-2121	 Lisa Johnson Horsepower Real Estate Junction City, OR 541-510-4601	
 John Lee Lee Real Estate Aumsville, OR 503-245-9090	 Paul Terjeson Oregon Farm Brokers Corvallis, OR 503-999-6777	 Jason Nash Keller Williams Realty Southern Oregon 541-591-5195	 Steve Helms Keller Williams Farm & Ranch Albany, OR 541-979-0118	 Curtis Hitchcock Knipe Land Company Boise, ID 208-866-2825
 Janey Knipe Knipe Land Company Boise, ID 208-345-3163	 John Knipe Knipe Land Company Boise, ID 208-345-3163	 Tom Gill Knipe Land Company Mountain Home, ID 208-860-0776	 Julie Mansfield-Smith Mossy Oak Properties Copper Creek Land Co. Kimberly, OR 541-519-6891	 Jake Polvi POLVI Bend, OR 541-410-3050
 John Collins Ranch-N-Home Realty La Grande, OR 541-963-5450	 Judy Willis Real Estate Associates Joseph, OR 541-432-4060	 Ken Wick Real Estate Associates Joseph, OR 541-432-4060	 Mark Jones Robert Jones Realty Twin Falls, ID 208-733-0404	 Kirk Makin Ruby Peak Realty Joseph, OR 541-432-3131
 Claessee O'Connor Timberline Realty Joseph, OR 541-432-1234	 Jim Whitney Whitney Land Company Pendleton, OR 541-278-4444	 Todd Longgood Whitney Land Company Pendleton, OR 541-278-4444	 Robert Carnahan Artisan Real Estate Associates Dufur, OR 503-313-0419	

**CALIFORNIA**  
HOLLISTER SAN BENITO REALTY 831-637-5563

**IDAHO**  
BOISE KNIFE LAND 208-345-3163  
POCATELLO INTERMOUNTAIN LAND EXCHANGE, INC. 208-232-8306  
STAR FLINDERS REALTY & EXCHANGE 208-334-3840  
TWIN FALLS ROBERT JONES REALTY INC. 208-733-0404

**MONTANA**  
BILLINGS ROCKY MTN. RANCH REAL ESTATE 406-259-6666  
MISSOULA STELLING RANCH & LAND 406-728-9200

**NEVADA**  
FALLON BERNEY REALTY LTD. 775-426-8023

**OREGON**  
ALBANY KELLER WILLIAMS FARM & RANCH 541-979-0118  
AUMSVILLE LEE REAL ESTATE 503-245-9090  
BAKER CITY AGRILANDS REAL ESTATE 541-853-1212  
INTERMOUNTAIN REALTY 541-523-4434  
BEND CASCADE SOTHEBY'S INTERNATIONAL REALTY (PAM MAYO AND BROOK HAVENS) 541-923-1376  
CASCADE SOTHEBY'S INTERNATIONAL REALTY (PATTY CORDONI) 541-771-0931  
COLDWELL BANKER BAIN 541-280-4372  
FAY RANCHES 541-419-0770  
POLVI 541-410-3050  
BONANZA FISHER NICHOLSON REALTY, LLC 541-545-1510  
BURNS JETT BLACKBURN REAL ESTATE 541-573-7206  
CHILOQUIN CRATER LAKE REALTY 541-783-2759  
CORVALLIS OREGON FARM BROKERS 503-999-6777  
DAYVILLE DUKE WARNER REALTY 541-987-2363  
DUFUR ARTISAN REAL ESTATE ASSOCIATES 503-313-0419  
JOHN DAY EASTERN OREGON REALTY 541-575-2121  
JOSEPH REAL ESTATE ASSOCIATES 541-432-4060  
TIMBERLINE REALTY 541-432-1234  
RUBY PEAK REALTY 541-432-3131  
JUNCTION CITY HORSEPOWER REAL ESTATE 541-510-4601  
KIMBERLY MOSSY OAK PROPERTIES CUPPER CREEK LAND CO. 541-519-6891  
KLAMATH FALLS KELLER WILLIAMS REALTY SOUTHERN OR 541-591-5195  
CENTURY 21 SHOWCASE REALTORS, INC. 541-882-2121  
LA GRANDE RANCH-N-HOME REALTY 541-963-5450  
LAKEVIEW HIGH COUNTRY REAL ESTATE 541-417-0250  
MEDICAL SPRINGS AGRILANDS REAL ESTATE 541-853-1212  
NORTH BEND CADWELL REALTY GROUP 541-740-9854  
RE/MAX SOUTH COAST 541-290-1850  
ONTARIO TOM PHILLIPS AGENCY 541-889-8401  
PENDLETON WHITNEY LAND CO. 541-278-4444  
SALEM AGRI-BUSINESS REAL ESTATE 503-371-6409  
SILVERTON HARCOURTS NW OREGON REALTY GROUP 503-873-8600  
WILSONVILLE WOLF PROPERTIES NW 503-682-1789

**TEXAS**  
DIMMITT SCOTT LAND CO. 800-933-9698

**WASHINGTON**  
BURLINGTON RE/MAX TERRITORY NW 360-755-9494  
CHEHALIS CENTURY 21 LUND REALTORS 360-748-8619  
SPOKANE FARMLAND COMPANY 509-624-4408  
TOLEDO RE/MAX PREMIER GROUP 360-520-4810