

356 Ranches

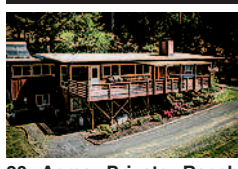

233 Acres M/L with Pivot Irrigation: 2423 sq.ft. custom built, 3 bdr, 2-1/2 bath home with vaulted ceilings, barn, hay building, shop and lots of outbuildings. Also, an additional caretaker or hired help home on the property. Located on the East side of the valley with views of Mt. Emily, the Grande Ronde Valley and a backdrop of Mt. Harris and Mt. Fanny. Priced at \$1,400,000. Ranch-N-Home Realty, Phillip Burling, John Collins principal brokers. www.ranchnhome.com, 541-963-5450, 1526 Jefferson Avenue, La Grande, OR, 97850

356 Ranches



20 Acres Private Ranch Plus Adjacent 24 Acres: timbered land available in Coos Bay, OR. Huge shop 44'x48', 4 stall barn and a riding arena. Amazing valley view from a 3300 sq.ft., 6 bedroom, 4 bath, 1 level home. Hot tub, game room, separate canning kitchen and you own salmon run up Boone Creek. \$465,000. MLS #17143497. Visit: www.tourfactory.com/1786696 Jan Delimont, Broker/ Owner REMAX South Coast 541-290-1850 jan@coosbayproperties.com

356 Ranches



7000 Acre Ranch, Midvale, ID. \$7,600,000. Expert Realty, LLC. Kelly Jensen, Michael Sampson, 208-521-4222 www.idahoranchlandandfarmsale.com

190 Acre Ranch: Secluded, spectacular views, barn with apartment, timber, creek, more. Medimont, Idaho, near CDA. Very motivated. \$1,295,000. Prime Real Estate Group. Bob Mattson 208-930-5566

356 Ranches



NEW LISTING
Barr Ranch - Bend Equestrian Facility
27.8 acres, 10 acres water rights.
Borders BLM.
\$1,100,000

www.barranch-bendoregon.com

356 Ranches



Cascade Sotheby's International Realty
Farm & Ranch Division
650 SW Bond St., Ste 100
Bend, OR 97702

356 Ranches



PAM MAYO-PHILLIPS & BROOK HAVENS
PRINCIPAL BROKERS
541.480.1513 | 541.604.0788
pam.mayo-phillips@sothebysrealty.com
brook.havens@sothebysrealty.com
www.desertvalleygroup.com

356 Ranches

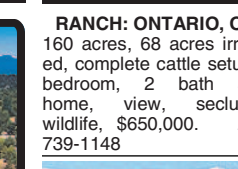

RANCH: ONTARIO, OR. 160 acres, 68 acres irrigated, complete cattle setup. 3 bedroom, 2 bath stick home, view, secluded, wildlife, \$650,000. 208-739-1148

648 Acres Indian Valley, ID. High Desert Rangeland, fenced, additional 40 acres BLM lease included, next to public lands, large spring fed pond. Additional acreage purchase possible, great Mule Deer, Elk and Antelope hunting, \$648,000. Donna Cave, Licensed Agent, Silver Creek Realty Group 208-315-2888

356 Ranches

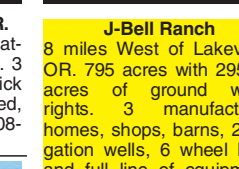

J-Bell Ranch
8 miles West of Lakeview, OR. 795 acres with 295 +/- acres of ground water rights. 3 manufactured homes, shops, barns, 2 irrigation wells, 6 wheel lines and full line of equipment. \$1,950,000. Favell-Utley Realty. www.favell-utley.com 541-947-2161.

380 Farms
Farm Seller
BUYING RURAL PROPERTY?
• Ranches • Ranchettes
• Land • Acreage
• Horse Property • Pasture
Visit Today!
www.farmseller.com

Buying or Selling
Capital Press is here to help you!
1-800-882-6789
or FAX 503-370-4383
www.capitalpress.com

Local Friendly Professional
541-889-8160
937 SW 30th St.
Ontario, OR

AG Investment Brokers
LAND
AG Real Estate Specialists
Tehama County Cattle Ranch
2,690 AC on Thomes Creek. Rancho Bello has (5) reservoirs, springs, good fencing, (6) separate pastures, paved county road. 200 winter calving cow capacity. Multiple barns, steel corrals, community water, power and septic. Good hunting, fishing.
New \$2,780,000
530.529.4400
AGLANDBROKERS.COM
BRE #01707128 30-3/18

Vale Oregon - 79+/- acres with irrigated pastures and fields. Live water in two draws and a 4050+/- sq. ft. home. Minutes from town. Offered at **\$465,000. #340-17**

Row crop farm - 349+/- acres with pivot irrigation. Pivots and pump station all very new. 3 bdrm, 2 bath manufactured home included. **\$1,860,000. #317-17**

Vale Oregon - 704+/- acres for sale - Farm/Ranch combo - Excellent soils for farming and established irrigated pastures. Home, working cattle facilities under cover and sale barn. **\$2,899,000. #318-17**

Pivot irrigated land. 239+/- acre farm with Vale Oregon Irrigation District water rights, two newer pivots. Small house on property under life estate. **\$1,225,000. #320-17**

PRICE REDUCED - Nyssa farm property - 55+/- acre row crop farm with excellent soils and water rights. 2576+/- sq. ft., 3 bdrm, 2 bath home and large five overhead door shop. **\$595,000. #295-16**

For more information, call:
Scott Lamb Broker, GRI, OR/ID 208-739-2119 cell
Dee Anne Mosman Broker, GRI, OR/ID 208-707-4444 cell

Office - Toll Free 1-800-398-3457
www.waldore.com

Capital Press Classifieds
1-800-882-6789
Fax (503) 370-4383 www.capitalpress.com

ANTONE RANCH
MITCHELL, OREGON

100 miles east of Bend, Oregon this legacy recreational ranch consists of 36,663+/- deeded acres in a large private block with exceptional water resources, including live water creeks, numerous fishing lakes and irrigated lands. With the Spanish Peak as its backdrop, the topography ranges from timber covered slopes, grassy hillsides, steep canyons and large irrigated meadows. Elevation ranges from 6000 feet down to 2600 feet with over 10 miles bordering the Ochoco National Forest allowing for diverse wildlife habit. \$75M

Robb Van Pelt
970-718-2717
robb@ranchland.com
www.RanchLand.com

HALL AND HALL
Dedicated to Land and Landowners Since 1946

MCEWEN RANCH & CATTLE COMPANY
RIVERSIDE, OREGON
Expansive legacy ranching operation encompassing 52,445± deeded acres and 100,000± acres of grazing allotments in southeastern Oregon. Capacity for 1,525 cows and producing hay on 1,500± acres.
Offered at **\$20,000,000**

COVE RANCH
SUN VALLEY, IDAHO
This 4,636± acre ranch is located within its own private valley 10 minutes from Sun Valley's airport and features superior water rights, a ranch compound, and ongoing farming and grazing operations.
Offered at **\$13,500,000**

MULDOON CREEK RANCH
SUN VALLEY, IDAHO
Located 25 miles east of Sun Valley, this scenic mountain ranch features 1,440± deeded acres, irrigated pastures, a comfortable home, and over one mile of a year-round trout stream. Adjacent to public lands.
Offered at **\$2,250,000**

TRENT JONES | 208.622.4133 | TJONES@HALLANDHALL.COM
SALES | AUCTIONS | FINANCE | APPRAISALS | MANAGEMENT

FISHHOLE CREEK RANCH

- A true slice of heaven and historic piece of property in Oregon's Southeastern Corner.
- Operated for more than 150 years.
- 14,000 total acres; just under 4,000 are deeded, the rest is a long-standing, adjacent U.S. Forest Service permit with rich feed for 800 pair of cows/calves.
- A 7,000 square-foot log lodge and five 1,250 square-foot log cabins - Aspen Ridge Resort - allow for sophisticated living conditions despite the property's remoteness and could be used as a private family or group retreat complex

\$10,600,000 • MLS#2969372

Crater Lake Realty, Inc.
Linda L. Long, Broker
541-891-5562
Chiloquin, OR
linda@craterlakerealtyinc.com • craterlakerealtyinc.com



TOM'S PLACE - CRANE, OREGON
754± Acres | \$825,000

This is a wonderfully private small ranch with 110± acre new pivot, bordering BLM with some crested wheat ground. A newer 3-bedroom home is set back against the mountain rim and is close to K-12 school. Complete with a small stream!

FAY RANCHES, INC.
Ken Bentz, Principal Broker
541.647.0657
KBentz@FayRanches.com
www.FayRanches.com

2017 AMERICA'S BEST BROKERAGES

FARMS • TIMBER • RANCHES • PLANTATIONS



PRICE REDUCED!

McKinnon Farm - Powell Butte, OR
\$925,000 • 79.4± acres

"The best value on the market today! 73.8± acres of irrigation, fully equipped with shop, hay shed, 2 homes, Cascade Mountain views and more."

Jerry Hicks, Principal Broker
541.420.0679 • jhicks@fayranches.com
www.fayranches.com | info@fayranches.com

FAY RANCHES, INC.
FARMS • TIMBER • RANCHES • PLANTATIONS

LIFE STYLE - CATTLE RANCH

WORKING • HUNTING • FISHING
• UNBELIEVABLE (BASICALLY FREE) WATER RIGHTS • 450 ACRES IRRIGATED • RATED 500 ANIMAL UNITS • 4,100 DEEDED • PRIVATE BLM • QUALITY IMPROVEMENTS

** POSSIBLE OWNER CARRY OR PARTIAL TRADE WITH ADEQUATE DOWN **

Check Brochure @ agrilandsrealestate.com

Jack Horton 208-830-9210
Rae H. Anderson 208-761-9553
AGRILANDS REAL ESTATE
Medical Springs, OR
541-853-1212
agrilandsrealestate.com

380 Farms

PACIFIC NORTHWEST PROPERTIES

WASCO COUNTY, CLARNO, OR - 47,120+/- ac. 29,279+/- ac deeded with an additional 11,000 ac of BLM and 7,000 ac of USFS leased lands. Over 8 miles of deeded river frontage on the lower John Day River. Exceptional fishing. **\$19,750,000 CP#03015**

UMATILLA COUNTY, UKIAH, OR - 16,200 contiguous ac 7 miles SW of Ukiah. Premier hunting and recreation. **\$12,960,000 CP#01015**

UNION COUNTY, NORTH POWDER, OR - This private 2,518+/- acre ranch is located at the base of the Elkhorn Mountains. 11,000+/- square foot custom built timber frame home with guest quarters. Outbuildings include multiple workshops. Elk, deer and turkey hunting, and stocked fishing ponds. **\$7,500,000 CP#00217**

UMATILLA COUNTY, PENDLETON, OR - 737+/- deeded ac of which 549 ac are irrigated under center pivots. 115 ac dryland crop enrolled in CRP and 62 ac rangeland. Main home and outbuildings. Deer and bird hunting. Broker owned. **\$4,500,000 CP#01316**

MALHEUR/ BAKER COUNTY, IRONSIDE, OR - 6,860 contiguous ac, excellent water including over 30 springs, superior hunting opportunity, corrals with truck access and separate holding pasture, currently runs 300 head for 6 months. **\$4,300,000 CP#02116**

UNION COUNTY, MEDICAL SPRINGS, OR - 5,350 contiguous ac timber parcel inside a larger 9,560 ac grazing area w/ additional 2,400 grazing ac negotiable for lease from seller. Ponds and springs. LOP tags for deer and elk. **\$3,445,000 CP#02514**

BAKER COUNTY, BAKER CITY, OR - 559.09 ac. with house, barn and hay shed. 547.9 ac of water rights. Wheel line and flood irrigation. **\$2,300,000 CP#00317**

BAKER COUNTY, BAKER CITY, OR - Keating Valley 425 ac irrigated hay/pasture ranch. 360 ac Powder River water rights. 8 Tower pivot. 196 ac irr along river. Remodeled home. Shop w/working facilities. 1 mo BLM permit out the gate. 18 miles from Baker City. **\$2,300,000 CP#00617**

DOUGLAS COUNTY, CANYONVILLE, OR - South Umpqua River Ranch has river frontage and 618.17 ac with 142 ac irrigated cropland/pivot and hillside pasture. 5 ac / 2 homesites, feeder barns, hay barns, milk parlor and shops/storage. Water rights. **\$1,999,000 CP#00517**

MORROW COUNTY, MORROW, OR - 1,273 ac with 2,731 ac of which 200 ac are irrigated. 150± ac on a year-to-year lease. **\$1,650,000 CP#01317**

MORROW COUNTY, LEXINGTON, OR - 337 ac equine facility which includes 65 ac irrigated lands, 261 ac CRP, 3,349 SF home, and complete horse facilities. Additional 225 ac water rights. Turn-key operation. **\$1,600,000 CP#00616**

BAKER COUNTY, KEATING, OR - 262 ac. Nice home, additional living quarters, shop, irrigated pasture, 1 mile of Powder River frontage. 127 ac water right, 2.5 ac pond. **\$1,550,000 CP#00416**

UMATILLA COUNTY, HERMISTON, OR - 38.5 acre small scale, full operation facility. Shop, pivot irrigated fields, small feed lot, corral system, pastures, and a 2,400 sq. ft. custom built home. **\$1,500,000 CP#01117**

GRANT COUNTY, MT. VERNON, OR - 464.03 total ac. 55 ac of pasture, 330 ac planted to spring barley and alfalfa. 8 springs located throughout. 2015 Marlette Home-3 bedrooms-2 bath-office-carport. Fully fenced perimeter with new fence. Great deer and quail hunting. **\$1,350,000 CP#02217**

GILLIAM COUNTY, CONDON, OR - 1,976.64 total ac. Deer, elk, and upland birds. Currently 837.74 ac of range, 984.96 ac of dryland crop, and 153.94 ac under CRP contract. Home with bunkhouse and outbuildings. **\$1,335,430 CP#02716**

WHEELER COUNTY, MITCHELL, OR - 1,475 total ac of timber and range. Bridge Creek, seasonal creeks and springs, elk and mule deer. **\$1,143,125 CP#03415**

BAKER COUNTY, HEREFORD, OR - 1,560 ac. Perennial streams, springs, timber, corrals. Excellent hunting, 3 LOP tags. **\$934,440 CP#02915**

BAKER COUNTY, KEATING, OR - 1,312 ac timber parcel with mountain pasture. Balm Creek Reservoir. Stream and springs. LOP tags. Located adjacent to Wallowa Whitman National Forest. **\$899,000 CP#00714**

UMATILLA COUNTY, PENDLETON, OR - 1402 ac. 1288 ac. expired CRP. 45 bu. average historical wheat production. Suitable for pasture and/or renewed wheat rotation. Good ROI. **\$865,900 CP#00417**

GILLIAM COUNTY, CONDON, OR - 1,398.18 total ac. CRP 108.01 ac, 784.24 ac of range and 505.93 ac currently seeded to wheat. No improvements. Great deer, elk, and Chukar hunting. **\$700,491 CP#02616**

BENTON COUNTY, KENNEWICK, WA - 6.29 ac with an indoor arena, horse barn, shop, with a new 2,254 square foot home. **\$625,000 CP#02916**

GRANT COUNTY, JOHN DAY, OR - 168.6 acres. 4 irrigated ac. fenced into 4 pastures. Home, shop, horse barn and shed, riding arena. Abundant with wildlife and excellent shed antler hunting. **\$595,000 CP#01017**

MALHEUR COUNTY, ONTARIO, OR - 115 ac, 66 ac irrigated. Pond, 2,500 sq. ft. home, and outbuildings. Wildlife, views, 6 miles from Ontario. **\$550,000 CP#01915**

BAKER COUNTY, HAINES, OR - 88.98 ac. nestled at the base of the Elkhorn Mountains. Main house, several outbuildings, hay/livestock barn and cattle working facility. Irrigated grass pasture. **\$549,000 CP#03116**

UMATILLA COUNTY, WESTON, OR - Investment opportunity. 102 +/- forested ac, 65 ac zoned FR allows development of 5 ac tracts. Power and well. Wildlife. **\$525,000 CP#02416**

UNION COUNTY, UNION, OR - 325.97 +/- ac. Timber parcel with 1/2 mile of Catherine Creek. 1 mm BF timber per 2010 cruise. Adjacent to USFS. Downstream from wilderness access area. 11 mi. south of Union. **\$499,000 CP#02614**

UMATILLA COUNTY, PENDLETON, OR - Dryland wheat/CRP farm, Missouri Gulch. 394.73 ac northwest of Pendleton. 172 ac. enrolled CRP through 2022 and 220 ac. in production. **\$395,000 CP#02914**

GILLIAM COUNTY, CONDON, OR - 939.75 total ac. Property consisting of 612.27 ac of range, 229.52 ac currently in wheat production, and 97.96 ac of CRP. Abundant deer, upland birds, occasional elk. **\$385,979 CP#02516**

UMATILLA COUNTY, PENDLETON, OR - Development potential 76.37 ac parcel. Zoned to allow the creation of 4ea nine ac lots with 40+ ac of river bottom remaining for recreation. **\$350,000 CP#02415**

The Whitney Land Co.
541-278-4444
www.whitneylandcompany.com
101 S.E. 3rd | P.O. Box 1614, Pendleton, OR 97801

• Jim Whitney, CCIM/Owner/Principal Broker
• Gary Jellum, Broker
• Timothy "Scott" Coe, Broker
• Todd Longgood, Owner/Broker
• Blake Knowles, Broker
• Christopher Stuvland, Broker
• Travis Bloomer, Broker

MORROW COUNTY, ECHO, OR - CRP income property. 186.9 ac of land with 157.7 ac of CRP, power and well. The balance of the property is range pasture. **\$295,000 CP#03515**

UNION COUNTY, UNION, OR - Buildable 80 +/- ac near Tollgate and the Spout Springs Ski Resort on the breaks of Lookingglass Creek. Bordered on 2 sides by Umatilla National Forest. **\$290,000 CP#02316**

BAKER COUNTY, BAKER CITY, OR - 230 +/- ac. timber parcel located between Rock Creek and Muddy Creek. Adjacent to ODFW area at the base of the Elkhorn Mountains. Buildable. Located 8 mi West of Haines. **\$240,000.00. CP#00717**

MORROW COUNTY, PENLAND LAKE, OR - Off grid, lakeside cabin. 2.18 ac timbered lot on pristine lake with private dock. Cabin has 2 bedrooms, loft, kitchen, deck overlooking lake. Solar power, well, septic, and cell phone booster, private lake access. **\$225,000 CP#02117**

MORROW COUNTY, PENLAND LAKE, OR - Lake front cabin on 2.2+/- forested acre lot. 2 bedrooms, loft, kitchen, and bathroom. Off grid with solar power, well, and septic. Private lakeside dock. Borders U.S. forest service. **\$225,000 CP#02017**

UMATILLA COUNTY, TOLLGATE, OR - 5 acres of buildable land consisting of 2.18 ac of CRP, power and well and is zoned MUF. Build your dream home and enjoy this unique opportunity. **\$180,000 CP#01217**

BAKER COUNTY, OXBOW, OR - 160 ac hunters paradise surrounded by BLM and NF 3 sides. Good water and timber. Zoned timber/grazing. **\$160,000 CP#01916**

SHERMAN COUNTY, WASCO, OR
The Recreational John Day River Frontage Property offers an opportunity to have a 37.5% shared undivided interest in 192 acres along the John Day River. **\$85,000.00 CP#02816**