

380 Farms
10 ACRES IRRIGATED WITH HOME & SHOP
FSBO: Located south of Corvallis, OR. \$650,000. Contact: 406-465-7271.

10 Acres Surveyed 100% off Grid: 3 bdrm mobile, shop, horse barn, private auto gate. Unforgettable Grays Harbor County. 3/4 Mile nearest neighbor. 3 Miles to Elma, WA. \$340,000. 360-482-3897. 360-470-1899



170 Plus Acres: Molalla, OR. Large 4,000 square foot 5 bedroom 3 bath fixer. Bring your imagination to return this once grand property to its glory days. Outbuildings include: Mother-in-law cottage, large 2 bay truck shop, machine shed, two big barns and a gazebo with fireplace. 3 large ponds, a small 12 tree apple orchard and RC air strip add to the amenities. \$1,200,000. MLS#16606148 Ed Stafford, RE/MAX HomeSource Office 503-829-8500, Cell 503-708-0981.



Awesome Valley and Sprague River Views: 400 (+) acres all 80/ acre subdividable. 156 Acre of water rights, 3 solar wells, underground main line, wheel-lines, 3/2, 1600 sq.ft. manufactured home, 200 ton pole barn, nursery barn, 6 bay, large equipment shed and shop. Private stocked fishing lake. 100 hp variable geared pump system in river, all planted in pasture. Owner carry 30% down on a 4% note, over 30 years but due in 5. Asking \$899,000. Will consider trade. Sprague River, OR. 541-533-2364



BEAUTIFUL FARM: 28+ acres, 2 story barn with attached tool tractor shed. Shop with cold room, cutting room on the most beautiful property in Mossyrock, WA. 4 bedroom home. Creek and ponds. Views of Mt. Rainier. Near Riffe Lake. TOO MUCH TO LIST! Call KELLY EGAN 360-269-1086 RE/MAX Key Land



Bend, OR: Horsell Road Farm boasts 474 contiguous acres with 392 acres of irrigation, 6 pivot lines, 2 pumping stations, 68' x 176' hay barn, 40' x 60' shop with two 24' equipment sheds. Home features 4 beds, 2 baths, 2879 square foot, slab granite counters throughout, large pantry, mud room, laundry room, office, covered patio, heat pump with air conditioning, \$3,345,000. North unit of 317 acres with 260 irrigated (with shop & barn) or South unit of 160 acres with 125 irrigated (with house) could be available separately. Full line of farm equipment available. John Ropp, Principal Broker/Owner, The Broker Network, 541-771-6564.



BUYING RURAL PROPERTY?
• Ranches • Ranchettes • Land • Acreage • Horse Property • Pasture Visit Today!
www.farmseller.com

Farm/ Ranch For Sale By Owner: Eastern Washington, 560 total acres, 385 Acres of dry farm land plus 175 acres fenced pasture. Spokane County 160 acres. Lincoln County 400 acres. Joined parcels. Approximately 11 acres of pine trees, old farm house, partially collapsed large barn, 1 out building, good functioning well, Century Link telephone, Avista electricity, on paved road. Great potential for development. \$1,250,000. 509-990-3310 bcederblom@gmail.com

WA ACREAGE
22 Acres Chehalis Nice 3 Bed, Fireplace, 2 Baths, Estate **\$225,000**
75 Acres Chehalis Land & Merch. Timber & Growing Timber **\$250,000**
5.5 Acres Centralia Mostly Timber. **\$65,000**
Frank Dipola Realty
201 S. Tower St.
Centralia, WA 98531
360-736-9561

Your Farm & Land Specialist

840-Cow Dairy Farm in Western Washington,\$5.3 Million
80 acres, Molalla Or. 50 acres suitable for hazelnuts. Buildable.....**SOLD \$610,000**
(507) Acres: (30) acres water rights, fenced & crossfenced Richardson Gap Road, Lebanon, OR.**PRICE CHANGE \$1,599,000**
(49) Acre Vineyard Site: South Salem Hills, Willamette Valley AVA,**\$808,500**

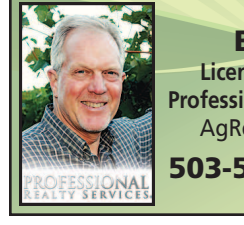

Bill Hekman
Licensed OR & WA Broker
Professional Realty Services Intl.
AgRealtyNW@gmail.com
503-580-8664

380 Farms
Indian Valley, ID, 1,153 +/- Acres Hell's Canyon Rim Country For Sale By Owner. Magnificent Mountain Views, highly productive farmland, growing alfalfa hay, timothy hay and grain. One main home, a secondary home and 4 additional home sites with access to power and water. 5 large hay barns, 7 pivots, 2 wheel lines, granary and several outbuildings. Water rights, well water, two irrigation wells, surface water. Hunting opportunities. About 15 miles from Council, ID. Firm Pricing. Possible short-term owner financing. Serious Buyers only, \$5,000,000. Call 208-256-4419, 208-741-2399



ROSE CREEK RANCH FOR SALE
Rose Creek Ranch in Winnemucca, Nevada for sale. 2,700 Acres, 400 acres under pivot currently in alfalfa and grain hay. Extensive water rights, freeway frontage, clean ranch house, excellent hunting, year round stream. 9 Miles west of downtown Winnemucca, Nevada, I-80 off ramp and frontage. Please call Dan 775-273-0896

Unique 20 Acre Junction City, OR Farm: private, secure, views, 2 homes, outbuildings, power, water, gentle southwest grade, some timber, by owner. Jim 541-521-0682

385 Dairy Farms



BUYING RURAL PROPERTY?
Visit Today!
www.farmseller.com



Eastern Washington Dairy
This is a well-maintained 500 cow dry lot facility with 510 mature lockups, open sheds/shades, D10 Herringbone Parlor, 2 milk tanks, Jersey x cows and young stock available, +/-70 lbs./ day milk with high BF and protein. Sale includes 40,596 lbs of milk base and 3,200 square foot home with pool. Eric Weinheimer, Ag Com Real Estate, LLC, 509-845-4389, ewagrealstate@hotmail.com

BEST SELLERS . . .
"...The phone rang off the hook."
VanVelthuisen Dairy • Turner, OR
Call and list your BEST SELLER!
1-800-882-6789



THANK YOU!
My ad was very effective!
I received responses and sold mini donkeys in ID, OR and CA, proving your coverage for the agricultural world in the West is pretty good!

Del Turner
Cedar Ridge Farm
Myrtle Creek, OR

Capital Press
The West's Ag Weekly
DEADLINES:
Classified Display Ads, Weds. @ 10AM
Classified Line Ads Weds. @ Noon
1-800-882-6789
Fax 503-370-4383
www.capitalpress.com

380 Farms

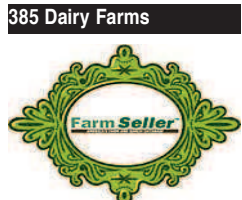

BUYING RURAL PROPERTY?
Visit Today!
www.farmseller.com

"BEST FARM PAPER AROUND!"
Gerald Stanton • Granite Falls, Wash.
Subscribe! Call 1-800-882-6789

GOT MILKERS?



Celebrate June Dairy Month
in Capital Press' 33rd Annual Dairy Industry Special Section
June 2nd, 2017
Our annual Dairy Special Section spotlights dairy operations and operators in California, Idaho, Oregon and Washington. It features an in depth look at the situations and successes - needs and concerns of this dynamic industry.

To reach our print and online readers, contact your sales representative or call 1-800-882-6789.

Ad space reservation is by Friday, May 5th.

Capital Press
The West's Ag Weekly
PO Box 2048
Salem, OR 97308
(503) 364-4798 (800) 882-6789
Fax: (503) 364-2692 or (503) 370-4383
www.capitalpress.com
385-14-4-2/#13

387 Orchard/Vineyard Properties

120 +/- acre development ranch in Canyon County, Idaho's A.V.A. 9-10 exquisite view lots. Ground and surface water rights with irrigation well. Perfect orchard or vineyard ground, all south slopes. \$2,750,000. 208-412-6300

Pleasant Hill Development LLC
Complete vineyard installation from land clearing to planting and maintenance. Licensed, bonded, insured. CCB# 213829. Financing options available. Sheridan, OR. 971-241-0344

390 Timber Property

117 Acres Timber Land: in Noti, OR. Zoned F1, behind locked gate, good roads, well stocked, 24 years old, \$500,000. 541-968-7544



www.farmseller.com
SELLING RURAL PROPERTY?
Call or Visit Today!
1-800-882-6789

400 Land

Minnesota CRP Land For Sale: 1360 acres, 1090 CRP acres out in 2017 and 2018, 270 acres grass and trees, excellent hunting area. Proposed payment \$70 per acre. 701-570-5600

420 Acreage



(110) Acres: Property has county roads on (3) sides, some timber, mostly pasture, graveled area for tree landing/ shipping. Great views of Cascade Mountains and Mt. Hood, OR. Seasonal creek, approximately (90) acres in pasture and balance in timber. One mile South from Molalla City center, \$550,000. RMLS #15048476. Call Ed Stafford, for more information 503-829-8500, OREL#200202015

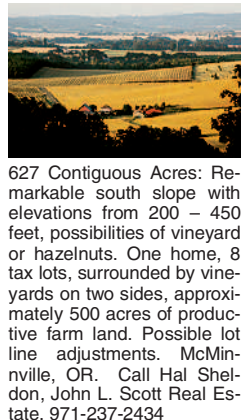

627 Contiguous Acres: Remarkable south slope with elevations from 200 - 450 feet, possibilities of vineyard or hazelnuts. One home, 8 tax lots, surrounded by vineyards on two sides, approximately 500 acres of productive farm land. Possible lot line adjustments. McMinnville, OR. Call Hal Sheldon, John L. Scott Real Estate. 971-237-2434

470 Timber, Lumber

BUYING 6" and UP Alder and Maple Saw Logs, Standing Timber



Chehalis, WA
Darrell Alvord 360-431-0421 WA • OR
Ken Jones 360-520-6491 WA • OR
Brian Karnes 253-208-9120

420 Acreage
63 Acres Excellent Alfalfa Ground: Irrigated from wells with early priority dates. View lots of Blue Mountains. Located East of Pilot Rock, Oregon on Birch Creek. Priced less than county assessed tax value. Ray 541-443-7451

For Lease: 935 Acres of dryland wheat ground. Pendleton, OR. 541-276-2753

GRAZING LAND IN NORTHEAST CALIFORNIA
Grazing land near Cal Pines, next to Graves Reservoir, near Graven Ridge. 2,367 Acres accessible on County Rd 72 and another 760 acres close by, \$450 per acre. 360-675-9091 ext. 3 julia@ipmrent.com

Motivated Seller: 161 acres in Douglas County. Several Springs and septic approved. I-5 access, \$340,000. Salem, OR. 503-362-3055

www.farmseller.com
SELLING RURAL PROPERTY?
Call or Visit Today!
1-800-882-6789

425 Pasture



200 Acres of Pasture: for lease in McMinnville, Oregon. email: rfcompanyllc@gmail.com Phone: 660-624-1311

5,640 Acres Dry Pasture:
Grazing ground between Ontario and Huntington Oregon, leased for the 2017 grazing season, freeway splits property, Hwy 201 access, fenced and cross fenced, water both springs and well. In addition to spring some years would make good fall and some winter pasture. \$2,600,000. Tom Phillips Agency 541-889-8401. Email: tompa7@gmail.com

BUYING RURAL PROPERTY?
Visit Today!
www.farmseller.com
Mountain Spring Pasture Available: 140 to 390 pair, easy access. Modoc and Lassen Counties, CA. 530-294-1203
Pasture For 1600 Yearlings: Eastern Oregon. 541-977-6160
Pasture for 400 pair in Eastern Oregon. Call 541-420-8689.
Pasture for Rent: enough room for 100 head of yearlings. Tidewater, OR. Call 541-270-7717

PASTURE WANTED!
Pasture wanted for 75 pairs and 3 bulls from May 15 to September 15. Looking in Eastern Washington and Eastern Oregon. Also, Northern or Western Idaho. Contact Clay Easterday 509-366-6430 or Cutler Easterday 509-366-6439

Pasture Your Yearlings On Our 632 Acre Ranch: irrigated Alfalfa, swathed and wilted 48 hours to prevent bloat. Cattle moved daily in rotational grazing system. Seeking long-term grazing venture. You supply the cattle, we supply labor. North Powder, OR. 541-805-0872

SUMMER PASTURE: 10,000 acres, 7200 acres deeded, lots of water, high country, Eastern Oregon, \$2,750,000. Tom Phillips Agency 541-889-8401, Email: tompa7@gmail.com
Wanted: Spring and Summer Pasture, for 50 to 100 pairs or yearlings. Eastern Oregon or Western Idaho. 208-741-0755
408 Commercial Property
MEAT SHOP FOR SALE IN DAYTON, WA
Fully equipped butcher and meat cutting shop for sale in Dayton, WA. The owner is retiring and needs someone to take over. Call Joe at 509-520-2153.

440 Business Opportunities

BUSINESS For Sale
For Sale By Owners: Hardwood flooring and paneling manufacture, equipment and inventory. Specializing in Myrtle wood and Madrone. 541-572-5755 or 541-267-7329
In Florence: 47 unit mini storage business with 30'x50' truck shop and office on 1-1/2 acres on Hwy. 101. \$1400 monthly storage income last 10 years. Owner financing with excellent credit references, \$350,000. 541-999-1011

#1 West's BEST Ag News!
• newspaper
• facebook
• twitter
• blog
• web
www.capitalpress.com

470 Timber, Lumber

Oregon Black Walnut Lumber: kiln dried. We also buy logs. Goby Walnut Products. Portland, OR. 503-477-6744

TOEPFER LOGGING, INC.
Timber Harvesting, Slash Piling, Reforestation: high quality forest and land management services. Certified professional logger. Over 50 years in the timber industry. Stayton, OR. 503-769-5505

Wanted
Buying old barn lumber, coral boards and/or beams. Also wanted for salvage: old wooden structures slated for demo or clean up. **Could save you thousands on demo costs.** Contact Brad at Timberworks, Inc. 208-669-1489 or by email at timberworksinc@moscow.com

CAPITAL PRESS CLASSIFIEDS
1-800-882-6789
www.capitalpress.com

WE BUY LOGS
• Standing Timber
• Land and Timber
Call for quotes.
We can answer your questions.
ROSBORO, LLC
Brian, 503-569-8740
Springfield, OR
470-14-4-1#5

470 Timber, Lumber

470 Timber, Lumber

Buying Logs & Timber
DOUG FIR
WHITEWOOD
STANDING TIMBER
TIMBER DEEDS
LAND & TIMBER

Jones Lumber Co., Inc.
Lyons, OR
TODD PARKER
503-859-2111
LYONS, OREGON

480 Fencing



FENCE INSTALLATION: Fence installed with hydraulic post driver. New Zealand, nonclimb, sheep & goat, woven wire, barbed wire, deer, and rail fencing. Serving Oregon since 1993. Licensed, Bonded & Insured CCB#93256. Salem, OR. 503-859-2804
www.statewidefence.net

Fence Posts: Douglas Fir, Penta Power Pole Treated, round rail fencing. Tinker Toy Fence. Junction City, OR. For hours, 541-689-3726

470 Timber, Lumber

NORTHWEST HARDWOODS
ALDER WANTED
Also Maple and Ash: Saw Logs Pulp Logs and Timber Deeds
Contact our Resource Group at these locations:
Coos Bay, OR: Ed G. (541) 404-3701
Eugene, OR: Dick W. (541) 206-4105
Tim T. (541) 231-4758
Garibaldi, OR: Lee A. (541) 290-9892
Salem, OR: Tim T. (541) 231-4758
Longview, WA: Steve A. (360) 430-0885
John A. (360) 807-7726
Centralia, WA: Jeremy M. (360) 807-7711
John A. (360) 807-7726

ROCKY MOUNTAIN STEEL
New Steel • Fasteners
• Stainless Steel
• New & Used Pipe • Beams
• Springs
• Turnbuckles Used Cable
• Fence Clips • Cable Clamps
• Oil Field Sucker Rod in all sizes
Direct Ship & Cutting Available
400 3rd Ave. North
Nampa, ID 83687
208-466-8913 (FAX)
800-851-8612 / 208-466-0036

Metal Roofing and Siding
Retail... Contractors... Wholesale...
ALL CUSTOMERS WELCOME!
Steel Building Kits Available
26 Ga. 3' Sale White \$2.15/LF
29 Ga. 3' Sale \$1.65/LF
Over a dozen select colors available!
www.metallionindustries.com
METALLION INDUSTRIES
HOURS: Mon. - Fri. 8:00 - 5:30
503-630-7740
850 NW Park Avenue • Estacada, OR
"LIVE EVERY DAY FOR JESUS!"



470 Timber, Lumber

480 Fencing

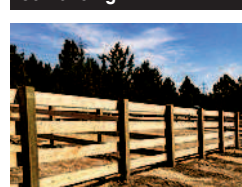

Animal Safe! Customizable! Easy Maintenance!
15-1/#16

Cable For Fencing



Animal Safe! Customizable! Easy Maintenance!
15-1/#16

NOTICE: Oregon Construction Contractors Law (ORS 701) requires that all businesses that advertise remodeling, repair, home improvement or new construction be licensed with the Construction Contractors Board. An active license means the contractor is bonded and insured.
Verify a contractor's license and complaint history at **www.hirealicensedcontractor.com**
503-378-4621
480-15-2-4/#13

500 Building Materials

500 Building Materials

480 Fencing

Lindevineyard supply
Serving OR, WA, ID
• Fixed Knot Fence
• Barbed
• Gripple
• Penta Posts
• Gates
• And More!

866-966-3597
lindevineyardsupply.com
480-14-4-1/#7



FENCING!

Animal Safe! Customizable! Easy Maintenance!
15-1/#16



Animal Safe! Customizable! Easy Maintenance!
15-1/#16

NEW TRUCK LOADS ARRIVING! Great Pricing! Call Today!
BISON PIPE & SUPPLY
800.764.7473
www.BisonPipe.com

500 Building Materials

500 Building Materials

490 Rock, Sand, Gravel

GRAVEL WASH PLANT/ GOLD PLACER
Very nice and well built wash plant with 22' vibrating feeder and 14' Trommel, 16' sluice box. Has a Jig plant for gemstones and sand trap water system. Contact Rick Beckner, Searcher Exploration, Redmond, OR at 541-604-1376. I also test hardrock for gold with pilot mill.

500 Building Materials

3'x18' Sheets of Metal Roofing: 24 to 26 gauge, large volume. Wilsonville, OR. 503-806-7536

CEDAR SPLIT POST/ SHINGLES
Cedar split post made to order. Call for pricing. Cedar barn shingles starting at \$10 a bundle. Coquille, OR. Mike 541-297-4949

Used Treated and Untreated Glulam Beams: many sizes up to 65' long. Portland, OR. 503-936-9414

Wanted
Used, new and scrap metal roofing. Used and scrap old barn wood. We will haul. Text ONLY Preferred: 541-993-7372

Buying or Selling
Capital Press is here to help you!
1-800-882-6789
or FAX 503-370-4383
www.capitalpress.com

METAL ROOFING AND SIDING
AGRICULTURAL & COMMERCIAL
9109 N. Willbur Ave., Portland, OR
(503) 285-1907
www.remsteel.com
500-15-3-1/#8

Don't Replace Your Metal Roof. Repair it!
Rust control, stops leaks. White reflective or colored top coats.
503-881-1946
360-727-3500

510 Farm Buildings
Martin Cisneros Pole Buildings & Concrete: Shops, garages, arenas, hay storage. Agriculture/ Residential, additions and repairs. Serving Oregon CCB# 135771. Licensed, bonded and insured. Excellent references. 503-375-9273 or 503-507-2847

500 Building Materials

500 Building Materials

LEGACY METALWORKS
AGRICULTURAL • RESIDENTIAL • COMMERCIAL
METAL ROOFING & SIDING
Call for Current Sale Pricing!
(541) 632-4260
www.legacymetalworks.com
795 S. 2nd ST., HARRISBURG, OR

BARKER BUILDINGS
25 YEARS IN THE POLE BUILDING BUSINESS
POLE BUILDINGS • STEEL BUILDINGS • ARENAS • SHOPS
• GARAGES • LEAN TOS • CONCRETE • EXCAVATION
ADAM BARKER Owner/Operator
ORccb #206886 • Lafayette, OR
971-237-4403 • abarkerbuildings@gmail.com

PARKER BUILDINGS INC. QUALITY SINCE 1982
1-800-331-0155
503-981-0890
• BARNs • ARENAS & STALL BARNs
• WAREHOUSES • COMMERCIAL • SHOPS & GARAGES • RESIDENTIAL • MINI STORAGE
Special DIY Pricing
EAVE 10' 12' 14' 16'
24x36 \$4,928 \$5,338 \$5,693 \$6,108
30x36 \$5,481 \$5,965 \$6,405 \$6,892
30x48 \$6,553 \$7,045 \$7,582 \$8,373
36x36 \$6,159 \$6,646 \$7,139 \$7,873
36x48 \$7,834 \$7,930 \$8,479 \$9,451
40x48 \$8,267 \$8,841 \$9,475 \$10,381
40x60 \$9,543 \$10,173 \$10,898 \$11,723
Kit contains: (1) 3'x6'-8" Entry Door, (1) 11' wide slider door, Galvanized Roof, Painted Walls & Trim. These buildings have Engineered Plans & price is based on 25# Snow load, "B" Exposure.
www.PARKERBUILDINGS.COM

PARKER BUILDINGS INC. QUALITY SINCE 1982
1-800-331-0155
503-981-0890
• BARNs • ARENAS & STALL BARNs
• WAREHOUSES • COMMERCIAL • SHOPS & GARAGES • RESIDENTIAL • MINI STORAGE
Special DIY Pricing
EAVE 10' 12' 14' 16'
24x36 \$4,928 \$5,338 \$5,693 \$6,108
30x36 \$5,481 \$5,965 \$6,405 \$6,892
30x48 \$6,553 \$7,045 \$7,582 \$8,373
36x36 \$6,159 \$6,646 \$7,139 \$7,873
36x48 \$7,834 \$7,930 \$8,479 \$9,451
40x48 \$8,267 \$8,841 \$9,475 \$10,381
40x60 \$9,543 \$10,173 \$10,898 \$11,723
Kit contains: (1) 3'x6'-8" Entry Door, (1) 11' wide slider door, Galvanized Roof, Painted Walls & Trim. These buildings have Engineered Plans & price is based on 25# Snow load, "B" Exposure.
www.PARKERBUILDINGS.COM